



# LIBRARIES

UNIVERSITY OF WISCONSIN-MADISON

## **Site 4075: White River, Green Lake County, Township 17N, Range 12E, Section 19. 1953-07-02**

[s.l.]: [s.n.], 1953-07-02

<https://digital.library.wisc.edu/1711.dl/QQ4GC5O7ZSLR384>

This material may be protected by copyright law (Title 17, US Code).

For information on re-use see:

<http://digital.library.wisc.edu/1711.dl/Copyright>

The libraries provide public access to a wide range of material, including online exhibits, digitized collections, archival finding aids, our catalog, online articles, and a growing range of materials in many media.

When possible, we provide rights information in catalog records, finding aids, and other metadata that accompanies collections or items. However, it is always the user's obligation to evaluate copyright and rights issues in light of their own use.

STAND RECORD

FORESTS

Stand No. 4075

Name: White River

County: Green Lake

Date: July 2, 1953

Size of Stand: 20A

Forest Type: Floodplain hardwoods

Topography: Braided sloughs

Locality:

T: 17N R: 12E Sec: 19

SE: NW

Observers: Ware, Anderson

Size of Area Sampled: 10A

Soil Type:

Slope:

Directions

Condition of Stand: Signs of slight cutting, but in general stand is in good condition. Abundant medium to small sized ashes along sloughs.

Open Grown Trees:

80% Canopy:

Stumps:

- |    |    |    |     |
|----|----|----|-----|
| 1. | 4. | 7. | 10. |
| 2. | 5. | 8. | 11. |
| 3. | 6. | 9. | 12. |

Soil Data:

	pH	N	P	K	Ca	Mg	Org. Mat.	Colloids	W.H.C.
A <sub>0</sub>									
A <sub>1</sub>									
A <sub>2</sub>									
B									

DEPTH

CHARACTERISTICS (Color, Texture, Structure, etc.)

A <sub>0</sub>	2-4	rich in higher areas
A <sub>1</sub>	2-6	deep and black in places
A <sub>2</sub>		Pure sand
B		

Parent Material:

Map:

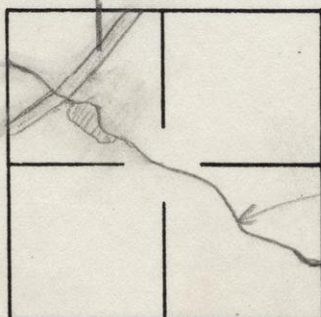

White River

Sec 19

POINT RECORD TREES

Stand No. 4075

STATION NO.	1	2	3	4	5	6	7	8	9	10
Acer negundo										
A. saccharinum		45	2	2	1			40 35	85 120 110 45	80 50
A. saccharum										
Betula nigra										
Carya cordiformis										
Celtis occident.										
Crataegus sp.										
Fraxinus americ.										
F. nigra		1				1		2	2	
F. pennsylvanica										
Gleditsia triacan.										
Gymnocladus dioica										
Juglans cinerea										
Platanus occident.										
Populus deltoides										
P. tremuloides										
Prunus serotina										
Quercus bicolor							50 90	25		
Q. rubra										
Robinia pseudo.										
Salix nigra										
Tilia americana	220 35	2	150	230 310	360		30	4	2	2
Ulmus americana										
U. rubra	2	270	20	2	130	2	120 153	1	140	1
Amelanchier										
Distance	13 1/2	24	17	28	20	16	21	19	22	25 1/2

①

Handwritten notes at the bottom right of the page.

POINT RECORD TREES

(2)

1 Q. bicolor 18ft in circumference (not at pts)

STATION NO.	1	2	3	4	5	6	7	8	9	10		
Acer negundo												
A. saccharinum	40	110 500	2/80	2		120	540	2				
A. saccharum												
Betula nigra												
Carya cordiformis												
Celtis occident.												
Crataegus sp.												
Fraxinus americ.			1	1				2	1			
F. nigra	2	2/70	1	1	3	2				1		
F. pennsylvanica												
Gleditsia triacan.												
Gymnocladus dioica												
Juglans cinerea												
Platanus occident.												
Populus deltoides												
P. tremuloides												
Prunus serotina												
Quercus bicolor							85	1		760		
Q. rubra												
Robinia pseudo.												
Salix nigra												
Tilia americana	2			65 150	2	30 35	1	25 20		3	25 18	3
Ulmus americana												
U. rubra					100	580	2	80	2	110 95		
Distance	20	10	12	11	22	21	16	23	14	14		

POINT RECORD TREES

STATION NO.	1	2	3	4	5	6	7	8	9	10
Acer negundo										
A. saccharinum		123		4					40 60	4 90 4
A. saccharum										(3)
Betula nigra										
Carya cordiformis										
Celtis occident.										
Crataegus sp.										
Fraxinus americ.								1		
F. nigra						4	1			
F. pennsylvanica										
Gleditsia triacan.										
Gymnocladus dioica										
Juglans cinerea										
Platanus occident.										
Populus deltoides										
P. tremuloides										
Prunus serotina										
Quercus bicolor	490			380			75 280			
Q. rubra										
Robinia pseudo.										
Salix nigra										
Tilia americana	60	2 25	1 140	4	60	220	24	1 80	1	
Ulmus americana										
U. rubra	2		160	160	2 12		2 60	2		65
Distance	10	14	13	18'	12	8	16	15	13	20

STATION NO.	1	2	3	4	5	6	7	8	9	10
Acer negundo										
A. saccharinum	480	45 110 ✓		60 85	4 200				80 2	460 95 ✓
A. saccharum										
Betula nigra										
Carya cordiformis										
Celtis occident.										
Crataegus sp.										
Fraxinus americ.	2				14				2	
F. nigra	80 1		1				240			3
F. pennsylvanica										
Gleditsia triacan.										
Gymnocladus dioica										
Juglans cinerea										
Platanus occident.										
Populus deltoides										
P. tremuloides										
Prunus serotina										
Quercus bicolor						100		150 2		
Q. rubra										
Robinia pseudo.										
Salix nigra										
Tilia americana			200 90 3			40 2		45 50		
Ulmus americana										
U. rubra	1	2					95		2 120	
Distance	19	12	21	10	16	8	19	24	20	14

(4)

Prunus

Presence or Frequency  
(Common species only)

## FLOOD-PLAIN HARDWOODS

Stand No. 4075  
Quadrat No. Presence

<i>Adiantum pedatum</i>	<i>Corylus americana</i>	<i>Polygonatum canaliculatum</i>
<i>Agrimonia gryposepala</i>	<i>Cryptotaenia canadensis</i>	<i>Prenanthes alba</i>
<i>Allium canadense</i>	<i>Desmodium glutinosum</i>	<i>Ranunculus abortivus</i>
<i>Allium tricoccum</i>	<i>Dioscorea villosa</i>	<i>Ranunculus septentrionalis</i>
<i>Amphicarpa tracteada</i>	<i>Echinocystis lobata</i>	<i>Rhus radicans</i>
<i>Anemone canadensis</i>	<i>Fragaria virginiana</i>	<i>Ribes americanum</i>
<i>Anemone virginiana</i>	<i>Galium aparine</i>	<i>Ribes cynosbati</i>
<i>Aralia nudicaulis</i>	<i>Galium concinnum</i>	<i>Ribes missouriense</i>
<i>Arenaria lateriflora</i>	<i>Galium obtusum</i>	<i>Rorippa islandica</i>
<i>Arisaema atrorubens</i>	<i>Galium triflorum</i>	<i>Rudbeckia laciniata</i>
<i>Arisaema dracontium</i>	<i>Geranium maculatum</i>	<i>Rumex verticillatus</i>
<i>Asarum canadense</i>	<i>Geum canadense</i>	<i>Sambucus canadensis</i>
<i>Aster lateriflorus</i>	<i>Glyceria striata</i>	<i>Sanguinaria canadensis</i>
<i>Aster simplex</i>	<i>Hydrophyllum virginianum</i>	<i>Sanicula gregaria</i>
<i>Athyrium filix-femina</i>	<i>Ilex verticillata</i>	<i>Smilacina racemosa</i>
<i>Athyrium thelypteroides</i>	<i>Impatiens capensis</i>	<i>Smilacina stellata</i>
<i>Boehmeria cylindrica</i>	<i>Iris virginica</i>	<i>Smilax ecirrhata</i>
<i>Brachyelytrum erectum</i>	<i>Lactuca biennis</i>	<i>Smilax herbacea</i>
<i>Caltha palustris</i>	<i>Laportea canadensis</i>	<i>Smilax tannoides</i>
<i>Campanula americana</i>	<i>Leersia oryzoides</i>	<i>Solanum dulcamara</i>
<i>Carex crinita</i>	<i>Lobelia cardinalis</i>	<i>Stachys palustris</i>
<i>Carex grayii</i>	<i>Lycopus americanus</i>	<i>Teucrium canadense</i>
<i>Carex intumescens</i>	<i>Lycopus uniflorus</i>	<i>Thalictrum dasycarpum</i>
<i>Carex lupulina</i>	<i>Lysimachia ciliata</i>	<i>Thalictrum dioicum</i>
<i>Carex normalis</i>	<i>Lysimachia nummularia</i>	<i>Tovara virginiana</i>
<i>Carex vupinoidea</i>	<i>Menispermum canadense</i>	<i>Trillium flexipes</i>
<i>Cephalanthus occidentalis</i>	<i>Onoclea sensibilis</i>	<i>Uvularia sessilifolia</i>
<i>Cicuta maculata</i>	<i>Osmorhiza claytoni</i>	<i>Veronicastrum virginianum</i>
<i>Circaea quadrisulcata</i>	<i>Osmorhiza longistylis</i>	<i>Viburnum lentago</i>
<i>Cirsium altissimum</i>	<i>Parthenocissus inserta</i>	<i>Viola canadensis</i>
<i>Convolvulus sepium</i>	<i>Phlox divaricata</i>	<i>Viola conspersa</i>
<i>Cornus femina</i>	<i>Phryma leptostachya</i>	<i>Viola cucullata</i>
<i>Cornus obliqua</i>	<i>Physostegia virginiana</i>	<i>Viola pubescens</i>
<i>Cornus rugose</i>	<i>Podophyllum peltatum</i>	<i>Vitis riparia</i>
<i>Cornus stolonifera</i>	<i>Polemonium reptans</i>	<i>Zanthoxylum americanum</i>

Additional species:

*Betula papyrifera*  
*Carex gracillima*

Presence List  
(Uncommon species)

## FLOOD-PLAIN HARDWOODS

Stand No. 4075  
Quadrat No. Present

Acorus calamus	Comandra umbellata	Mitella diphylla
Actaea pachypoda	Cornus alternifolia	Monarda fistulosa
Actaea rubra	Cuscuta sp.	Muhlenbergia sp.
Agastache scrophulariaefolia	Dentaria laciniata	Napaea dioica
Agropyron trachycaulum	Desmodium nudiflorum	Nepeta hederacea
Alisma subcordatum	Dicentra cucullaria	Oryzopsis racemosa
Alnus incana	Diervilla lonicera	Osmunda cinnamomea
Alnus rugosa	Dryopteris cristata	Osmunda regalis
Ambrosia trifida	Dryopteris spinulosa	Oxalis europaea
Amorpha fruticosa	Dryopteris thelypteris	Oxalis stricta
Anemone quinquefolia	Ellisia nyctelea	Parietaria pensylvanica
Anemonella thalictroides	Elymus virginicus	Phalaris arundinacea
Angelica atropurpurea	Epilobium palustris	Phlox pilosa
Apios americana	Equisetum arvense	Physocarpus opulifolius
Aralia hispida	Equisetum hyemale	Pilea pumila
Aralia racemosa	Erigeron philadelphicus	Poa palustris
Asclepias incarnata	Erigeron pulchellus	Polygonatum biflorum
Aster cordifolius	Erythronium albidum	Polygonatum pubescens
Aster sagittifolius	Eupatorium perfoliatum	Polygonum hydropiper
Aster shortii	Eupatorium purpureum	Polygonum sagittatum
Bidens connata	Eupatorium rugosum	Pteridium aquilinum
Bidens coronata	Euonymus atropurpureus	Ranunculus recurvatus
Bidens frondosa	Festuca obtusa	Ratibida pinnata
Bidens vulgata	Fragaria vesca	Rubus allegheniensis
Botrychium virginianum	Galium tinctorium	Rubus occidentalis
Bromus purgans	Gerardia gradiflora	Rumex altissimus
Calamagrostis canadensis	Geum strictum	Salix amygdaloides
Carex albursina	Hackelia virginica	Salix interior
Carex alopecoidea	Helenium autumnale	Sanicula marilandica
Carex convoluta	Helianthus strumosus	Saxifraga pensylvanica
Carex cristata	Hepatica acutiloba	Scutellaria lateriflora
Carex grisea	Heracleum maximum	Senecio aureus
Carex laxiflora	Hydrophyllum appendiculatum	Silphium perfoliatum
Carex molesta	Hypericum ascyron	Sium suave
Carex muskingumensis	Hypericum pyramidatum	Solidago gigantea
Carex pensylvanica	Hystrix patula	Solidago ulmifolia
Carex projecta	Impatiens pallida	Spiraea alba
Carex stipata	Iris versicolor	Staphylea trifolia
Carex tribuloides	Isopyrum biternatum	Stellaria longifolia
Carex typhina	Juncus tenuis	Symplocarpus foetida
Carex vesicaria	Lactuca canadensis	Trientalis borealis
Cassia marilandica	Lilium michiganense	Trillium grandiflorum
Caulophyllum thalictroides	Lilium philadelphicum	Trillium recurvatum
Galastrus scandens	Lilium superbum	Triosteum perfoliatum
Chaerophyllum procumbens	Lippia lanceolata	Urtica dioica
Chelone glabra	Lonicera prolifera	Uvularia grandiflora
Cicuta bulbifera	Maianthemum canadense	Vernonia fasciculata
Circaea alpina	Mentha arvensis	Viola renifolia
Clematis virginiana	Mertensia virginica	Zizia aurea
Clintonia borealis	Mimulus ringens	

Additional Species:



Presence or Frequency  
(Common species only)

## FLOOD-PLAIN HARDWOODS

Stand No. 4075  
Quadrat No. 1

Adiantum pedatum  
Agrimonia gryposepala  
Allium canadense  
Allium tricoccum  
Amphicarpa bracteata  
Anemone canadensis  
Anemone virginiana  
Aralia nudicaulis  
Arenaria lateriflora  
Arisaema atrorubens  
Arisaema dracontium  
Asarum canadense  
Aster lateriflorus  
Aster simplex  
Athyrium filix-femina  
Athyrium thelypteroides  
Boehmeria cylindrica  
Brachyelytrum erectum  
Caltha palustris  
Campanula americana  
Carex crinita  
Carex grayii  
Carex intumescens  
Carex lupulina  
Carex normalis  
Carex vupinoidea  
Cephalanthus occidentalis  
Cicuta maculata  
Circaea quadrisulcata  
Cirsium altissimum  
Convolvulus sepium  
Cornus femina  
Cornus obliqua  
Cornus rugosa  
Cornus stolonifera

Corylus americana  
Cryptotaenia canadensis  
Desmodium glutinosum  
Dioscorea villosa  
Echinocystis lobata  
Fragaria virginiana  
Galium aparine  
Galium concinnum  
Galium obtusum  
Galium triflorum  
Geranium maculatum  
Geum canadense  
Glyceria striata  
Hydrophyllum virginianum  
Ilex verticillata  
Impatiens capensis  
Iris virginica  
Lactuca biennis  
Laportea canadensis  
Leersia oryzoides  
Lobelia cardinalis  
Lycopus americanus  
Lycopus uniflorus  
Lysimachia ciliata  
Lysimachia nummularia  
Menispermum canadense  
Onoclea sensibilis  
Osmorhiza claytoni  
Osmorhiza longistylis  
Parthenocissus inserta  
Phlox divaricata  
Phryma leptostachya  
Physostegia virginiana  
Podophyllum peltatum  
Polemonium reptans

Polygonatum canaliculatum  
Prenanthes alba  
Ranunculus abortivus  
Ranunculus septentrionalis  
Rhus radicans  
Ribes americanum  
Ribes cynosbati  
Ribes missouriense  
Rorippa islandica  
Rudbeckia laciniata  
Rumex verticillatus  
Sambucus canadensis  
Sanguinaria canadensis  
Sanicula gregaria  
Smilacina racemosa  
Smilacina stellata  
Smilax ecirrhata  
Smilax herbacea  
Smilax tannoides  
Solanum dulcamara  
Stachys palustris  
Teucrium canadense  
Thalictrum dasycarpum  
Thalictrum dioicum  
Tovara virginiana  
Trillium flexipes  
Uvularia sessilifolia  
Veronicastrum virginianum  
Viburnum lentago  
Viola canadensis  
Viola conspersa  
Viola cucullata  
Viola pubescens  
Vitis riparia  
Zanthoxylum americanum

Additional species:

*Viola conspersa*  
*Aster lateriflorus*  
*Athyrium angustum*  
*elm seedling*

*Bromus ciliatus*  
*Carex convoluta*

Presence or Frequency  
(Common species only)

## FLOOD-PLAIN HARDWOODS

Stand No. 4075  
Quadrat No. 2

Adiantum pedatum  
Agrimonia gryposepala  
Allium canadense  
Allium tricoccum  
Amphicarpa bracteata  
Anemone canadensis  
Anemone virginiana  
Aralia nudicaulis  
Arenaria lateriflora  
Arisaema atrorubens  
Arisaema dracontium  
Asarum canadense  
Aster lateriflorus  
Aster simplex  
Athyrium filix-femina  
Athyrium thelypteroides  
Boehmeria cylindrica  
Brachyelytrum erectum  
Caltha palustris  
Campanula americana  
Carex crinita  
Carex grayii  
Carex intumescens  
Carex lupulina  
Carex normalis  
Carex vupinoidea  
Cephalanthus occidentalis  
Cicuta maculata  
Circaea quadrisulcata  
Cirsium altissimum  
Convolvulus sepium  
Cornus femina  
Cornus obliqua  
Cornus rugosa  
Cornus stolonifera

Corylus americana  
Cryptotaenia canadensis  
Desmodium glutinosum  
Dioscorea villosa  
Echinocystis lobata  
Fragaria virginiana  
Galium aparine  
Galium concinnum  
Galium obtusum  
Galium triflorum  
Geranium maculatum  
Geum canadense  
Glyceria striata  
Hydrophyllum virginianum  
Ilex verticillata  
Impatiens capensis  
Iris virginica  
Lactuca biennis  
Laportea canadensis  
Leersia oryzoides  
Lobelia cardinalis  
Lycopus americanus  
Lycopus uniflorus  
Lysimachia ciliata  
Lysimachia nummularia  
Menispermum canadense  
Onoclea sensibilis  
Osmorhiza claytoni  
Osmorhiza longistylis  
Parthenocissus inserta  
Phlox divaricata  
Phryma leptostachya  
Physostegia virginiana  
Podophyllum peltatum  
Polemonium reptans

Polygonatum canaliculatum  
Prenanthes alba  
Ranunculus abortivus  
Ranunculus septentrionalis  
Rhus radicans  
Ribes americanum  
Ribes cynosbati  
Ribes missouriense  
Rorippa islandica  
Rudbeckia laciniata  
Rumex verticillatus  
Sambucus canadensis  
Sanguinaria canadensis  
Sanicula gregaria  
Smilacina racemosa  
Smilacina stellata  
Smilax ecirrhata  
Smilax herbacea  
Smilax tamnoides  
Solanum dulcamara  
Stachys palustris  
Teucrium canadense  
Thalictrum dasycarpum  
Thalictrum dioicum  
Tovara virginiana  
Trillium flexipes  
Uvularia sessilifolia  
Veronicastrum virginianum  
Viburnum lentago  
Viola canadensis  
Viola conspersa  
Viola cucullata  
Viola pubescens  
Vitis riparia  
Zanthoxylum americanum

Additional species:

Aster lateriflorus  
Viola conspersa  
Carex convoluta

Presence or Frequency  
(Common species only)

## FLOOD-PLAIN HARDWOODS

Stand No. 4075  
Quadrat No. 3

Adiantum pedatum	Corylus americana	Polygonatum canaliculatum
Agrimonia gryposepala	Cryptotaenia canadensis	Prenanthes alba
Allium canadense	Desmodium glutinosum	Ranunculus abortivus
Allium tricoccum	Dioscorea villosa	Ranunculus septentrionalis
Amphicarpa bracteata	Echinocystis lobata	Rhus radicans
Anemone canadensis	Fragaria virginiana	Ribes americanum
Anemone virginiana	Galium aparine	Ribes cynosbati
Aralia nudicaulis	Galium concinnum	Ribes missouriense
Arenaria lateriflora	Galium obtusum	Rorippa islandica
Arisaema atrorubens	Galium triflorum	Rudbeckia laciniata
Arisaema dracontium	Geranium maculatum	Rumex verticillatus
Asarum canadense	Geum canadense	Sambucus canadensis
Aster lateriflorus	Glyceria striata	Sanguinaria canadensis
Aster simplex	Hydrophyllum virginianum	Sanicula gregaria
Athyrium filix-femina	Ilex verticillata	Smilacina racemosa
Athyrium thelypteroides	Impatiens capensis	Smilacina stellata
Boehmeria cylindrica	Iris virginica	Smilax ecirrhata
Brachyelytrum erectum	Lactuca biennis	Smilax herbacea
Caitha palustris	Laportea canadensis	Smilax tannoides
Campanula americana	Leersia oryzoides	Solanum dulcamara
Carex crinita	Lobelia cardinalis	Stachys palustris
Carex grayii	Lycopus americanus	Teucrium canadense
Carex intumescens	Lycopus uniflorus	Thalictrum dasycarpum
Carex lupulina	Lysimachia ciliata	Thalictrum dioicum
Carex normalis	Lysimachia nummularia	Tovara virginiana
Carex vupinoidea	Menispermum canadense	Trillium flexipes
Cephalanthus occidentalis	Onoclea sensibilis	Uvularia sessilifolia
Cicuta maculata	Osmorhiza claytoni	Veronicastrum virginianum
Circaea quadrisulcata	Osmorhiza longistylis	Viburnum lentago
Cirsium altissimum	Parthenocissus inserta	Viola canadensis
Convolvulus sepium	Phlox divaricata	Viola conspersa
Cornus femina	Phryma leptostachya	Viola cucullata
Cornus obliqua	Physostegia virginiana	Viola pubescens
Cornus rugosa	Podophyllum peltatum	Vitis riparia
Cornus stolonifera	Polemonium reptans	Zanthoxylum americanum

Additional species:

*Aster lateriflorus*  
*Circaea arundinacea*  
*Bromus latifolius*  
*Asclepias phytolaccoides*  
*Solidago gigantea*

Presence or Frequency  
(Common species only)

## FLOOD-PLAIN HARDWOODS

Stand No. 4075  
Quadrat No. 4

Adiantum pedatum	Corylus americana	Polygonatum canaliculatum
Agrimonia gryposepala	Cryptotaenia canadensis	Prenanthes alba
Allium canadense	Desmodium glutinosum	Ranunculus abortivus
Allium tricoccum	Dioscorea villosa	Ranunculus septentrionalis
Amphicarpa bracteata	Echinocystis lobata	Rhus radicans
Anemone canadensis	Fragaria virginiana	Ribes americanum
Anemone virginiana	Galium aparine	Ribes cynosbati
Aralia nudicaulis	Galium concinnum	Ribes missouriense
Arenaria lateriflora	Galium obtusum	Rorippa islandica
Arisaema atrorubens	Galium triflorum	Rudbeckia laciniata
Arisaema dracontium	Geranium maculatum	Rumex verticillatus
Asarum canadense	Geum canadense	Sambucus canadensis
Aster lateriflorus	Glyceria striata	Sanguinaria canadensis
Aster simplex	Hydrophyllum virginianum	Sanicula gregaria
Athyrium filix-femina	Ilex verticillata	Smilacina racemosa
Athyrium thelypteroides	Impatiens capensis	Smilacina stellata
Boehmeria cylindrica	Iris virginica	Smilax ecirrhata
Brachyelytrum erectum	Lactuca biennis	Smilax herbacea
Caltha palustris	Laportea canadensis	Smilax tannoides
Campanula americana	Leersia oryzoides	Solanum dulcamara
Carex crinita	Lobelia cardinalis	Stachys palustris
Carex grayii	Lycopus americanus	Teucrium canadense
Carex intumescens	Lycopus uniflorus	Thalictrum dasycarpum
Carex lupulina	Lysimachia ciliata	Thalictrum dioicum
Carex normalis	Lysimachia nummularia	Tovara virginiana
Carex vupinoidea	Menispermum canadense	Trillium flexipes
Cephalanthus occidentalis	Onoclea sensibilis	Uvularia sessilifolia
Cicuta maculata	Osmorhiza claytoni	Veronicastrum virginianum
Circaea quadrisulcata	Osmorhiza longistylis	Viburnum lentago
Cirsium altissimum	Parthenocissus inserta	Viola canadensis
Convolvulus sepium	Phlox divaricata	Viola conspersa
Cornus femina	Phryma leptostachya	Viola cucullata
Cornus obliqua	Physostegia virginiana	Viola pubescens
Cornus rugosa	Podophyllum peltatum	Vitis riparia
Cornus stolonifera	Polemonium reptans	Zanthoxylum americanum

## Additional species:

*Aster lateriflorus*  
*Circaea arundinacea*  
*Anem. red seedling*  
*Athyrium angustum*  
*Viola conspersa*

Presence or Frequency  
(Common species only)

## FLOOD-PLAIN HARDWOODS

Stand No. 4075  
Quadrat No. 5

Adiantum pedatum  
Agrimonia grypsosepala  
Allium canadense  
Allium tricoccum  
Amphicarpa bracteata  
Anemone canadensis  
Anemone virginiana  
Aralia nudicaulis  
Arenaria lateriflora  
Arisaema atrorubens  
Arisaema dracontium  
Asarum canadense  
Aster lateriflorus  
Aster simplex  
Athyrium filix-femina  
Athyrium thelypteroides  
Boehmeria cylindrica  
Brachyelytrum erectum  
Caltha palustris  
Campanula americana  
Carex crinita  
Carex grayii  
Carex intumescens  
Carex lupulina  
Carex normalis  
Carex vupinoidea  
Cephalanthus occidentalis  
Cicuta maculata  
Circaea quadrisulcata  
Cirsium altissimum  
Convolvulus sepium  
Cornus femina  
Cornus obliqua  
Cornus rugosa  
Cornus stolonifera

Corylus americana  
Cryptotaenia canadensis  
Desmodium glutinosum  
Dioscorea villosa  
Echinocystis lobata  
Fragaria virginiana  
Galium aparine  
Galium concinnum  
Galium obtusum  
Galium triflorum  
Geranium maculatum  
Geum canadense  
Glyceria striata  
Hydrophyllum virginianum  
Ilex verticillata  
Impatiens capensis  
Iris virginica  
Lactuca biennis  
Laportea canadensis  
Leersia oryzoides  
Lobelia cardinalis  
Lycopus americanus  
Lycopus uniflorus  
Lysimachia ciliata  
Lysimachia nummularia  
Menispermum canadense  
Onoclea sensibilis  
Osmorhiza claytoni  
Osmorhiza longistylis  
Parthenocissus inserta  
Phlox divaricata  
Phryma leptostachya  
Physostegia virginiana  
Podophyllum peltatum  
Polemonium reptans

Polygonatum canaliculatum  
Prenanthes alba  
Ranunculus abortivus  
Ranunculus septentrionalis  
Rhus radicans  
Ribes americanum  
Ribes cynosbati  
Ribes missouriense  
Rorippa islandica  
Rudbeckia laciniata  
Rumex verticillatus  
Sambucus canadensis  
Sanguinaria canadensis  
Sanicula gregaria  
Smilacina racemosa  
Smilacina stellata  
Smilax ecirrhata  
Smilax herbacea  
Smilax tannoides  
Solanum dulcamara  
Stachys palustris  
Teucrium canadense  
Thalictrum dasycarpum  
Thalictrum dioicum  
Tovara virginiana  
Trillium flexipes  
Uvularia sessilifolia  
Veronicastrum virginianum  
Viburnum lentago  
Viola canadensis  
Viola conspersa  
Viola cucullata  
Viola pubescens  
Vitis riparia  
Zanthoxylum americanum

Additional species:

*Aster lateriflorus*  
*Prunus virginiana*  
*Carex convoluta*  
*Cinna arundinacea*

Presence or Frequency  
(Common species only)

## FLOOD-PLAIN HARDWOODS

Stand No. 4075  
Quadrat No. 6

Adiantum pedatum  
Agrimonia grypsosepala  
Allium canadense  
Allium tricoccum  
Amphicarpa tracteada  
Anemone canadensis  
Anemone virginiana  
Aralia nudicaulis  
Arenaria lateriflora  
Arisaema atrorubens  
Arisaema dracontium  
Asarum canadense  
Aster lateriflorus  
Aster simplex  
Athyrium filix-femina  
Athyrium thelypteroides  
Boehmeria cylindrica  
Brachyelytrum erectum  
Caltha palustris  
Campanula americana  
Carex crinita  
Carex grayii  
Carex intumescens  
Carex lupulina  
Carex normalis  
Carex vupinoidea  
Cephalanthus occidentalis  
Cicuta maculata  
Circaea quadrisulcata  
Cirsium altissimum  
Convolvulus sepium  
Cornus femina  
Cornus obliqua  
Cornus rugosa  
Cornus stolonifera

Corylus americana  
Cryptotaenia canadensis  
Desmodium glutinosum  
Dioscorea villosa  
Echinocystis lobata  
Fragaria virginiana  
Galium aparine  
Galium concinnum  
Galium obtusum  
Galium triflorum  
Geranium maculatum  
Geum canadense  
Glyceria striata  
Hydrophyllum virginianum  
Ilex verticillata  
Impatiens capensis  
Iris virginica  
Lactuca biennis  
Laportea canadensis  
Leersia oryzoides  
Lobelia cardinalis  
Lycopus americanus  
Lycopus uniflorus  
Lysimachia ciliata  
Lysimachia nummularia  
Menispermum canadense  
Onoclea sensibilis  
Osmorhiza claytoni  
Osmorhiza longistylis  
Parthenocissus inserta  
Phlox divaricata  
Phryma leptostachya  
Physostegia virginiana  
Podophyllum peltatum  
Polemonium reptans

Polygonatum canaliculatum  
Prenanthes alba  
Ranunculus abortivus  
Ranunculus septentrionalis  
Rhus radicans  
Ribes americanum  
Ribes cynosbati  
Ribes missouriense  
Rorippa islandica  
Rudbeckia laciniata  
Rumex verticillatus  
Sambucus canadensis  
Sanguinaria canadensis  
Sanicula gregaria  
Smilacina racemosa  
Smilacina stellata  
Smilax ecirrhata  
Smilax herbacea  
Smilax tamnoides  
Solanum dulcamara  
Stachys palustris  
Teucrium canadense  
Thalictrum dasycarpum  
Thalictrum dioicum  
Tovara virginiana  
Trillium flexipes  
Uvularia sessilifolia  
Veronicastrum virginianum  
Viburnum lentago  
Viola canadensis  
Viola conspersa  
Viola cucullata  
Viola pubescens  
Vitis riparia  
Zanthoxylum americanum

Additional species:

Soft maple seedling  
Cinna arundinacea  
Viola conspersa  
Bromus horridus  
Carex cristatella  
Carex albursina

Presence or Frequency  
(Common species only)

## FLOOD-PLAIN HARDWOODS

Stand No. 4075  
Quadrat No. 7

<i>Adiantum pedatum</i>	<i>Corylus americana</i>	<i>Polygonatum canaliculatum</i>
<i>Agrimonia gryposepala</i>	<i>Cryptotaenia canadensis</i>	<i>Prenanthes alba</i>
<i>Allium canadense</i>	<i>Desmodium glutinosum</i>	<i>Ranunculus abortivus</i>
<i>Allium tricoccum</i>	<i>Dioscorea villosa</i>	<i>Ranunculus septentrionalis</i>
<i>Amphicarpa bracteata</i>	<i>Echinocystis lobata</i>	<i>Rhus radicans</i>
<i>Anemone canadensis</i>	<i>Fragaria virginiana</i>	<i>Ribes americanum</i>
<i>Anemone virginiana</i>	<i>Galium aparine</i>	<i>Ribes cynosbati</i>
<i>Aralia nudicaulis</i>	<i>Galium concinnum</i>	<i>Ribes missouriense</i>
<i>Arenaria lateriflora</i>	<i>Galium obtusum</i>	<i>Rorippa islandica</i>
<i>Arisaema atrorubens</i>	<i>Galium triflorum</i>	<i>Rudbeckia laciniata</i>
<i>Arisaema dracontium</i>	<i>Geranium maculatum</i>	<i>Rumex verticillatus</i>
<i>Asarum canadense</i>	<i>Geum canadense</i>	<i>Sambucus canadensis</i>
<i>Aster lateriflorus</i>	<i>Glyceria striata</i>	<i>Sanguinaria canadensis</i>
<i>Aster simplex</i>	<i>Hydrophyllum virginianum</i>	<i>Sanicula gregaria</i>
<i>Athyrium filix-femina</i>	<i>Ilex verticillata</i>	<i>Smilacina racemosa</i>
<i>Athyrium thelypteroides</i>	<i>Impatiens capensis</i>	<i>Smilacina stellata</i>
<i>Boehmeria cylindrica</i>	<i>Iris virginica</i>	<i>Smilax ecirrhata</i>
<i>Brachyelytrum erectum</i>	<i>Lactuca biennis</i>	<i>Smilax herbacea</i>
<i>Caltha palustris</i>	<i>Laportea canadensis</i>	<i>Smilax tamnoides</i>
<i>Campanula americana</i>	<i>Leersia oryzoides</i>	<i>Solanum dulcamara</i>
<i>Carex crinita</i>	<i>Lobelia cardinalis</i>	<i>Stachys palustris</i>
<i>Carex grayii</i>	<i>Lycopus americanus</i>	<i>Teucrium canadense</i>
<i>Carex intumescens</i>	<i>Lycopus uniflorus</i>	<i>Thalictrum dasycarpum</i>
<i>Carex lupulina</i>	<i>Lysimachia ciliata</i>	<i>Thalictrum dioicum</i>
<i>Carex normalis</i>	<i>Lysimachia nummularia</i>	<i>Tovara virginiana</i>
<i>Carex vupinoidea</i>	<i>Menispermum canadense</i>	<i>Trillium flexipes</i>
<i>Cephalanthus occidentalis</i>	<i>Onoclea sensibilis</i>	<i>Uvularia sessilifolia</i>
<i>Cicuta maculata</i>	<i>Osmorhiza claytoni</i>	<i>Veronicastrum virginianum</i>
<i>Circaea quadrisulcata</i>	<i>Osmorhiza longistylis</i>	<i>Viburnum lentago</i>
<i>Cirsium altissimum</i>	<i>Parthenocissus inserta</i>	<i>Viola canadensis</i>
<i>Convolvulus sepium</i>	<i>Phlox divaricata</i>	<i>Viola conspersa</i>
<i>Cornus femina</i>	<i>Phryma leptostachya</i>	<i>Viola cucullata</i>
<i>Cornus obliqua</i>	<i>Physostegia virginiana</i>	<i>Viola pubescens</i>
<i>Cornus rugosa</i>	<i>Podophyllum peltatum</i>	<i>Vitis riparia</i>
<i>Cornus stolonifera</i>	<i>Polemonium reptans</i>	<i>Zanthoxylum americanum</i>

Additional species:

*Black oak seedling*

Presence or Frequency  
(Common species only)

## FLOOD-PLAIN HARDWOODS

Stand No. 4075  
Quadrat No. 8

Adiantum pedatum  
Agrimonia grypsosepala  
Allium canadense  
Allium tricoccum  
Amphicarpa bracteata  
Anemone canadensis  
Anemone virginiana  
Aralia nudicaulis  
Arenaria lateriflora  
Arisaema atrorubens  
Arisaema dracontium  
Asarum canadense  
Aster lateriflorus  
Aster simplex  
Athyrium filix-femina  
Athyrium thelypteroides  
Boehmeria cylindrica  
Brachyelytrum erectum  
Caltha palustris  
Campanula americana  
Carex crinita  
Carex grayii  
Carex intumescens  
Carex lupulina  
Carex normalis  
Carex vupinoidea  
Cephalanthus occidentalis  
Cicuta maculata  
Circaea quadrisulcata  
Cirsium altissimum  
Convolvulus sepium  
Cornus femina  
Cornus obliqua  
Cornus rugosa  
Cornus stolonifera

Corylus americana  
Cryptotaenia canadensis  
Desmodium glutinosum  
Dioscorea villosa  
Echinocystis lobata  
Fragaria virginiana  
Galium aparine  
Galium concinnum  
Galium obtusum  
Galium triflorum  
Geranium maculatum  
Geum canadense  
Glyceria striata  
Hydrophyllum virginianum  
Ilex verticillata  
Impatiens capensis  
Iris virginica  
Lactuca biennis  
Laportea canadensis  
Leersia oryzoides  
Lobelia cardinalis  
Lycopus americanus  
Lycopus uniflorus  
Lysimachia ciliata  
Lysimachia nummularia  
Menispermum canadense  
Onoclea sensibilis  
Osmorhiza claytoni  
Osmorhiza longistylis  
Parthenocissus inserta  
Phlox divaricata  
Phryma leptostachya  
Physostegia virginiana  
Podophyllum peltatum  
Polemonium reptans

Polygonatum canaliculatum  
Prenanthes alba  
Ranunculus abortivus  
Ranunculus septentrionalis  
Rhus radicans  
Ribes americanum  
Ribes cynosbati  
Ribes missouriense  
Rorippa islandica  
Rudbeckia laciniata  
Rumex verticillatus  
Sambucus canadensis  
Sanguinaria canadensis  
Sanicula gregaria  
Smilacina racemosa  
Smilacina stellata  
Smilax ecirrhata  
Smilax herbacea  
Smilax tannoides  
Solanum dulcamara  
Stachys palustris  
Teucrium canadense  
Thalictrum dasycarpum  
Thalictrum dioicum  
Tovara virginiana  
Trillium flexipes  
Uvularia sessilifolia  
Veronicastrum virginianum  
Viburnum lentago  
Viola canadensis  
Viola conspersa  
Viola cucullata  
Viola pubescens  
Vitis riparia  
Zanthoxylum americanum

Additional species:

Carex complanata  
Sphalagnum zigzagum  
Bromus latifolius  
24 m 9/8

Aster puniceus



Presence or Frequency  
(Common species only)

## FLOOD-PLAIN HARDWOODS

Stand No. 4075  
Quadrat No. 9

<i>Adiantum pedatum</i>	<i>Corylus americana</i>	<i>Polygonatum canaliculatum</i>
<i>Agrimonia gryposepala</i>	<i>Cryptotaenia canadensis</i>	<i>Prenanthes alba</i>
<i>Allium canadense</i>	<i>Desmodium glutinosum</i>	<i>Ranunculus abortivus</i>
<i>Allium tricoccum</i>	<i>Dioscorea villosa</i>	<i>Ranunculus septentrionalis</i>
<i>Amphicarpa bracteata</i>	<i>Echinocystis lobata</i>	<i>Rhus radicans</i>
<i>Anemone canadensis</i>	<i>Fragaria virginiana</i>	<i>Ribes americanum</i>
<i>Anemone virginiana</i>	<i>Galium aparine</i>	<i>Ribes cynosbati</i>
<i>Aralia nudicaulis</i>	<i>Galium concinnum</i>	<i>Ribes missouriense</i>
<i>Arenaria lateriflora</i>	<i>Galium obtusum</i>	<i>Rorippa islandica</i>
<i>Arisaema atrorubens</i>	<i>Galium triflorum</i>	<i>Rudbeckia laciniata</i>
<i>Arisaema dracontium</i>	<i>Geranium maculatum</i>	<i>Rumex verticillatus</i>
<i>Asarum canadense</i>	<i>Geum canadense</i>	<i>Sambucus canadensis</i>
<i>Aster lateriflorus</i>	<i>Glyceria striata</i>	<i>Sanguinaria canadensis</i>
<i>Aster simplex</i>	<i>Hydrophyllum virginianum</i>	<i>Sanicula gregaria</i>
<i>Athyrium filix-femina</i>	<i>Ilex verticillata</i>	<i>Smilacina racemosa</i>
<i>Athyrium thelypteroides</i>	<i>Impatiens capensis</i>	<i>Smilacina stellata</i>
<i>Boehmeria cylindrica</i>	<i>Iris virginica</i>	<i>Smilax ecirrhata</i>
<i>Brachyelytrum erectum</i>	<i>Lactuca biennis</i>	<i>Smilax herbacea</i>
<i>Caitha palustris</i>	<i>Laportea canadensis</i>	<i>Smilax tannoides</i>
<i>Campanula americana</i>	<i>Leersia oryzoides</i>	<i>Solanum dulcamara</i>
<i>Carex crinita</i>	<i>Lobelia cardinalis</i>	<i>Stachys palustris</i>
<i>Carex grayii</i>	<i>Lycopus americanus</i>	<i>Teucrium canadense</i>
<i>Carex intumescens</i>	<i>Lycopus uniflorus</i>	<i>Thalictrum dasycarpum</i>
<i>Carex lupulina</i>	<i>Lysimachia ciliata</i>	<i>Thalictrum dioicum</i>
<i>Carex normalis</i>	<i>Lysimachia nummularia</i>	<i>Tovara virginiana</i>
<i>Carex vupinoidea</i>	<i>Menispermum canadense</i>	<i>Trillium flexipes</i>
<i>Cephalanthus occidentalis</i>	<i>Onoclea sensibilis</i>	<i>Uvularia sessilifolia</i>
<i>Cicuta maculata</i>	<i>Osmorhiza claytoni</i>	<i>Veronicastrum virginianum</i>
<i>Circaea quadrisulcata</i>	<i>Osmorhiza longistylis</i>	<i>Viburnum lentago</i>
<i>Cirsium altissimum</i>	<i>Parthenocissus inserta</i>	<i>Viola canadensis</i>
<i>Convolvulus sepium</i>	<i>Phlox divaricata</i>	<i>Viola conspersa</i>
<i>Cornus femina</i>	<i>Phryma leptostachya</i>	<i>Viola cucullata</i>
<i>Cornus obliqua</i>	<i>Physostegia virginiana</i>	<i>Viola pubescens</i>
<i>Cornus rugosa</i>	<i>Podophyllum peltatum</i>	<i>Vitis riparia</i>
<i>Cornus stolonifera</i>	<i>Polemonium reptans</i>	<i>Zanthoxylum americanum</i>

Additional species:

*Viola conspersa*  
*Prunus latiflorus*  
*Carex cristatella*  
Black ash seedling  
*Quercus bicolor*  
*Prunus virginiana*

Presence or Frequency  
(Common species only)

## FLOOD-PLAIN HARDWOODS

Stand No. 4075  
Quadrat No. 10

<i>Adiantum pedatum</i>	<i>Corylus americana</i>	<i>Polygonatum canaliculatum</i>
<i>Agrimonia gryposepala</i>	<i>Cryptotaenia canadensis</i>	<i>Prenanthes alba</i>
<i>Allium canadense</i>	<i>Desmodium glutinosum</i>	<i>Ranunculus abortivus</i>
<i>Allium tricoccum</i>	<i>Dioscorea villosa</i>	<i>Ranunculus septentrionalis</i>
<i>Amphicarpa bracteata</i>	<i>Echinocystis lobata</i>	<i>Rhus radicans</i>
<i>Anemone canadensis</i>	<i>Fragaria virginiana</i>	<i>Ribes americanum</i>
<i>Anemone virginiana</i>	<i>Galium aparine</i>	<i>Ribes cynosbati</i>
<i>Aralia nudicaulis</i>	<i>Galium concinnum</i>	<i>Ribes missouriense</i>
<i>Arenaria lateriflora</i>	<i>Galium obtusum</i>	<i>Rorippa islandica</i>
<i>Arisaema atrorubens</i>	<i>Galium triflorum</i>	<i>Rudbeckia laciniata</i>
<i>Arisaema dracontium</i>	<i>Geranium maculatum</i>	<i>Rumex verticillatus</i>
<i>Asarum canadense</i>	<i>Geum canadense</i>	<i>Sambucus canadensis</i>
<i>Aster lateriflorus</i>	<i>Glyceria striata</i>	<i>Sanguinaria canadensis</i>
<i>Aster simplex</i>	<i>Hydrophyllum virginianum</i>	<i>Sanicula gregaria</i>
<i>Athyrium filix-femina</i>	<i>Ilex verticillata</i>	<i>Smilacina racemosa</i>
<i>Athyrium thelypteroides</i>	<i>Impatiens capensis</i>	<i>Smilacina stellata</i>
<i>Boehmeria cylindrica</i>	<i>Iris virginica</i>	<i>Smilax ecirrhata</i>
<i>Brachyelytrum erectum</i>	<i>Lactuca biennis</i>	<i>Smilax herbacea</i>
<i>Caltha palustris</i>	<i>Laportea canadensis</i>	<i>Smilax tannoides</i>
<i>Campanula americana</i>	<i>Leersia oryzoides</i>	<i>Solanum dulcamara</i>
<i>Carex crinita</i>	<i>Lobelia cardinalis</i>	<i>Stachys palustris</i>
<i>Carex grayii</i>	<i>Lycopus americanus</i>	<i>Teucrium canadense</i>
<i>Carex intumescens</i>	<i>Lycopus uniflorus</i>	<i>Thalictrum dasycarpum</i>
<i>Carex lupulina</i>	<i>Lysimachia ciliata</i>	<i>Thalictrum dioicum</i>
<i>Carex normalis</i>	<i>Lysimachia nummularia</i>	<i>Tovara virginiana</i>
<i>Carex vupinoidea</i>	<i>Menispermum canadense</i>	<i>Trillium flexipes</i>
<i>Cephalanthus occidentalis</i>	<i>Onoclea sensibilis</i>	<i>Uvularia sessilifolia</i>
<i>Cicuta maculata</i>	<i>Osmorhiza claytoni</i>	<i>Veronicastrum virginianum</i>
<i>Circaea quadrisulcata</i>	<i>Osmorhiza longistylis</i>	<i>Viburnum lentago</i>
<i>Cirsium altissimum</i>	<i>Parthenocissus inserta</i>	<i>Viola canadensis</i>
<i>Convolvulus sepium</i>	<i>Phlox divaricata</i>	<i>Viola conspersa</i>
<i>Cornus femina</i>	<i>Phryma leptostachya</i>	<i>Viola cucullata</i>
<i>Cornus obliqua</i>	<i>Physostegia virginiana</i>	<i>Viola pubescens</i>
<i>Cornus rugosa</i>	<i>Podophyllum peltatum</i>	<i>Vitis riparia</i>
<i>Cornus stolonifera</i>	<i>Polemonium reptans</i>	<i>Zanthoxylum americanum</i>

Additional species:

*Bromus horridus*  
Black ash seedling  
*Carex convoluta*  
A m ash  
*Cinna arund.*  
*Viola edithae*

Presence or Frequency  
(Common species only)

## FLOOD-PLAIN HARDWOODS

Stand No. 4075  
Quadrat No. 11

<i>Adiantum pedatum</i>	<i>Corylus americana</i>	<i>Polygonatum canaliculatum</i>
<i>Agrimonia gryposepala</i>	<i>Cryptotaenia canadensis</i>	<i>Prenanthes alba</i>
<i>Allium canadense</i>	<i>Desmodium glutinosum</i>	<i>Ranunculus abortivus</i>
<i>Allium tricoccum</i>	<i>Dioscorea villosa</i>	<i>Ranunculus septentrionalis</i>
<i>Amphicarpa bracteata</i>	<i>Echinocystis lobata</i>	<i>Rhus radicans</i>
<i>Anemone canadensis</i>	<i>Fragaria virginiana</i>	<i>Ribes americanum</i>
<i>Anemone virginiana</i>	<i>Galium aparine</i>	<i>Ribes cynosbati</i>
<i>Aralia nudicaulis</i>	<i>Galium concinnum</i>	<i>Ribes missouriense</i>
<i>Arenaria lateriflora</i>	<i>Galium obtusum</i>	<i>Rorippa islandica</i>
<i>Arisaema atrorubens</i>	<i>Galium triflorum</i>	<i>Rudbeckia laciniata</i>
<i>Arisaema dracontium</i>	<i>Geranium maculatum</i>	<i>Rumex verticillatus</i>
<i>Asarum canadense</i>	<i>Geum canadense</i>	<i>Sambucus canadensis</i>
<i>Aster lateriflorus</i>	<i>Glyceria striata</i>	<i>Sanguinaria canadensis</i>
<i>Aster simplex</i>	<i>Hydrophyllum virginianum</i>	<i>Sanicula gregaria</i>
<i>Athyrium filix-femina</i>	<i>Ilex verticillata</i>	<i>Smilacina racemosa</i>
<i>Athyrium thelypteroides</i>	<i>Impatiens capensis</i>	<i>Smilacina stellata</i>
<i>Boehmeria cylindrica</i>	<i>Iris virginica</i>	<i>Smilax ecirrhata</i>
<i>Brachyelytrum erectum</i>	<i>Lactuca biennis</i>	<i>Smilax herbacea</i>
<i>Caltha palustris</i>	<i>Laportea canadensis</i>	<i>Smilax tannoides</i>
<i>Campanula americana</i>	<i>Leersia oryzoides</i>	<i>Solanum dulcamara</i>
<i>Carex crinita</i>	<i>Lobelia cardinalis</i>	<i>Stachys palustris</i>
<i>Carex grayii</i>	<i>Lycopus americanus</i>	<i>Teucrium canadense</i>
<i>Carex intumescens</i>	<i>Lycopus uniflorus</i>	<i>Thalictrum dasycarpum</i>
<i>Carex lupulina</i>	<i>Lysimachia ciliata</i>	<i>Thalictrum dioicum</i>
<i>Carex normalis</i>	<i>Lysimachia nummularia</i>	<i>Tovara virginiana</i>
<i>Carex vupinoidea</i>	<i>Menispermum canadense</i>	<i>Trillium flexipes</i>
<i>Cephalanthus occidentalis</i>	<i>Onoclea sensibilis</i>	<i>Uvularia sessilifolia</i>
<i>Cicuta maculata</i>	<i>Osmorhiza claytoni</i>	<i>Veronicastrum virginianum</i>
<i>Circaea quadrisulcata</i>	<i>Osmorhiza longistylis</i>	<i>Viburnum lentago</i>
<i>Cirsium altissimum</i>	<i>Parthenocissus inserta</i>	<i>Viola canadensis</i>
<i>Convolvulus sepium</i>	<i>Phlox divaricata</i>	<i>Viola conspersa</i>
<i>Cornus femina</i>	<i>Phryma leptostachya</i>	<i>Viola cucullata</i>
<i>Cornus obliqua</i>	<i>Physostegia virginiana</i>	<i>Viola pubescens</i>
<i>Cornus rugosa</i>	<i>Podophyllum peltatum</i>	<i>Vitis riparia</i>
<i>Cornus stolonifera</i>	<i>Polemonium reptans</i>	<i>Zanthoxylum americanum</i>

Additional species:

*elm seedling*  
*Symphoricarpos fetida*  
*Am. ash*  
*Viola collina*

Presence or Frequency  
(Common species only)

## FLOOD-PLAIN HARDWOODS

Stand No. 4075  
Quadrat No. 12

<i>Adiantum pedatum</i>	<i>Corylus americana</i>	<i>Polygonatum canaliculatum</i>
<i>Agrimonia gryposepala</i>	<i>Cryptotaenia canadensis</i>	<i>Prenanthes alba</i>
<i>Allium canadense</i>	<i>Desmodium glutinosum</i>	<i>Ranunculus abortivus</i>
<i>Allium tricoccum</i>	<i>Dioscorea villosa</i>	<i>Ranunculus septentrionalis</i>
<i>Amphicarpa bracteata</i>	<i>Echinocystis lobata</i>	<i>Rhus radicans</i>
<i>Anemone canadensis</i>	<i>Fragaria virginiana</i>	<i>Ribes americanum</i>
<i>Anemone virginiana</i>	<i>Galium aparine</i>	<i>Ribes cynosbati</i>
<i>Aralia nudicaulis</i>	<i>Galium concinnum</i>	<i>Ribes missouriense</i>
<i>Arenaria lateriflora</i>	<i>Galium obtusum</i>	<i>Rorippa islandica</i>
<i>Arisaema atrorubens</i>	<i>Galium triflorum</i>	<i>Rudbeckia laciniata</i>
<i>Arisaema dracontium</i>	<i>Geranium maculatum</i>	<i>Rumex verticillatus</i>
<i>Asarum canadense</i>	<i>Geum canadense</i>	<i>Sambucus canadensis</i>
<i>Aster lateriflorus</i>	<i>Glyceria striata</i>	<i>Sanguinaria canadensis</i>
<i>Aster simplex</i>	<i>Hydrophyllum virginianum</i>	<i>Sanicula gregaria</i>
<i>Athyrium filix-femina</i>	<i>Ilex verticillata</i>	<i>Smilacina racemosa</i>
<i>Athyrium thelypteroides</i>	<i>Impatiens capensis</i>	<i>Smilacina stellata</i>
<i>Boehmeria cylindrica</i>	<i>Iris virginica</i>	<i>Smilax ecirrhata</i>
<i>Brachyelytrum erectum</i>	<i>Lactuca biennis</i>	<i>Smilax herbacea</i>
<i>Caitha palustris</i>	<i>Laportea canadensis</i>	<i>Smilax tamnoides</i>
<i>Campanula americana</i>	<i>Leersia oryzoides</i>	<i>Solanum dulcamara</i>
<i>Carex crinita</i>	<i>Lobelia cardinalis</i>	<i>Stachys palustris</i>
<i>Carex grayii</i>	<i>Lycopus americanus</i>	<i>Teucrium canadense</i>
<i>Carex intumescens</i>	<i>Lycopus uniflorus</i>	<i>Thalictrum dasycarpum</i>
<i>Carex lupulina</i>	<i>Lysimachia ciliata</i>	<i>Thalictrum dioicum</i>
<i>Carex normalis</i>	<i>Lysimachia nummularia</i>	<i>Tovara virginiana</i>
<i>Carex vupinoidea</i>	<i>Menispermum canadense</i>	<i>Trillium flexipes</i>
<i>Cephalanthus occidentalis</i>	<i>Oncoclea sensibilis</i>	<i>Uvularia sessilifolia</i>
<i>Cicuta maculata</i>	<i>Osmorhiza claytoni</i>	<i>Veronicastrum virginianum</i>
<i>Circaea quadrisulcata</i>	<i>Osmorhiza longistylis</i>	<i>Viburnum lentago</i>
<i>Cirsium altissimum</i>	<i>Parthenocissus inserta</i>	<i>Viola canadensis</i>
<i>Convolvulus sepium</i>	<i>Phlox divaricata</i>	<i>Viola conspersa</i>
<i>Cornus femina</i>	<i>Phryma leptostachya</i>	<i>Viola cucullata</i>
<i>Cornus obliqua</i>	<i>Physostegia virginiana</i>	<i>Viola pubescens</i>
<i>Cornus rugosa</i>	<i>Podophyllum peltatum</i>	<i>Vitis riparia</i>
<i>Cornus stolonifera</i>	<i>Polemonium reptans</i>	<i>Zanthoxylum americanum</i>

Additional species:

*V. ulm. canadensis*

Presence or Frequency  
(Common species only)

## FLOOD-PLAIN HARDWOODS

Stand No. 4075  
Quadrat No. 13

Adiantum pedatum  
Agrimonia grypsosepala  
Allium canadense  
Allium tricoccum  
Amphicarpa bracteata  
Anemone canadensis  
Anemone virginiana  
Aralia nudicaulis  
Arenaria lateriflora  
Arisaema atrorubens  
Arisaema dracontium  
Asarum canadense  
Aster lateriflorus  
Aster simplex  
Athyrium filix-femina  
Athyrium thelypteroides  
Boehmeria cylindrica  
Brachyelytrum erectum  
Caltha palustris  
Campanula americana  
Carex crinita  
Carex grayii  
Carex intumescens  
Carex lupulina  
Carex normalis  
Carex vupinoidea  
Cephalanthus occidentalis  
Cicuta maculata  
Circaea quadrisulcata  
Cirsium altissimum  
Convolvulus sepium  
Cornus femina  
Cornus obliqua  
Cornus rugosa  
Cornus stolonifera

Corylus americana  
Cryptotaenia canadensis  
Desmodium glutinosum  
Dioscorea villosa  
Echinocystis lobata  
Fragaria virginiana  
Galium aparine  
Galium concinnum  
Galium obtusum  
Galium triflorum  
Geranium maculatum  
Geum canadense  
Glyceria striata  
Hydrophyllum virginianum  
Ilex verticillata  
Impatiens capensis  
Iris virginica  
Lactuca biennis  
Laportea canadensis  
Leersia oryzoides  
Lobelia cardinalis  
Lycopus americanus  
Lycopus uniflorus  
Lysimachia ciliata  
Lysimachia nummularia  
Menispermum canadense  
Onoclea sensibilis  
Osmorhiza claytoni  
Osmorhiza longistylis  
Parthenocissus inserta  
Phlox divaricata  
Phryma leptostachya  
Physostegia virginiana  
Podophyllum peltatum  
Polemonium reptans

Polygonatum canaliculatum  
Prenanthes alba  
Ranunculus abortivus  
Ranunculus septentrionalis  
Rhus radicans  
Ribes americanum  
Ribes cynosbati  
Ribes missouriense  
Rorippa islandica  
Rudbeckia laciniata  
Rumex verticillatus  
Sambucus canadensis  
Sanguinaria canadensis  
Sanicula gregaria  
Smilacina racemosa  
Smilacina stellata  
Smilax ecirrhata  
Smilax herbacea  
Smilax tamnoides  
Solanum dulcamara  
Stachys palustris  
Teucrium canadense  
Thalictrum dasycarpum  
Thalictrum dioicum  
Tovara virginiana  
Trillium flexipes  
Uvularia sessilifolia  
Veronicastrum virginianum  
Viburnum lentago  
Viola canadensis  
Viola conspersa  
Viola cucullata  
Viola pubescens  
Vitis riparia  
Zanthoxylum americanum

Additional species:

elm

Presence or Frequency  
(Common species only)

## FLOOD-PLAIN HARDWOODS

Stand No. 4075  
Quadrat No. 14

<i>Adiantum pedatum</i>	<i>Corylus americana</i>	<i>Polygonatum canaliculatum</i>
<i>Agrimonia gryposepala</i>	<i>Cryptotaenia canadensis</i>	<i>Prenanthes alba</i>
<i>Allium canadense</i>	<i>Desmodium glutinosum</i>	<i>Ranunculus abortivus</i>
<i>Allium tricoccum</i>	<i>Dioscorea villosa</i>	<i>Ranunculus septentrionalis</i>
<i>Amphicarpa bracteata</i>	<i>Echinocystis lobata</i>	<i>Rhus radicans</i>
<i>Anemone canadensis</i>	<i>Fragaria virginiana</i>	<i>Ribes americanum</i>
<i>Anemone virginiana</i>	<i>Galium aparine</i>	<i>Ribes cynosbati</i>
<i>Aralia nudicaulis</i>	<i>Galium concinnum</i>	<i>Ribes missouriense</i>
<i>Arenaria lateriflora</i>	<i>Galium obtusum</i>	<i>Rorippa islandica</i>
<i>Arisaema atrorubens</i>	<i>Galium triflorum</i>	<i>Rudbeckia laciniata</i>
<i>Arisaema dracontium</i>	<i>Geranium maculatum</i>	<i>Rumex verticillatus</i>
<i>Asarum canadense</i>	<i>Geum canadense</i>	<i>Sambucus canadensis</i>
<i>Aster lateriflorus</i>	<i>Glyceria striata</i>	<i>Sanguinaria canadensis</i>
<i>Aster simplex</i>	<i>Hydrophyllum virginianum</i>	<i>Sanicula gregaria</i>
<i>Athyrium filix-femina</i>	<i>Ilex verticillata</i>	<i>Smilacina racemosa</i>
<i>Athyrium thelypteroides</i>	<i>Impatiens capensis</i>	<i>Smilacina stellata</i>
<i>Boehmeria cylindrica</i>	<i>Iris virginica</i>	<i>Smilax ecirrhata</i>
<i>Brachyelytrum erectum</i>	<i>Lactuca biennis</i>	<i>Smilax herbacea</i>
<i>Caltha palustris</i>	<i>Laportea canadensis</i>	<i>Smilax tamnoides</i>
<i>Campanula americana</i>	<i>Leersia oryzoides</i>	<i>Solanum dulcamara</i>
<i>Carex crinita</i>	<i>Lobelia cardinalis</i>	<i>Stachys palustris</i>
<i>Carex grayii</i>	<i>Lycopus americanus</i>	<i>Teucrium canadense</i>
<i>Carex intumescens</i>	<i>Lycopus uniflorus</i>	<i>Thalictrum dasycarpum</i>
<i>Carex lupulina</i>	<i>Lysimachia ciliata</i>	<i>Thalictrum dioicum</i>
<i>Carex normalis</i>	<i>Lysimachia nummularia</i>	<i>Tovara virginiana</i>
<i>Carex vupinoidea</i>	<i>Menispermum canadense</i>	<i>Trillium flexipes</i>
<i>Cephalanthus occidentalis</i>	<i>Onoclea sensibilis</i>	<i>Uvularia sessilifolia</i>
<i>Cicuta maculata</i>	<i>Osmorhiza claytoni</i>	<i>Veronicastrum virginianum</i>
<i>Circaea quadrisulcata</i>	<i>Osmorhiza longistylis</i>	<i>Viburnum lentago</i>
<i>Cirsium altissimum</i>	<i>Parthenocissus inserta</i>	<i>Viola canadensis</i>
<i>Convolvulus sepium</i>	<i>Phlox divaricata</i>	<i>Viola conspersa</i>
<i>Cornus femina</i>	<i>Phryma leptostachya</i>	<i>Viola cucullata</i>
<i>Cornus obliqua</i>	<i>Physostegia virginiana</i>	<i>Viola pubescens</i>
<i>Cornus rugosa</i>	<i>Podophyllum peltatum</i>	<i>Vitis riparia</i>
<i>Cornus stolonifera</i>	<i>Polemonium reptans</i>	<i>Zanthoxylum americanum</i>

Additional species:

*Bromus latiglumis*  
elm  
orange white oak

Presence or Frequency  
(Common species only)

## FLOOD-PLAIN HARDWOODS

Stand No. 4075  
Quadrat No. 15

Adiantum pedatum  
Agrimonia grypsosepala  
Allium canadense  
Allium tricoccum  
Amphicarpa bracteata  
Anemone canadensis  
Anemone virginiana  
Aralia nudicaulis  
Arenaria lateriflora  
Arisaema atrorubens  
Arisaema dracontium  
Asarum canadense  
Aster lateriflorus  
Aster simplex  
Athyrium filix-femina  
Athyrium thelypteroides  
Boehmeria cylindrica  
Brachyelytrum erectum  
Caltha palustris  
Campanula americana  
Carex crinita  
Carex grayii  
Carex intumescens  
Carex lupulina  
Carex normalis  
Carex vupinoidea  
Cephalanthus occidentalis  
Cicuta maculata  
Circaea quadrisulcata  
Cirsium altissimum  
Convolvulus sepium  
Cornus femina  
Cornus obliqua  
Cornus rugosa  
Cornus stolonifera

Corylus americana  
Cryptotaenia canadensis  
Desmodium glutinosum  
Dioscorea villosa  
Echinocystis lobata  
Fragaria virginiana  
Galium aparine  
Galium concinnum  
Galium obtusum  
Galium triflorum  
Geranium maculatum  
Geum canadense  
Glyceria striata  
Hydrophyllum virginianum  
Ilex verticillata  
Impatiens capensis  
Iris virginica  
Lactuca biennis  
Laportea canadensis  
Leersia oryzoides  
Lobelia cardinalis  
Lycopus americanus  
Lycopus uniflorus  
Lysimachia ciliata  
Lysimachia nummularia  
Menispermum canadense  
Onoclea sensibilis  
Osmorhiza claytoni  
Osmorhiza longistylis  
Parthenocissus inserta  
Phlox divaricata  
Phryma leptostachya  
Physostegia virginiana  
Podophyllum peltatum  
Polemonium reptans

Polygonatum canaliculatum  
Prenanthes alba  
Ranunculus abortivus  
Ranunculus septentrionalis  
Rhus radicans  
Ribes americanum  
Ribes cynosbati  
Ribes missouriense  
Rorippa islandica  
Rudbeckia laciniata  
Rumex verticillatus  
Sambucus canadensis  
Sanguinaria canadensis  
Sanicula gregaria  
Smilacina racemosa  
Smilacina stellata  
Smilax ecirrhata  
Smilax herbacea  
Smilax tamnoides  
Solanum dulcamara  
Stachys palustris  
Teucrium canadense  
Thalictrum dasycarpum  
Thalictrum dioicum  
Tovara virginiana  
Trillium flexipes  
Uvularia sessilifolia  
Veronicastrum virginianum  
Viburnum lentago  
Viola canadensis  
Viola conspersa  
Viola cucullata  
Viola pubescens  
Vitis riparia  
Zanthoxylum americanum

Additional species:

elm  
syc maple  
Viola conspersa  
black ash seedling

Presence or Frequency  
(Common species only)

## FLOOD-PLAIN HARDWOODS

Stand No. 4075  
Quadrat No. 16

Adiantum pedatum  
Agrimonia grypsosepala  
Allium canadense  
Allium tricoccum  
Amphicarpa bracteata  
Anemone canadensis  
Anemone virginiana  
Aralia nudicaulis  
Arenaria lateriflora  
Arisaema atrorubens  
Arisaema dracontium  
Asarum canadense  
Aster lateriflorus  
Aster simplex  
Athyrium filix-femina  
Athyrium thelypteroides  
Boehmeria cylindrica  
Brachyelytrum erectum  
Caltha palustris  
Campanula americana  
Carex crinita  
Carex grayii  
Carex intumescens  
Carex lupulina  
Carex normalis  
Carex vupinoidea  
Cephalanthus occidentalis  
Cicuta maculata  
Circaea quadrisulcata  
Cirsium altissimum  
Convolvulus sepium  
Cornus femina  
Cornus obliqua  
Cornus rugosa  
Cornus stolonifera

Corylus americana  
Cryptotaenia canadensis  
Desmodium glutinosum  
Dioscorea villosa  
Echinocystis lobata  
Fragaria virginiana  
Galium aparine  
Galium concinnum  
Galium obtusum  
Galium triflorum  
Geranium maculatum  
Geum canadense  
Glyceria striata  
Hydrophyllum virginianum  
Ilex verticillata  
Impatiens capensis  
Iris virginica  
Lactuca biennis  
Laportea canadensis  
Leersia oryzoides  
Lobelia cardinalis  
Lycopus americanus  
Lycopus uniflorus  
Lysimachia ciliata  
Lysimachia nummularia  
Menispermum canadense  
Onoclea sensibilis  
Osmorhiza claytoni  
Osmorhiza longistylis  
Parthenocissus inserta  
Phlox divaricata  
Phryma leptostachya  
Physostegia virginiana  
Podophyllum peltatum  
Polemonium reptans

Polygonatum canaliculatum  
Prenanthes alba  
Ranunculus abortivus  
Ranunculus septentrionalis  
Rhus radicans  
Ribes americanum  
Ribes cynosbati  
Ribes missouriense  
Rorippa islandica  
Rudbeckia laciniata  
Rumex verticillatus  
Sambucus canadensis  
Sanguinaria canadensis  
Sanicula gregaria  
Smilacina racemosa  
Smilacina stellata  
Smilax ecirrhata  
Smilax herbacea  
Smilax tamnoides  
Solanum dulcamara  
Stachys palustris  
Teucrium canadense  
Thalictrum dasycarpum  
Thalictrum dioicum  
Tovara virginiana  
Trillium flexipes  
Uvularia sessilifolia  
Veronicastrum virginianum  
Viburnum lentago  
Viola canadensis  
Viola conspersa  
Viola cucullata  
Viola pubescens  
Vitis riparia  
Zanthoxylum americanum

Additional species:

Ann. ad  
Carex cristatella  
Aster lateriflorus  
etc.  
Cirsium arvense  
Bromus latiflorus



Presence or Frequency  
(Common species only)

## FLOOD-PLAIN HARDWOODS

Stand No. 4075  
Quadrat No. 17

Adiantum pedatum	Corylus americana	Polygonatum canaliculatum
Agrimonia gryposepala	Cryptotaenia canadensis	Prenanthes alba
Allium canadense	Desmodium glutinosum	Ranunculus abortivus
Allium tricoccum	Dioscorea villosa	Ranunculus septentrionalis
Amphicarpa bracteata	Echinocystis lobata	Rhus radicans
Anemone canadensis	Fragaria virginiana	Ribes americanum
Anemone virginiana	Galium aparine	Ribes cynosbati
Aralia nudicaulis	Galium concinnum	Ribes missouriense
Arenaria lateriflora	Galium obtusum	Rorippa islandica
Arisaema atrorubens	Galium triflorum	Rudbeckia laciniata
Arisaema dracontium	Geranium maculatum	Rumex verticillatus
Asarum canadense	Geum canadense	Sambucus canadensis
Aster lateriflorus	Glyceria striata	Sanguinaria canadensis
Aster simplex	Hydrophyllum virginianum	Sanicula gregaria
Athyrium filix-femina	Ilex verticillata	Smilacina racemosa
Athyrium thelypteroides	Impatiens capensis	Smilacina stellata
Boehmeria cylindrica	Iris virginica	Smilax ecirrhata
Brachyelytrum erectum	Lactuca biennis	Smilax herbacea
Caltha palustris	Laportea canadensis	Smilax tamnoides
Campanula americana	Leersia oryzoides	Solanum dulcamara
Carex crinita	Lobelia cardinalis	Stachys palustris
Carex grayii	Lycopus americanus	Teucrium canadense
Carex intumescens	Lycopus uniflorus	Thalictrum dasycarpum
Carex lupulina	Lysimachia ciliata	Thalictrum dioicum
Carex normalis	Lysimachia nummularia	Tovara virginiana
Carex vupinoidea	Menispermum canadense	Trillium flexipes
Cephalanthus occidentalis	Oncoclea sensibilis	Uvularia sessilifolia
Cicuta maculata	Osmorhiza claytoni	Veronicastrum virginianum
Circaea quadrisulcata	Osmorhiza longistylis	Viburnum lentago
Cirsium altissimum	Parthenocissus inserta	Viola canadensis
Convolvulus sepium	Phlox divaricata	Viola conspersa
Cornus femina	Phryma leptostachya	Viola cucullata
Cornus obliqua	Physostegia virginiana	Viola pubescens
Cornus rugosa	Podophyllum peltatum	Vitis riparia
Cornus stolonifera	Polemonium reptans	Zanthoxylum americanum

Additional species:

Black ash seedling

Presence or Frequency  
(Common species only)

## FLOOD-PLAIN HARDWOODS

Stand No. 4075  
Quadrat No. 18

Adiantum pedatum	Corylus americana	Polygonatum canaliculatum
Agrimonia grypsosepala	Cryptotaenia canadensis	Prenanthes alba
Allium canadense	Desmodium glutinosum	Ranunculus abortivus
Allium tricoccum	Dioscorea villosa	Ranunculus septentrionalis
Amphicarpa bracteata	Echinocystis lobata	Rhus radicans
Anemone canadensis	Fragaria virginiana	Ribes americanum
Anemone virginiana	Galium aparine	Ribes cynosbati
Aralia nudicaulis	Galium concinnum	Ribes missouriense
Arenaria lateriflora	Galium obtusum	Rorippa islandica
Arisaema atrorubens	Galium triflorum	Rudbeckia laciniata
Arisaema dracontium	Geranium maculatum	Rumex verticillatus
Asarum canadense	Geum canadense	Sambucus canadensis
Aster lateriflorus	Glyceria striata	Sanguinaria canadensis
Aster simplex	Hydrophyllum virginianum	Sanicula gregaria
Athyrium filix-femina	Ilex verticillata	Smilacina racemosa
Athyrium thelypteroides	Impatiens capensis	Smilacina stellata
Boehmeria cylindrica	Iris virginica	Smilax ecirrhata
Brachyelytrum erectum	Lactuca biennis	Smilax herbacea
Caltha palustris	Laportea canadensis	Smilax tamnoides
Campanula americana	Leersia oryzoides	Solanum dulcamara
Carex crinita	Lobelia cardinalis	Stachys palustris
Carex grayii	Lycopus americanus	Teucrium canadense
Carex intumescens	Lycopus uniflorus	Thalictrum dasycarpum
Carex lupulina	Lysimachia ciliata	Thalictrum dioicum
Carex normalis	Lysimachia nummularia	Tovara virginiana
Carex vupinoidea	Menispermum canadense	Trillium flexipes
Cephalanthus occidentalis	Onoclea sensibilis	Uvularia sessilifolia
Cicuta maculata	Osmorhiza claytoni	Veronicastrum virginianum
Circaea quadrisulcata	Osmorhiza longistylis	Viburnum lentago
Cirsium altissimum	Parthenocissus inserta	Viola canadensis
Convolvulus sepium	Phlox divaricata	Viola conspersa
Cornus femina	Phryma leptostachya	Viola cucullata
Cornus obliqua	Physostegia virginiana	Viola pubescens
Cornus rugosa	Podophyllum peltatum	Vitis riparia
Cornus stolonifera	Polemonium reptans	Zanthoxylum americanum

Additional species:

Viola conspersa  
 Bromus - late summer  
 Rubus pubescens 20 ft maple  
 black ash seedling  
 Cinn. arundinacea  
 Aster punctatus

Presence or Frequency  
(Common species only)

## FLOOD-PLAIN HARDWOODS

Stand No. 4075  
Quadrat No. 19

Adiantum pedatum	Corylus americana	Polygonatum canaliculatum
Agrimonia grypsosepala	Cryptotaenia canadensis	Prenanthes alba
Allium canadense	Desmodium glutinosum	Ranunculus abortivus
Allium tricoccum	Dioscorea villosa	Ranunculus septentrionalis
Amphicarpa bracteata	Echinocystis lobata	Rhus radicans
Anemone canadensis	Fragaria virginiana	Ribes americanum
Anemone virginiana	Galium aparine	Ribes cynosbati
Aralia nudicaulis	Galium concinnum	Ribes missouriense
Arenaria lateriflora	Galium obtusum	Rorippa islandica
Arisaema atrorubens	Galium triflorum	Rudbeckia laciniata
Arisaema dracontium	Geranium maculatum	Rumex verticillatus
Asarum canadense	Geum canadense	Sambucus canadensis
Aster lateriflorus	Glyceria striata	Sanguinaria canadensis
Aster simplex	Hydrophyllum virginianum	Sanicula gregaria
Athyrium filix-femina	Ilex verticillata	Smilacina racemosa
Athyrium thelypteroides	Impatiens capensis	Smilacina stellata
Boehmeria cylindrica	Iris virginica	Smilax ecirrhata
Brachyelytrum erectum	Lactuca biennis	Smilax herbacea
Caltha palustris	Laportea canadensis	Smilax tamnoides
Campanula americana	Leersia oryzoides	Solanum dulcamara
Carex crinita	Lobelia cardinalis	Stachys palustris
Carex grayii	Lycopus americanus	Teucrium canadense
Carex intumescens	Lycopus uniflorus	Thalictrum dasycarpum
Carex lupulina	Lysimachia ciliata	Thalictrum dioicum
Carex normalis	Lysimachia nummularia	Tovara virginiana
Carex vupinoidea	Menispermum canadense	Trillium flexipes
Cephalanthus occidentalis	Onoclea sensibilis	Uvularia sessilifolia
Cicuta maculata	Osmorhiza claytoni	Veronicastrum virginianum
Circaea quadrisulcata	Osmorhiza longistylis	Viburnum lentago
Cirsium altissimum	Parthenocissus inserta	Viola canadensis
Convolvulus sepium	Phlox divaricata	Viola conspersa
Cornus femina	Phryma leptostachya	Viola cucullata
Cornus obliqua	Physostegia virginiana	Viola pubescens
Cornus rugosa	Podophyllum peltatum	Vitis riparia
Cornus stolonifera	Polemonium reptans	Zanthoxylum americanum

Additional species:

*Symplocos foetida*  
*Maranthaceae*  
*Carex convoluta*  
*Bromus obtusifolius*  
*Rhus pubescens*  
black ash seedling

Presence or Frequency  
(Common species only)

## FLOOD-PLAIN HARDWOODS

Stand No. 4075  
Quadrat No. 20

Adiantum pedatum  
Agrimonia gryposepala  
Allium canadense  
Allium tricoccum  
Amphicarpa bracteata  
Anemone canadensis  
Anemone virginiana  
Aralia nudicaulis  
Arenaria lateriflora  
Arisaema atrorubens  
Arisaema dracontium  
Asarum canadense  
Aster lateriflorus  
Aster simplex  
Athyrium filix-femina  
Athyrium thelypteroides  
Boehmeria cylindrica  
Brachyelytrum erectum  
Caltha palustris  
Campanula americana  
Carex crinita  
Carex grayii  
Carex intumescens  
Carex lupulina  
Carex normalis  
Carex vupinoidea  
Cephalanthus occidentalis  
Cicuta maculata  
Circaea quadrisulcata  
Cirsium altissimum  
Convolvulus sepium  
Cornus femina  
Cornus obliqua  
Cornus rugosa  
Cornus stolonifera

Corylus americana  
Cryptotaenia canadensis  
Desmodium glutinosum  
Dioscorea villosa  
Echinocystis lobata  
Fragaria virginiana  
Galium aparine  
Galium concinnum  
Galium obtusum  
Galium triflorum  
Geranium maculatum  
Geum canadense  
Glyceria striata  
Hydrophyllum virginianum  
Ilex verticillata  
Impatiens capensis  
Iris virginica  
Lactuca biennis  
Laportea canadensis  
Leersia oryzoides  
Lobelia cardinalis  
Lycopus americanus  
Lycopus uniflorus  
Lysimachia ciliata  
Lysimachia nummularia  
Menispermum canadense  
Onoclea sensibilis  
Osmorhiza claytoni  
Osmorhiza longistylis  
Parthenocissus inserta  
Phlox divaricata  
Phryma leptostachya  
Physostegia virginiana  
Podophyllum peltatum  
Polemonium reptans

Polygonatum canaliculatum  
Prenanthes alba  
Ranunculus abortivus  
Ranunculus septentrionalis  
Rhus radicans  
Ribes americanum  
Ribes cynosbati  
Ribes missouriense  
Rorippa islandica  
Rudbeckia laciniata  
Rumex verticillatus  
Sambucus canadensis  
Sanguinaria canadensis  
Sanicula gregaria  
Smilacina racemosa  
Smilacina stellata  
Smilax ecirrhata  
Smilax herbacea  
Smilax tannoides  
Solanum dulcamara  
Stachys palustris  
Teucrium canadense  
Thalictrum dasycarpum  
Thalictrum dioicum  
Tovara virginiana  
Trillium flexipes  
Uvularia sessilifolia  
Veronicastrum virginianum  
Viburnum lentago  
Viola canadensis  
Viola conspersa  
Viola cucullata  
Viola pubescens  
Vitis riparia  
Zanthoxylum americanum

Additional species:

*Rubus pubescens*  
black at seedling  
*Carex cristatella*  
elm  
perfoliate  
*Bromus latiglumis*  
*Viola conspersa*