



# LIBRARIES

UNIVERSITY OF WISCONSIN-MADISON

## Site 3514: Vilas County, Township 41N, Range 8E, Section 27. 1952-08-09

[s.l.]: [s.n.], 1952-08-09

<https://digital.library.wisc.edu/1711.dl/OVCAZKIDOEM6R8W>

This material may be protected by copyright law (Title 17, US Code).

For information on re-use see:

<http://digital.library.wisc.edu/1711.dl/Copyright>

The libraries provide public access to a wide range of material, including online exhibits, digitized collections, archival finding aids, our catalog, online articles, and a growing range of materials in many media.

When possible, we provide rights information in catalog records, finding aids, and other metadata that accompanies collections or items. However, it is always the user's obligation to evaluate copyright and rights issues in light of their own use.

*Dearyard*

*H*

Data Form No. 20

Plant Ecology Research

Univ. of Wisconsin

STAND RECORD

FORESTS

Stand No. 3514

Name: *V. Las*  
County:  
Date: *8-9-52*

Locality:  
T: *41 N* R: *8 E* Sec: *27*

Observers: *Chustensen Ward Ward, Bray*

Size of Stand:  
Forest Type: *Maple-Balsam*  
Topography: *hillside sloping to a creek*  
Size of Area Sampled:  
Soil Type:  
Slope: *N 45* Directions

Condition of Stand:  
*Badly highlined. No recent cutting  
x by deer.*

Open Grown Trees:

% Canopy:

| Stumps: | 1. | 2. | 3. | 4. | 5. | 6. | 7. | 8. | 9. | 10. | 11. | 12. |
|---------|----|----|----|----|----|----|----|----|----|-----|-----|-----|
|         |    |    |    |    |    |    |    |    |    |     |     |     |

Soil Data:

|                | pH | N | P | K | Ca | Mg | Org. Mat. | Colloids | W.H.C. |
|----------------|----|---|---|---|----|----|-----------|----------|--------|
| A <sub>0</sub> |    |   |   |   |    |    |           |          |        |
| A <sub>1</sub> |    |   |   |   |    |    |           |          |        |
| A <sub>2</sub> |    |   |   |   |    |    |           |          |        |
| B              |    |   |   |   |    |    |           |          |        |

DEPTH CHARACTERISTICS (Color, Texture, Structure, etc.)

|                |  |
|----------------|--|
| A <sub>0</sub> |  |
| A <sub>1</sub> |  |
| A <sub>2</sub> |  |
| B              |  |

Parent Material:

*v = browse presence*

Map:

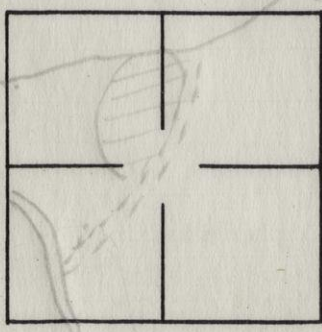



H  
 yard

Northern Pine-Hardwoods

Station Number: 3514

| TREE              | # PTS | # TRS | DOM. CLASSES |      |     | TOT. DOM. | # SAP | D. % SAP | F. % SDL. | F. % TRS. | % SUM F. TR. | D. % TRS. | DOM% TRS. | DFD INDEX | upland C. I.    |
|-------------------|-------|-------|--------------|------|-----|-----------|-------|----------|-----------|-----------|--------------|-----------|-----------|-----------|-----------------|
|                   |       |       | -80          | -320 | 321 |           |       |          |           |           |              |           |           |           |                 |
| Abies bals        | 23    | 36    | 34           | 2    |     | 1390      | 81    | 55.86    | 45        | 57.5      | 38.98        | 45.00     | 41.52     | 125.50    | 878.50 564.75   |
| Acer rubru        | 3     | 3     | 3            |      |     | 72        | 6     | 4.14     | 55        | 7.5       | 5.08         | 3.75      | 2.15      | 10.98     | 65.89 65.89     |
| A. sacchar        | 11    | 15    | 15           |      |     | 412       | 31    | 21.38    | 15        | 27.5      | 18.64        | 18.75     | 12.31     | 49.70     | 497.00 497.00   |
| A. spicatu        |       |       |              |      |     |           |       |          |           |           |              |           |           |           |                 |
| Betula lut        | 2     | 2     |              | 2    |     | 470       | 8     | 5.52     |           | 5.0       | 3.39         | 2.50      | 14.04     | 19.93     | 159.44 149.07   |
| B. papyrif        | 12    | 15    | 14           | 1    |     | 769       | 18    | 12.41    | 5         | 30.0      | 20.34        | 18.75     | 14.01     | 53.10     | 265.50 265.5    |
| Carpinus c        |       |       |              |      |     |           |       |          |           |           |              |           |           |           |                 |
| Fagus gran        |       |       |              |      |     |           |       |          |           |           |              |           |           |           |                 |
| Ostrya vir        |       |       |              |      |     |           |       |          |           |           |              |           |           |           |                 |
| Picea glau        |       |       |              |      |     |           |       |          |           |           |              |           |           |           |                 |
| Pinus Bank        |       |       |              |      |     |           |       |          |           |           |              |           |           |           |                 |
| P. resinosa       |       |       |              |      |     |           |       |          |           |           |              |           |           |           |                 |
| P. Strobus        | 4     | 5     | 4            | 1    |     | 335       |       |          |           | 10.0      | 6.78         | 6.25      | 10.01     | 23.04     | 115.20 92.16    |
| Populus ba        |       |       |              |      |     |           |       |          |           |           |              |           |           |           |                 |
| P. grandid        |       |       |              |      |     |           |       |          |           |           |              |           |           |           |                 |
| P. tremulo        | 3     | 3     | 3            |      |     | 125       |       |          | 5         | 7.5       | 5.08         | 3.75      | 3.74      | 12.57     | 25.14 43.99     |
| Prunus pen        |       |       |              |      |     |           |       |          |           |           |              |           |           |           |                 |
| Quercus el        |       |       |              |      |     |           |       |          |           |           |              |           |           |           |                 |
| Q. rubra          |       |       |              |      |     |           |       |          |           |           |              |           |           |           |                 |
| Tilia amer        |       |       |              |      |     |           |       |          |           |           |              |           |           |           |                 |
| Tsuga cana        | 1     | 1     | 1            |      |     | 75        |       |          |           | 2.5       | 1.69         | 1.25      | 2.24      | 5.18      | 41.14 44.03     |
| Thuja occi        |       |       |              |      |     |           |       |          |           |           |              |           |           |           |                 |
| Ulmus amer        |       |       |              |      |     |           |       |          |           |           |              |           |           |           |                 |
| U. fulva          |       |       |              |      |     |           |       |          |           |           |              |           |           |           |                 |
| check Amelanchier |       |       |              |      |     |           | 1     | 0.69     |           |           |              |           |           |           |                 |
| Parnassia sp.     |       |       |              |      |     |           |       |          | 5         |           |              |           |           |           |                 |
|                   | 59    | 80    | 74           | 6    |     | 3348      | 145   | 100      |           |           | 99.98        | 100       | 100.2     | 300       | 9048.11 1722.39 |

AVE. DIST. BTW'N TREES:

$\frac{490.5}{40} = 12.26$

AVE B. A.:

41.85

# TREES/ACRE:

335

DOM./ACRE:

14020



POINT RECORD TREES

NORTHERN PINE-HARDWOODS

Stand No. 3514

| STATION NO.  | 1  | 2      | 3     | 4  | 5     | 6      | 7  | 8     | 9      | 10     |
|--------------|----|--------|-------|----|-------|--------|----|-------|--------|--------|
| Abies balsam | 4  | 10/32  | 30/15 | 45 | 20/15 | 12     | 2  | 55    | 2      | 20     |
| Acer rubrum  |    |        |       | 30 | 2     |        | 12 | 2     |        |        |
| A. sacchar.  |    |        |       |    |       |        |    |       |        |        |
| A. spicatum  |    |        |       |    |       |        |    |       |        |        |
| Betula lut.  |    |        |       | ✓  |       |        |    |       |        |        |
| B. papyrif   | 85 |        |       | ✓  | 25    | 2      |    |       |        | 30/12  |
| Carpinus car |    |        |       |    |       |        |    |       |        |        |
| Fagus gran   |    |        |       |    |       |        |    |       |        |        |
| Ostrya virg  |    |        |       |    |       |        |    |       |        |        |
| Picea glau   |    |        |       |    |       |        |    |       |        |        |
| Pinus Bank   |    |        |       |    |       |        |    |       |        |        |
| P. resinosa  |    |        |       |    |       |        |    |       |        |        |
| P. Strobus   |    |        |       |    |       |        | 50 | 15    | 80/110 |        |
| Populus bals |    |        |       |    |       |        |    |       |        |        |
| P. grand     |    |        |       |    |       |        |    |       |        |        |
| P. trem      |    |        |       |    |       |        |    |       |        |        |
| Prunus pen.  |    |        |       |    |       |        |    |       |        |        |
| Quercus ell  |    |        |       |    |       |        |    |       |        |        |
| Q. rubra     |    |        |       |    |       |        |    |       |        |        |
| Tilia amer   |    |        |       |    |       |        |    |       |        |        |
| Tsuga can    | 15 |        |       |    |       |        |    |       |        |        |
| Thuja occ    |    |        |       |    |       |        |    |       |        |        |
| Ulmus amer   |    |        |       |    |       |        |    |       |        |        |
| U. fulva     |    |        |       |    |       |        |    |       |        |        |
| Distance     | 14 | 16 1/2 | 8     | 15 | 9     | 16 1/2 | 14 | 9 1/2 | 19     | 11 1/2 |

H



POINT RECORD TREES

NORTHERN PINE-HARDWOODS

Stand No. 3514

| STATION NO.  | 1       | 2        | 3  | 4  | 5    | 6  | 7    | 8    | 9    | 10           |
|--------------|---------|----------|----|----|------|----|------|------|------|--------------|
| Abies balsam | 25<br>4 | 4        | 3  |    | 1    |    |      |      |      | 35<br>3 35 4 |
| Acer rubrum  |         |          |    |    |      | 30 |      |      |      | 1            |
| A. sacchar.  |         | 20<br>25 |    | 25 | 3 15 | 45 | 4 20 | 4 25 | 2 45 | 42           |
| A. spicatum  |         |          |    |    |      |    |      |      |      |              |
| Betula lut.  |         |          | 1  |    |      |    | 220  |      |      |              |
| B. papyrif   |         |          | 35 | 30 | 20   | 1  |      |      | 2    |              |
| Carpinus car |         |          |    |    |      |    |      |      |      |              |
| Fagus gran   |         |          |    |    |      |    |      |      |      |              |
| Ostrya virg  |         |          |    |    |      |    |      |      |      |              |
| Picea glau   |         |          |    |    |      |    |      |      |      |              |
| Pinus Bank   |         |          |    |    |      |    |      |      |      |              |
| P. resinosa  |         |          |    |    |      |    |      |      |      |              |
| P. Strobus   |         |          |    |    |      |    |      |      |      |              |
| Populus bals |         |          |    |    |      |    |      |      |      |              |
| P. grand     |         |          |    |    |      |    |      |      |      |              |
| P. trem      | 45      |          | 35 |    |      |    |      |      |      |              |
| Prunus pen.  |         |          |    |    |      |    |      |      |      |              |
| Quercus ell  |         |          |    |    |      |    |      |      |      |              |
| Q. rubra     |         |          |    |    |      |    |      |      |      |              |
| Tilia amer   |         |          |    |    |      |    |      |      |      |              |
| Tsuga can    |         |          |    |    |      |    |      |      |      |              |
| Thuja occ    |         |          |    |    |      |    |      |      |      |              |
| Ulmus amer   |         |          |    |    |      |    |      |      |      |              |
| U. fulva     |         |          |    |    |      |    |      |      |      |              |
| CORYLUS      | ✓       |          |    |    |      |    |      |      |      |              |
| Distance     | 9       | 12       | 10 | 9  | 7    | 13 | 22   | 9    | 9    | 13           |



POINT RECORD TREES

NORTHERN PINE-HARDWOODS

Stand No. 3514

| STATION NO.  | 1         | 2         | 3      | 4        | 5        | 6       | 7        | 8      | 9        | 10     |          |
|--------------|-----------|-----------|--------|----------|----------|---------|----------|--------|----------|--------|----------|
| Abies balsam | 20 ✓<br>3 | 27 ✓<br>2 | ✓<br>4 | 2        |          | 110     |          |        | ✓<br>350 | ✓<br>2 | ✓<br>350 |
| Acer rubrum  |           |           |        |          |          |         |          |        |          |        |          |
| A. sacchar.  |           | 26        |        | ✓<br>2   | 3        | ✓<br>3  | 30<br>22 | ✓<br>4 | 17       | 1      | 2        |
| A. spicatum  |           |           |        |          |          |         |          |        | 20<br>15 | 1      |          |
| Betula lut.  |           |           |        |          |          | 1       |          | 250    |          |        |          |
| B. papyrif   | 13<br>1   | 2         | 40     | 35<br>60 | 23<br>30 | ✓<br>16 |          |        |          |        |          |
| Carpinus car |           |           |        |          |          |         |          |        |          |        |          |
| Fagus gran   |           |           |        |          |          |         |          |        |          |        |          |
| Ostrya virg  |           |           |        |          |          |         |          |        |          |        |          |
| Picea glau   |           |           |        |          |          |         |          |        |          |        |          |
| Pinus Bank   |           |           |        |          |          |         |          |        |          |        |          |
| P. resinosa  |           |           |        |          |          |         |          |        |          |        |          |
| P. Strobus   |           |           |        |          |          |         |          |        |          |        |          |
| Populus bals |           |           |        |          |          |         |          |        |          |        |          |
| P. grand     |           |           |        |          |          |         |          |        |          |        |          |
| P. trem      |           |           | 65     |          |          |         |          |        |          |        |          |
| Prunus pen.  |           |           |        |          |          |         |          |        |          |        |          |
| Quercus ell  |           |           |        |          |          |         |          |        |          |        |          |
| Q. rubra     |           |           |        |          |          |         |          |        |          |        |          |
| Tilia amer   |           |           |        |          |          |         |          |        |          |        |          |
| Tsuga can    |           |           |        |          |          |         |          |        |          |        |          |
| Thuja occ    |           |           |        |          |          |         |          |        |          |        |          |
| Ulmus amer   |           |           |        |          |          |         |          |        |          |        |          |
| U. fulva     |           |           |        |          |          |         |          |        |          |        |          |
| Distance     | 18        | 15        | 7      | 17       | 6        | 11-6    | 7-6      | 11-6   | 9-6      | 14     |          |



POINT RECORD TREES

NORTHERN PINE-HARDWOODS

Stand No. 3514

| STATION NO.  | 1        | 2        | 3        | 4        | 5        | 6        | 7        | 8  | 9        | 10  |
|--------------|----------|----------|----------|----------|----------|----------|----------|----|----------|-----|
| Abies balsam | 55<br>38 | 63<br>14 | 45<br>28 | 22<br>65 | 17<br>30 | 55<br>24 | 40<br>45 | 45 | 12<br>24 | 120 |
| Acer rubrum  |          | 1        |          |          |          |          |          |    |          |     |
| A. sacchar.  |          |          |          |          |          |          |          |    |          |     |
| A. spicatum  |          |          |          |          |          |          |          |    |          |     |
| Betula lut.  |          |          |          | 3        | 2        |          |          |    |          |     |
| B. papyrif   | 2        |          |          |          |          |          |          |    | 2        | 15  |
| Carpinus car |          |          |          |          |          |          |          |    |          |     |
| Fagus gran   |          |          |          |          |          |          |          |    |          |     |
| Ostrya virg  |          |          |          |          |          |          |          |    |          |     |
| Picea glau   |          |          |          |          |          |          |          |    |          |     |
| Pinus Bank   |          |          |          |          |          |          |          |    |          |     |
| P. resinosa  |          |          |          |          |          |          |          |    |          |     |
| P. Strobus   |          |          |          |          |          |          |          | 80 |          |     |
| Populus bals |          |          |          |          |          |          |          |    |          |     |
| P. grand     |          |          |          |          |          |          |          |    |          |     |
| P. trem      |          |          |          |          |          |          |          |    |          |     |
| Prunus pen.  |          |          |          |          |          |          |          |    |          |     |
| Quercus ell  |          |          |          |          |          |          |          |    |          |     |
| Q. rubra     |          |          |          |          |          |          |          |    |          |     |
| Tilia amer   |          |          |          |          |          |          |          |    |          |     |
| Tsuga can    |          |          |          |          |          |          |          |    |          |     |
| Thuja occ    |          |          |          |          |          |          |          |    |          |     |
| Ulmus amer   |          |          |          |          |          |          |          |    |          |     |
| U. fulva     |          |          |          |          |          |          |          |    |          |     |
| Amelanchier  |          |          |          |          |          |          |          |    |          | 1   |
| Distance     | 9        | 10       | 11       | 13-6     | 9-6      | 13-6     | 7        | 15 | 22-6     | 10  |



## HERB FREQUENCY

LR RED MAPLE SEED 4H1  
 FIR SEED 4H1111  
 W. MAPLE SEED 1

Actaea pachypoda  
 Actaea rubra .  
 Adiantum pedatum  
 Allium tricoccum  
 Anemone quinquefolia  
 Aquilegia canadensis  
 Aralia nudicaulis ||  
 Aralia racemosa  
 Arisaema atrorubens  
 Aster macrophyllus //|  
 Aster sagittifolius  
 Athyrium angustum  
 Botrychium virginianum  
 Brachyelytrum erectum /  
 Carex albursina  
 Caulophyllum thalictroides  
 Chimaphila umbellata  
 Circaea alpina  
 Circaea latifolia  
 Clintonia borealis 4H1  
 Coptis trifolia |||  
 Corallorrhiza maculata  
 Cornus alternifolia  
 Cornus canadensis 4H1111  
 Cornus rugosa  
 Corylus americana  
 Corylus cornuta  
 Cypripedium acaule  
 Diervilla lonicera  
 Dirca palustris  
 Dryopteris linnaeana  
 Dryopteris phegopteris  
 Dryopteris spinulosa ||  
 Epifagus virginiana  
 Epigaea repens

## NORTHERN PINE-HARDWOODS

Fragaria virginiana  
 Galium lanceolatum  
 Galium triflorum P  
 Gaultheria procumbens  
 Gaylussacia baccata  
 Geranium maculatum  
 Geum canadense  
 Gnaphalium obtusifolium  
~~GOODYURA~~ P  
 Helianthemum sp.  
 Helianthus strumosus  
 Hepatica acutiloba  
 Hepatica americana  
 Impatiens biflora  
 Linnaea borealis P  
 Lonicera oblongifolia  
 Lupinus perennis  
~~LYCOP. CLAYTONI~~ |||  
 Lycopodium annotinum  
 Lycopodium complanatum  
 Lycopodium lucidulum  
 Lycopodium obscurum 4H1  
 Lysimachia quadrifolia  
 Maianthemum canadense 4H1111  
 Mitchellia repens  
 Mitella diphylla  
 Mitella nuda  
 Monotropa uniflora P  
 Myrica asplenifolia  
 Onoclea sensibilis  
 Oryzopsis asperifolia ||  
 Osmorhiza claytoni  
 Oxalis montana  
 Phryma leptostachya  
 Polygala pauciflora  
 Polygonatum commutatum  
 Polygonatum pubescens

Potentilla simplex  
 Prenanthes alba  
 Pteridium aquilinum //|  
 Pyrola elliptica  
 Pyrola rotundifolia  
 Pyrola secunda  
 Ranunculus recurvatus  
 Rhus radicans + typhoid  
 Ribes americanum  
 Rosa sp.  
 Rubus parviflorus  
 Rubus (blackberry)  
 Rubus (dewberry) P  
 Sambucus pubens  
 Sanguinaria canadensis  
 Sanicula gregaria  
 Smilacina racemosa  
 Smilacina stellata  
 Smilax ecirrhata  
 Solidago ulmifolia  
 Streptopus roseus |||  
 Taxus canadensis  
 Thalictrum dioicum  
 Trientalis borealis |||  
 Trillium grandiflorum  
 Uvularia grandiflora  
 Uvularia sessilifolia  
 Vaccinium angustifolium  
 Vaccinium pennsylvanicum  
 Viburnum acerifolium  
~~VIOLA WOODRUFFIA~~ |||  
 Viola canadensis  
 Viola cucullata  
 Viola pallens  
 Viola pubescens  
 Waldsteinia fragarioides 4H11

W. BIRCH SEEDS 1

OSMUNDA CLAYTONI  
 OXALIS MONT 1

Schizachne par 1



























## PRESENCE LIST

## NORTHERN PINE-HARDWOODS

STAND NO. 3514  
H

✓ *Abies balsamea* /  
 ✓ *Acer rubrum* III  
 ✓ *Acer saccharum* II  
*Acer spicatum*  
 ✓ *Amelanchier* sp.  
 ✓ *Betula lutea*  
*Betula papyrifera*  
*Caprinus caroliniana*  
*Carya cordiformis*  
*Crategeus* sp.  
*Fagus grandiflora*  
*Fraxinus americana*  
*Fraxinus nigra*

*Fraxinus pennsylvanica*  
*Juglans cinerea*  
*Larix laricina*  
*Ostrya virginiana*  
*Picea glauca*  
*Pinus banksiana*  
*Pinus resinosa*  
*Pinus strobus*  
*Populus balsamifera*  
*Populus grandidentata*  
 ✓ *Populus tremuloides* /  
*Prunus pennsylvanica*  
 ✓ *Prunus serotina* /

✓ *Prunus virginiana*  
*Quercus alba*  
*Quercus ellipsoidalis*  
*Quercus macrocarpa*  
*Quercus rubra*  
*Sorbus decora*  
*Thuja occidentalis*  
*Tilia americana*  
 ✓ *Tsuga canadensis*  
*Ulmus americana*  
*Ulmus fulva*

## HERBS AND SHRUBS

✓ *Actaea pachypoda*  
*Actaea rubra*  
*Adiantum pedatum*  
*Agrimonia gryposepala*  
*Allium tricoccum*  
*Alnus rugosa*  
*Amphicarpa bracteata*  
*Anemone canadensis*  
*Anemone quinquefolia*  
*Antennaria* sp.  
*Apocynum androsaemifolium*  
*Apocynum cannabinum*  
*Aquilegia canadensis*  
 ✓ *Aralia nudicaulis* /  
*Aralia racemosa*  
*Arctostaphylos uva-ursi*  
*Arisaema atrorubens*  
*Asarum canadense*  
*Asclepias phytolaccoides*  
*Aster cordifolius*  
*Aster lateriflorus*  
*Aster macrophyllus* III  
*Aster prenanthoides*  
*Aster sagittifolius*  
*Aster shortii*  
*Aster umbellatus*  
*Athyrium angustum*  
*Aureolaria pedicularia*  
*Boehmeria cylindrica*  
*Botrychium virginianum*  
 ✓ *Brachyelytrum erectum* /  
*Bromus purgans*  
*Campanula americana*  
*Carex albursina*  
*Carex pensylvanica*  
*Caulophyllum thalictroides*  
*Celastrus scandens*  
*Chimaphila umbellata*  
*Chiogenes hispidula*

*Circaea alpina*  
*Circaea latifolia*  
*Claytonia caroliniana*  
*Claytonia virginiana*  
*Clintonia borealis* /  
*Convolvulus spithameus*  
 ✓ *Coptis trifolia* III  
*Corallorrhiza maculata*  
*Corallorrhiza striata*  
*Cornus alternifolia*  
 ✓ *Cornus canadensis* III  
*Cornus femina*  
*Cornus rugosa*  
*Corylus americana*  
 ✓ *Corylus cornuta*  
*Cryptotaenia canadensis*  
*Cypripedium acaule*  
*Cypripedium pubescens*  
*Cystopteris fragilis*  
*Danthonia spicata*  
*Dentaria diphylla*  
*Desmodium glutinosum*  
*Desmodium nudiflorum*  
*Dicentra canadensis*  
*Dicentra cucullaria*  
*Diervilla lonicera*  
*Dirca palustris*  
*Dryopteris linneana*  
*Dryopteris phegopteris*  
 ✓ *Dryopteris spinulosa* /  
*Epifagus virginiana*  
*Epigaea repens*  
*Equisetum arvense*  
*Erythronium americanum*  
*Fragaria virginiana* /  
*Galium aparine*  
*Galium boreale*  
*Galium circaezans*  
*Galium concinnum*

*Galium lanceolatum*  
*Galium triflorum* III  
*Gaultheria procumbens*  
*Gaylussacia baccata*  
*Geranium maculatum*  
*Geum canadense*  
*Gnaphalium obtusifolium*  
*Goodyera pubescens*  
*Goodyera repens*  
*Habenaria bracteata*  
*Hamamelis virginiana*  
*Helianthus strumosus*  
*Hepatica acutiloba*  
*Hepatica americana*  
*Hieracium canadense*  
*Hydrophyllum virginianum*  
*Hystrix patula*  
*Impatiens biflora*  
*Lactuca canadensis*  
*Laportea canadensis*  
*Lappula virginica*  
*Lathyrus ochroleucus*  
*Ledum groenlandicum*  
*Linnaea borealis* /  
 ✓ *Lonicera canadensis*  
*Lonicera hirsuta*  
*Lonicera oblongifolia*  
*Lonicera prolifera*  
*Luzula multiflora*  
*Lycopodium annotinum*  
*Lycopodium clavatum*  
*Lycopodium complanatum*  
*Lycopodium lucidulum* II  
*Lycopodium obscurum* III  
*Lycopodium tristachyum*  
*Lycopus americanus*  
*Lycopus uniflora*  
*Lysimachia quadrifolia*  
 ✓ *Maianthemum canadense* III



3514

Melampyrum lineare  
 Mitchella repens  
 Mitella diphylla  
 Mitella nuda  
 Monarda fistulosa  
 Moneses uniflora  
 ✓ Monotropa uniflora  
 Myrica asplenifolia  
 Onoclea sensibilis  
 Oryzopsis asperifolia |  
 Osmorhiza claytoni  
 Osmunda cinnamomea  
 Osmunda claytoniana  
 ✓ Oxalis montana  
 Panax quinquefolia  
 Parietaria pennsylvanica  
 Parthenocissus vitacea  
 Pedicularis lanceolata  
 Phyrma leptostachya  
 Podophyllum peltatum  
 Polemonium reptans  
 Polygala pauciflora  
 Polygonatum commutatum  
 Polygonatum pubescens  
 Potentilla simplex  
 Prenanthes alba  
 Pteretis nodulosa  
 Pteridium aquilinum |||

Pyrola elliptica  
 Pyrola rotundifolia  
 Pyrola secunda  
 Ranunculus abortivus  
 Ranunculus recurvatus  
 Ranunculus septentrionalis  
 Rhus radicans  
 Rhus typhina  
 Ribes americanum  
 Ribes cynosbati  
 Ribes lacustre  
 Ribes triste  
 Rubus idaeus  
 Rubus parviflorus  
 Rubus hispidus  
 Rubus - blackberry  
 Rubus - dewberry |||  
 ✓ Rubus - raspberry  
 Sambucus canadensis  
 Sambucus pubens  
 Sanguinaria canadensis  
 Sanicula gregaria  
 Schizachne purpurascens |  
 Scutellaria lateriflora  
 Shepherdia canadensis  
 Smilacina racemosa  
 Smilacina stellata  
 Smilax ecirrhata

Smilax herbacea  
 Smilax hispida  
 Solidago latifolia  
 Solidago ulmifolia  
 Streptopus amplexifolius  
 ✓ Streptopus roseus ||  
 Taxus canadensis  
 Thalictrum dioicum  
 Tiarella cordifolia  
 ✓ Trientalis borealis ||||  
 Trillium cernuum  
 Trillium grandiflorum  
 Uvularia grandiflora  
 Uvularia sessilifolia  
 ✓ Vaccinium angustifolium  
 Vaccinium pennsylvanicum  
 Viburnum acerifolium  
 Viburnum affine  
 Viburnum lentago  
 Viola canadensis  
 Viola cucullata  
 Viola incognita |  
 Viola pallens  
 Viola pubescens |  
 Vitis <sup>microcarpa</sup> aestivalis  
 Vitis riparia  
 Waldsteinia fragarioides |||  
 Zanthoxylum americanum |

Additional Species:

~~L. quercus~~  
 ✓ Carex trisperma ||  
 Cinna  
 ? Vac. car  
 ? a. p. l. m.