



LIBRARIES

UNIVERSITY OF WISCONSIN-MADISON

Plat book, Dane County, Wisconsin. 1955

Madison, Wisconsin: Derr Map Studio East Side Print Shop, 1955

<https://digital.library.wisc.edu/1711.dl/G452RKVQX7FOJ8N>

This material may be protected by copyright law (Title 17, US Code).

Original material owned by Madison Public Library.

For information on re-use see:

<http://digital.library.wisc.edu/1711.dl/Copyright>

The libraries provide public access to a wide range of material, including online exhibits, digitized collections, archival finding aids, our catalog, online articles, and a growing range of materials in many media.

When possible, we provide rights information in catalog records, finding aids, and other metadata that accompanies collections or items. However, it is always the user's obligation to evaluate copyright and rights issues in light of their own use.

1955

13

PLAT BOOK

LOCAL
MATERIAL

DANE COUNTY, WIS.

Exclusive Distributors

EAST SIDE PRINT SHOP, Inc.

2004 Winnebago St.

Madison, Wis.

MADISON
FREE LIBRARY
MADISON

*917.758 D1921

Copyright 1955

Your Farm Bureau Serves You In Some Way Every Day

Dane County Farm Bureau

(Cooperative)

MADISON, WISCONSIN

INSURANCE SERVICE FOR FARMER (MEMBERS ONLY)

DANE COUNTY

MADISON

Farmco Gasoline
Farmco Fuel Oils
Farmco Motor Oils
Farmco Greases
Farmco Fly Spray

Verona – Phone 5

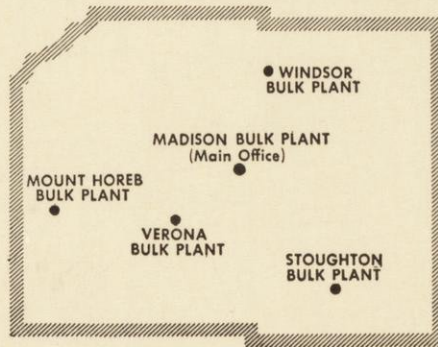

Bulk and Bottle Gas
Propane Gas Appliances

SERVICE CO.

WISCONSIN

Unico Paints
Unico Tires
Unico Batteries
Unico Milk Coolers
Unico Freezers

Madison – CHerry 4-4781

Dane County Cooperative Farm Supply Company

FEEDS

SEEDS

FARMCO



SERVICE

HARDWARE

FERTILIZER

De Forest

Phone 2301

Madison

Phone Alpine 6-8373

Verona

Phone 92

Jan.

Phone 782

Dane

Phone Waunakee 42R5

Waunakee

Phone 29R2

DI9 p2

(Local materials)

MADISON PUBLIC LIBRARY
3 9078 01712191 5

DRIVE-IN BANKING
WALK-UP BANKING
BANKING BY MAIL
FREE CUSTOMER PARKING

A combination of modern, helpful, time-saving services are available at the Security State Bank on Madison's East Side . . .

where you'll enjoy banking ease, pleasant surroundings, and understanding assistance in all of your banking transactions.

Friday Evening Banking Hours 4 - 8



SECURITY STATE BANK

on Madison's East Side

Each Deposit Insured Up to \$10,000

Member of Federal Deposit Insurance Corporation

ANALYSIS OF A SECTION OF LAND

Alphabetical Index of Township Maps

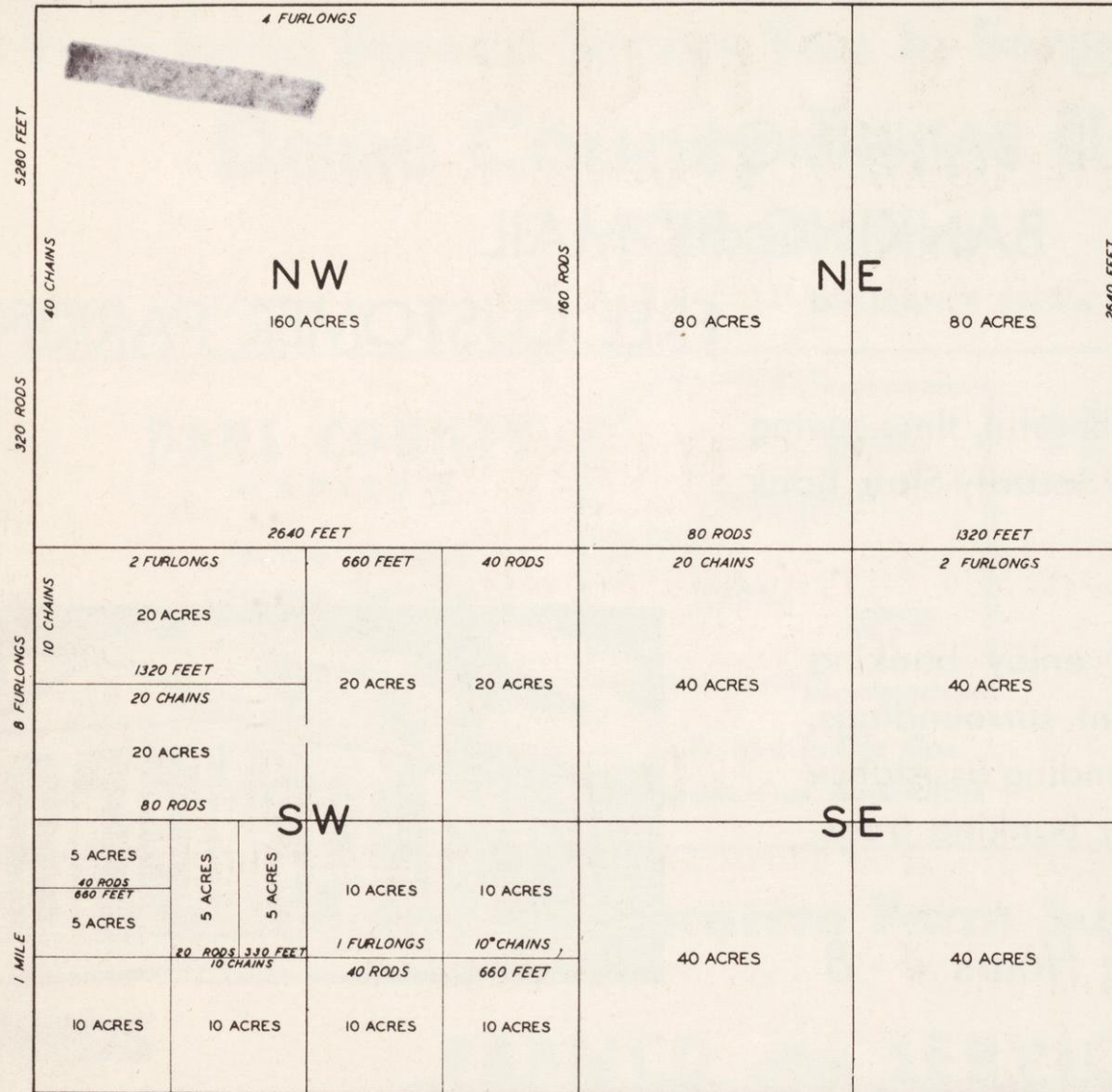

	Page
Albion	5
Berry	6
Black Earth	7
Blooming Grove	8
Blue Mounds	9
Bristol	10
Burke	11
Christiana	12
Cottage Grove	14
Cross Plains	15
Dane	16
Deerfield	17
Dunkirk	18
Dunn	19
Fitchburg	20
Madison	21
Mazomanie	22
Medina	23
Middleton	24
Montrose	30
Oregon	32
Perry	33
Pleasant Springs	34
Primrose	35
Roxbury	36
Rutland	37
Springdale	38
Springfield	39
Sun Prairie	40
Vermont	42
Verona	43
Vienna	44
Westport	46
Windsor	48
York	50

LINEAR MEASURES

	INCHES	FEET	RODS	LINKS	CHAINS	FURLONGS
1 LINK	7.92	0.66	0.04	1	0.01	0.001
1 FOOT	12	1	.0606061	1.515152	.0151515	.00151515
1 YARD	36	3	.181818	4.54545	.0454545	.00454545
1 ROD	198	16.5	1	25	0.25	0.025
1 CHAIN	792	66	4	100	1	.1
1 FURLONG	7920	660	40	1000	10	1
1 MILE	63,360	5280	320	8,000	80	8

SQUARE MEASURES

	SQ. INCHES	SQ. FEET	SQ. YARDS	SQ. RODS	SQ. CHAINS
1 SQ FOOT	144	1			
1 SQ YARD		9	1		
1 SQ ROD		272.25	30.25	1	
1 ACRE		43560	4840	160	10

640 ACRES = 1 SQ. MILE OR 1 SECTION
 1 TOWNSHIP = 36 MILES SQ OR 36 SQ MILES OR 36 SECTIONS
 1 ACRE IS ABOUT 208.75 FT SQUARE OR CONTAINS 43,560 SQ FEET OR
 ANY RECTANGULAR TRACT, THE PRODUCT OF THE LENGTH AND WIDTH OF
 WHICH TOTAL 160 SQ. RODS, WILL EQUAL 1 ACRE.

ANCHOR

A Mutual-Cooperative Savings Institution

SAVE *and* HAVE

The

Insured ANCHOR Way

Where 3% Dividends Really Pay

Principal Is Insured to \$10,000.00 by the Federal Savings & Loan Insurance Corporation of Washington, D.C.

ANCHOR

Madison's Popular House of Thrift and Thrift Home Financing

with Assets Exceeding 32 Million Dollars

FOR A SECURE FUTURE – SAVE AT ANCHOR

The Anchor Savings and Loan Association

2 So. Carroll St.

Madison 5, Wis.

**Bigger, Better
Crops with...**



6 Plant Foods Guaranteed



IN BULK OR BAGS

See Your Nearest Dealer

COMSTOCK SEED & FEED COMPANY	Madison
COMSTOCK SEED & FEED COMPANY	Waukegan
BORST & WILLOUGHBY	Belleville
CAMBRIDGE FEED & SEED COMPANY	Cambridge
CITY FEED MILL	Stoughton
COTTAGE GROVE LUMBER COMPANY	Cottage Grove
DEERFIELD FARMERS COOP.	Deerfield
THEO. EDWARDS & SON	McFarland
FISHER'S STORE	Sun Prairie
HOME FEED COMPANY	Morrisonville
MARTIN FEED COMPANY	Deansville
MIDDLETON FARMERS COOP.	Middleton
OREGON FEED & SUPPLY CO.	Oregon
PATRONS MERCANTILE COMPANY	Black Earth
PETERS FEED & SEED	Verona
R. K. FEED MILL	Sun Prairie
RUDE & ROBINSON	Mt. Horeb

Southern Wisconsin Produce Co.

633 W. Doty Street

Madison, Wisconsin

See Us for Highest Cash Prices

Tune In on WKOW 12:40 P.M., Also WIBU 12:45 P.M.,
For Daily Market Prices on Poultry and Eggs.

AL 5-4565

**Insurance for the Everyday Needs
of Families and Individuals**



See the Agent in Your Locality

FARMERS MUTUAL INSURANCE CO.

3099 E. Washington Avenue
Madison 1, Wisconsin



GARVER'S SUPPLY COMPANY

Manufacturer and Distributor of Live Stock and Poultry Feeds

3244 ATWOOD AVENUE MADISON 11, WIS. TELEPHONE 4-4739

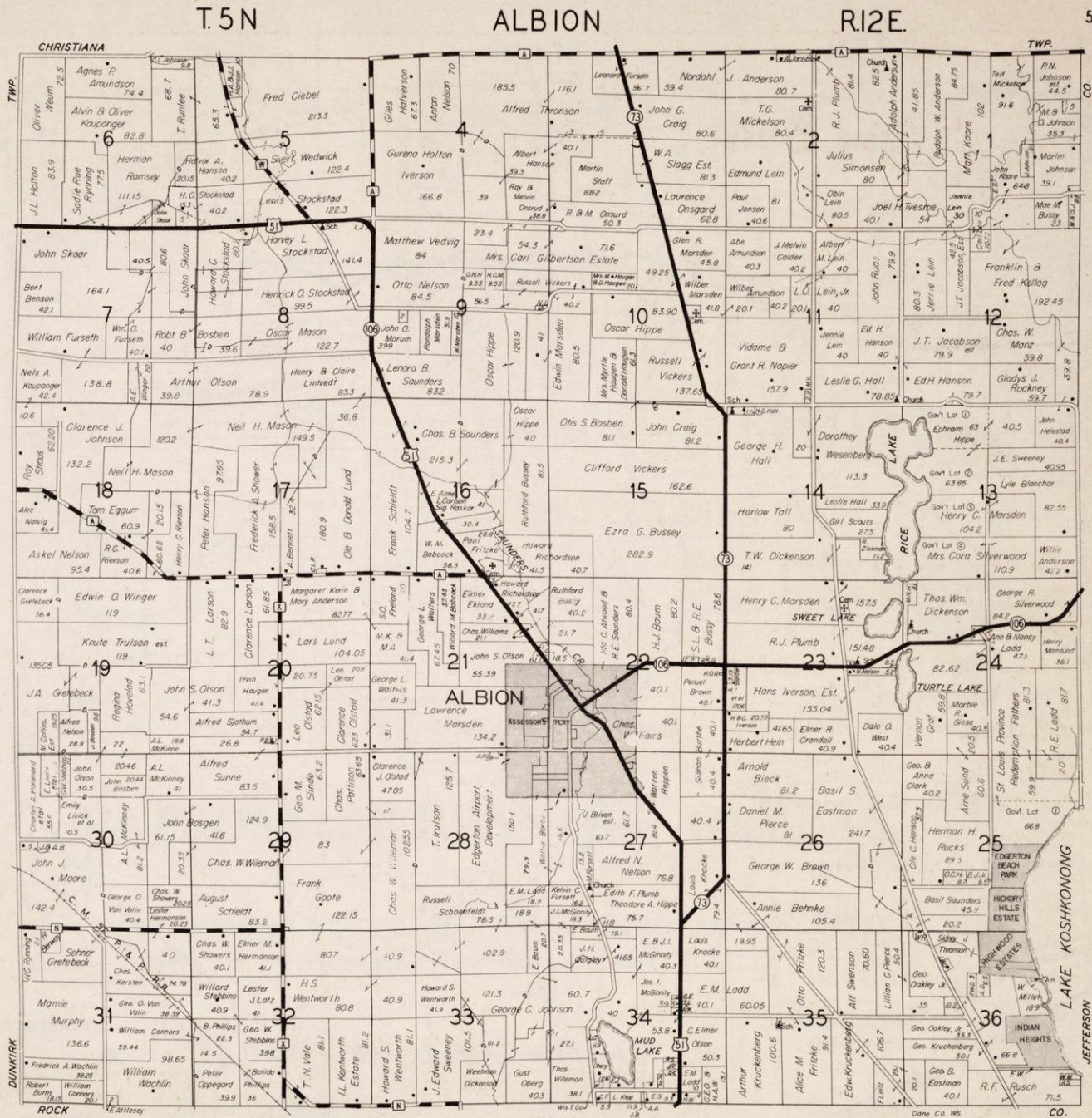

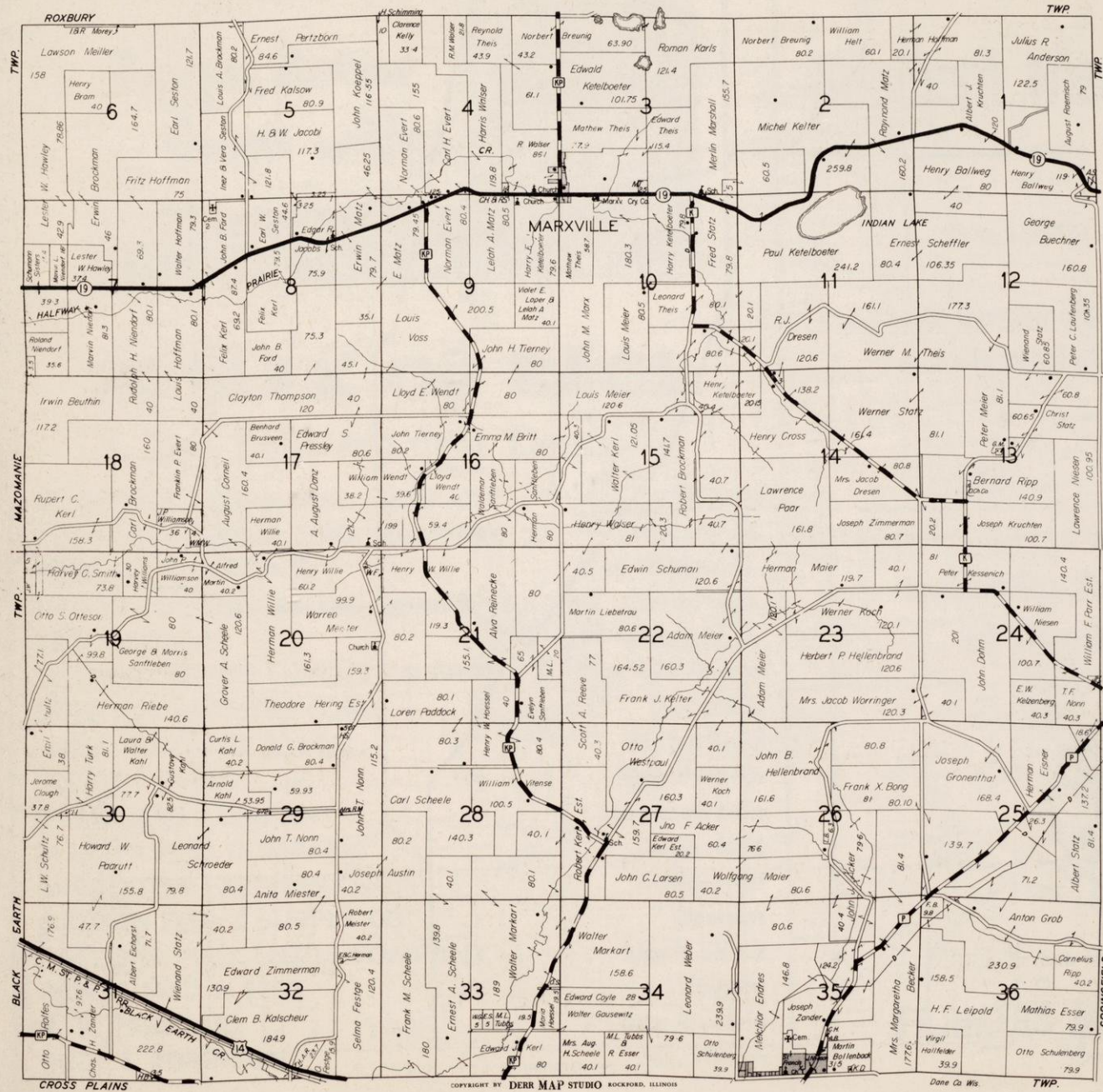

GATEWAY LUMBER COMPANY

A Wisconsin Organization

building experts

OPERATING RETAIL YARDS
BLACK EARTH, WISCONSIN

COAL
HARDWARE
PAINT

LUMBER
BUILDING MATERIALS



Black Earth State Bank

MEMBER OF FEDERAL DEPOSIT INSURANCE CORPORATION

Black Earth, Wis.



T.8N.

BLACK EARTH

R.6E.

7

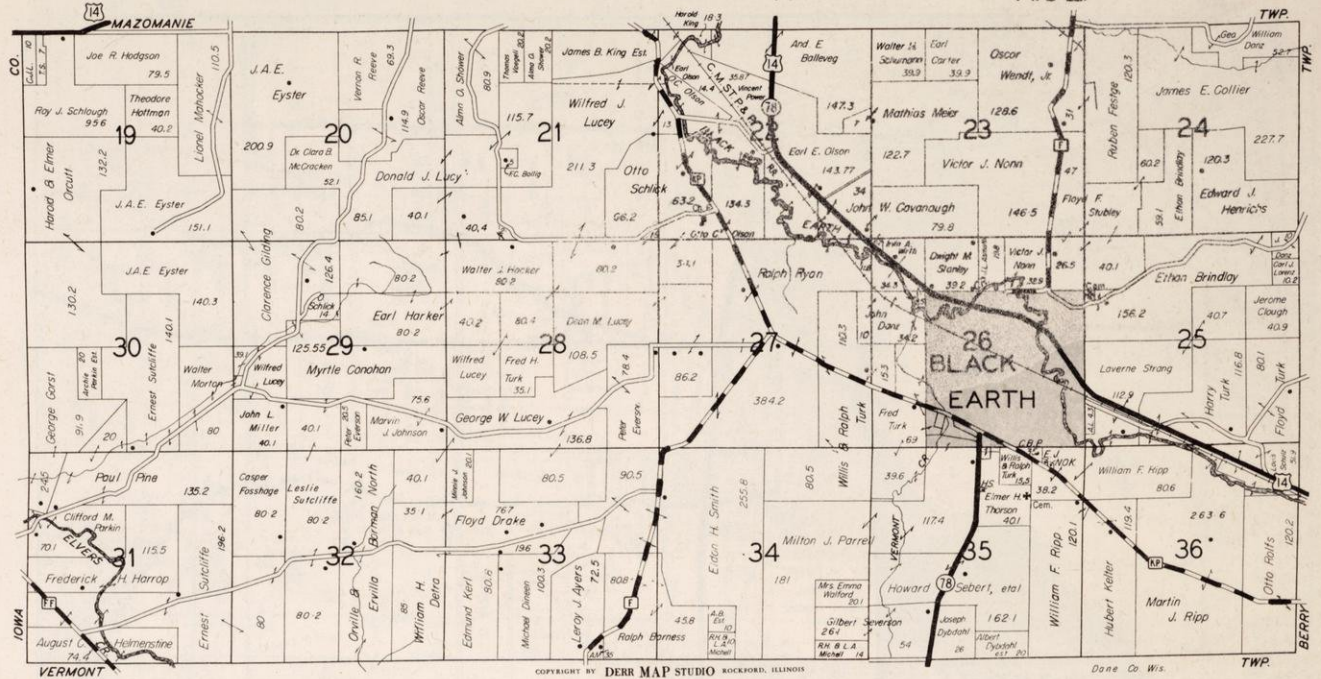

COPYRIGHT BY DERR MAP STUDIO ROCKFORD, ILLINOIS

Dane Co. Wis.

GEORGE CAIRNS, President

RAY E. RETTENMUND, Manager

LEONARD MOE, Secretary

PATRONS' MERCANTILE COMPANY

Dealers in

GROCERIES, GENERAL MERCHANDISE, HARDWARE, FEED,
FARM MACHINERY, GAS AND OIL

Incorporated in 1893

Authorized Capital \$75,000

BLACK EARTH, WISCONSIN

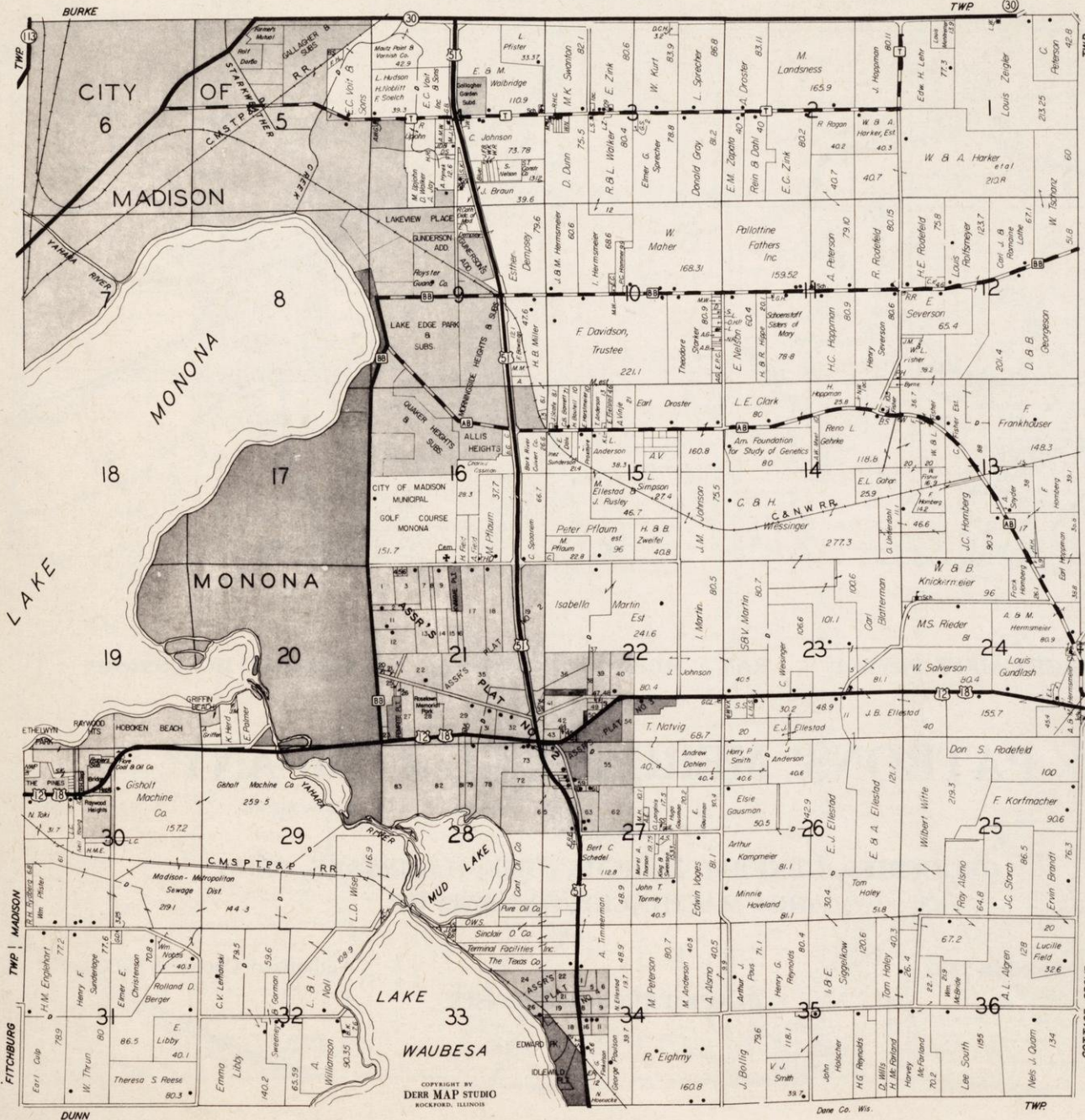

Schroeder & Son

FUNERAL SERVICE

A NAME TO REMEMBER

Established 1906

Air Conditioned — Private Parking

235 KING ST. PHONE AL 5-7924

MADISON, WISCONSIN

Southern Wisconsin

Cattle Credit

Company

An
Agricultural
Credit
Company

LOANS TO FARMERS

H. J. Sedgwick, President
Phone CHerry 4-1944
2334 Atwood Avenue
Madison 4, Wisconsin

Preferred Title Service Co.

COMPLETE ABSTRACT & TITLE INSURANCE SERVICE
ALL LANDS IN DANE COUNTY

Associates:
Arthur E. Engel
Edith G. Brandt
Janice Benz

Perry J. Armstrong
Owner

48 HOUR SERVICE

100 E. Main Street

Alpine 5-9445

Madison, Wisconsin

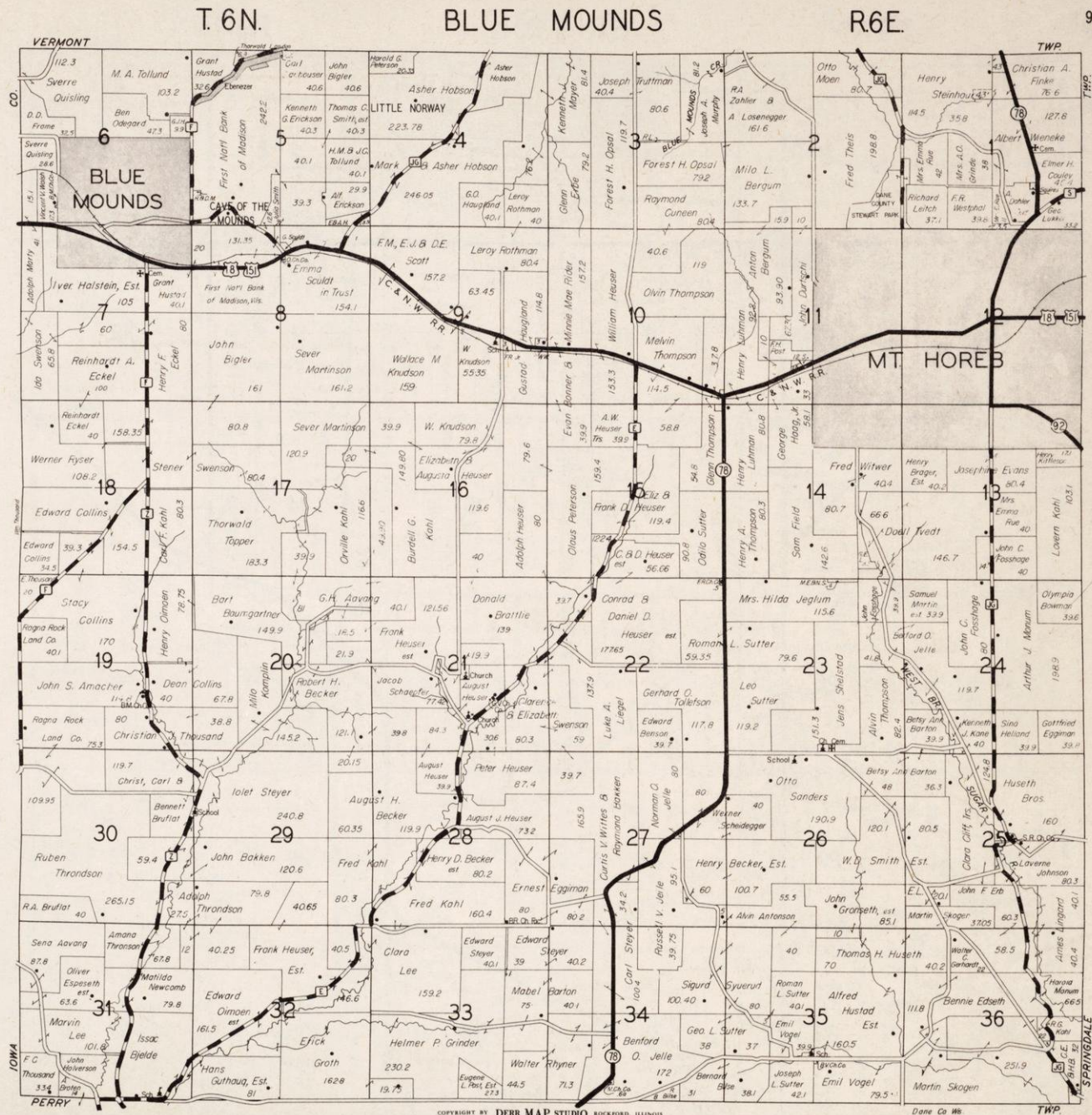

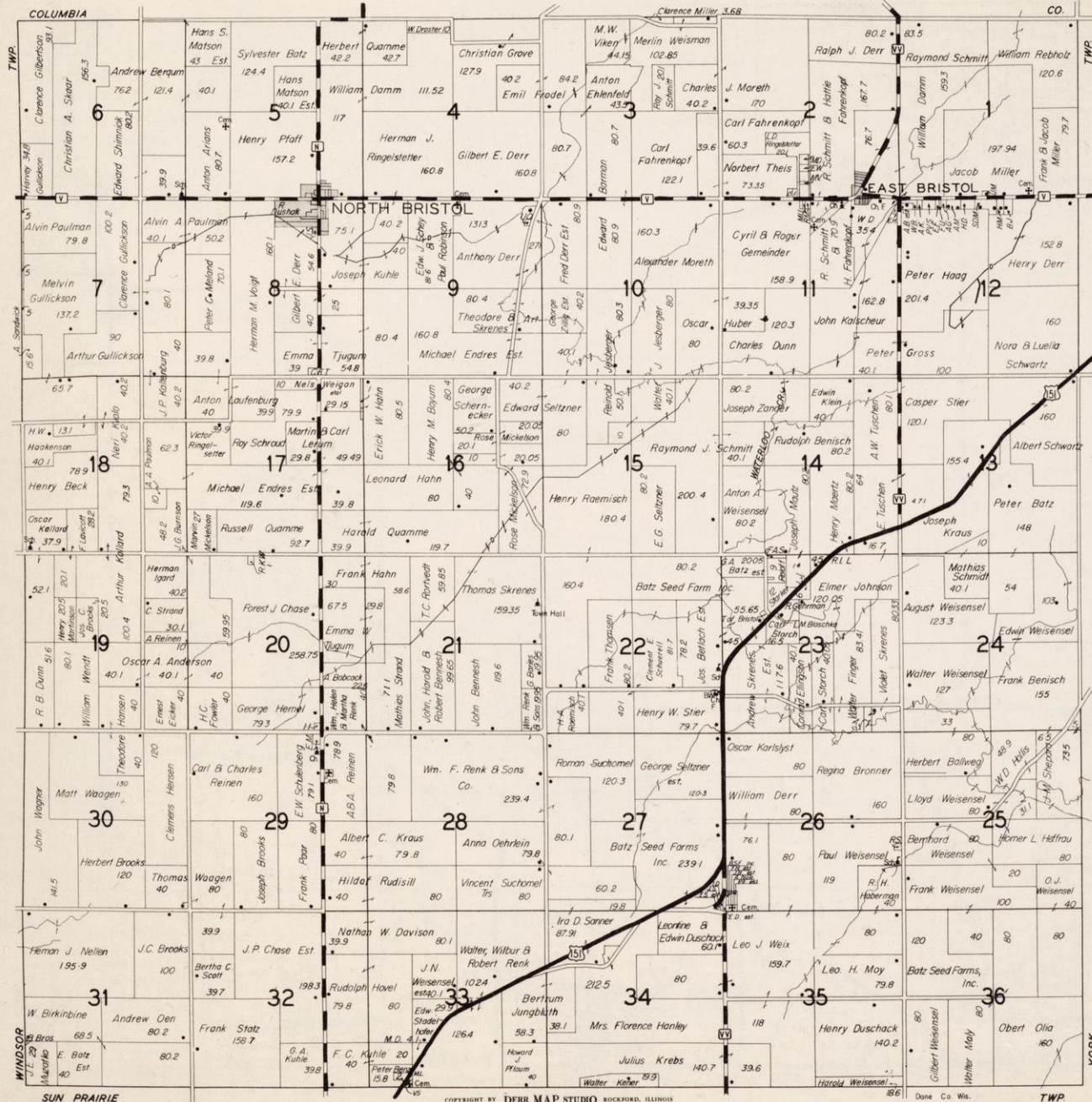

ROBINSON & BELDA AGENCY
REAL ESTATE - INSURANCE

109 Main Street

Sun Prairie, Wisconsin

T.8.N.

BURKE

R.10E.

11



Schroeder & Son
FUNERAL SERVICE
 A NAME TO REMEMBER
 Established 1906
 Air Conditioned — Private Parking
 235 KING ST. PHONE AL 5-7924
 MADISON, WISCONSIN

MIDDLETON FARMERS CO-OP CO.

**Gasoline—Oil—Feed
 Coal—Cement**

**Phone 2117-1
 Middleton, Wis.**

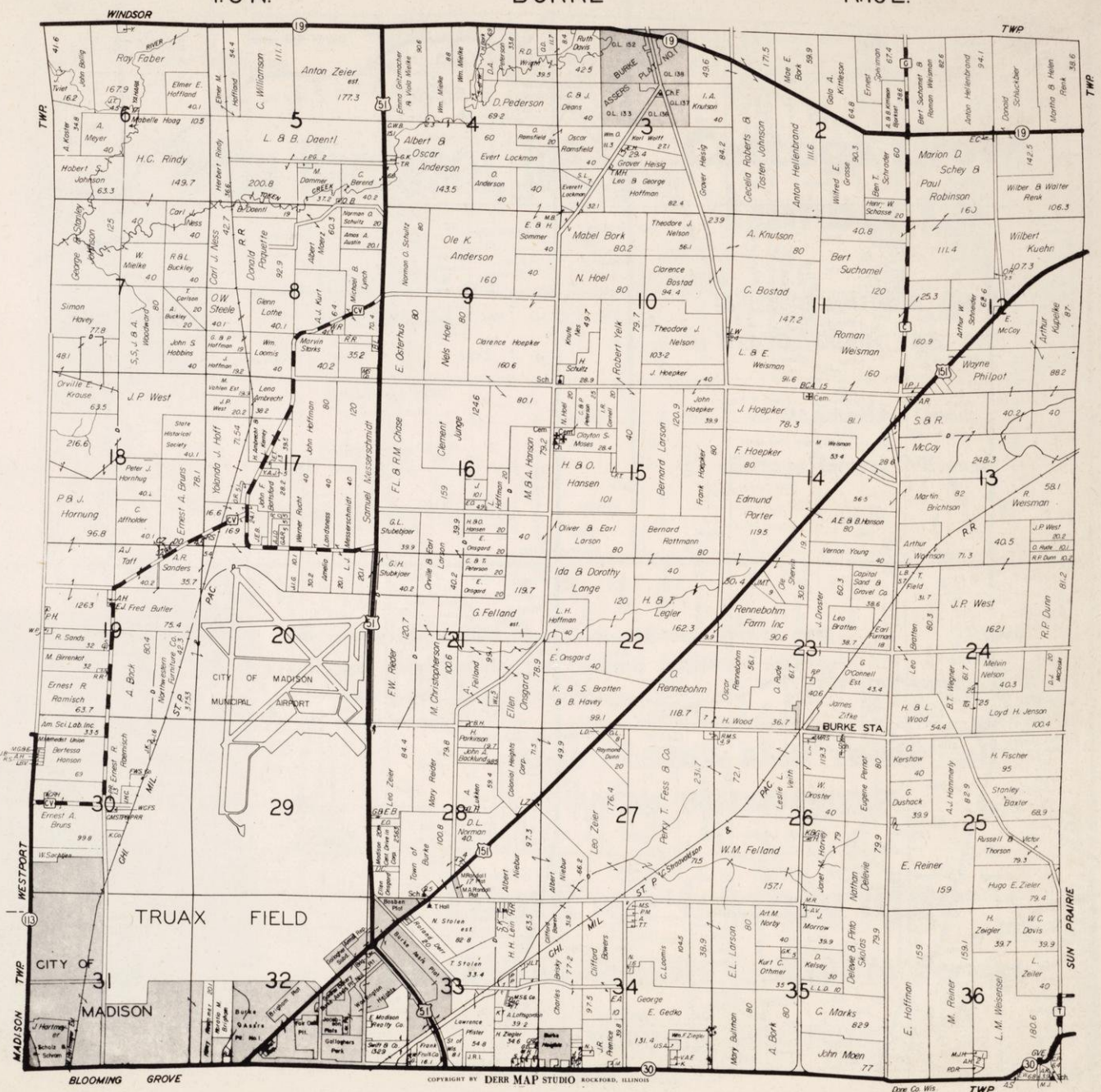

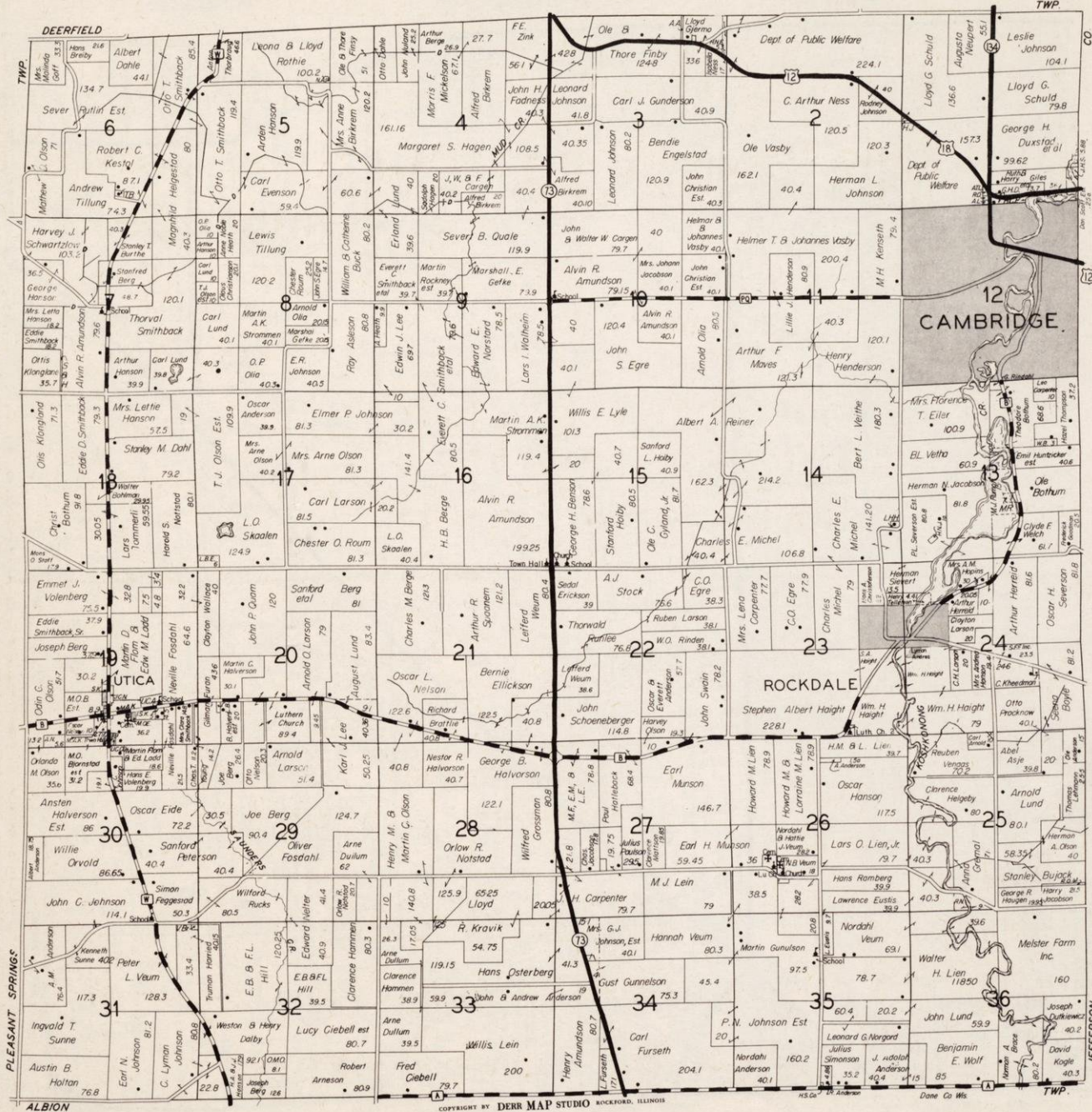

CAMBRIDGE STATE BANK

Member Federal Deposit Insurance Corporation

Phone 113

Cambridge, Wisconsin

**International Harvester
Chevrolet**

**Witte, Farr &
Frost, Inc.**

TELEPHONE 331

COTTAGE GROVE, WISCONSIN

I. J. WITTE, Pres.

C. A. FARR, Vice Pres.

H. E. WITTE, Secy.-Treas.

Witte Hardware, Inc.

**PLUMBING
ELECTRICAL**

Established 1909

Telephone 451

Cottage Grove, Wisconsin

BUILD A HOME NOW

**Cottage Grove
Lumber Co.**

BUILDING MATERIAL, COAL,
WOOD, DRAIN TILE, ETC.

W. M. Adamson, Owner

Cottage Grove, Wisconsin

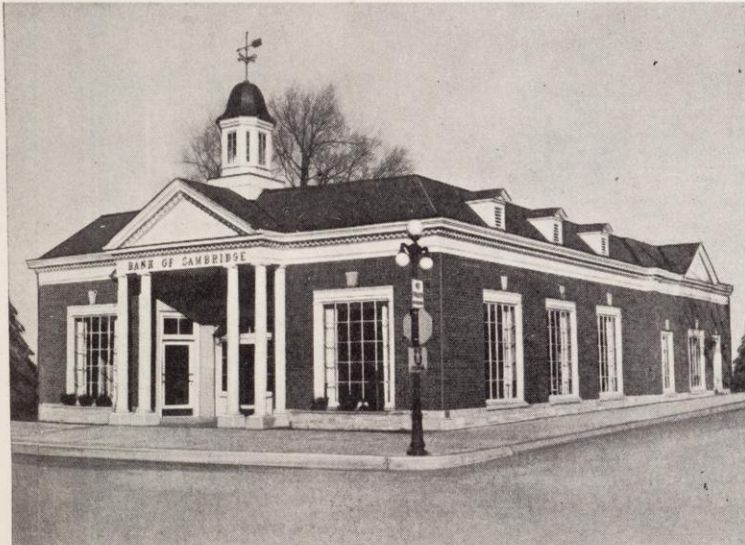

We invite you to call on us and discuss any
of your banking or business problems with us—
we have helped many.

**MAKE THIS NEW BANK YOUR
FINANCIAL HEADQUARTERS**

Bank of Cambridge

Founded on Security - - Built by Service

CAMBRIDGE, WISCONSIN

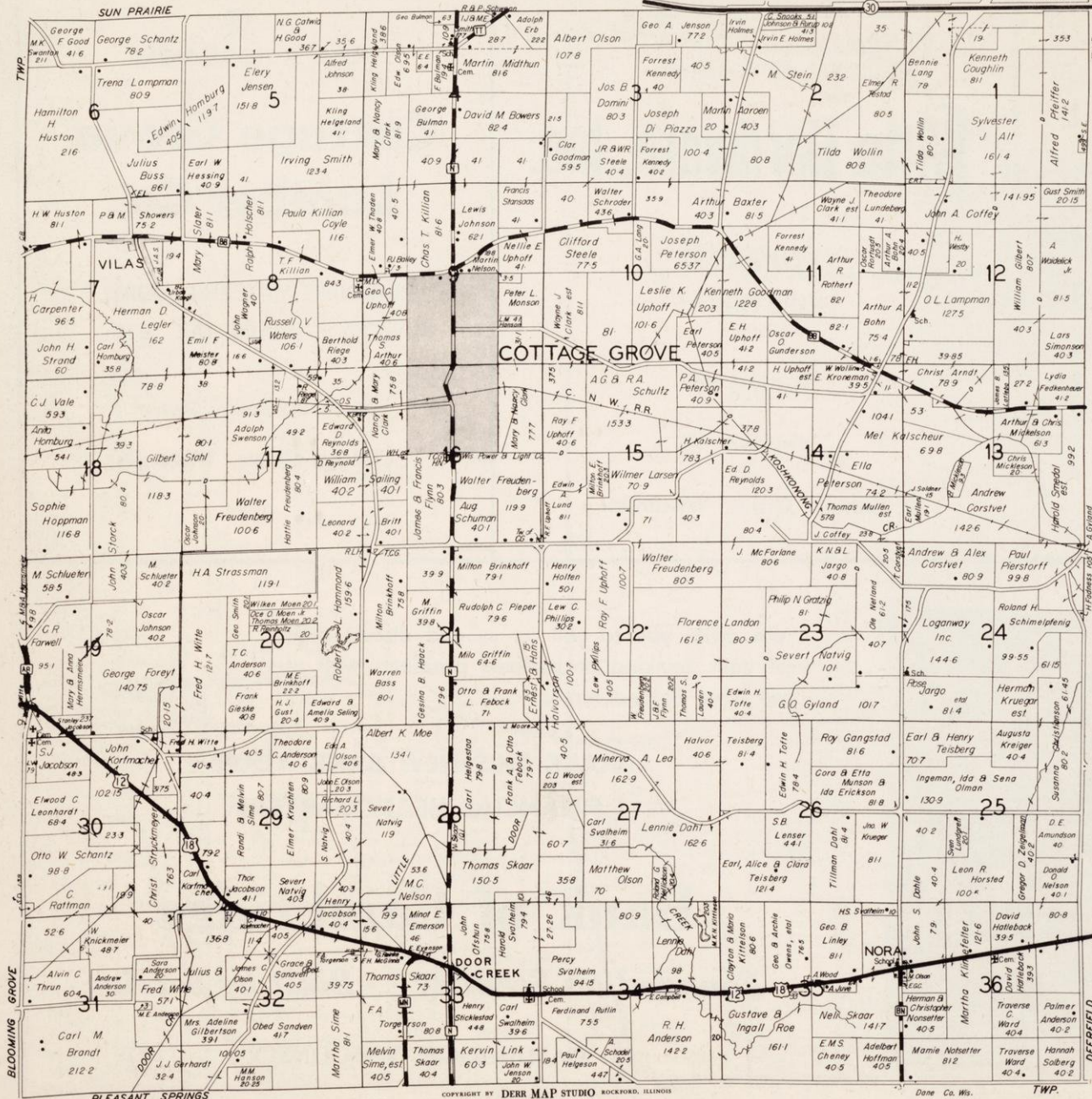

DIRECTORS

- I. J. WITTE
- M. E. BRINKHOFF
- CHAS. H. STRUCKMEYER
- JOHN SCHULTZ
- THOS. J. RIPPCHEN



COTTAGE GROVE STATE BANK

ESTABLISHED 1911

COTTAGE GROVE, WISCONSIN

OFFICERS

- I. J. WITTE, President
- M. E. BRINKHOFF, Vice-Pres.
- THOS. J. RIPPCHEN, Cashier



KALSCHUR

**Implement & Hardware Co.,
Inc.**

Cross Plains, Wisconsin

IH FARM IMPLEMENTS
HARDWARE - APPLIANCES
GEHL AND FOX CHOPPERS

Your Complete Farm Store

**LOUIS
SAEMAN'S
SONS, Inc.**

Since 1876

**Coal
Lumber
Live Stock**

Telephone 44

**CROSS PLAINS,
WISCONSIN**

T.7N.

CROSS PLAINS

R.7E

15

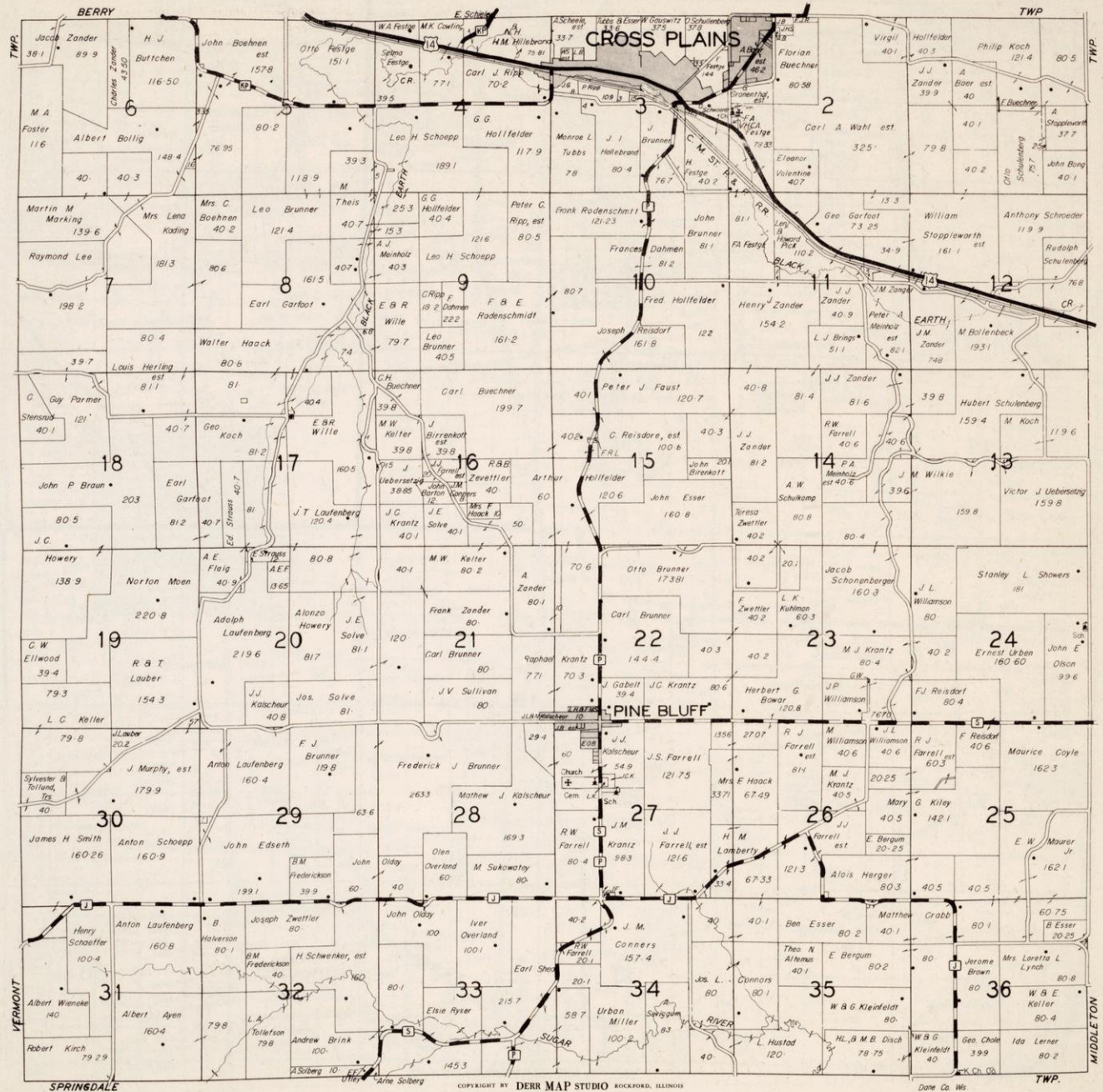

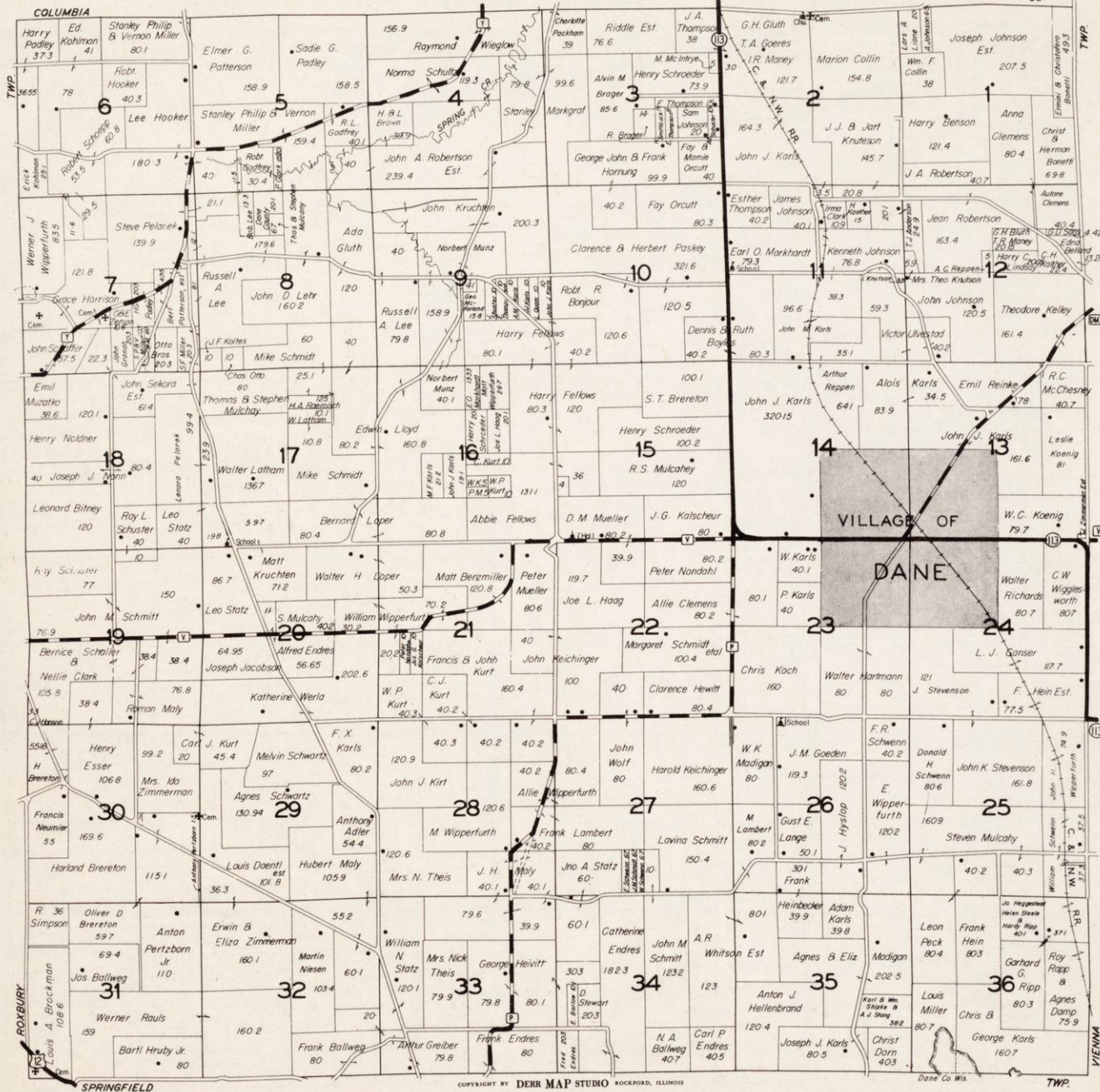

OLIVER

Brooks Implement Co.

Ford Tractors and Implements — Wood Brothers Corn Pickers
 Full Line Oliver Implements — Papec Forage Harvesters



Wisconsin's Largest Parts Stock

Telephone 41

Sun Prairie, Wisconsin

DEERFIELD FARMERS CO-OP

Feed and Seeds
Custom Grinding - Fertilizer - Wire
Fuel Oil - Gas & Lubricating Oil - Greases

Patronize Your Home Co-op

Telephone 107

Deerfield, Wisconsin

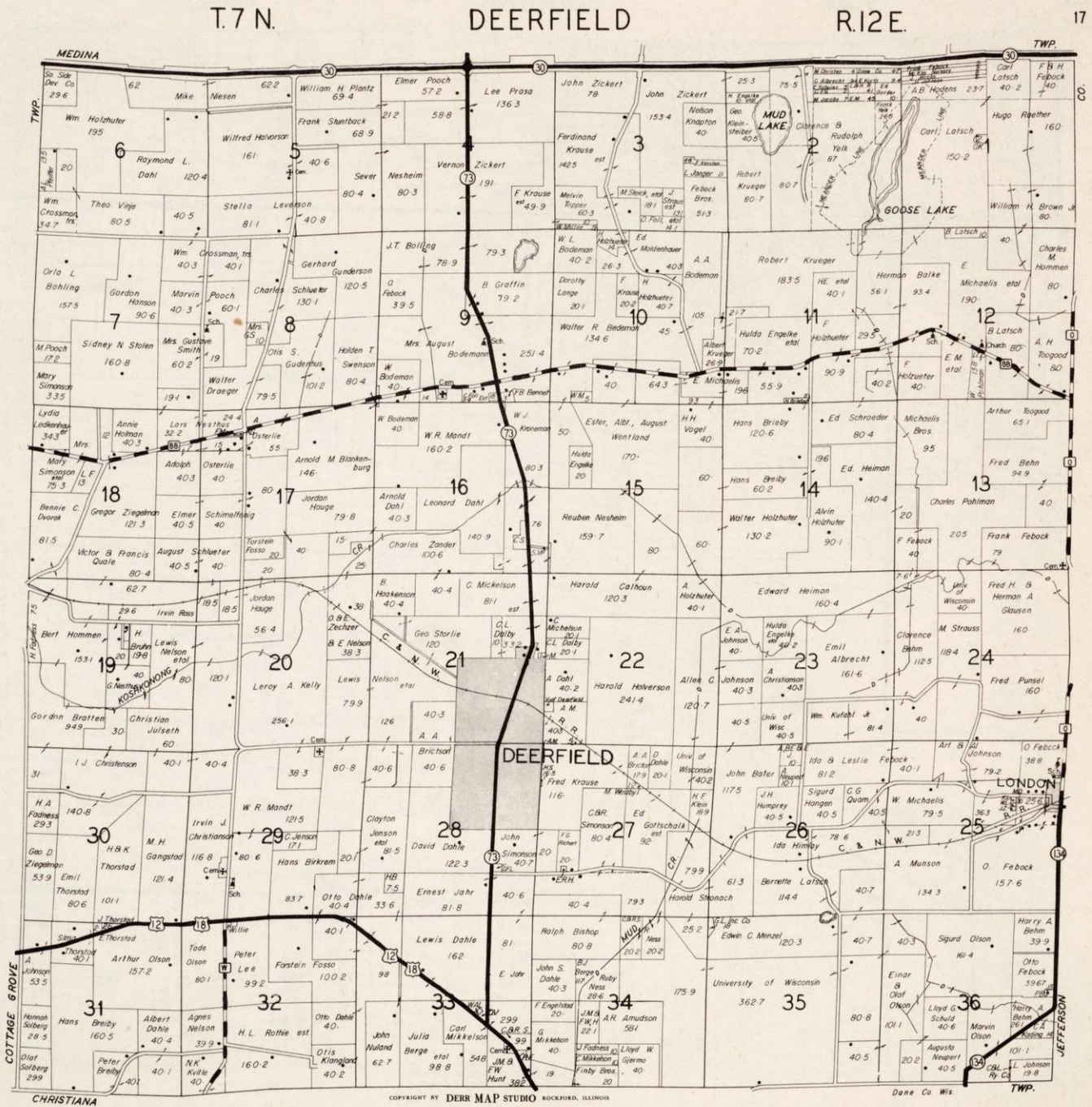

T.7 N.

DEERFIELD

R.12 E.

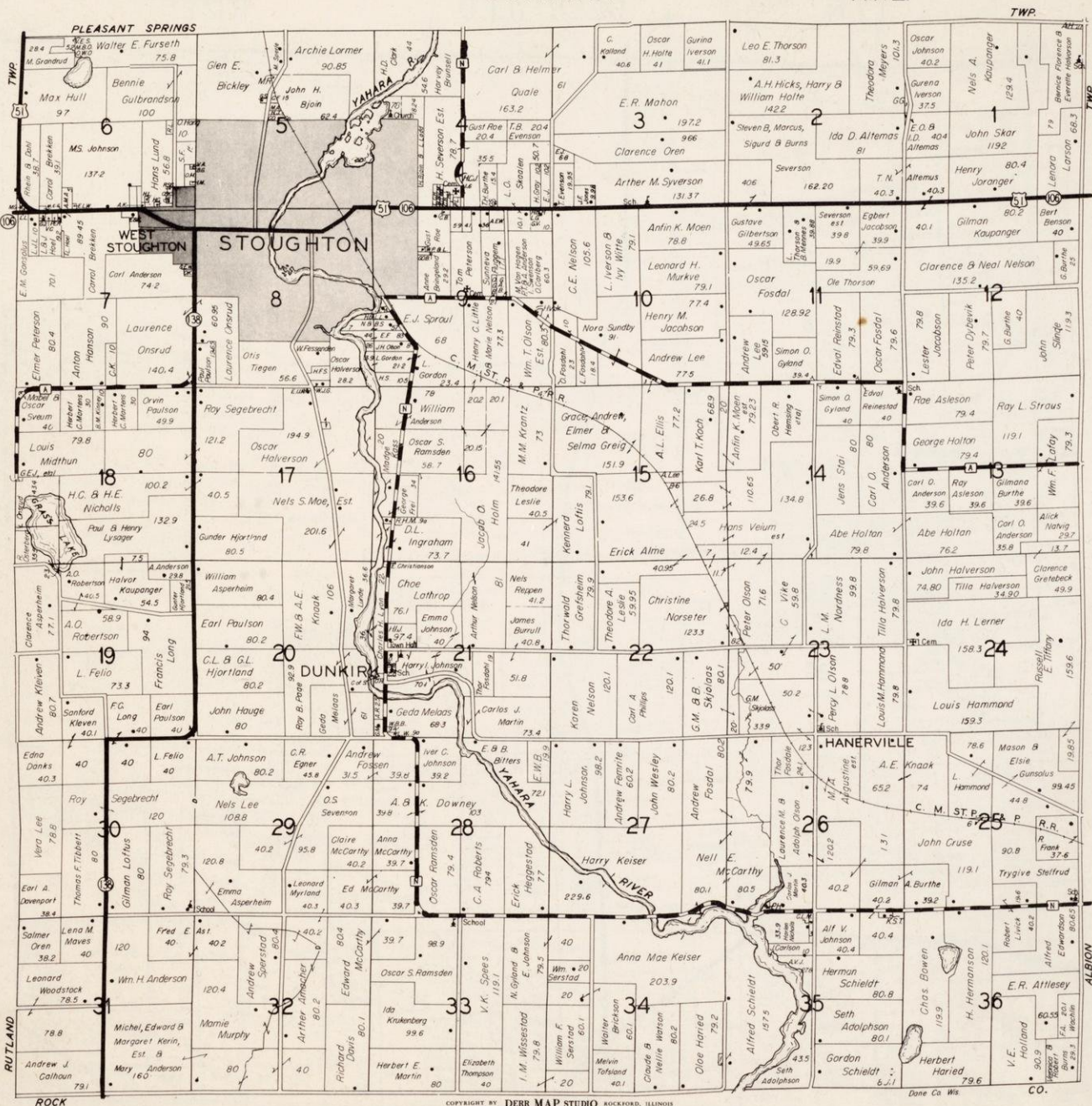

COPYRIGHT BY DEER MAP STUDIO ROCKFORD, ILLINOIS

Armour & Company

STOUGHTON, WISCONSIN

PHONE 380

A Reliable Year 'Round Market
for Your Milk

Dane Co Wis
C.O.

OLIVER

Brooks Implement Co.

Ford Tractors and Implements — Wood Brothers Corn Pickers
Full Line Oliver Implements — Papec Forage Harvesters



Wisconsin's Largest Parts Stock

Telephone 41

Sun Prairie, Wisconsin

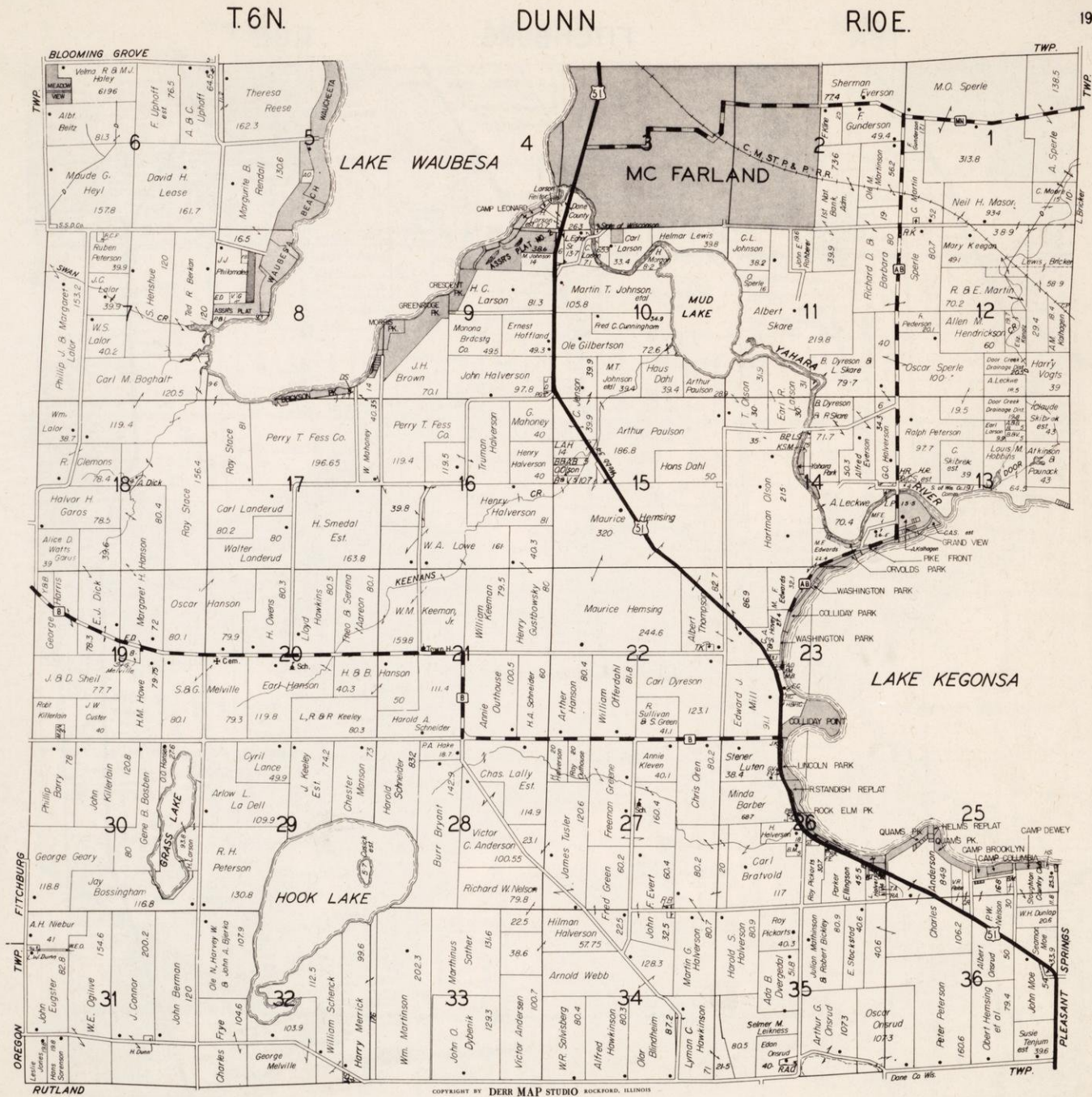

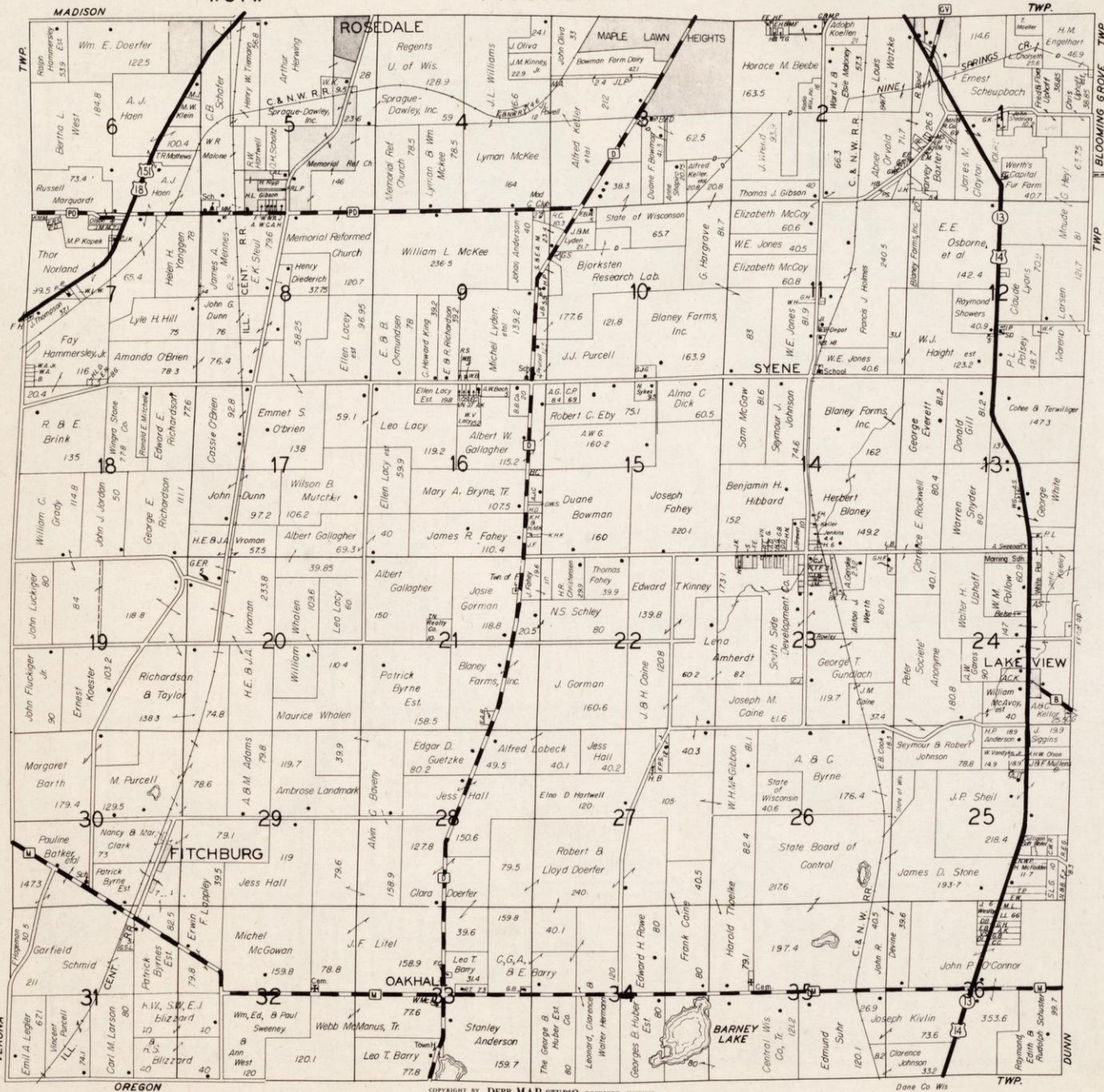

COPYRIGHT BY DERR MAP STUDIO ROCKFORD, ILLINOIS

United Real Estate Corp.



Complete Real Estate Service
 Homes, Income Property,
 Farms, Business Opportunities,
 Auctions

Ground Floor Location — Across From
 Gisholt and New Sears Roebuck Store

1212 E. Washington Ave.

AL 6-8391



SUNNYSIDE HATCHERIES, INC.

Producers of Quality Chicks Since 1910

Complete Line of Poultry Feeds and Remedies

AL 6-7457

635 West Wilson Street
 Madison

**COMSTOCK
SEED & FEED
CO.**

•
HIGH GRADE SEEDS
POULTRY FEEDS
FERTILIZERS

•
2612 Sherman Ave. at
Roth Street—Madison
Phone CH 4-2330

•
Waunakee
Phone 44

**IDEAL
Body Co.**

Fender and Body Repairing
Painting — Upholstering
Frame and Axle Service

502-516 S. Park St. Telephone 5-4075
Madison 5, Wis.

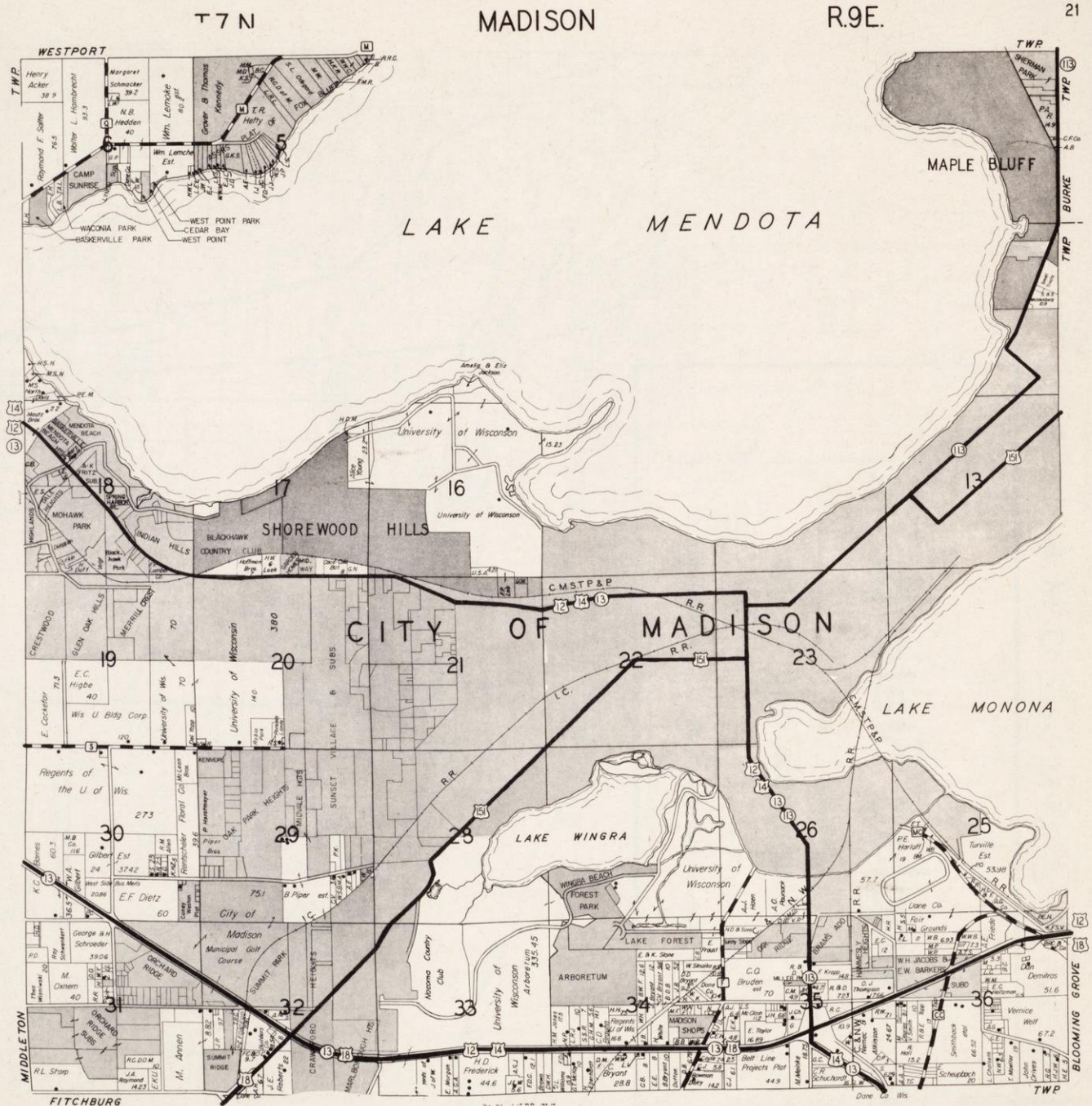

People's State Bank

Mazomanie and Arena

Member of the Federal Deposit Insurance Corporation

T.8&9 N.

MAZOMANIE

R.6E.

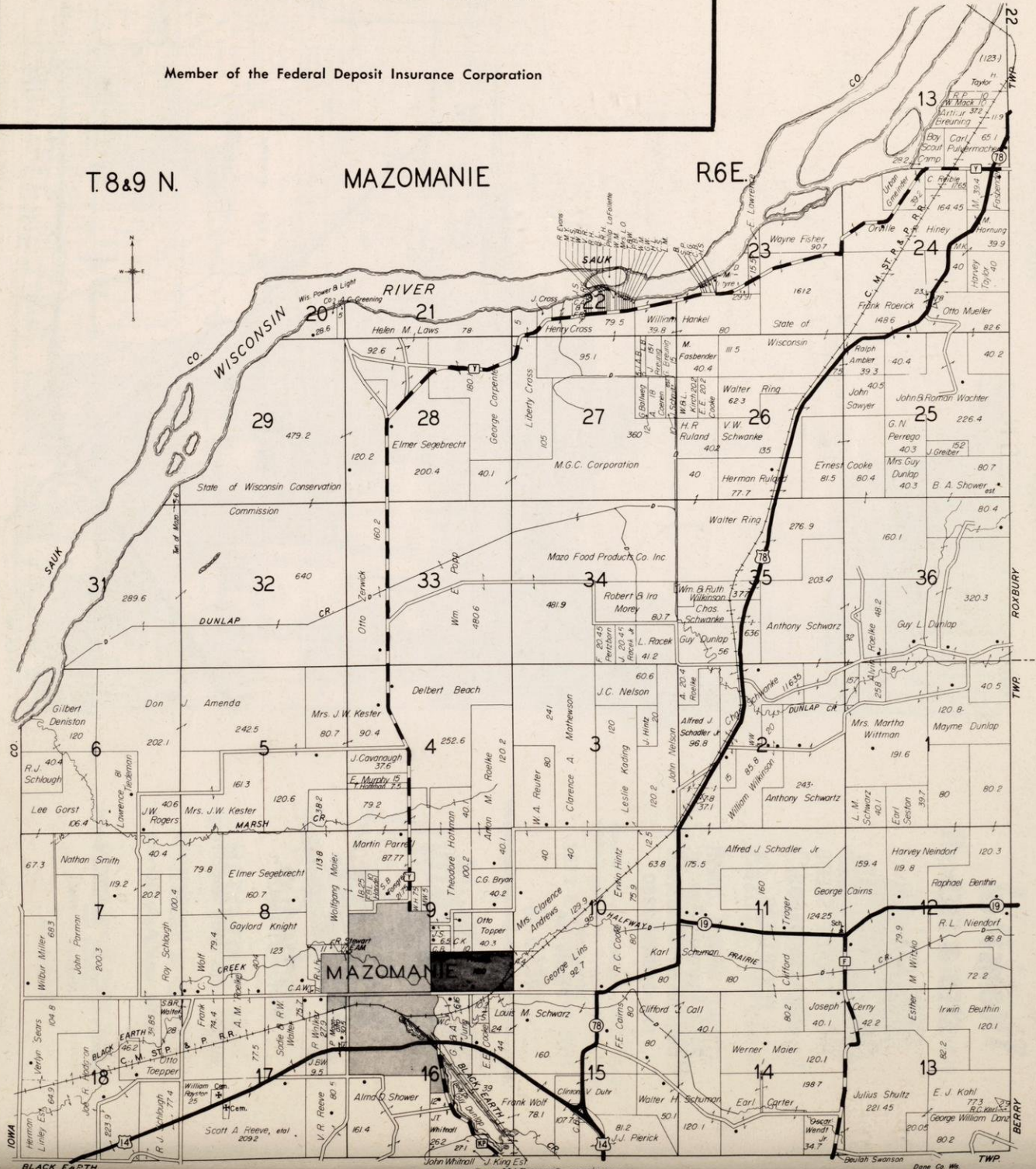

Farmers & Merchants State Bank

"The Old Reliable"

Member of the Federal Deposit Insurance Corporation

MARSHALL

WATERLOO

T.8 N.

MEDINA

R.12 E.

23

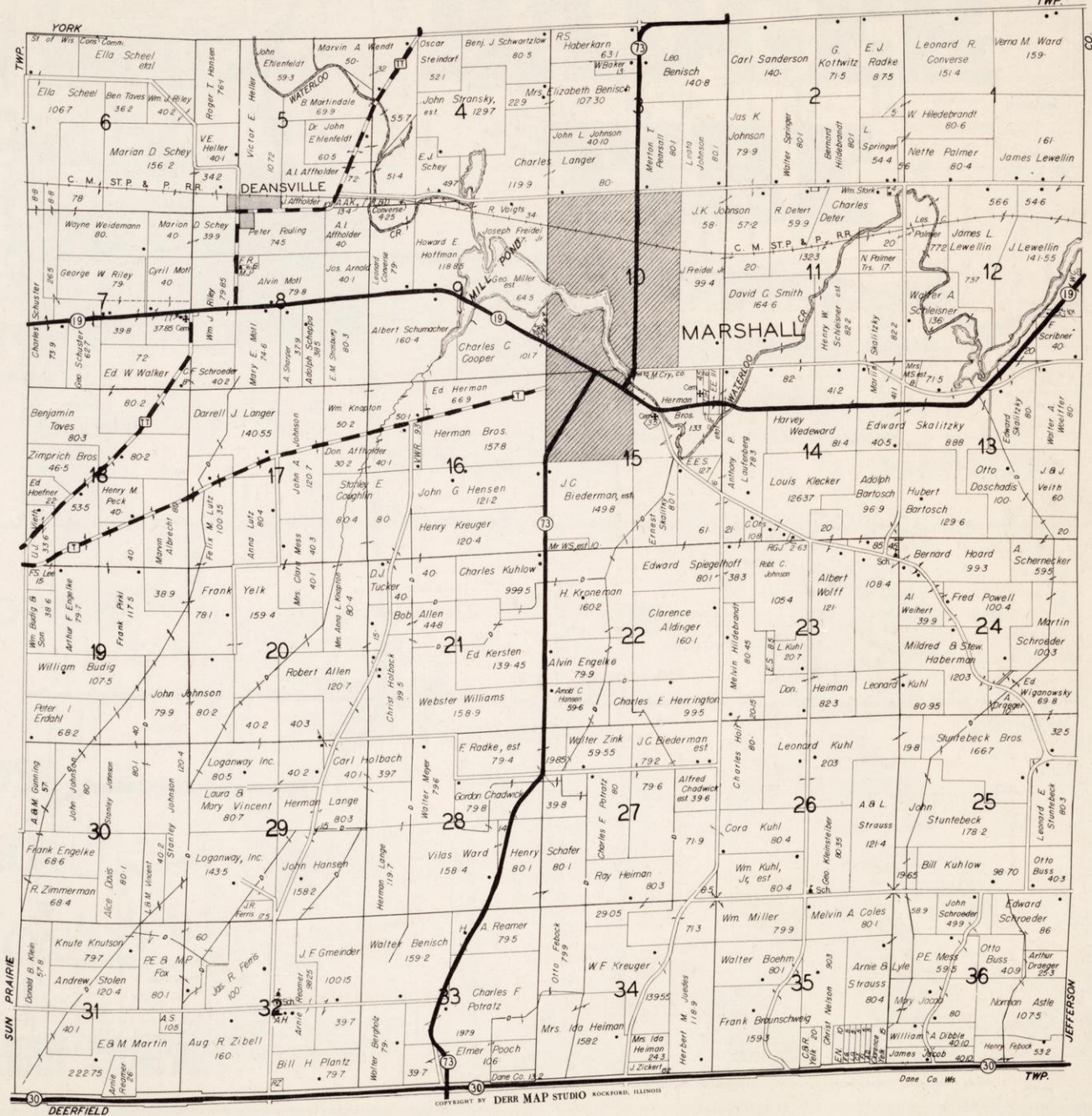

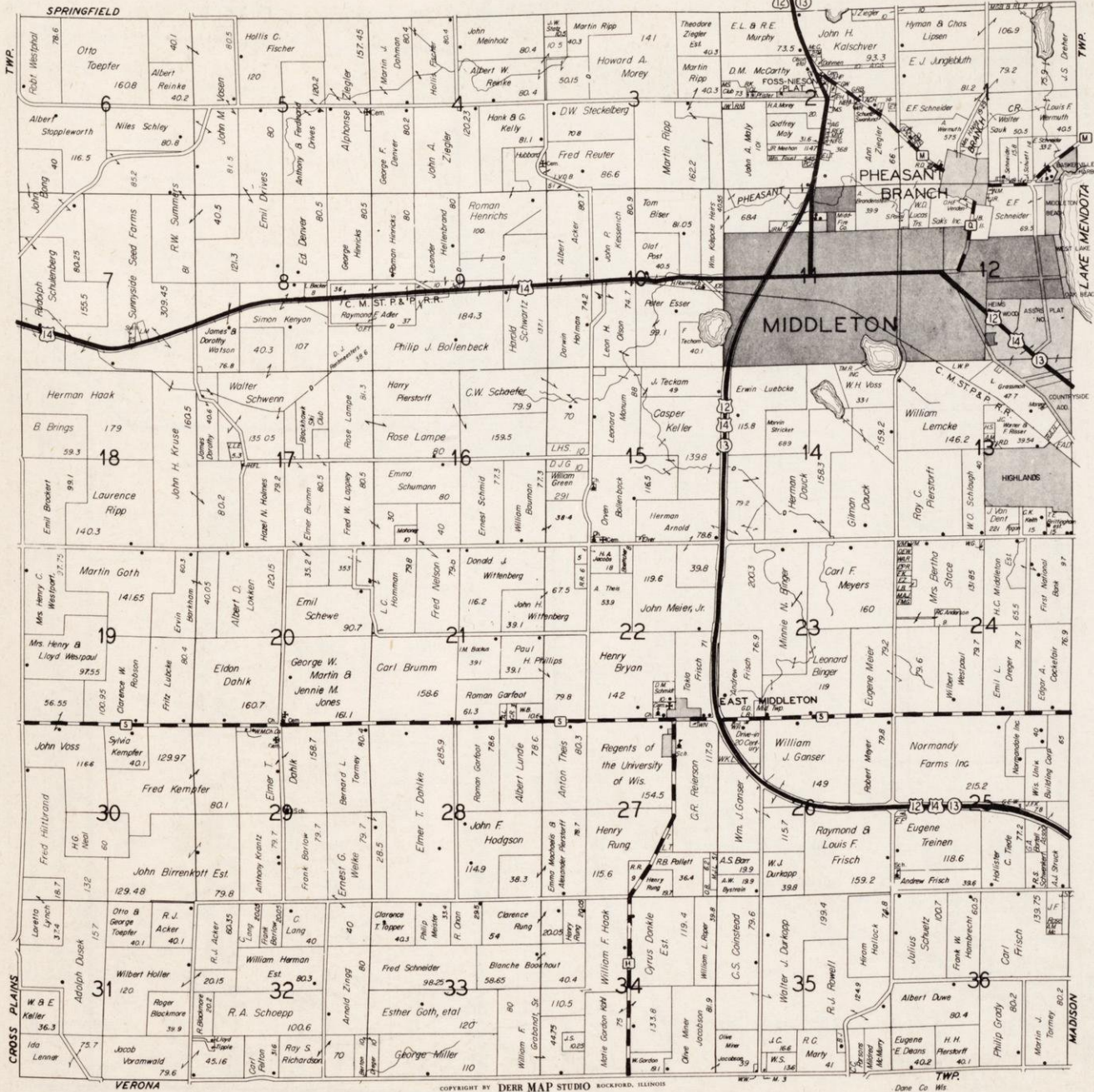

ISAKSEN and O'BRIEN

The name to remember when you want to Buy, Sell or Trade Your Farm or Home in this area.

POST OFFICE BUILDING
MIDDLETON, WISCONSIN
PHONE 2170-1

Home Phones:
BOB ISAKSEN, 2520-1
PAT O'BRIEN, 2639-2

When It's Real Estate
You're Buying,
The First to See Should Be
Isaksen & O'Brien.

- ★ Property Sales & Management
- ★ Appraisals
- ★ Mortgage Loans
- ★ Complete Insurance Service

Bob ISAKSEN and Pat O'BRIEN

Real Estate
Middleton Post Office
Building

JORDAN'S SUPER MARKET

For Low Cost Living

Monday Through Friday – 8 a.m. to 9 p.m.
Saturday 8 a.m. to 6 p.m. – Sunday 9 a.m. to 6 p.m.

Standard Brands at Lowest Prices

East End Middleton

Hys. 12-13-14

BADGER TIRE

TIRES – AUTO SEAT COVERS

Madison's Largest Complete Stock

New – Used – Recaps

1024 Regent Street

Alpine 5-9151

Reddy Kilowatt

IS

★ LOW COST

HIRED HELP ★

DO IT ELECTRICALLY

WISCONSIN POWER and LIGHT COMPANY



PATRONIZE OUR
ADVERTISERS;
THEY MADE THIS
BOOK POSSIBLE

Opitz & Young, Inc.

BUSINESS, CITY AND FARM PROPERTIES
SALES – RENTALS

Dial
AL 7-2271

144 W. Gorham Street

Madison, Wisconsin

The
PROVIDENT
SAVINGS
AND LOAN
ASSOCIATION

Telephone
AL 5-4854

117 S. PINCKNEY STREET
MADISON 1, WISCONSIN

Since



1871

“AMERICAN EXCHANGE”

One North Pinckney – Facing Our State Capitol

THIS BANK

IS ALWAYS READY TO RENDER VALUABLE ASSISTANCE

(Member F. D. I. C.)

*Let A Farm Trained
Organization*

Sell

Your Farm - We Know Farms

TOP REAL ESTATE

2702 Monroe Street Madison Phone Cedar 3-3920

"as near to you as your phone"

RAILROAD SALVAGE STORES

NATIONALLY ADVERTISED BRANDS OF FURNITURE, APPLIANCES,
TV, METAL AND WOOD KITCHENS, DINETTE SETS,
AND 1,000 OTHER HOUSEHOLD AND COMMERCIAL ITEMS.

Store No. I
732 WILLIAMSON STREET
DIAL CH 5-7997

Store Hours:
8 A.M. - 5 P.M.
Mon. & Fri. Nights Till 9 P.M.

Store No. II
6-8 NORTH STREET
DIAL CH 9-1285

Store Hours:
8 A.M. - 9 P.M. Mon. - Fri.
8 A.M. - 5 P.M. Sat.

We Buy — We Sell — We Trade

JOHNSON WELDING

EQUIPMENT CO., INC.

*Central Wisconsin's Most Complete Sales & Service Center
for Government Agencies, Truckers, Contractors
and Agriculturists*

2470 PENNSYLVANIA AVE.

CHerry 9-2133

MADISON, WIS.

Stoppenbach

SAUSAGE CO.

PHONE 420

JEFFERSON, WIS.

BLIED
Printers-Stationers
122 E. Wash. Ave., Dial 7-1441
MADISON 3, WISCONSIN

COMPLETE REAL ESTATE SERVICE

ALPINE

5-4805



SENATE REALTY
202 E. MAIN ST. MADISON

When you list with us . . . prepare to move

COUNT ON US TO GIVE YOU GREATER SERVICE, WHEN YOU
BUILD, BUY OR SELL YOUR FARM OR CITY PROPERTY

SUNDAYS OR HOLIDAYS — CALL

FRED OLSON — 9-1442

LES BORDSON — 4-3480

WALLY OLSON — 4-8965

WE ARRANGE FINANCING

Our Inspection of Your Property Involves No Obligation to You



MADISON MILK PRODUCERS COOPERATIVE ASSOCIATION

The Dairy Farmers' own Milk Marketing business.
Grade A milk for Madison and other area and distant milk distributors.
Milk for manufacturing in our own modern plant.
A cheese store and dairy fountain we are proud of.
Cheese of all kinds. Ice cream and dairy luncheons.

1709 S. Park St.

AL 6-1986

Madison, Wis.

BRICKER'S
KNOWN FOR VALUES

IMPLEMENTS & FARM SUPPLIES

Nobody Out Trades Bricker's

Middleton, Wisconsin

Phone 2635-1

THE PAUL E. STARK COMPANY

Established in 1907

REAL ESTATE SALES — CITY & FARM
RENTALS — PROPERTY MANAGEMENT — INSURANCE

Member

Madison Board of Realtors
National Association of Real Estate Boards

Street Floor Location — On the Square

ONE WEST MAIN ST., MADISON, AL 6-9011

Madion Silo Company

Manufacturers and Builders of
Cement Stone Silos
and Storage Bins

Box 271, Madison 1, Wisconsin

Division Office

3248 ATWOOD AVENUE
MADISON 4, WISCONSIN



Telephone
4-1363

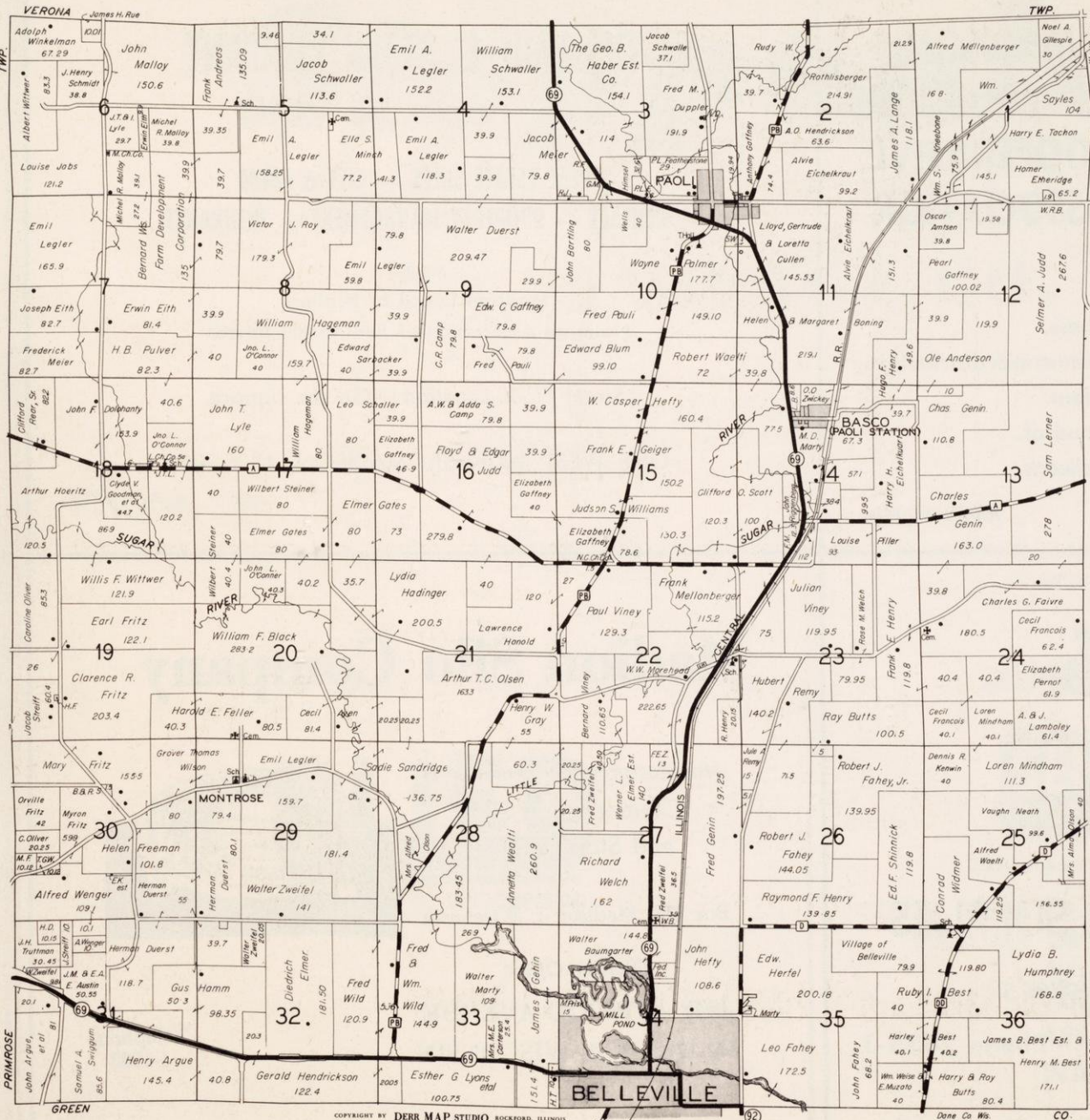

CITIZENS STATE BANK

BELEVILLE, WIS.

Complete Banking Service

Member
Federal Deposit Insurance Corporation

TRIBBEY IMPLEMENT COMPANY

Brooklyn, Wisconsin

INTERNATIONAL TRUCKS
FARMALL TRACTORS
McCORMICK FARM IMPLEMENTS
INTERNATIONAL HARVESTER
REFRIGERATION

Parts — Service
Accessories — Supplies

James Barn Equipment

PHONE: 33

**PAOLI
CO-OP DAIRY CO.**

*Manufactures of
Butter and Cheese*

HANDLERS OF
GRADE "A" MILK

Belleville, Wis.
Telephone Verona 33



Incorporated 1940
M. Curtis Pearson, Pres.
435 W. WASHINGTON AVE.

REAL ESTATE
SALES — APPRAISALS
MANAGEMENT
INSURANCE

-
- ★ Friendly
- ★ Dependable
- ★ Experienced
-

MADISON, WISCONSIN

BELLEVILLE STATE BANK

BELLEVILLE, WISCONSIN

CAPITAL and SURPLUS \$100,000



Interest Paid on Savings and Time Certificates of Deposit

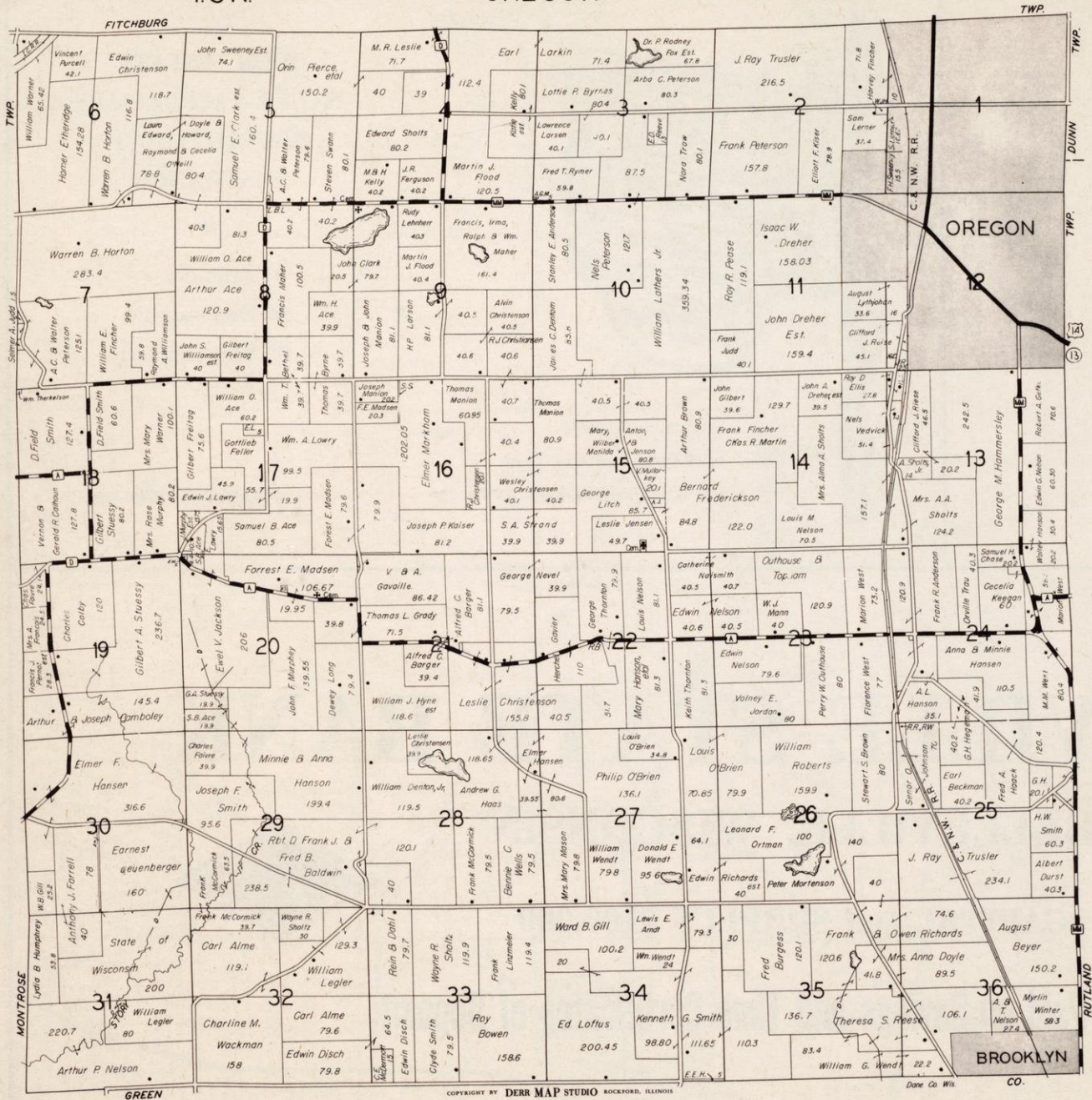

**MCKENNA
& CO., INC.**

**Merchandisers
of
Madison Real Estate**

Dial AL 6-0224

122 W. Washington Ave.

OLIVER

Brooks Implement Co.



Ford Tractors and Implements — Wood Brothers Corn Pickers
Full Line Oliver Implements — Papec Forage Harvesters

Wisconsin's Largest Parts Stock

Telephone 41

Sun Prairie, Wisconsin

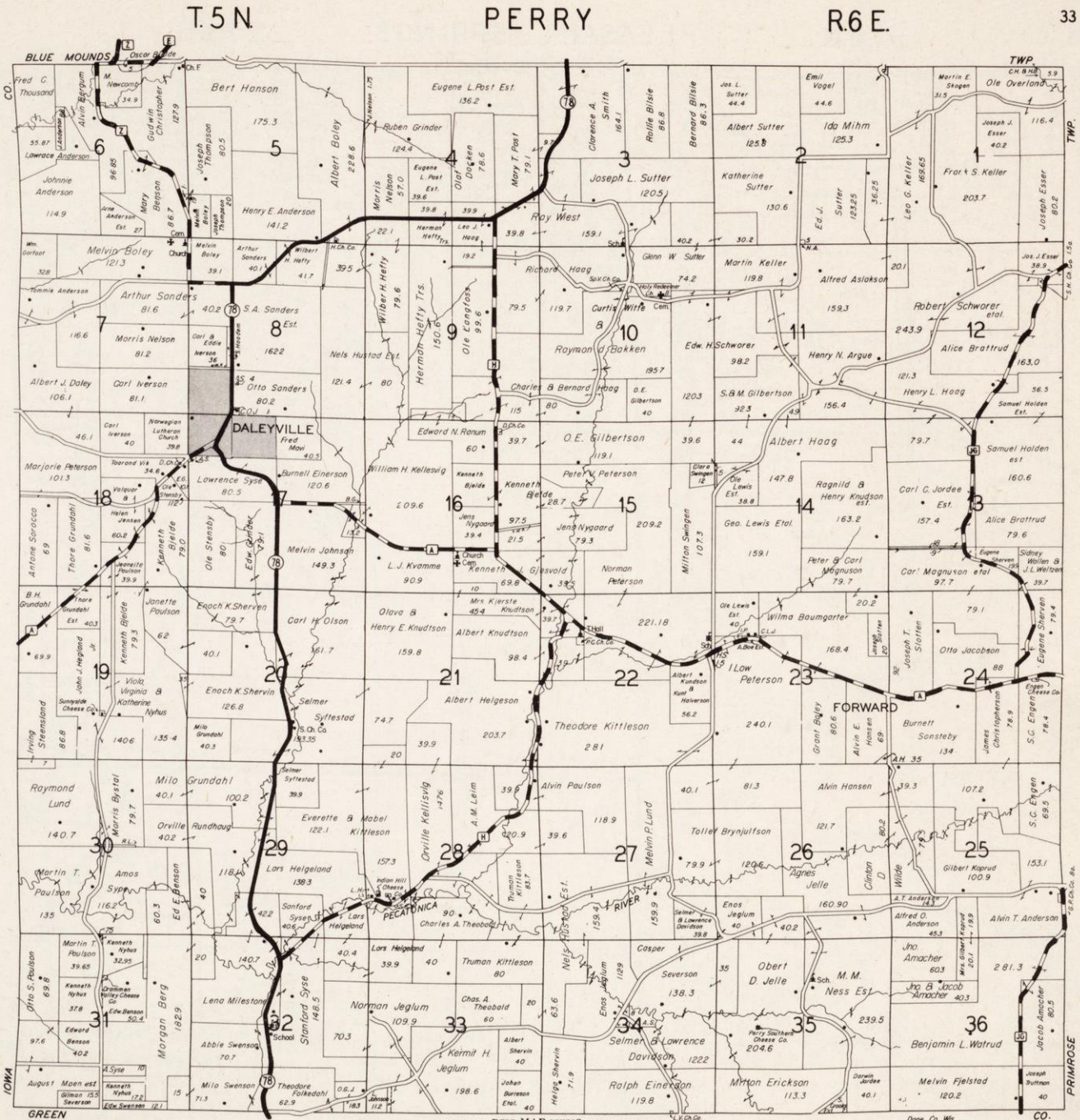

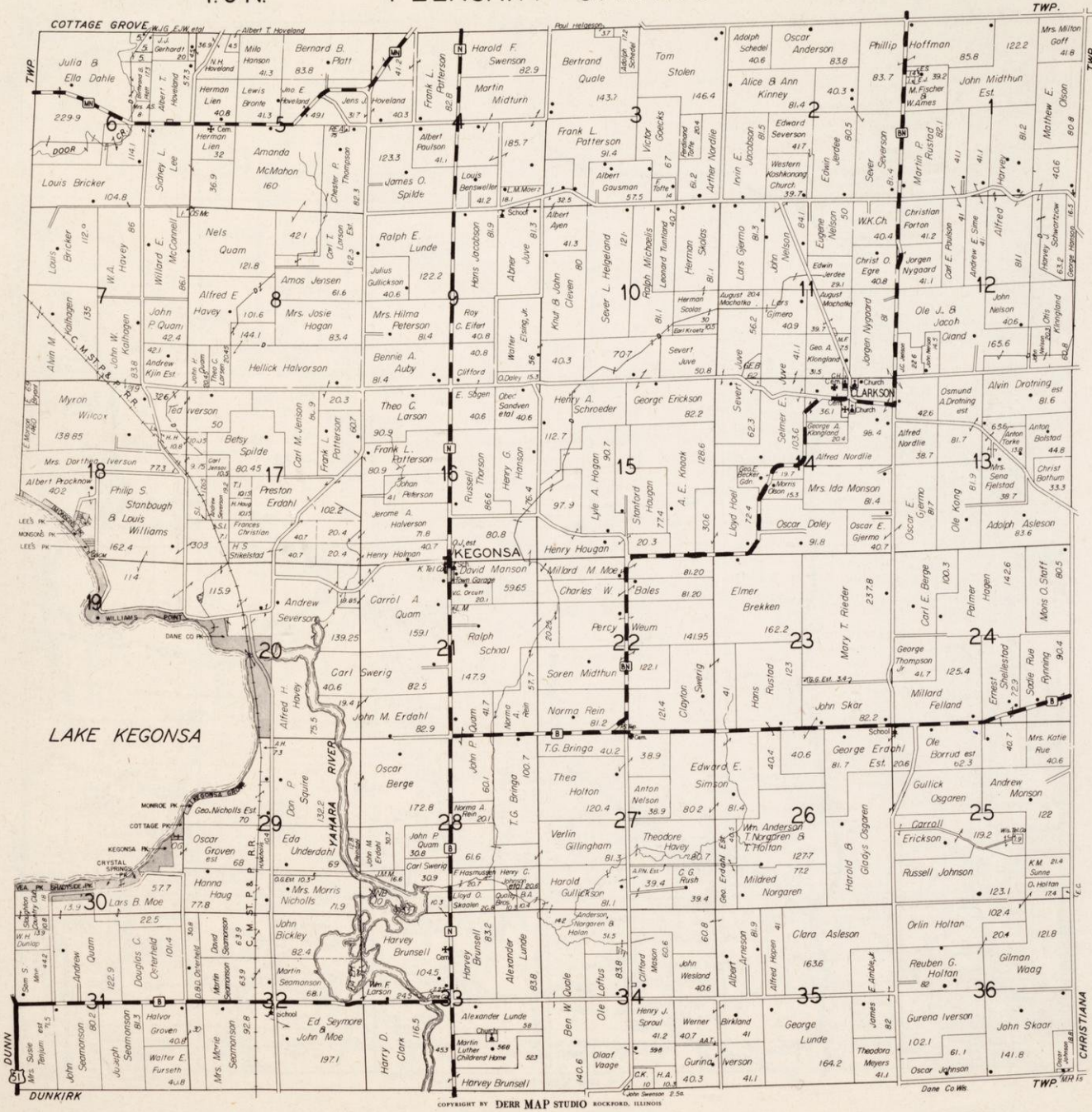

DANE COUNTY PLAT BOOKS

This new 1955 issue of our Dane County Plat Book is the result of many days of careful research of the records in the Dane County Court House. They will be available at your local weekly newspaper office or will be mailed to you, postage paid, on remittance of \$2.50 to

EAST SIDE PRINT SHOP, Inc.

2004 Winnebago Street

CH 4-6218

Madison, Wisconsin

OLIVER

Brooks Implement Co.

Ford Tractors and Implements — Wood Brothers Corn Pickers
Full Line Oliver Implements — Papec Forage Harvesters

Wisconsin's Largest Parts Stock

Telephone 41

Sun Prairie, Wisconsin



T.5 N.

PRIMROSE

R.7 E.

35

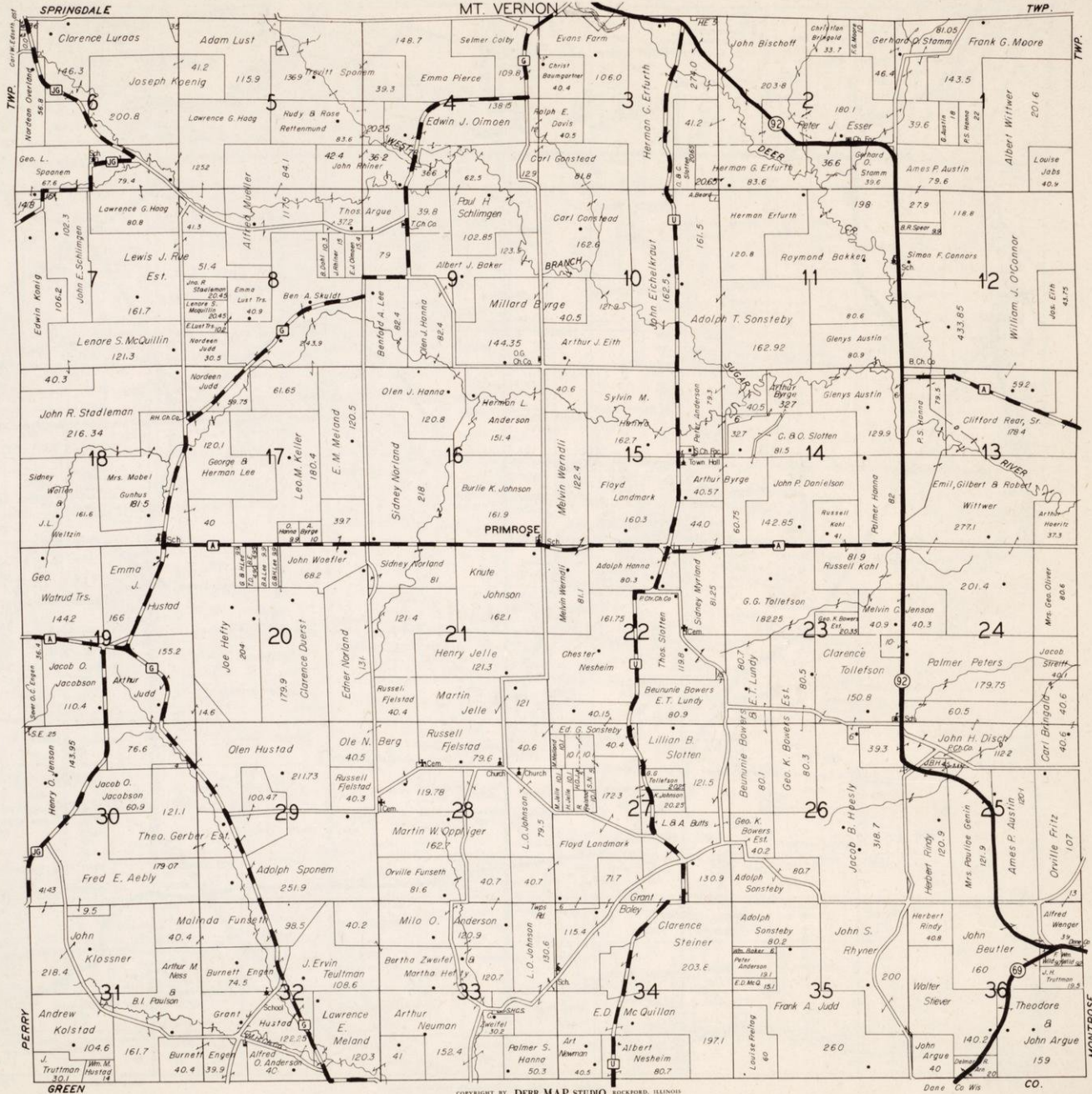

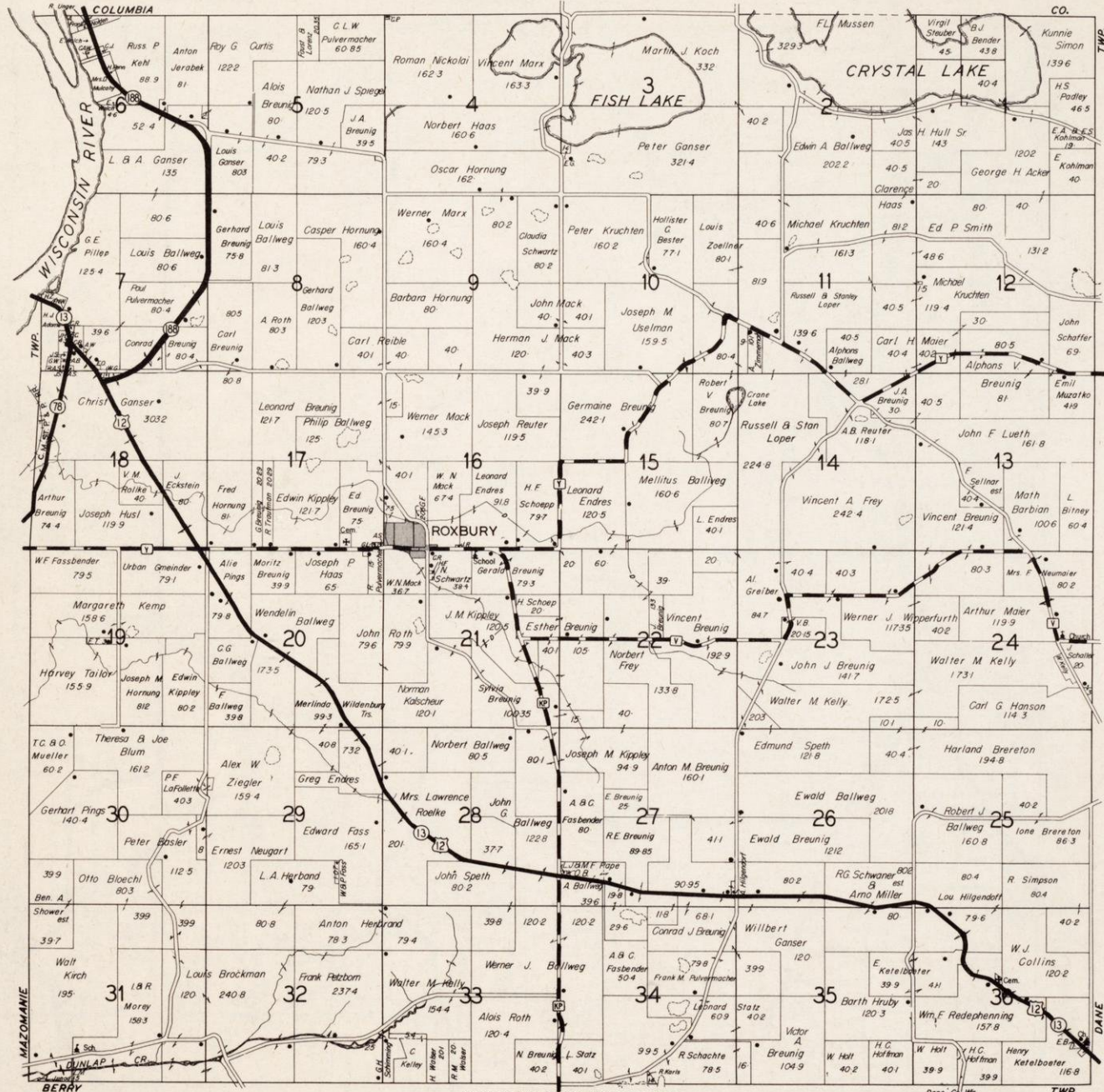

FARMERS & CITIZENS BANK

MEMBER FEDERAL RESERVE SYSTEM

SAUK CITY, WISCONSIN

UNITED COUNTRY PAPERS

It is possible to get your message to the village and rural residents of a large percentage of Dane County Communities through the use of the advertising columns of United Country Papers. To reach beyond your local area ask your local publisher about placing your advertisement in 10 Dane County weekly papers with a single order and one billing, or call at the office of

UNITED COUNTRY PAPERS

2004 WINNEBAGO STREET

CH 4-6218

MADISON, WISCONSIN

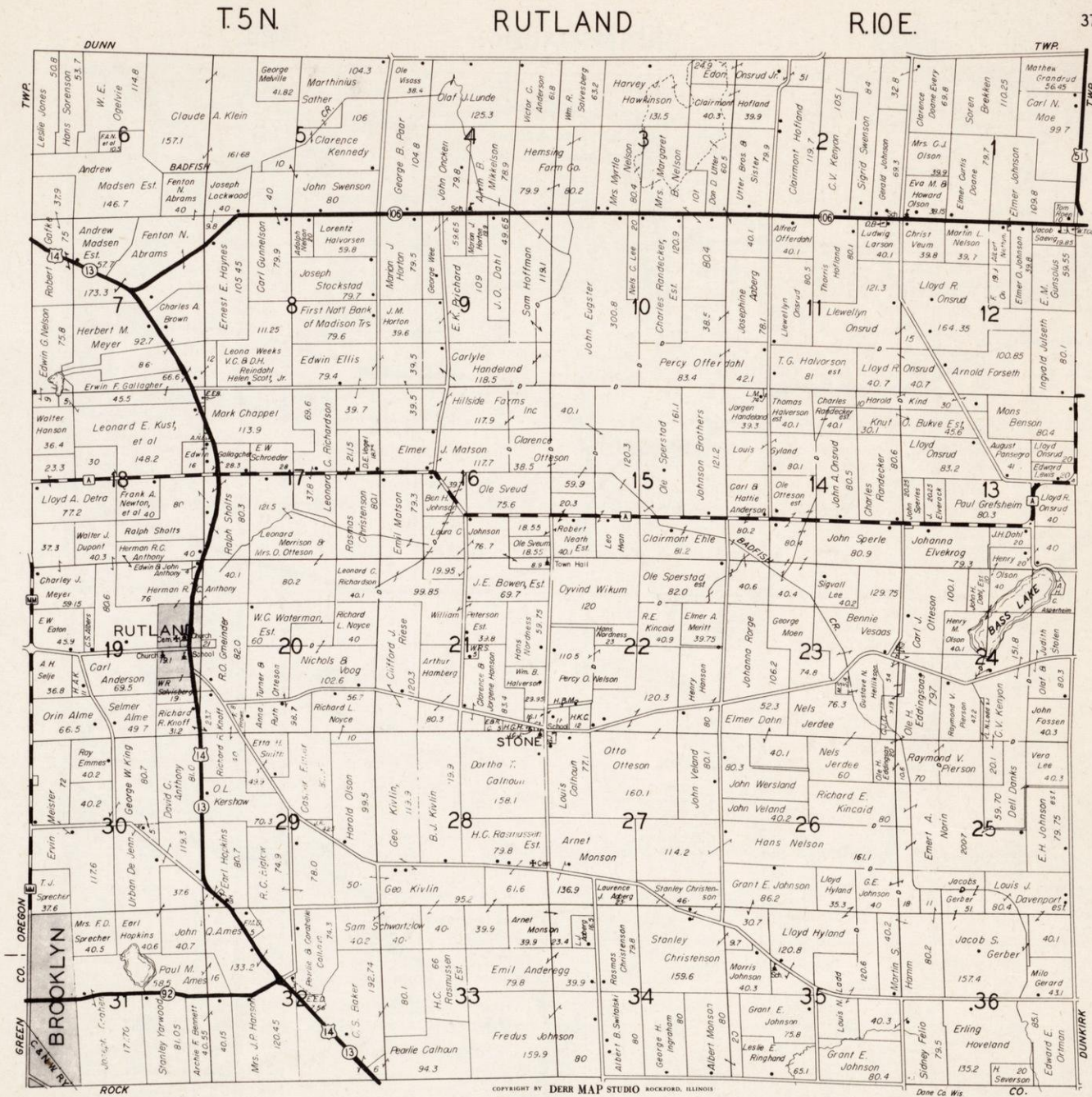

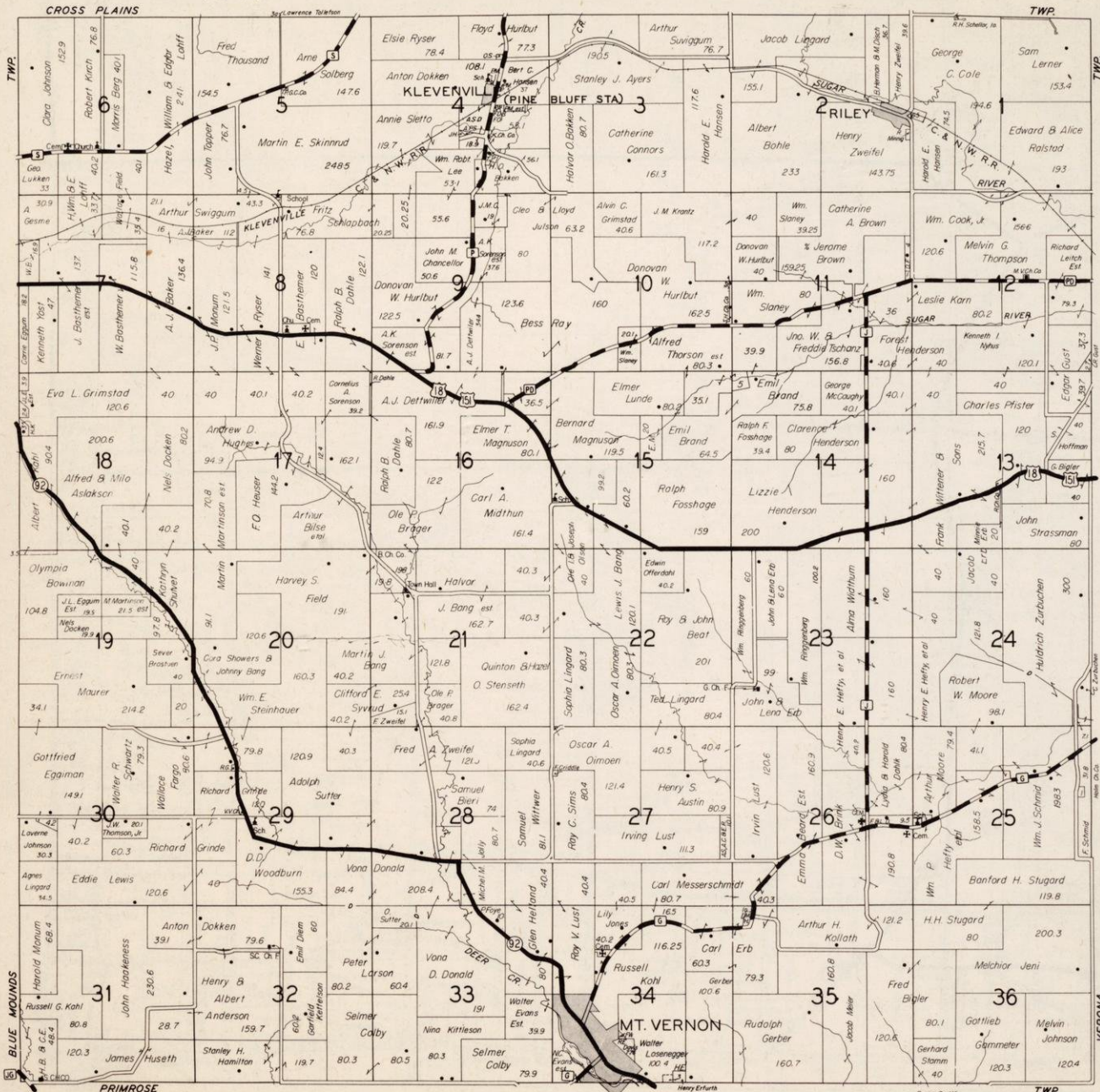

Brooks Implement Co.

Ford Tractors and Implements — Wood Brothers Corn Pickers
Full Line Oliver Implements — Papec Forage Harvesters

Wisconsin's Largest Parts Stock

Telephone 41

Sun Prairie, Wisconsin



DANE COUNTY PLAT BOOKS

This new 1955 issue of our Dane County Plat Book is the result of many days of careful research of the records in the Dane County Court House. They will be available at your local weekly newspaper office or will be mailed to you, postage paid, on remittance of \$2.50 to

EAST SIDE PRINT SHOP, Inc.

2004 Winnebago Street

CH 4-6218

Madison, Wisconsin

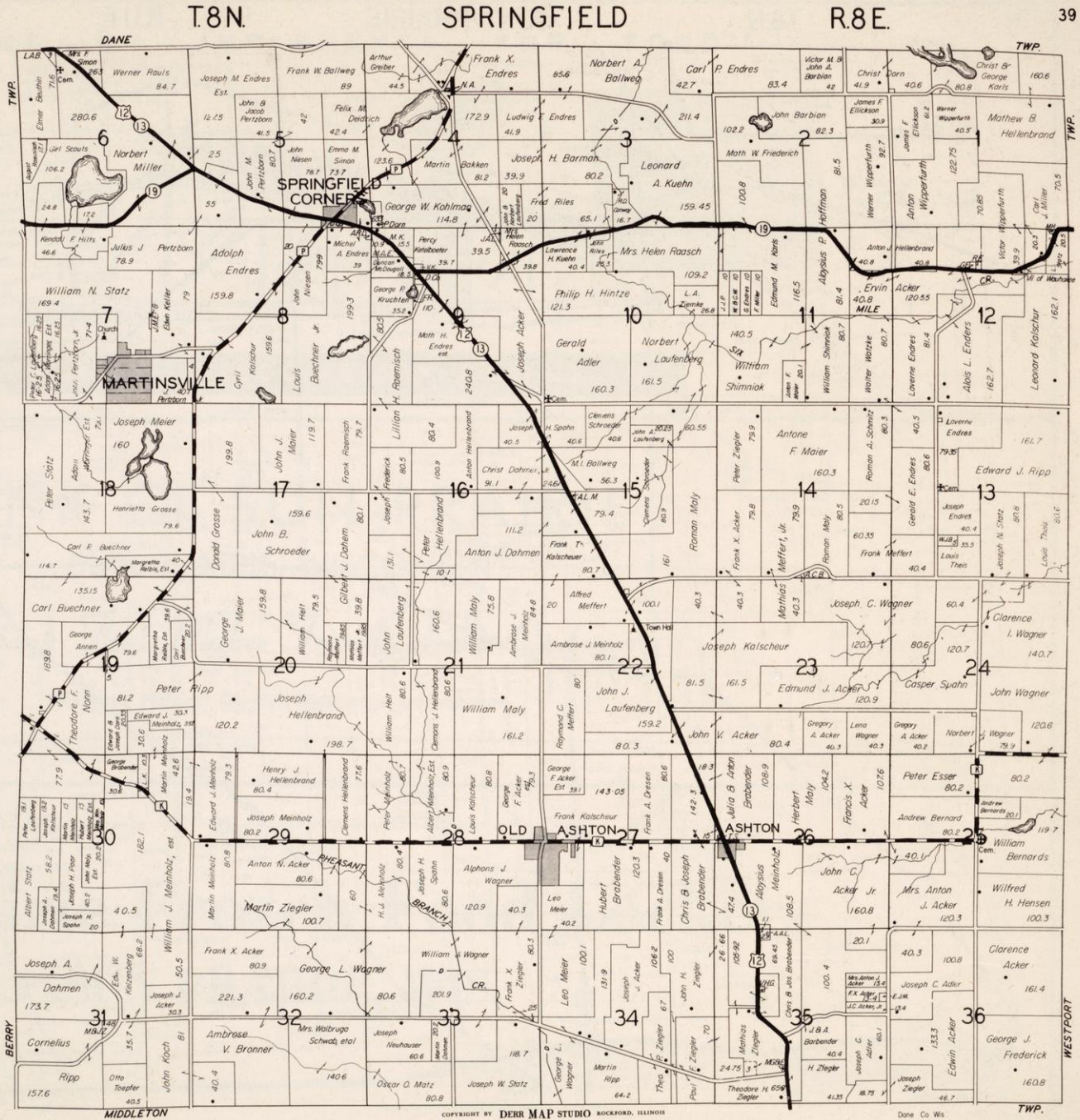

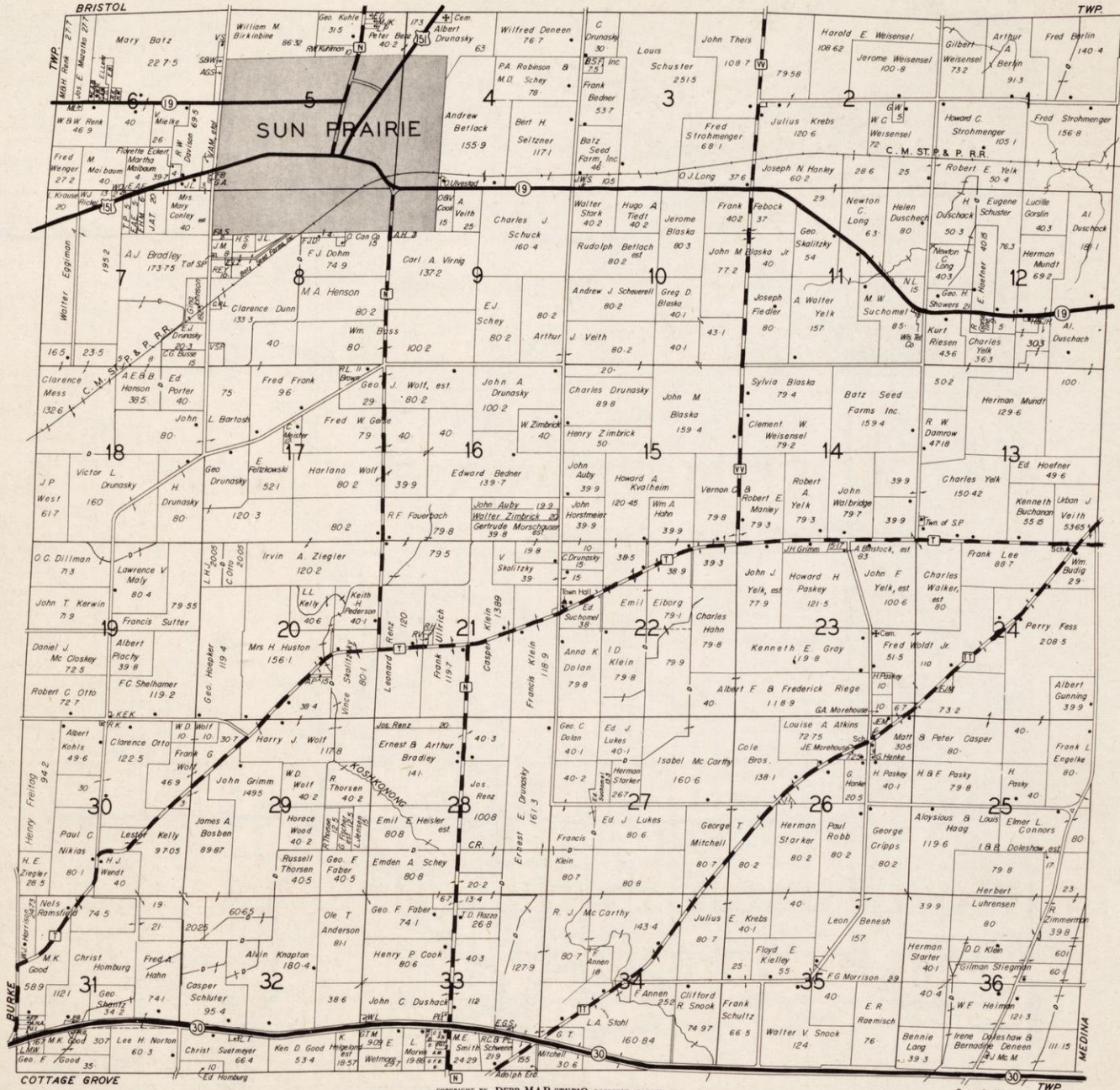

COPYRIGHT BY DERR MAP STUDIO ROCKFORD, ILLINOIS



Brooks Implement Co.

Ford Tractors and Implements — Wood Brothers Corn Pickers
 Full Line Oliver Implements — Papec Forage Harvesters

Wisconsin's Largest Parts Stock



Telephone 41

Sun Prairie, Wisconsin

"THE . HOME . OF . IMPLEMENTS . FOR . FOOD"

Arthur Hanley, Pres.

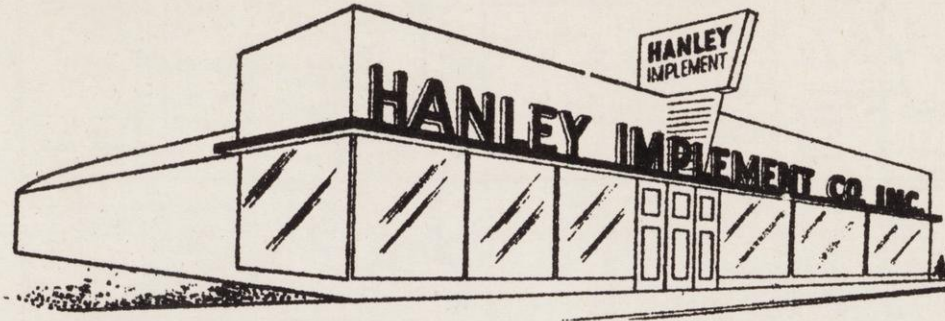

Erich Lenz, Sec.-Mgr.

SUN PRAIRIE, WISCONSIN • PHONE 10

BANK OF SUN PRAIRIE

SUN PRAIRIE, WISCONSIN

The Bank That Makes Friends of Its Customers

Member Federal Deposit Insurance Corporation

Sun Prairie Frozen Food Lockers

SUN PRAIRIE, WIS.

184 S. Bristol Street

Telephone 51

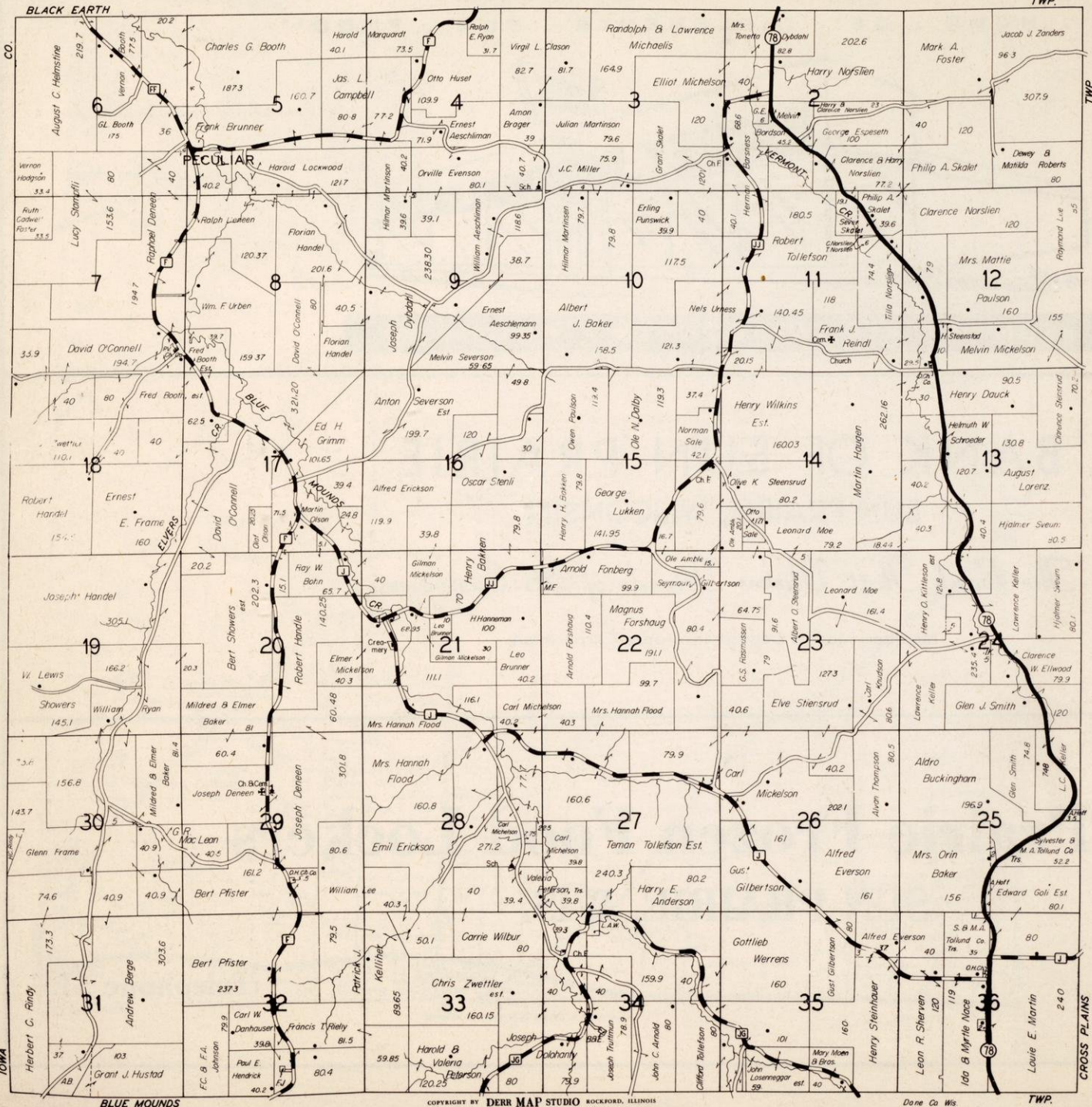

Central Ready-Mixed Concrete "Scientifically Mixed for Greater Strength and Durability"



Verona Redi-Mix Co.

Verona, Wisconsin Phone 117 or 157

BANK OF VERONA

“The Bank of Personal Service”

Member of the Federal Deposit Insurance Corporation

VERONA, WISCONSIN

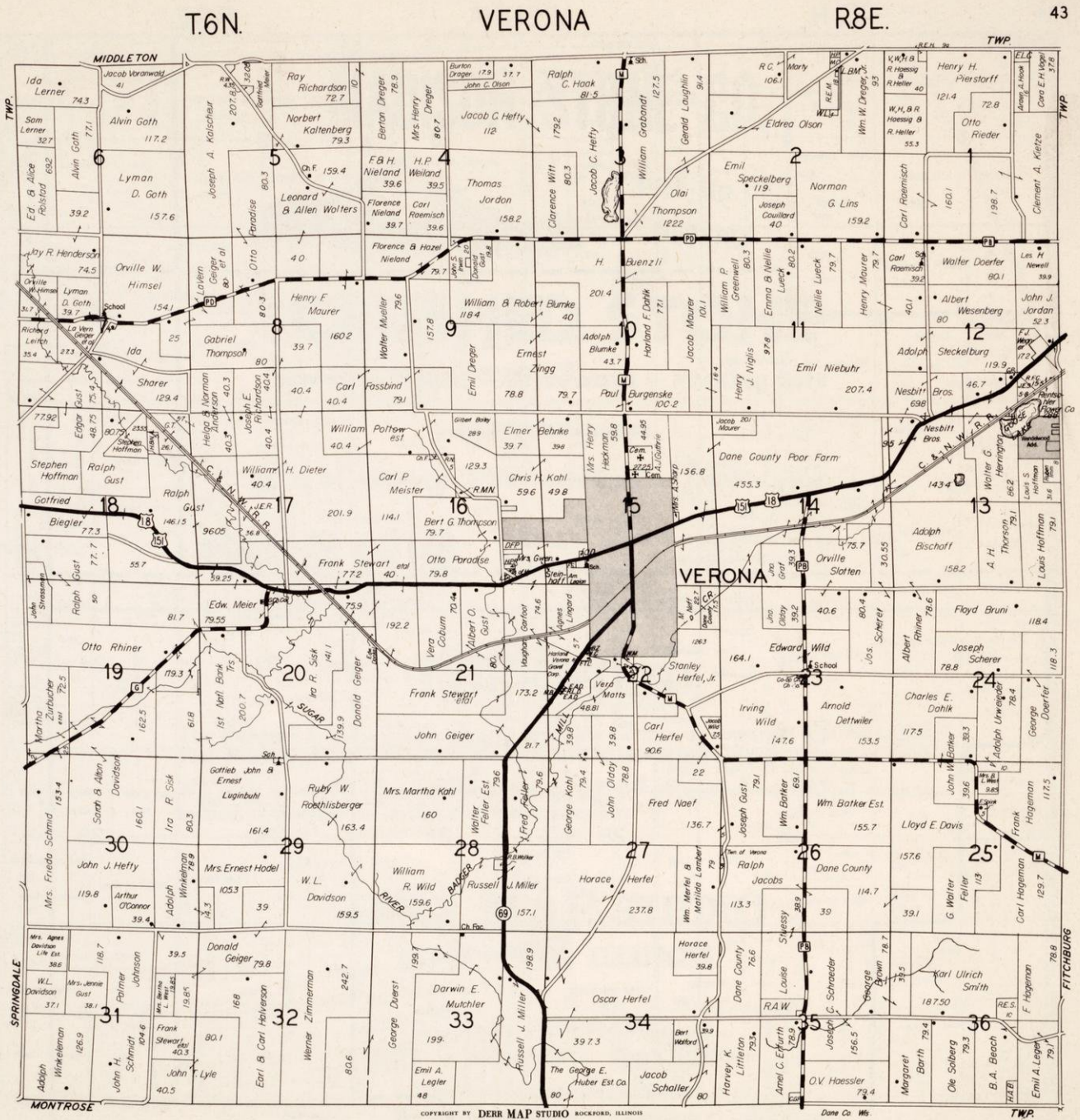

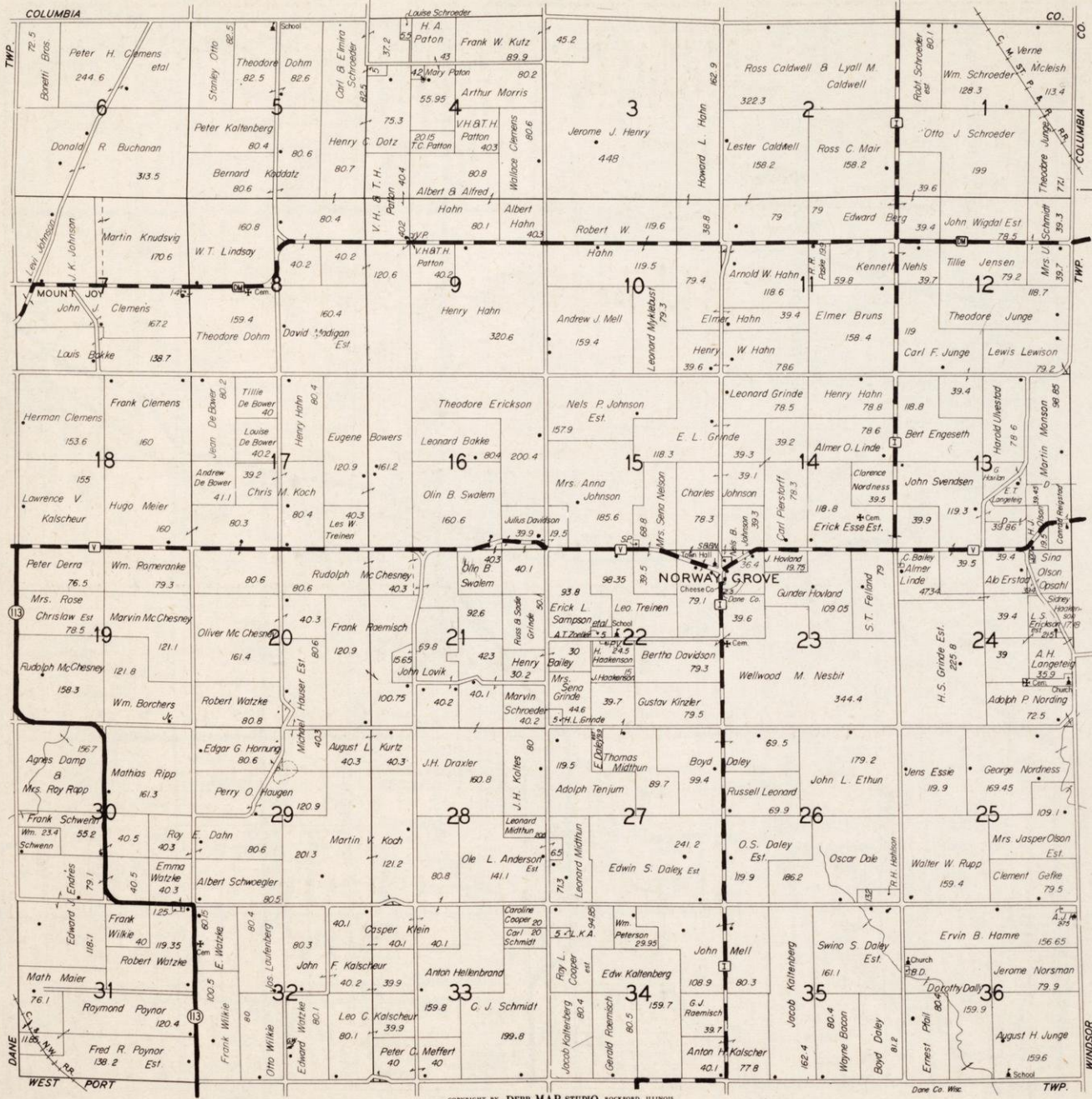

Brooks Implement Co.

Ford Tractors and Implements — Wood Brothers Corn Pickers
Full Line Oliver Implements — Papec Forage Harvesters

Wisconsin's Largest Parts Stock



Sun Prairie, Wisconsin

Telephone 41

PLENTY of WATER

*Whenever
You Want It*

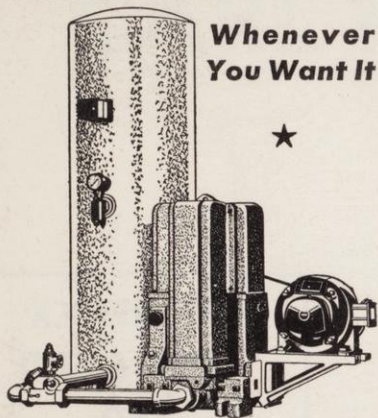

Monitor

AUTOMATIC

DEEP-WELL SYSTEMS

**BAKER
MANUFACTURING
COMPANY**

**Pitless Well Units, Water
Systems & Pump Jacks,
Jobbers of Well Supplies,
Plumbing and Heating
Equipment.**

PHONE ALPINE 7-2184

802 WILLIAMSON STREET

MADISON, WISCONSIN

MADISON STONE CO.



**Pick-Up or
Delivery**

CRUSHED STONE

Streets -- Roads -- Driveways -- Parking Lots

AGRICULTURAL LIME

"One of Madison's Oldest Producers of Crushed Stone"

Phone CH 4-6140

**North Hy. 51, 1 Mile N. of Truax Field
Madison, Wisconsin**

FOREWORD

The Publishers have endeavored to give this County an accurate and up-to-date Plat Book with such information that will make it a valuable reference book.

We wish to express our appreciation to the advertisers whose liberal support helped materially to make this book possible.

DERR MAP STUDIO

ROCKFORD, ILLINOIS

Cartographers and Publishers of
MAPS - ATLASES - PLAT BOOKS

"See Us For Your Map Needs"

Illinois - Wisconsin - Iowa - Indiana - Michigan

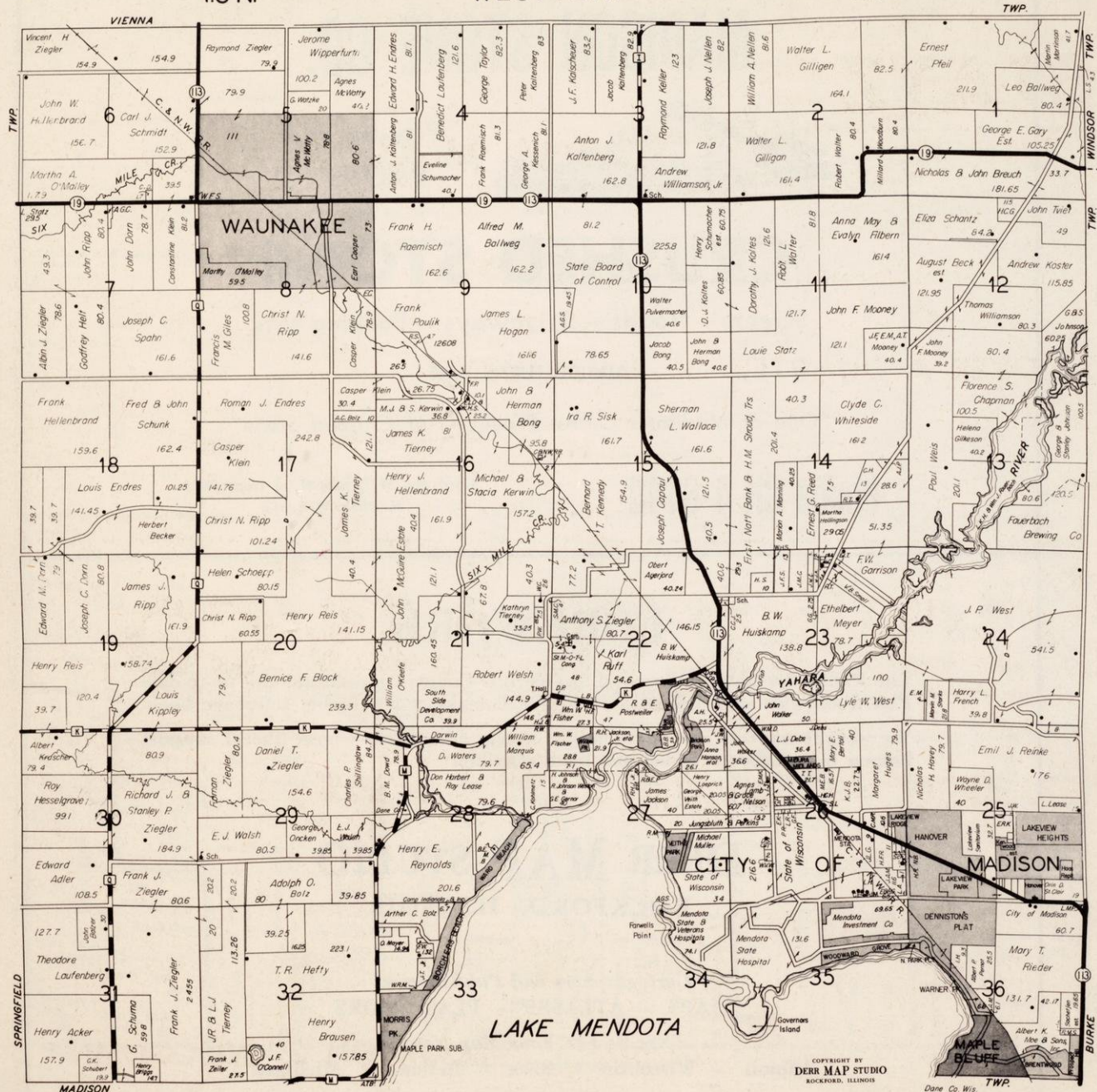

**COMSTOCK
SEED & FEED
CO.**

•

**HIGH GRADE SEEDS
POULTRY FEEDS
FERTILIZERS**

•

**2612 Sherman Ave. at
Roth Street—Madison
Phone CH 4-2330**

•

**Waunakee
Phone 44**

CARL F. STATZ



FARM MACHINERY

DEPENDABLE SERVICE AT LOW COST

FOR OVER A QUARTER OF A CENTURY

Phone 105R2

Waunakee, Wisconsin

"BOB" COOPER GLASS CO.

We Replace All Kinds of Glass

PHONE AL 7-1323

755 E. WASHINGTON AVENUE

MADISON 3, WISCONSIN

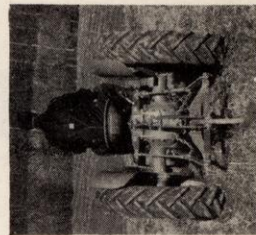
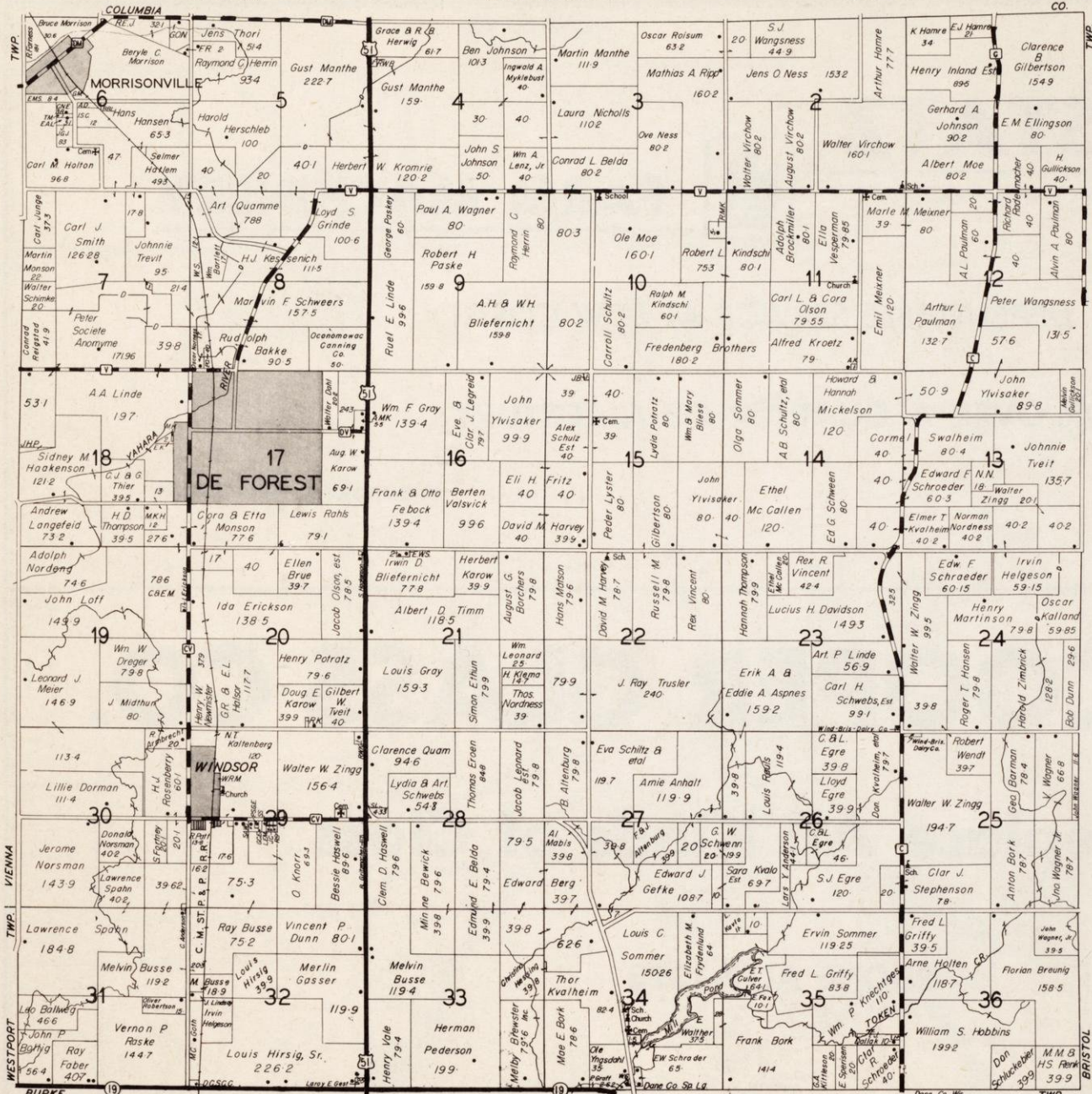

DeForest Implement Co.

Farm Machinery - Sales & Service

TELEPHONE 2211

DE FOREST, WISCONSIN



DeForest - Morrisonville Bank

“A Bank Built by the Community”

DEFOREST, WISCONSIN

2% Paid on All Time Deposits

Member of the Federal Reserve System and Federal Deposit Insurance Corporation



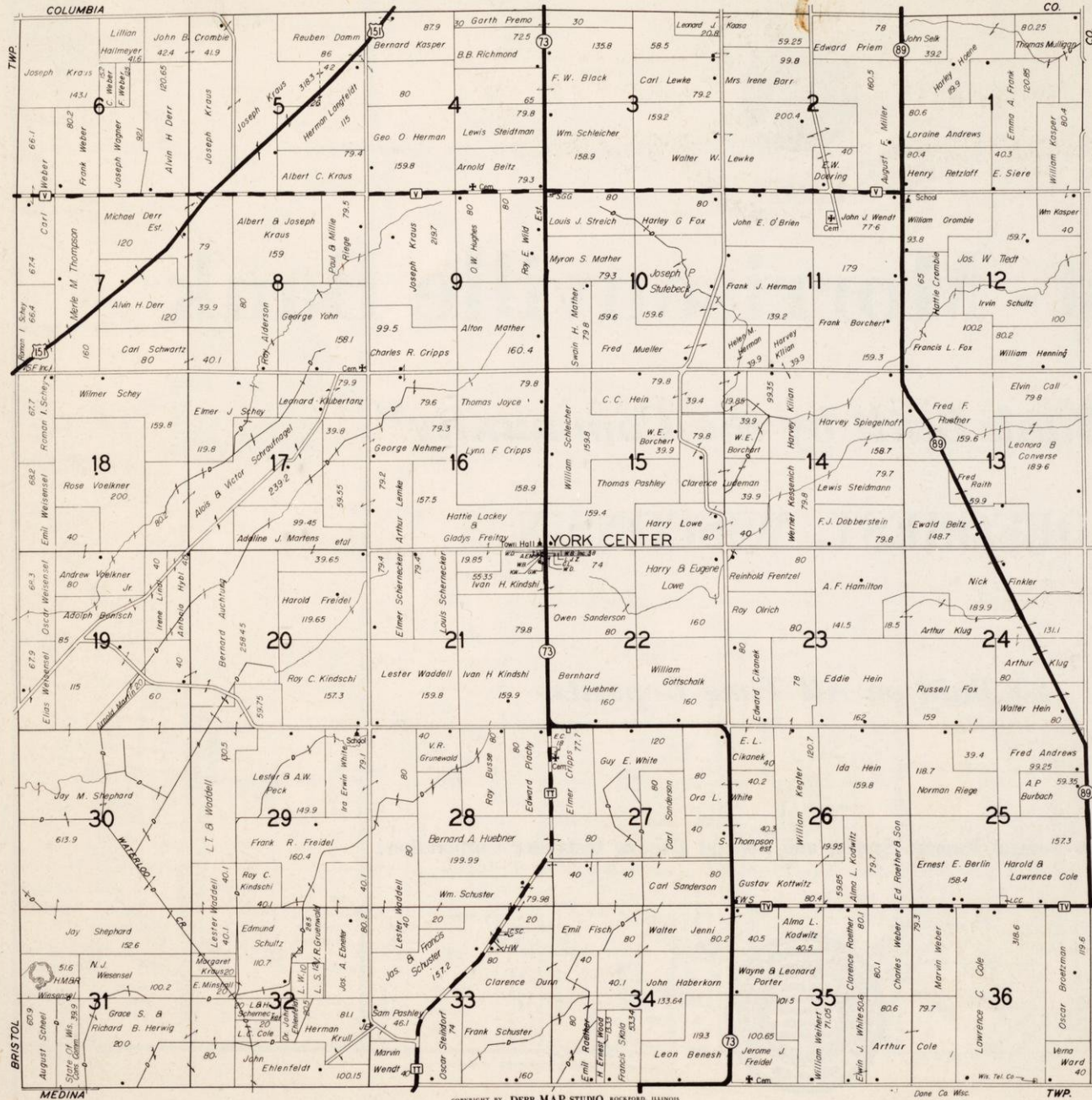

Brooks Implement Co.

Ford Tractors and Implements — Wood Brothers Corn Pickers
Full Line Oliver Implements — Papec Forage Harvesters

Wisconsin's Largest Parts Stock

Telephone 41

Sun Prairie, Wisconsin





CO-OPERATIVE FARM CREDIT

National Farm Loan Association

Long Term Farm
Real Estate Loans
4 per cent Interest

Production Credit Association

Farm personal property loans
Low cost
Repayments fitted to your income

FARM CREDIT OFFICE

Lars Landsness, Sec'y-Treas.
2025 Atwood Ave. (Schenk's Corners)
Madison, Wisconsin
Phone CH 4-2241

Glenn W. Gerhardt, Sec'y-Treas.
2025 Atwood Ave. (Schenk's Corners)
Madison, Wisconsin
Phone CH 4-1043

DANE COUNTY WISCONSIN

PUBLISHED BY
Derr MAP Studio
ROCKFORD, ILLINOIS

LEGEND

U.S. & STATE	U.S. & STATE
Paved Roads	County
Bituminous	Gravel
Gravel	Earth
Earth	Town Road

1955

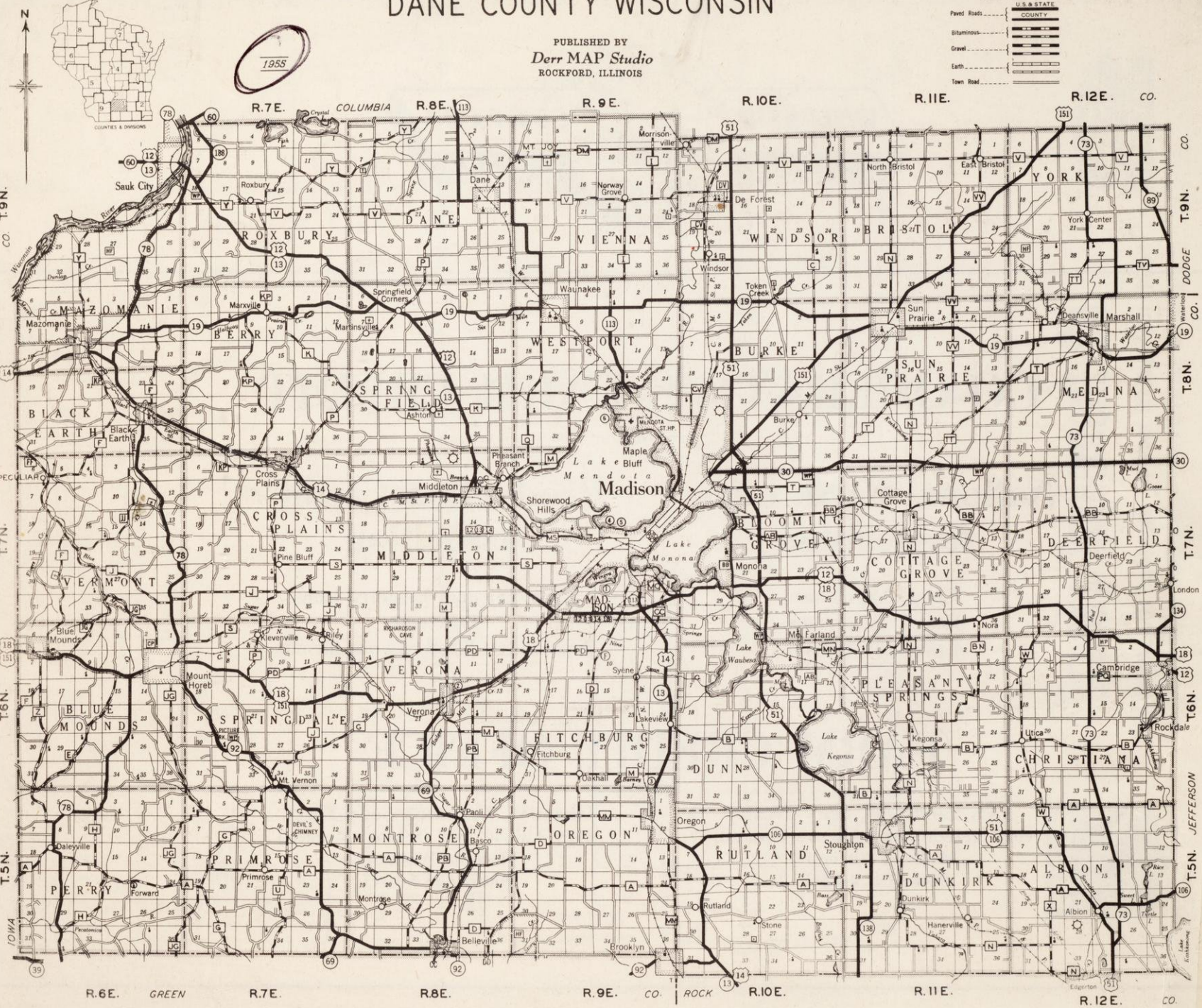

R. 6.E. GREEN R. 7.E. R. 8.E. R. 9.E. CO. ROCK R. 10.E. R. 11.E. R. 12.E. CO.

T. 5.N. T. 6.N. T. 7.N. T. 8.N. T. 9.N.

CO. DODGE CO. CO. JEFFERSON CO.

Displ
es - 2

A. J. ROOB, Inc.

**Plumbing - Heating - Sheet Metal
Electrical Work - Appliances**

Dane County Distributor for Pyrofax Bottle Gas

PHONE 30

SUN PRAIRIE, WIS.

A Tribute to . . .

The Farmers of Dane County

In 1919 the farmers of Dane County cast their lot with Oscar Mayer & Co. when they voted to sell the Farmers Co-operative Packing Company plant to Oscar Mayer.

Dane County farmers wanted a Company that would do an efficient job of processing livestock into saleable meats and meat products. For they knew, that only through efficient processing by the packer is the farmer assured of consistently higher prices for his cattle and hogs.

The past years of growth and development of Oscar Mayer & Co. serve as a testimonial to the faith and trust of these farmers. Oscar Mayer & Co. has maintained the most efficient processing methods possible—resulting in higher prices for the farmers and better products for the consumer.

The farmers of Dane County deserve a tribute for the outstanding co-operation they have given Oscar Mayer & Co. in the raising of lean, meat-type hogs, making possible efficient low-cost processing.

The Meats team is an important structure in the American economy and the farmer is the foundation on which that structure is built.

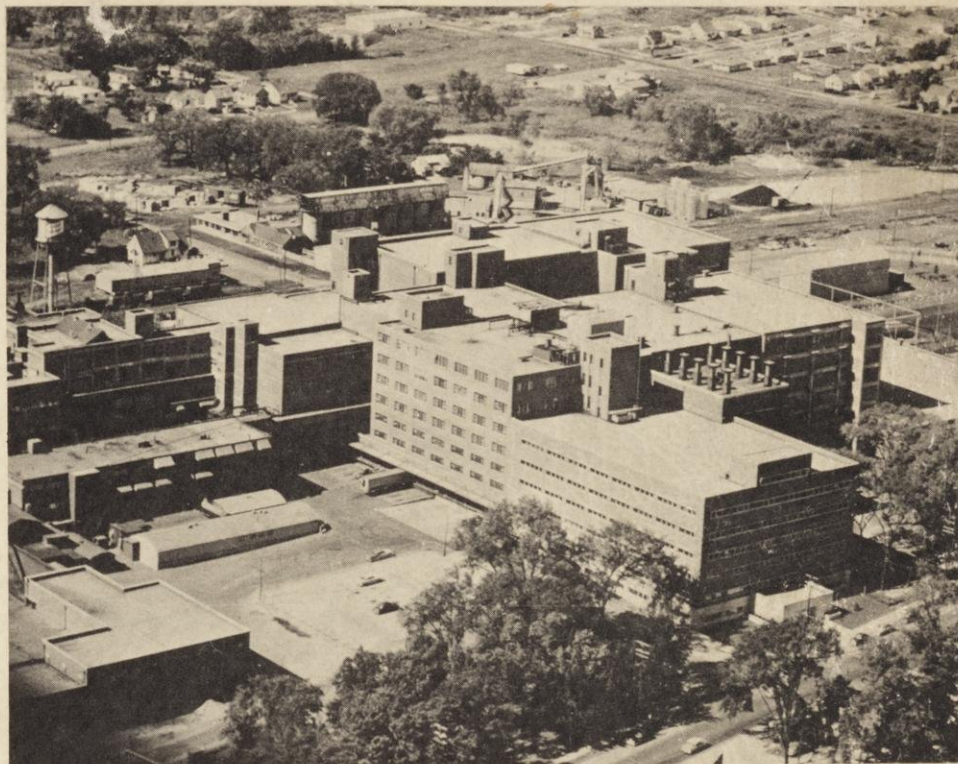

For the highest prices for your Livestock bring them directly to the Oscar Mayer & Co. Madison Plant or to the Oscar Mayer Buyer in your vicinity.

For the latest up-to-date Livestock prices listen to the Oscar Mayer Farm Service Radio Programs.

OSCAR MAYER & CO. Madison

Also Chicago - Davenport - Philadelphia - Los Angeles