



LIBRARIES

UNIVERSITY OF WISCONSIN-MADISON

Plat book of Dane County Wisconsin. 1947

Marathon Map Service

Milwaukee, Wisconsin: Marathon Map Service, 1947

<https://digital.library.wisc.edu/1711.dl/BJEKV2AMW3BKD86>

This material may be protected by copyright law (Title 17, US Code).

Original material owned by Madison Public Library.

For information on re-use see:

<http://digital.library.wisc.edu/1711.dl/Copyright>

The libraries provide public access to a wide range of material, including online exhibits, digitized collections, archival finding aids, our catalog, online articles, and a growing range of materials in many media.

When possible, we provide rights information in catalog records, finding aids, and other metadata that accompanies collections or items. However, it is always the user's obligation to evaluate copyright and rights issues in light of their own use.

DIAGRAM OF

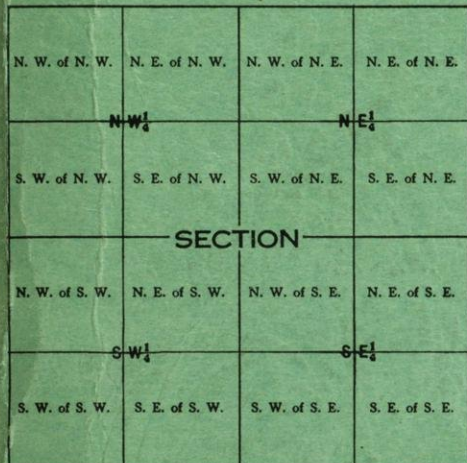

RANGE NO'S

PLAT BOOK

OF

DANE COUNTY

Wisconsin

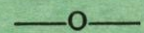

TOWN NAMES

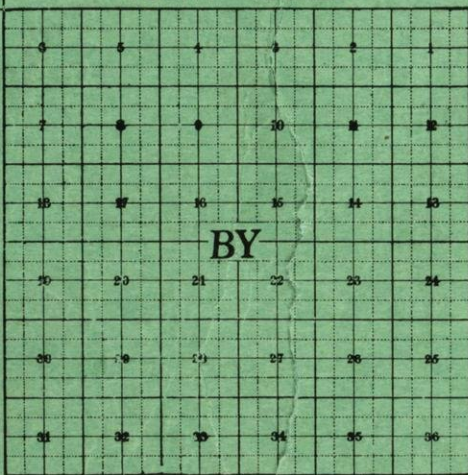

TOWNSHIP NO'S

BY

MARATHON MAP SERVICE

COUNTY PLAT BOOK PUBLISHER

State Bank Building

743 N. Fourth Street

Milwaukee 3, Wis.

WM. J. DAHLKE

Phone BRoadway 9642

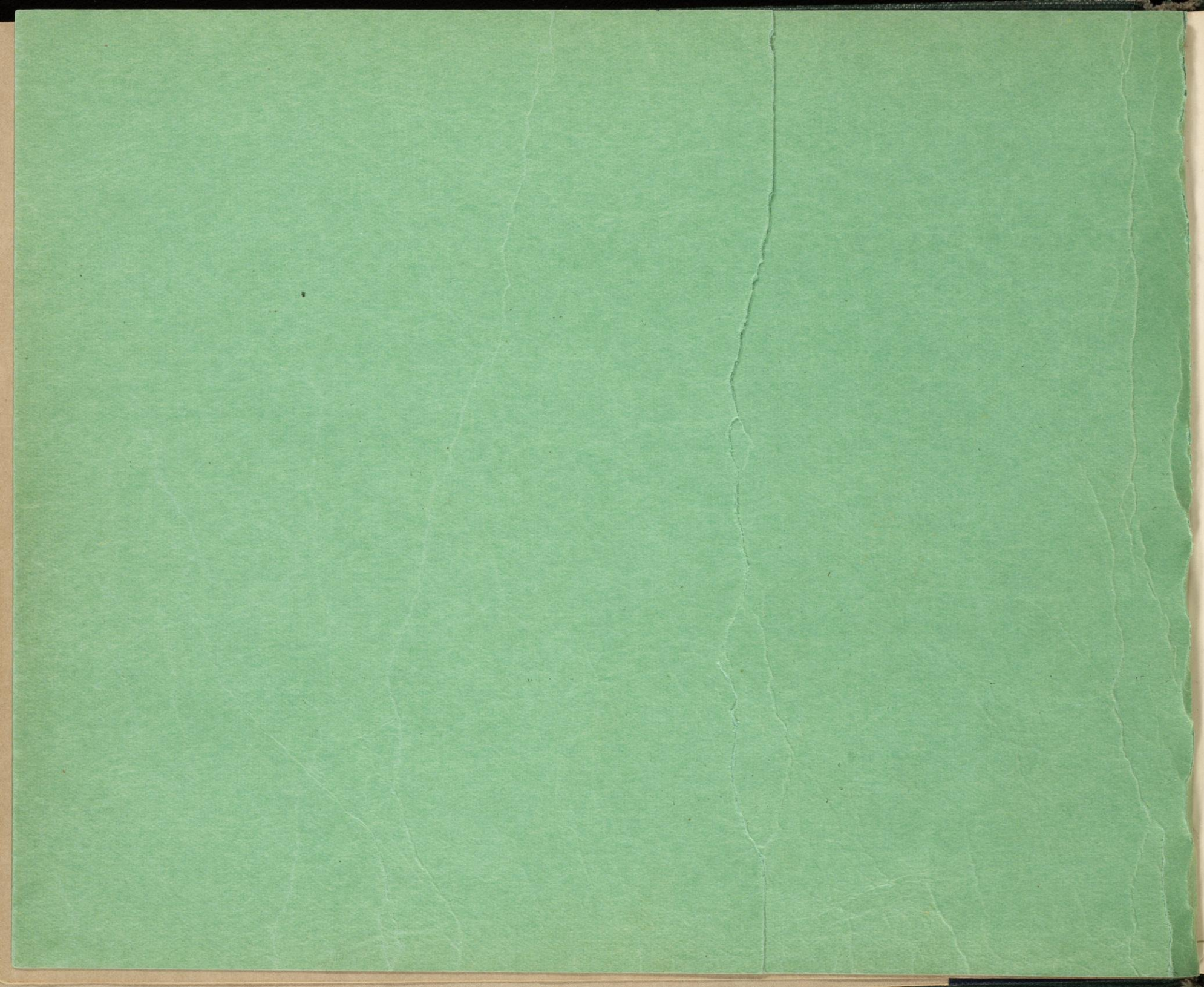

*
917.758
M32

T. 9 N. R. 6 E. MAP NO. 29 MAZOMANIE	ROXBURY T. 9 N. R. 7 E. MAP NO. 30	DANE T. 9 N. R. 8 E. MAP NO. 31	VIENNA T. 9 N. R. 9 E. MAP NO. 32	WINDSOR T. 9 N. R. 10 E. MAP NO. 33	BRISTOL T. 9 N. R. 11 E. MAP NO. 34	YORK T. 9 N. R. 12 E. MAP NO. 35
T. 8 N. R. 6 E. BLACK EARTH MAP NO. 22	BERRY T. 8 N. R. 7 E. MAP NO. 23	SPRINGFIELD T. 8 N. R. 8 E. MAP NO. 24	WESTPORT T. 8 N. R. 9 E. MAP NO. 25	BURKE T. 8 N. R. 10 E. MAP NO. 26	SUN PRAIRIE T. 8 N. R. 11 E. MAP NO. 27	MEDINA T. 8 N. R. 12 E. MAP NO. 28
VERMONT T. 7 N. R. 6 E. MAP NO. 15	CROSS PLAINS T. 7 N. R. 7 E. MAP NO. 16	MIDDLETON T. 7 N. R. 8 E. MAP NO. 17	MADISON T. 7 N. R. 9 E. MAP NO. 18	BLOOMING GROVE T. 7 N. R. 10 E. MAP NO. 19	COTTAGE GROVE T. 7 N. R. 11 E. MAP NO. 20	DEERFIELD T. 7 N. R. 12 E. MAP NO. 21
BLUE MOUNDS T. 6 N. R. 6 E. MAP NO. 8	SPRINGDALE T. 6 N. R. 7 E. MAP NO. 9	VERONA T. 6 N. R. 8 E. MAP NO. 10	FITCHBURG T. 6 N. R. 9 E. MAP NO. 11	DUNN T. 6 N. R. 10 E. MAP NO. 12	PLEASANT SPRINGS T. 6 N. R. 11 E. MAP NO. 13	CHRISTIANA T. 6 N. R. 12 E. MAP NO. 14
PERRY T. 5 N. R. 6 E. MAP NO. 1	PRIMROSE T. 5 N. R. 7 E. MAP NO. 2	MONTROSE T. 5 N. R. 8 E. MAP NO. 3	OREGON T. 5 N. R. 9 E. MAP NO. 4	RUTLAND T. 5 N. R. 10 E. MAP NO. 5	DUNKIRK T. 5 N. R. 11 E. MAP NO. 6	ALBION T. 5 N. R. 12 E. MAP NO. 7

ALPHABETICAL INDEX

	MAP NO.		MAP NO.		MAP NO.
ALBION	7	PRIMROSE	2		
BERRY	23	DUNKIRK	6	ROXBURY	30
BLACK EARTH	22	DUNN	12	RUTLAND	5
BLOOMING GROVE	19	FITCHBURG	11	SPRINGDALE	9
BLUE MOUNDS	8	MADISON	18	SPRINGFIELD	27
BRISTOL	34	MAZOMANIE	29	SUN PRAIRIE	27
BURKE	26	MEDINA	28	VERMONT	15
CHRISTIANA	14	MIDDLETON	17	VERONA	10
COTTAGE GROVE	20	MONTROSE	3	VIENNA	32
CROSS PLAINS	16	OREGON	4	WESTPORT	25
DANE	31	PLEASANT SPRINGS	13	WINDSOR	33
DEERFIELD	21	PERRY	1	YORK	35

IN TOWN MAPS

BLDG OR GROUP OF BLDGS	
SCHOOL	
CHURCH	
TOWN HALL	
CEMETERY	
GARAGE OR GAS ST.	
STORE	
TAVERN	
CREAMERY	
CHEESE FACTORY	

LEGEND

CONG. TWP. BORDER		CIVIL TWP. BORDER	
COUNTY DETAIL MAP		INSIDE BACK COVER	

COPYRIGHT 1917



47 10136

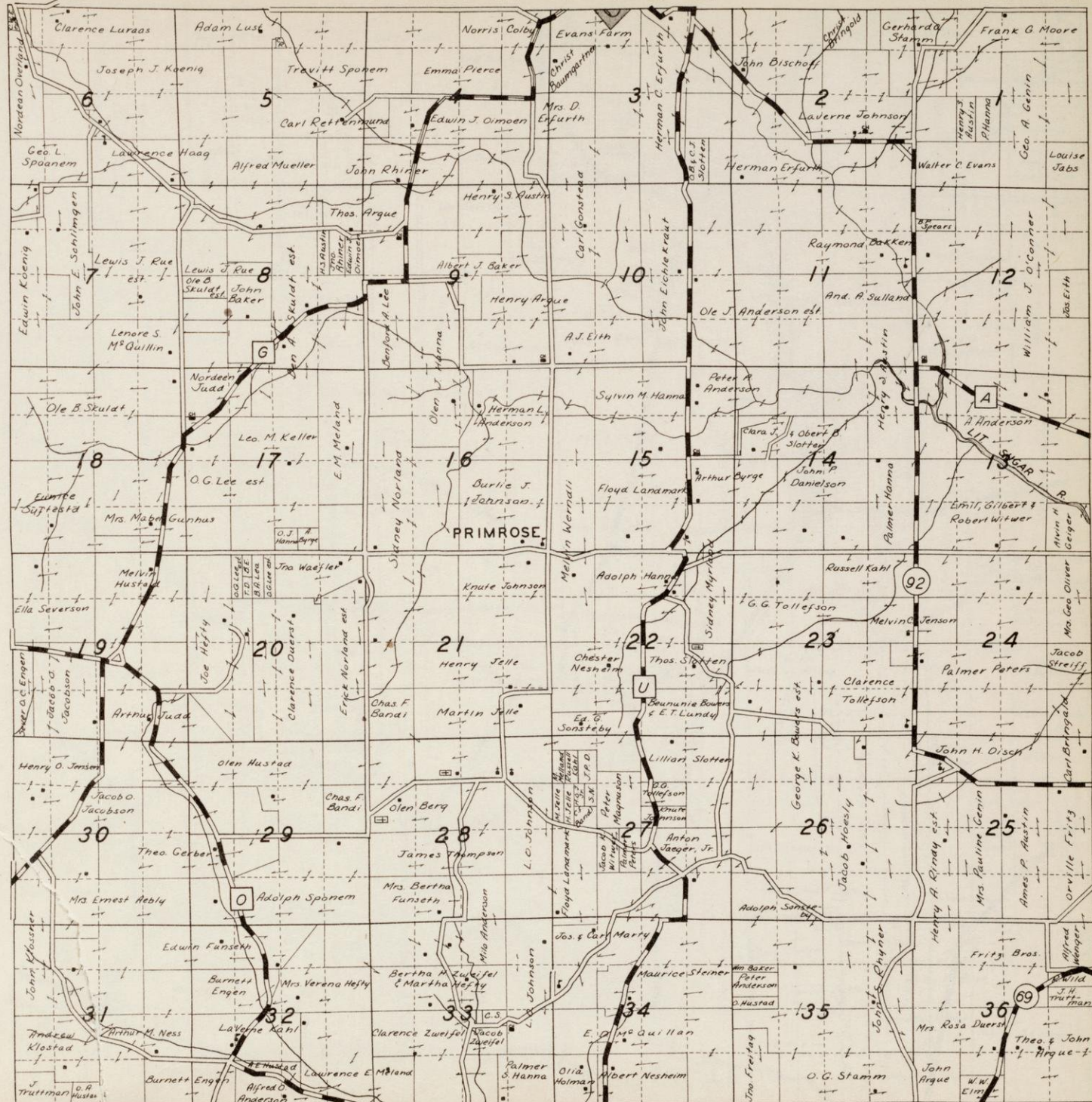

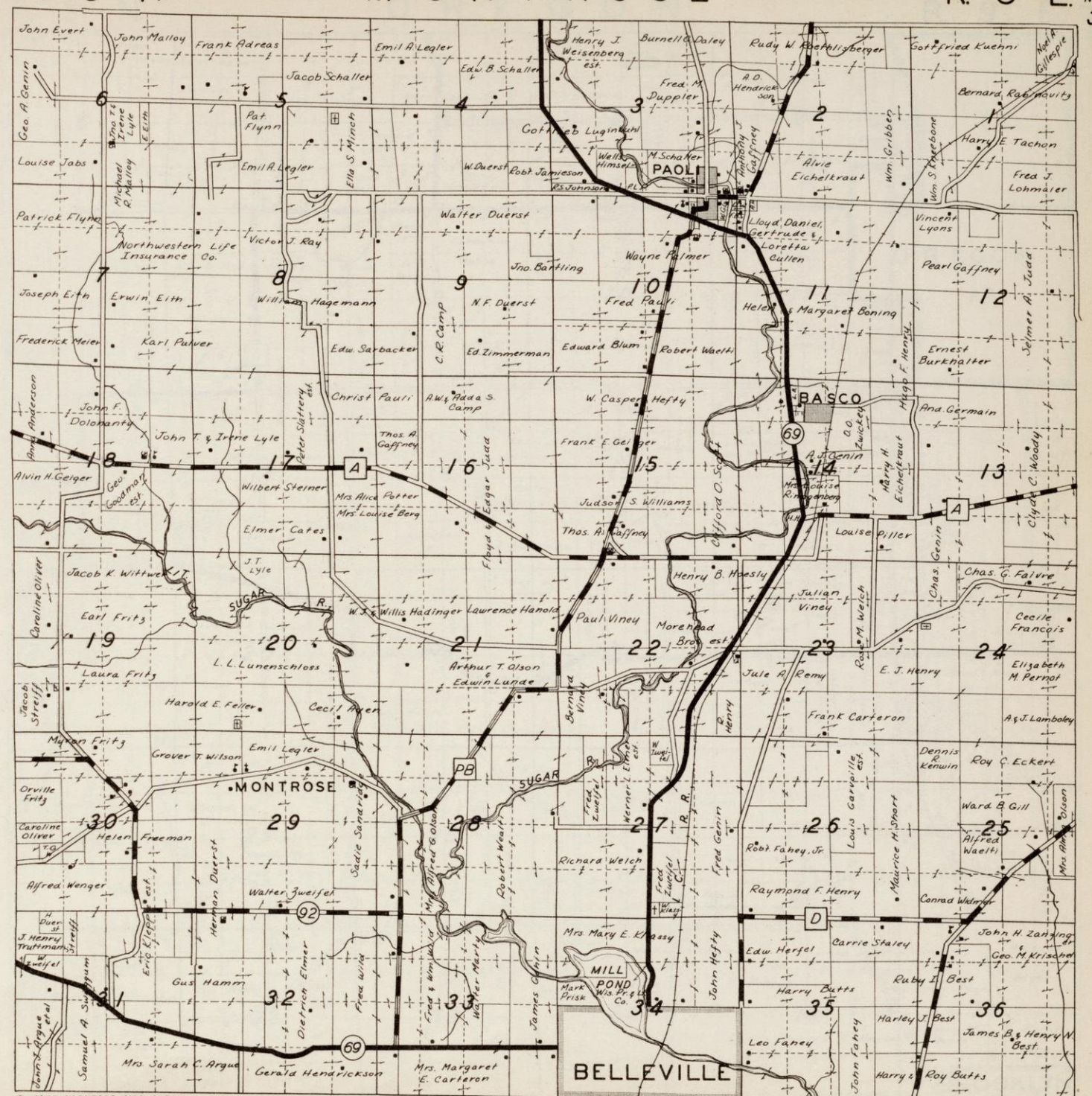

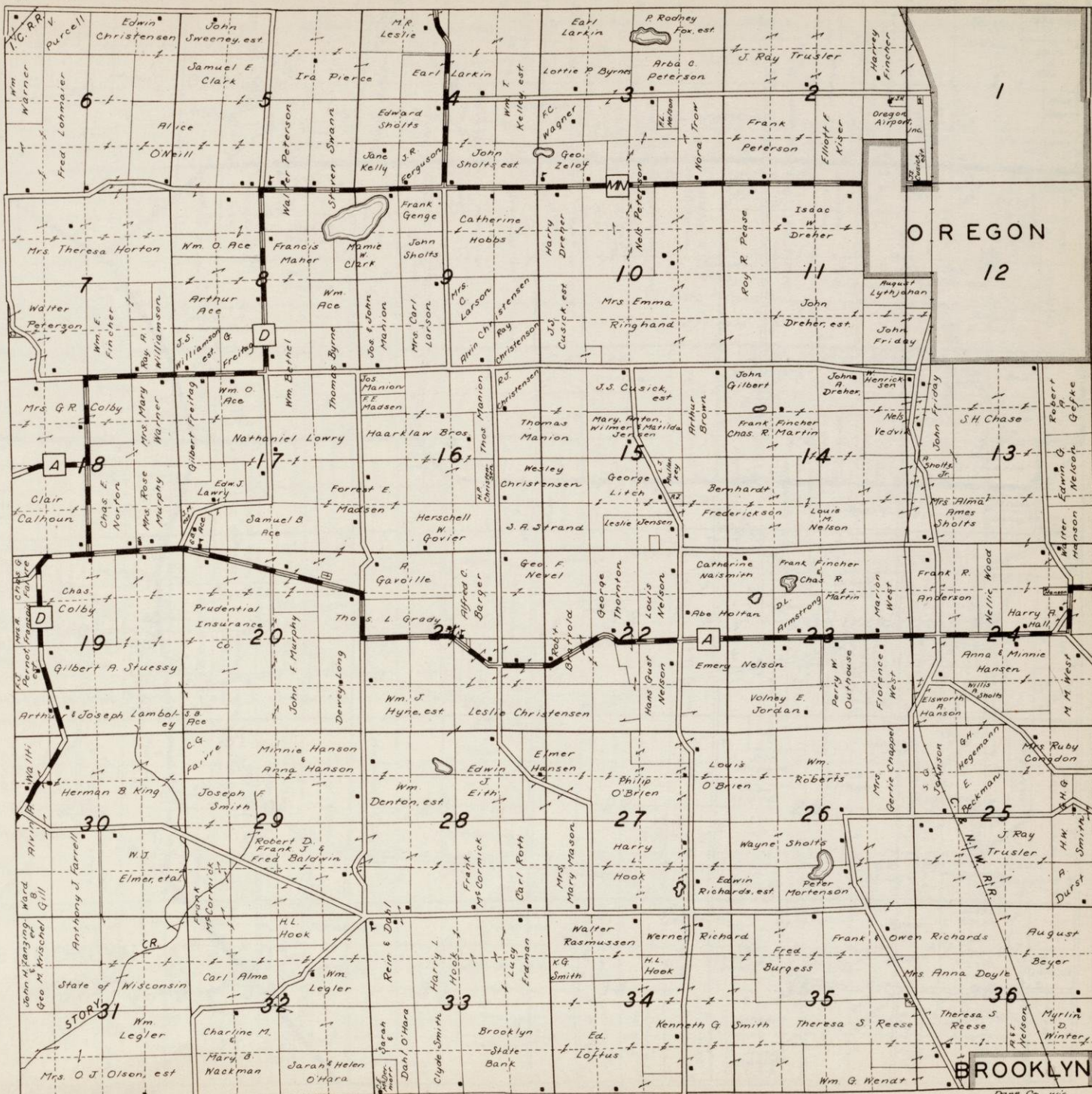

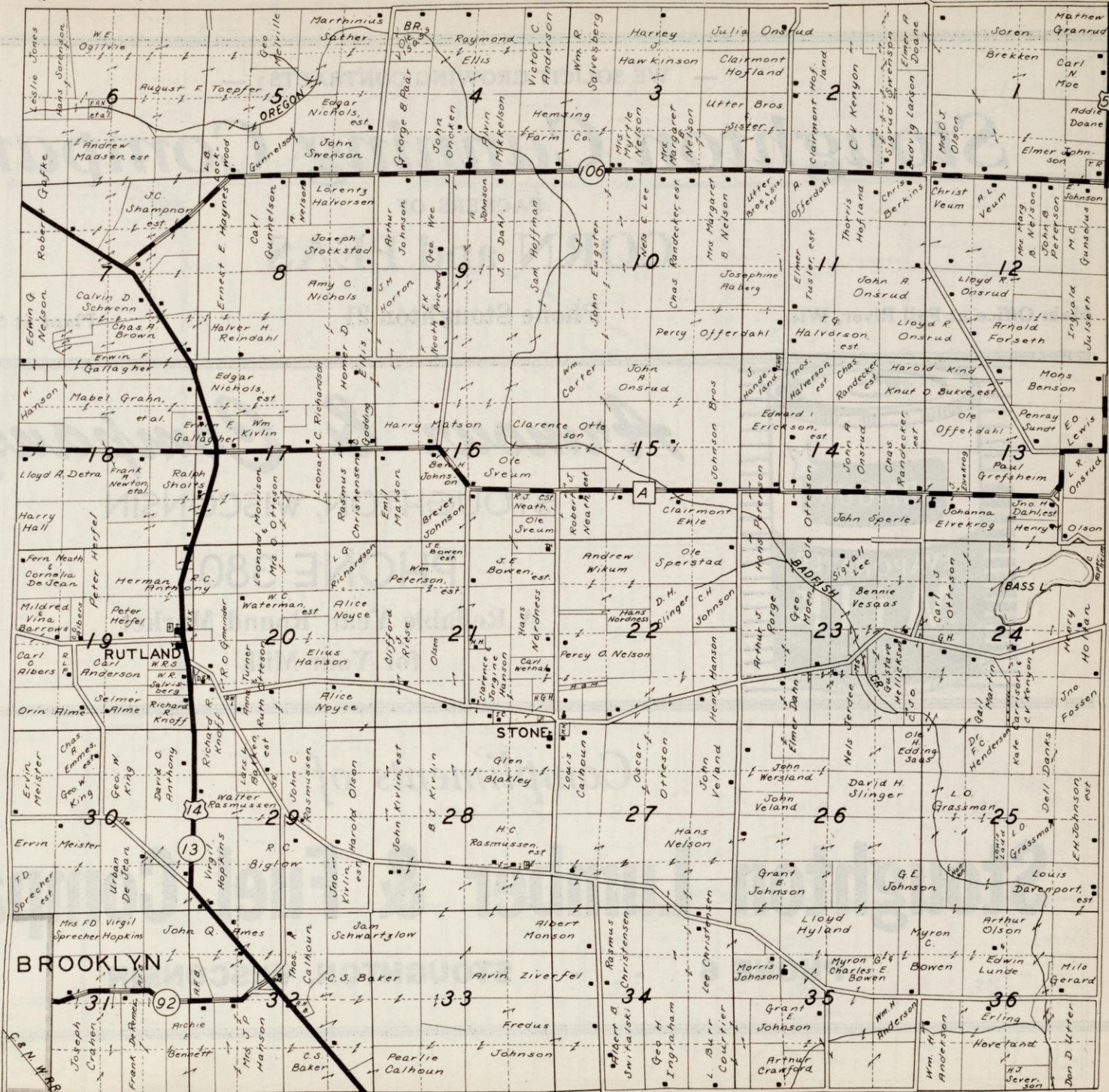

— WE SOLICIT GROWING CONTRACTS —

Stoughton Canning Company

PACKERS OF
CORN and PEAS

Main Office at Fall River, Wis.

Phone Stoughton 21

Plant at Stoughton, Wis.

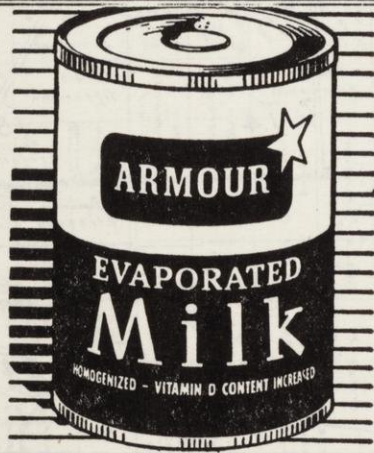

Armour & Company

STOUGHTON, WISCONSIN

PHONE 380

A Reliable Year 'Round Market
for Your Milk

Compliments of

Stoughton Lumber & Fuel Company

PHONE 6 - - STOUGHTON, WISCONSIN

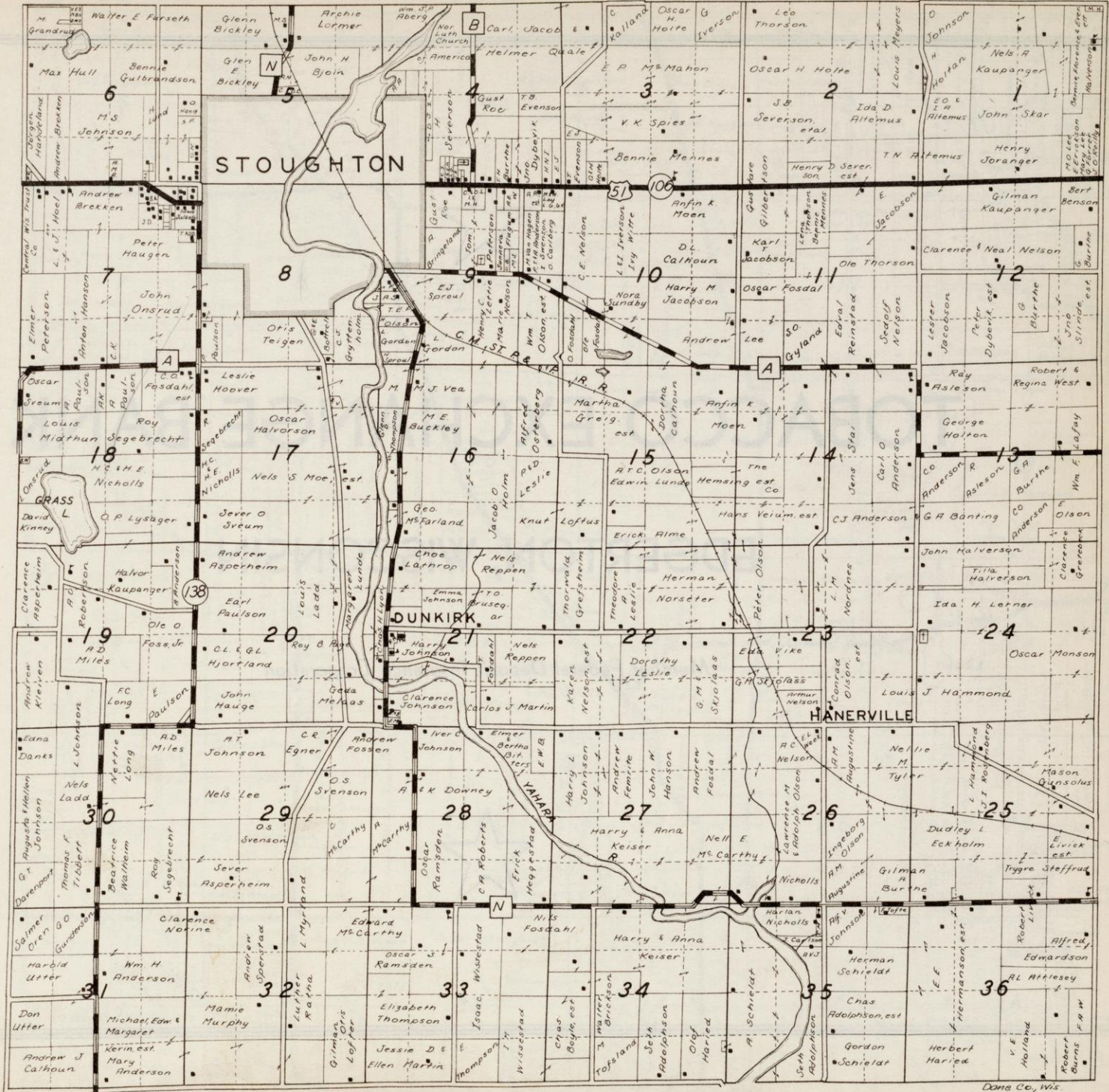



TOBACCO EXCHANGE BANK

EDGERTON, WISCONSIN

Member Federal Deposit Insurance Corporation



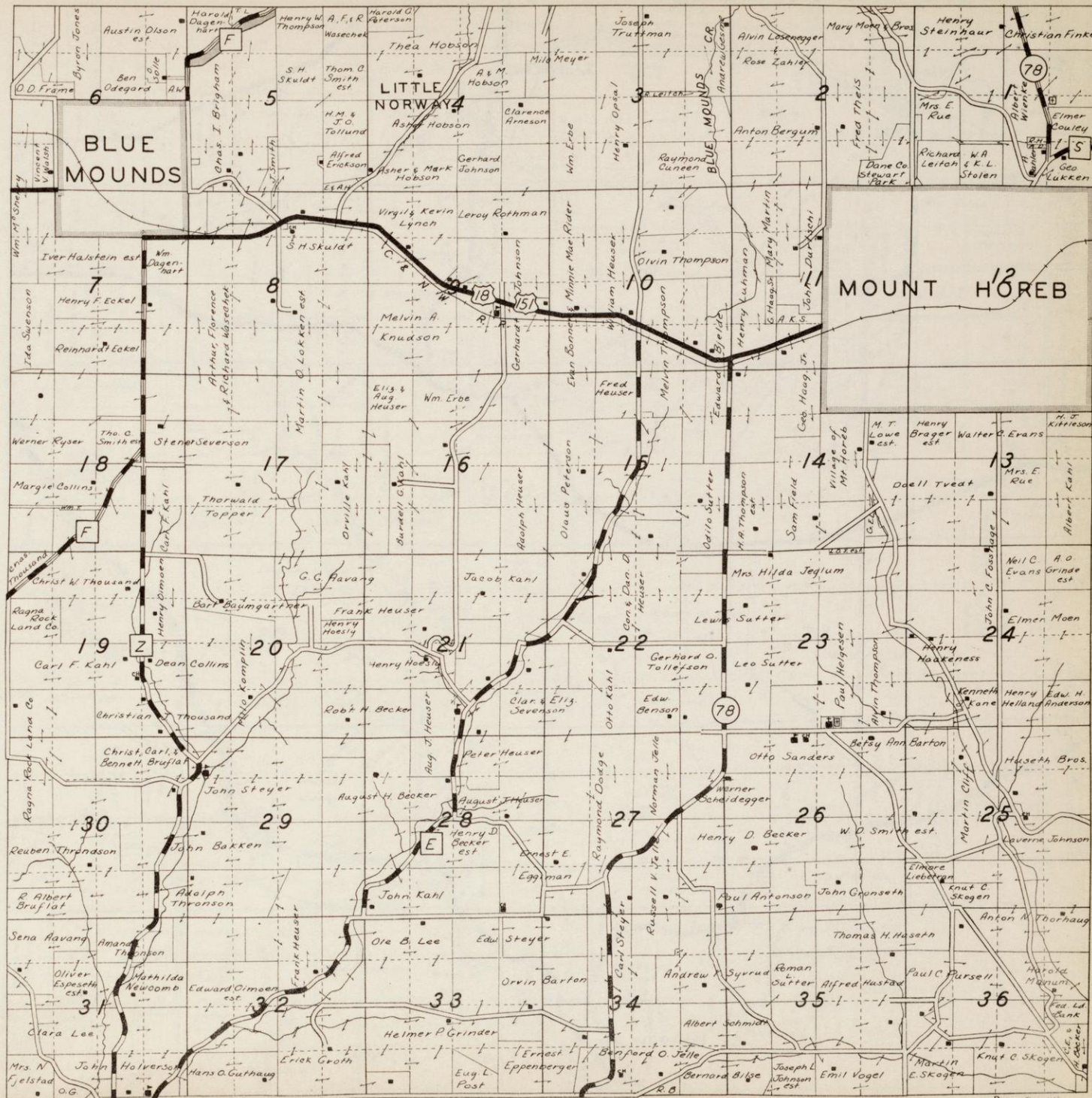

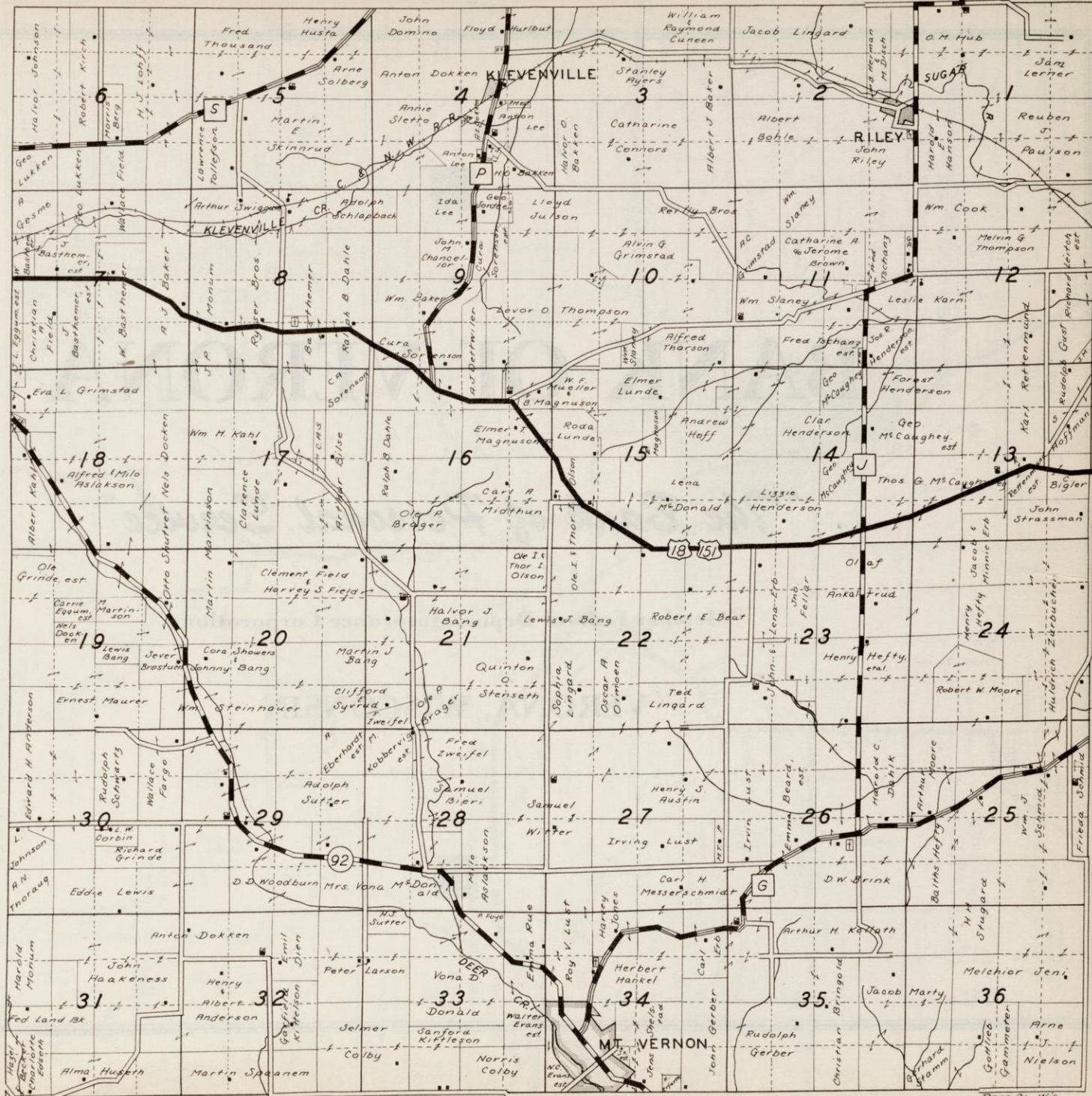



BANK OF VERONA

"The Bank of Personal Service"

Member Federal Deposit Insurance Corporation

VERONA, WISCONSIN





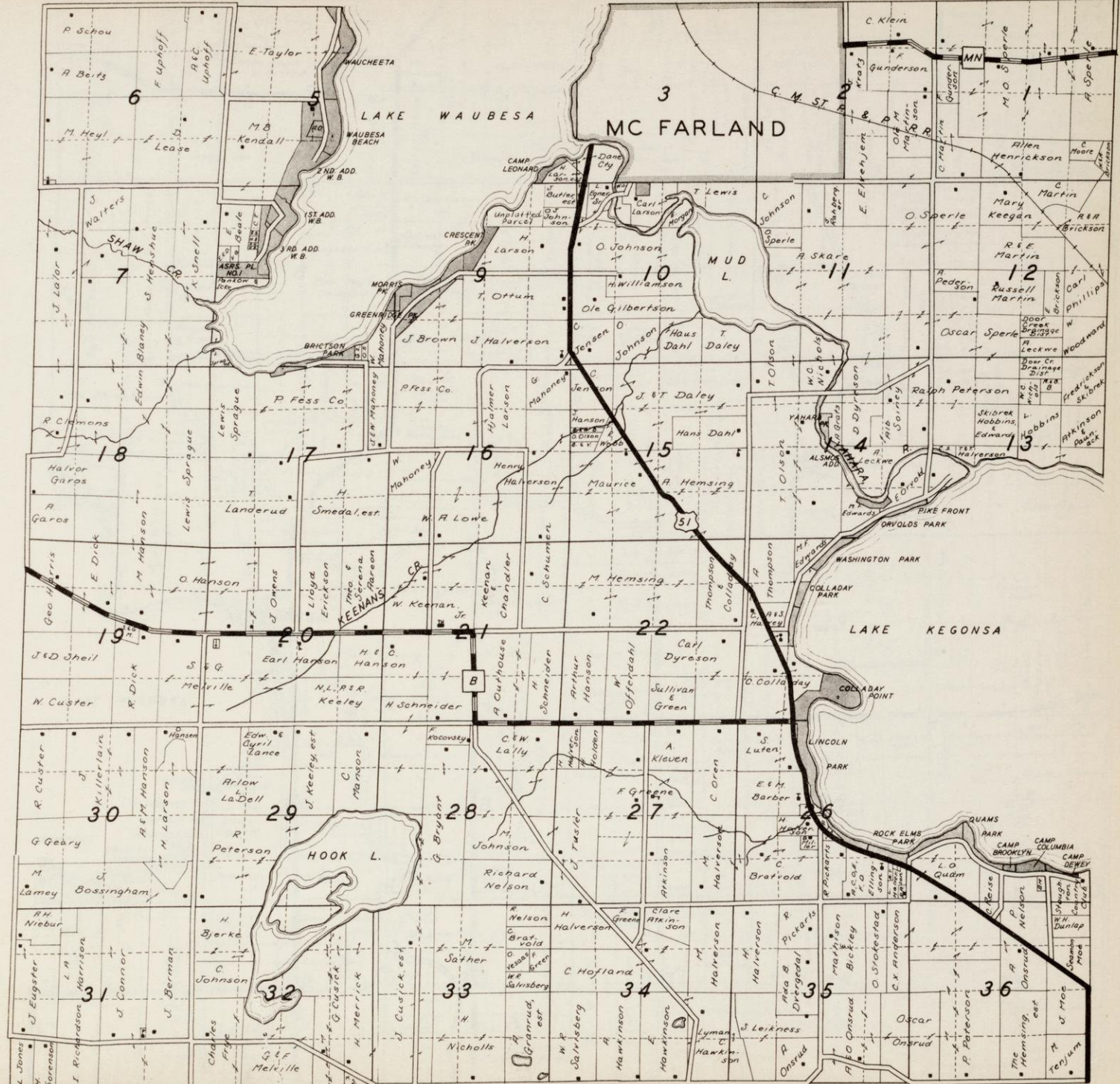

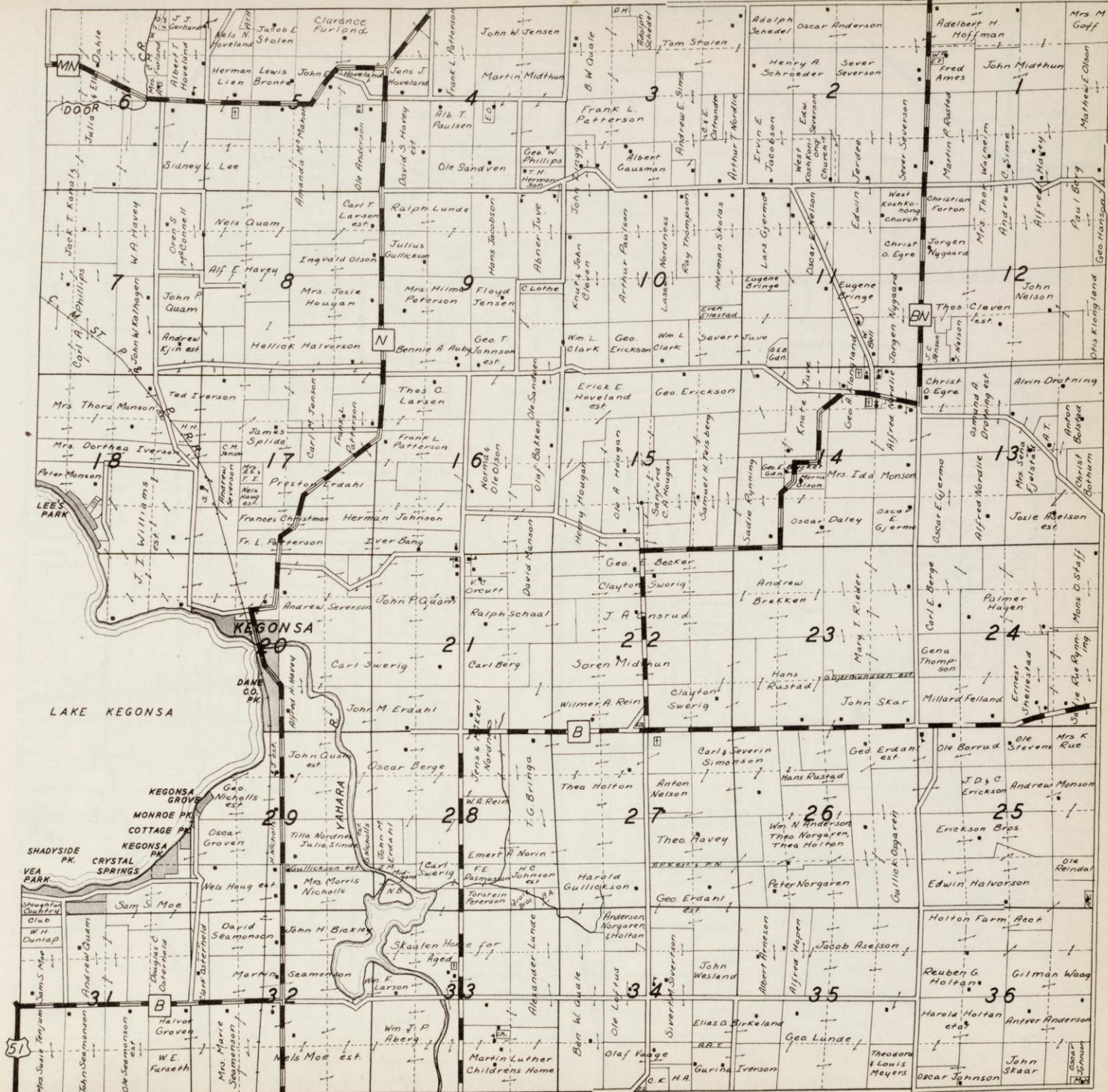

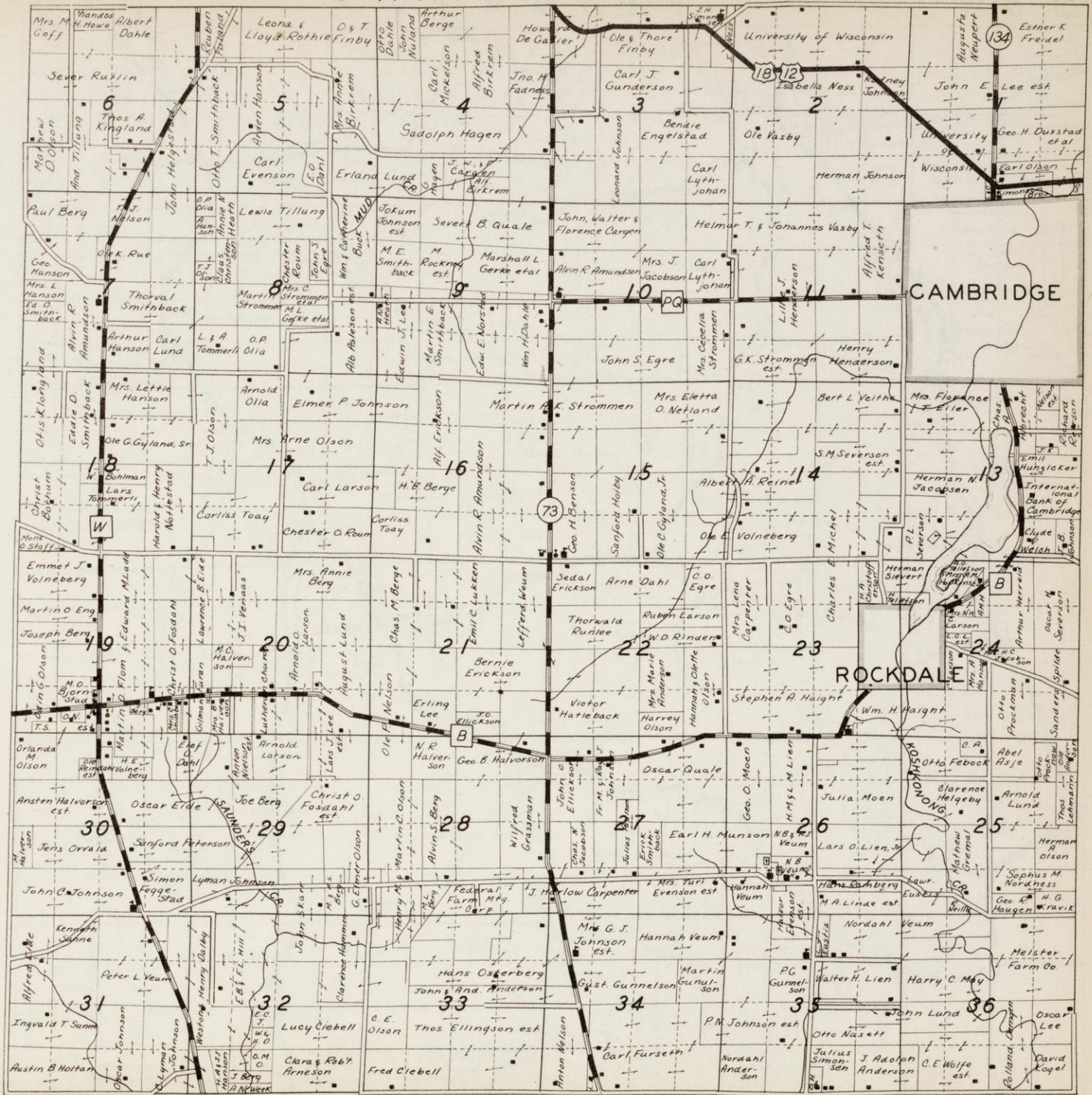

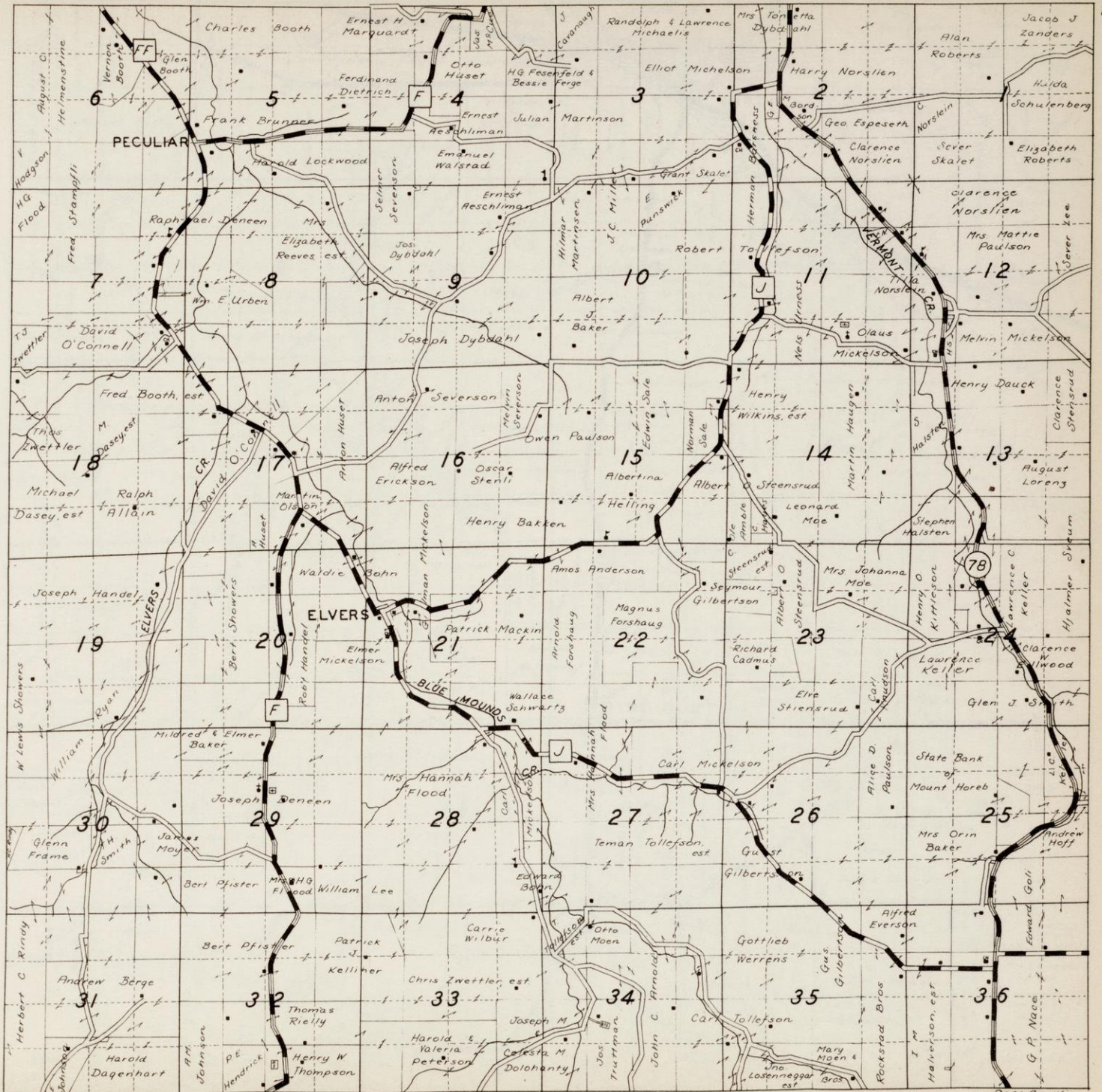

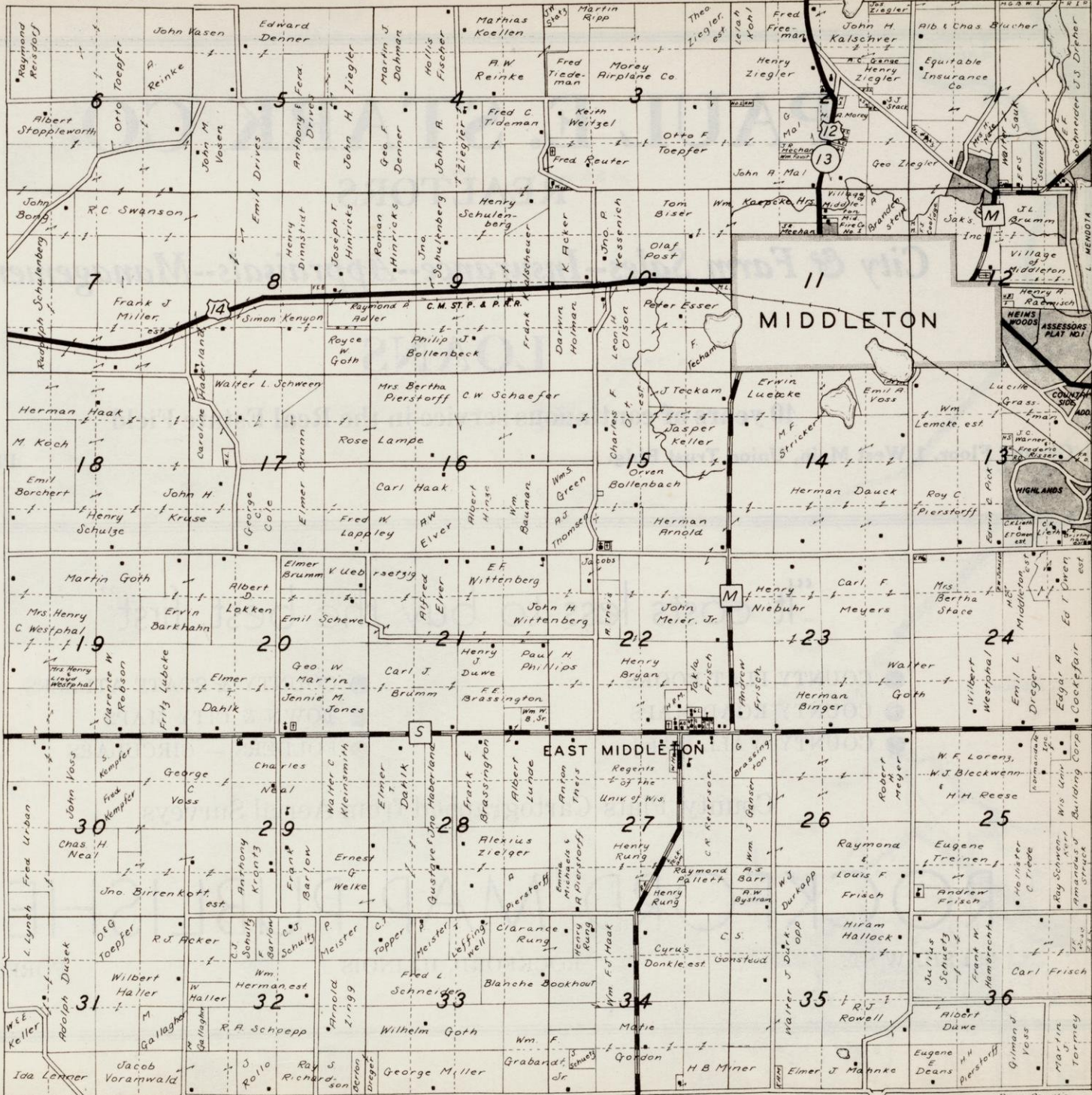

PAUL E. STARK CO.

REALTORS

City & Farm Sales--Insurance--Appraisals--Management

LOANS

40 years of continuous service in the Real Estate Field

Ground Floor, 1 West Main, Union Trust Bldg.

Phone Badger 175

“It costs less to buy the best, first”

- COUNTY PLAT BOOKS
- COUNTY ROAD MAPS
- COUNTY WALL MAPS

- COUNTY & STATE ATLASES
- TOWN & CITY MAPS
- FOLDERS — CIRCULARS

County Plats Cartographed from Aerial Surveys

ROCKFORD MAP PUBLISHERS

321 SHAW ST.

ROCKFORD, ILLINOIS

FOREST 2867

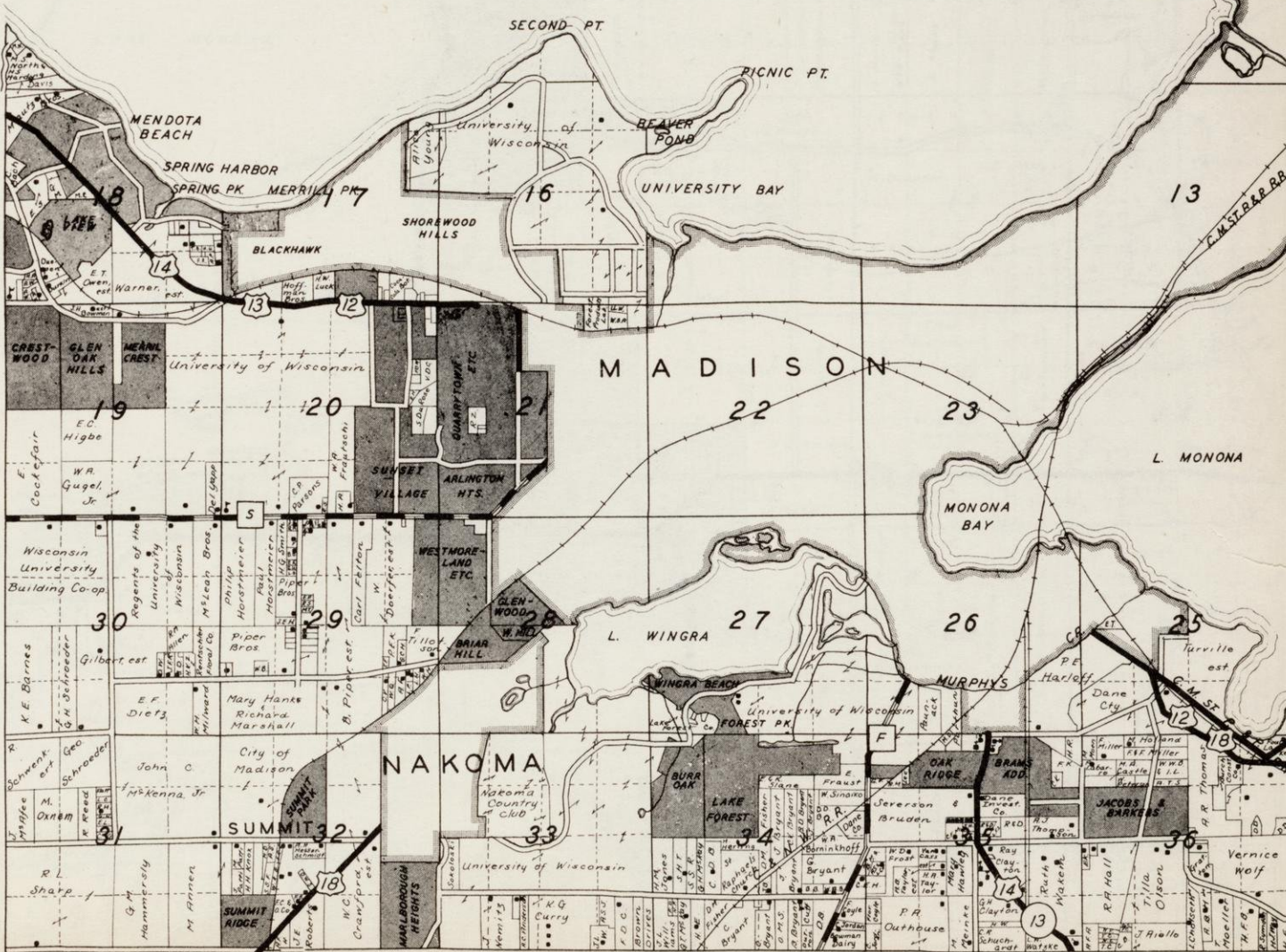
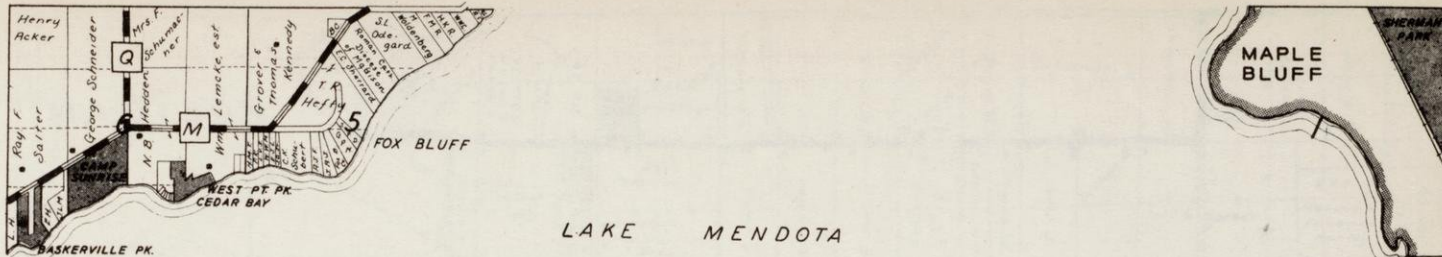

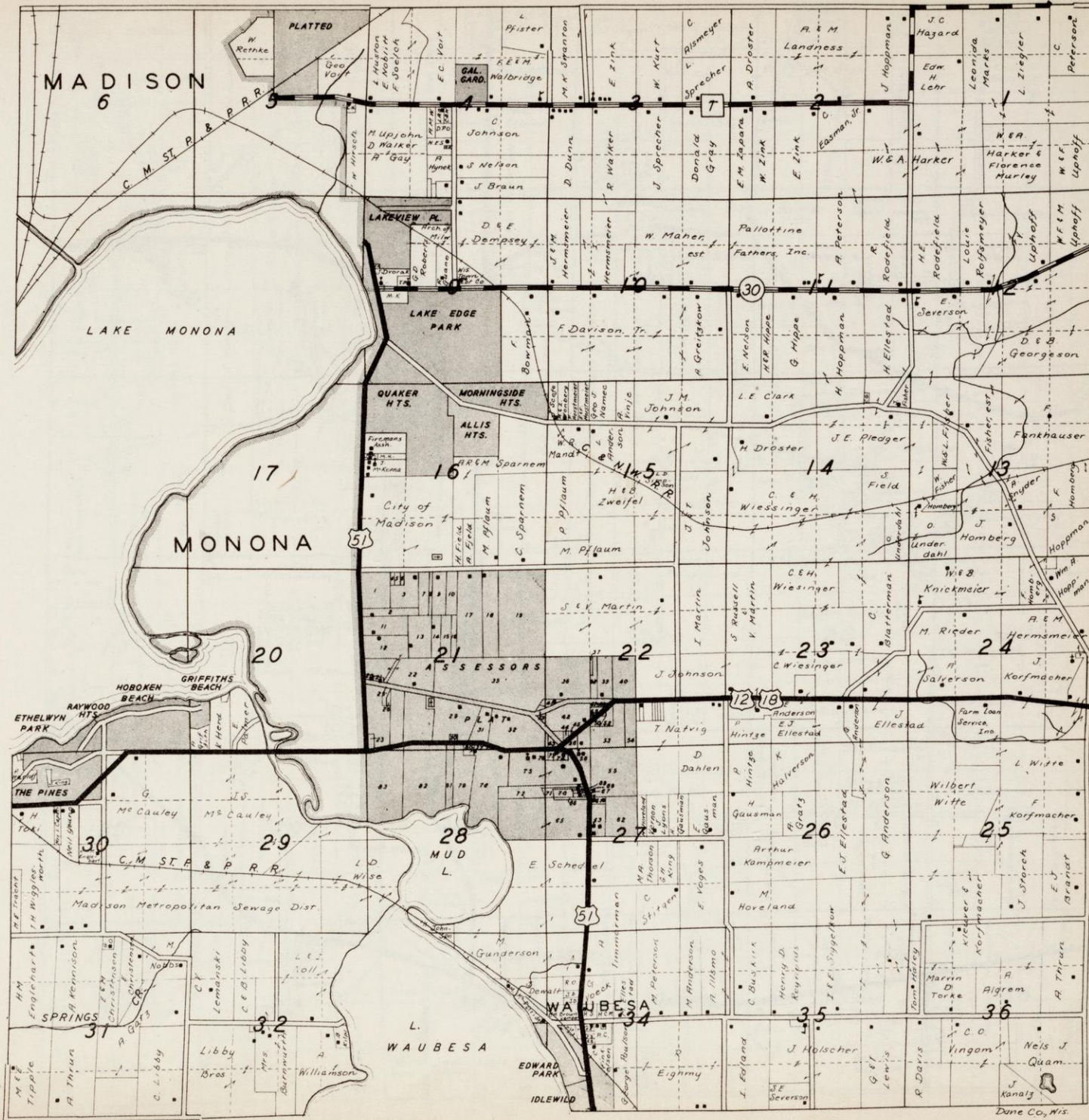

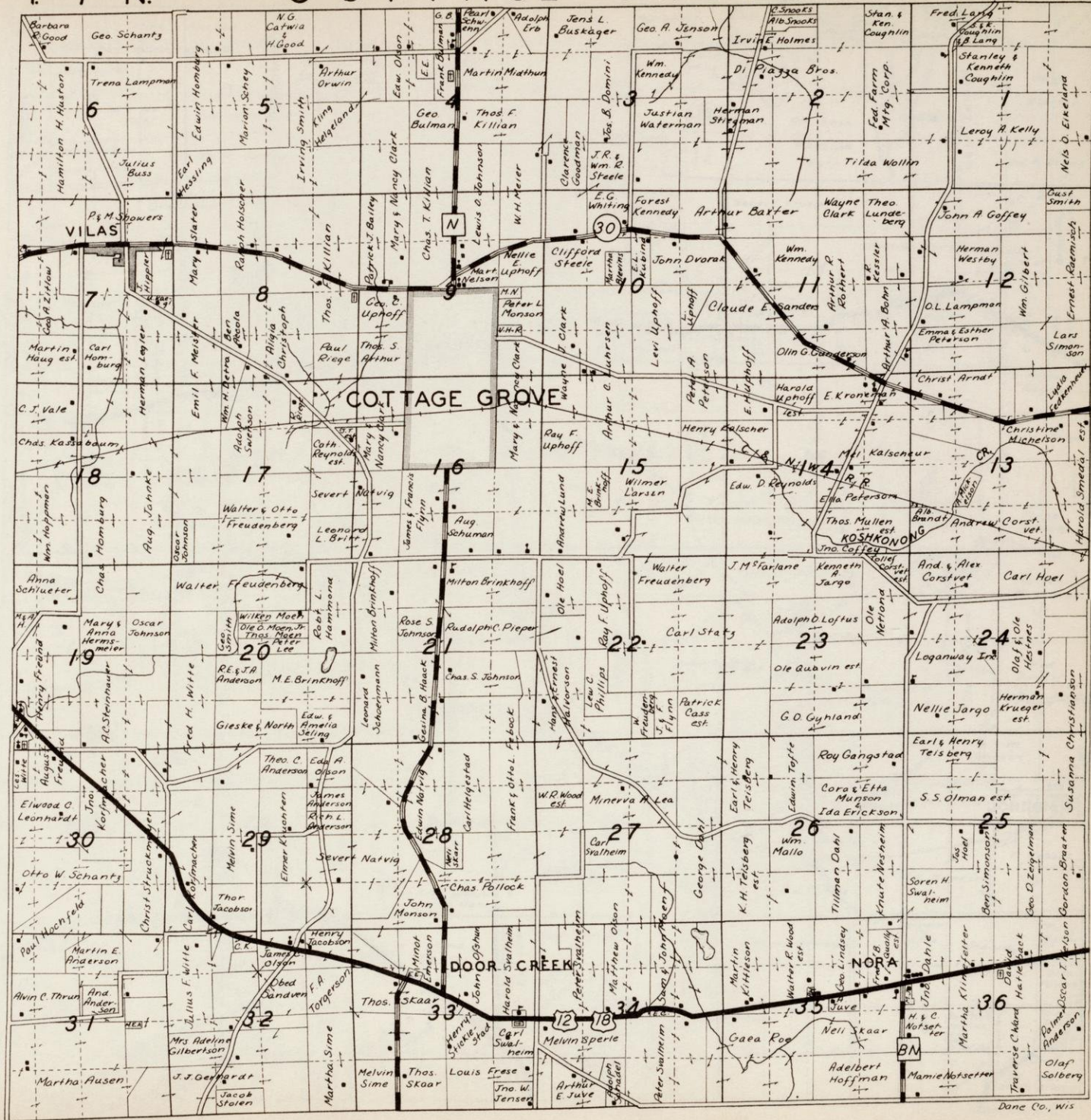

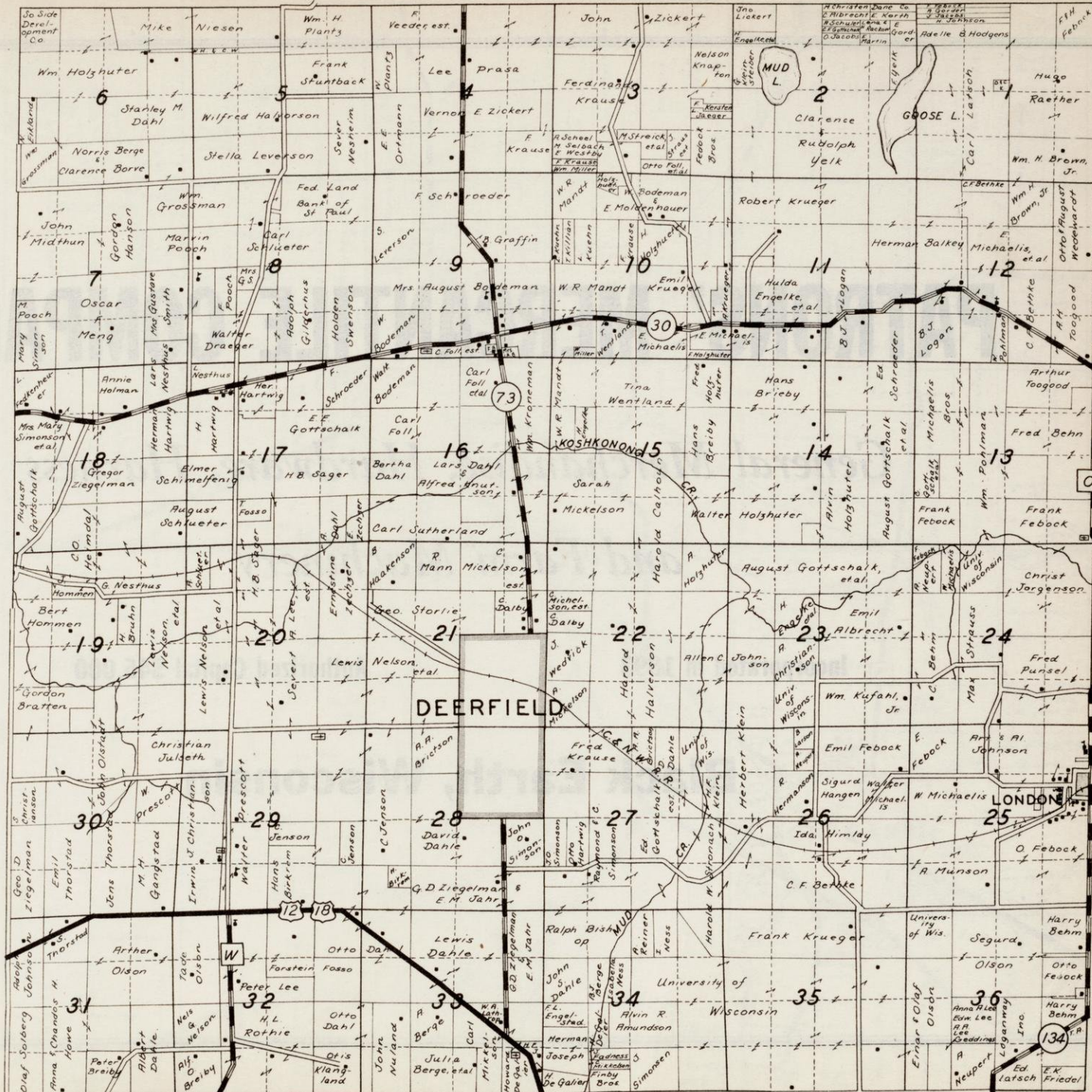

PATRONS' MERCANTILE COMPANY

*General Merchandise, Hardware, Harness
and Farm Machinery*

Incorporated in 1893

Authorized Capital \$45,000

Black Earth, Wisconsin

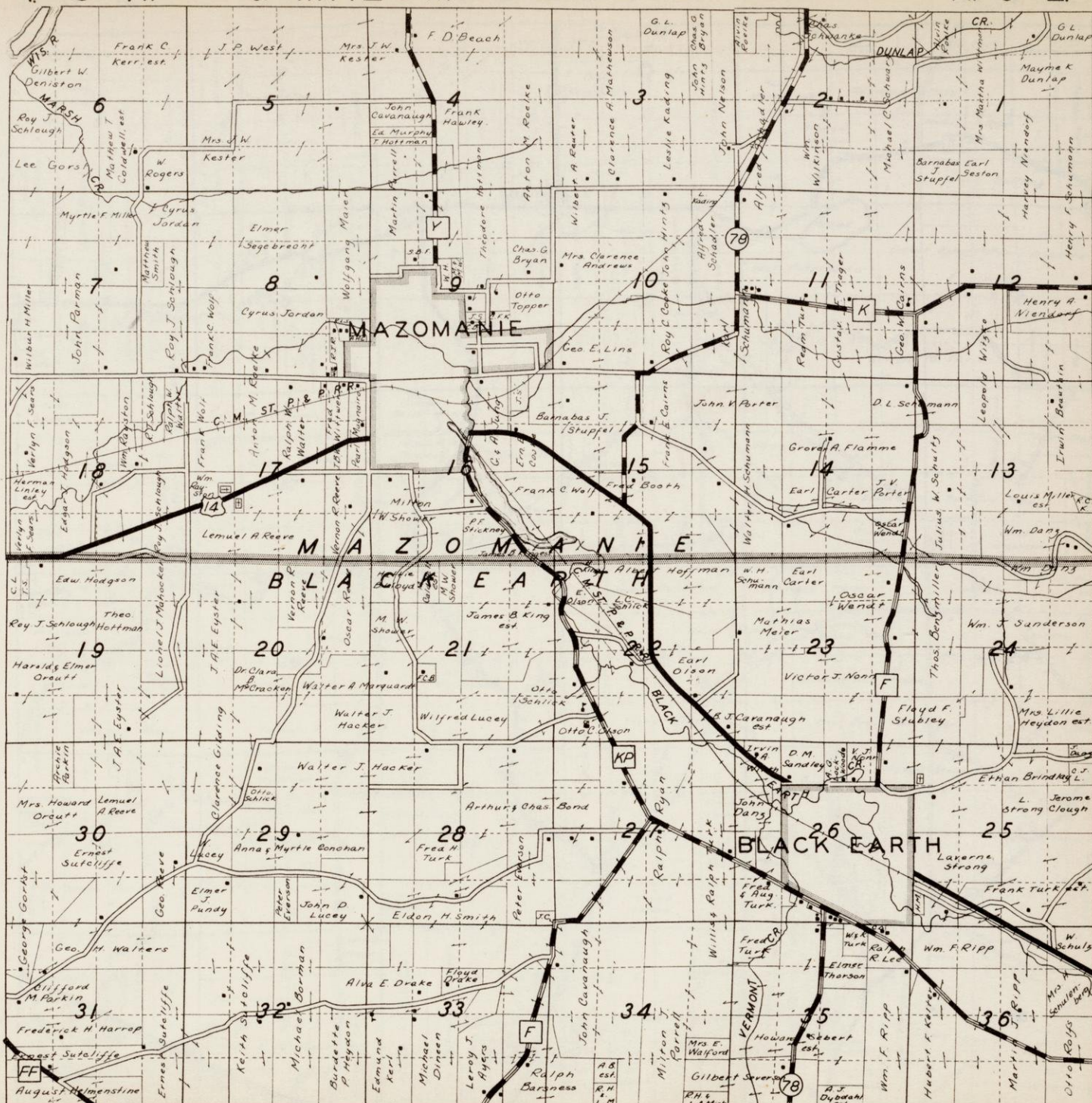

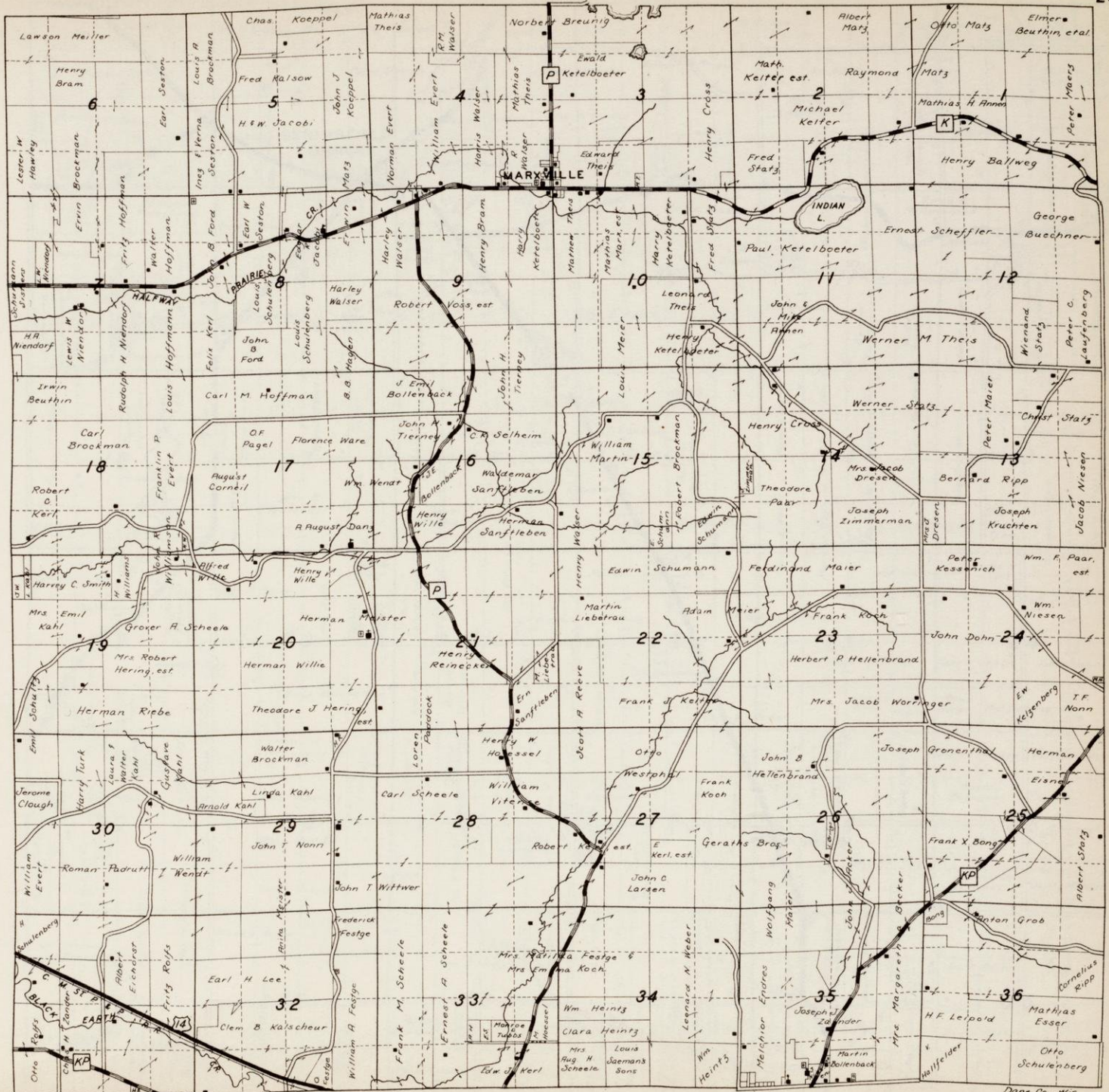

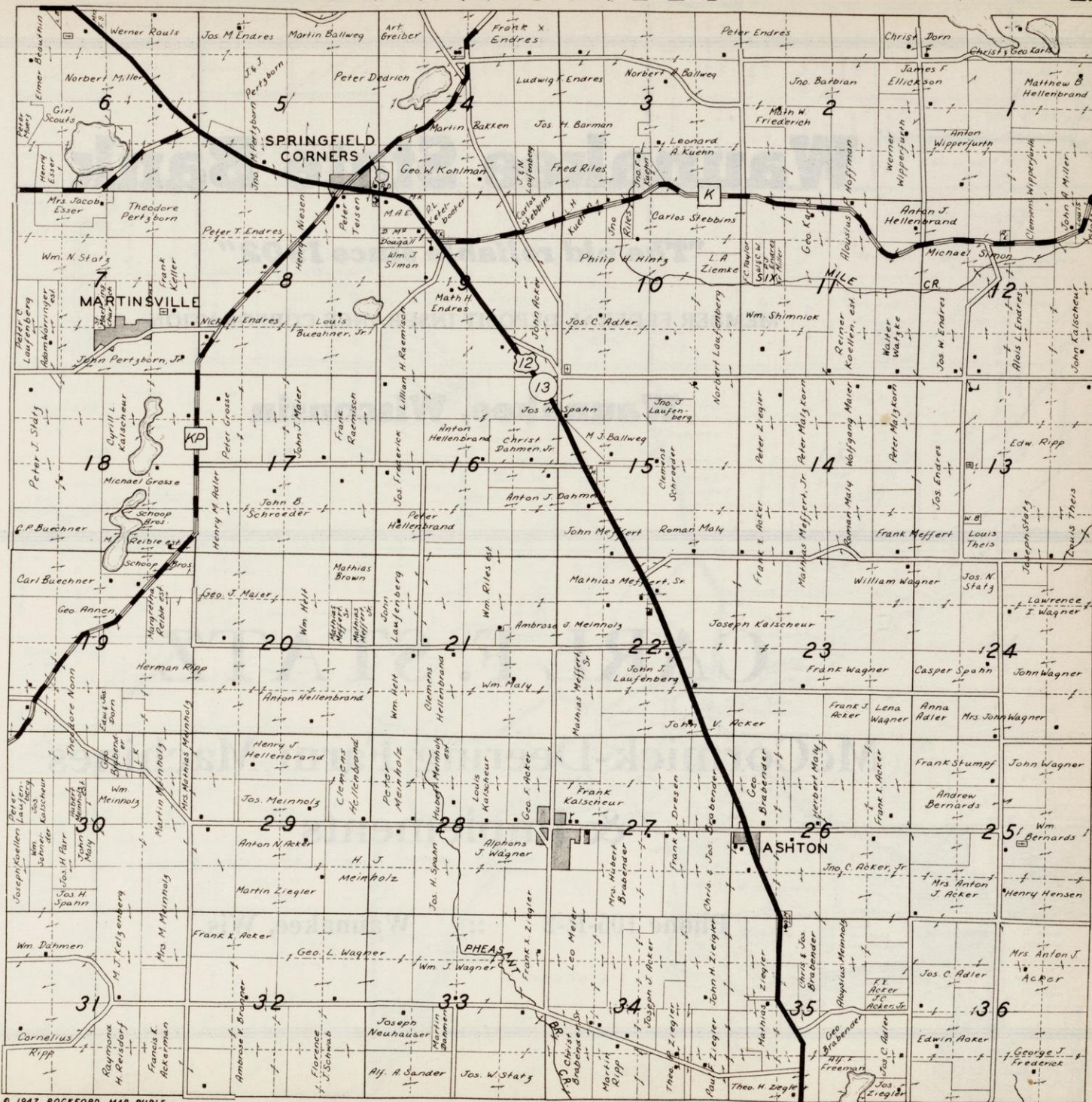

Waunakee State Bank

"The old reliable since 1902"

MEMBER FEDERAL DEPOSIT INSURANCE CORPORATION

Waunakee, Wisconsin

CARL F. STATZ

**McCormick-Deering Farm Machines
& Implements**

Phone 105-R-2 :: Waunakee, Wis.

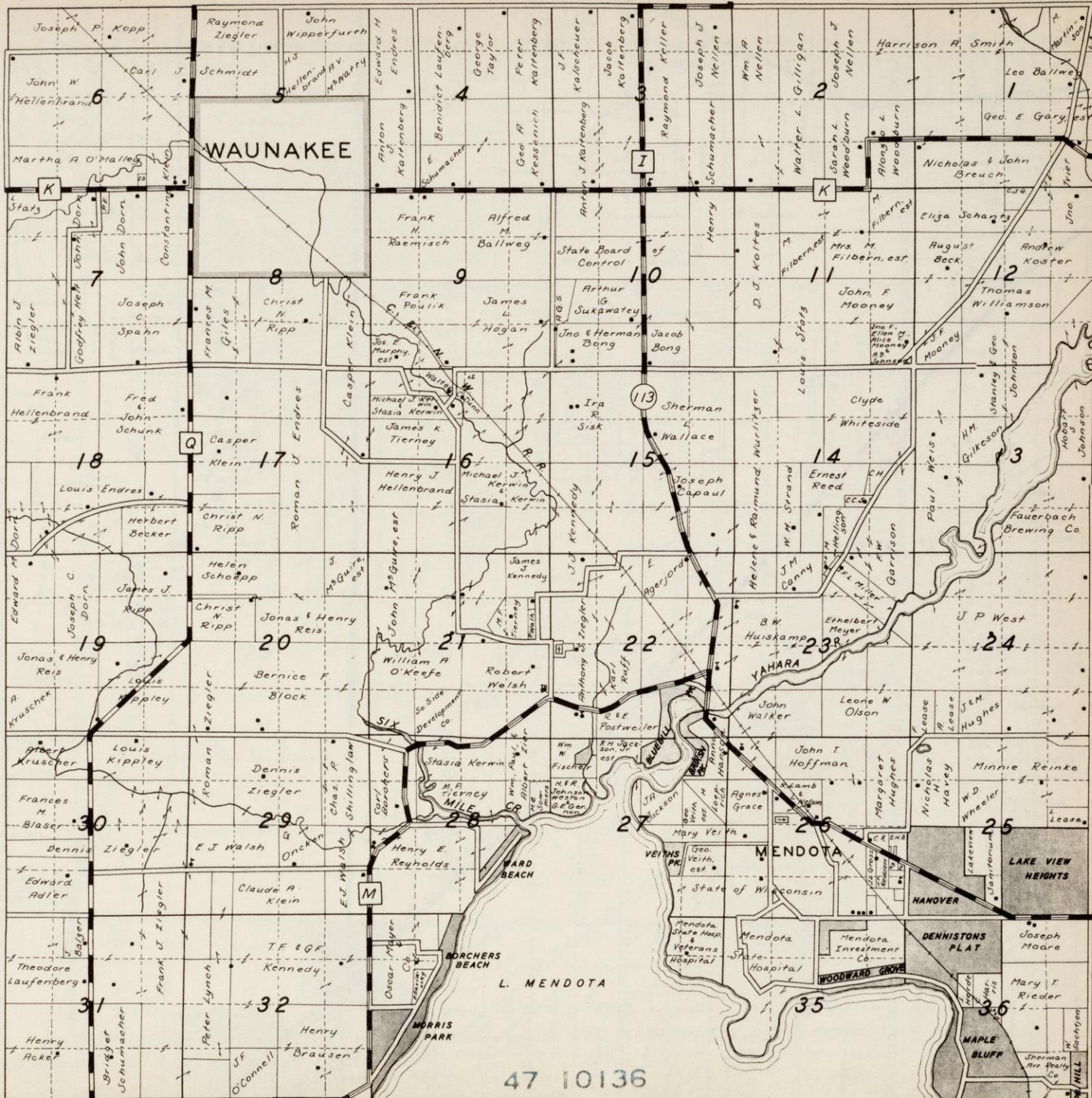

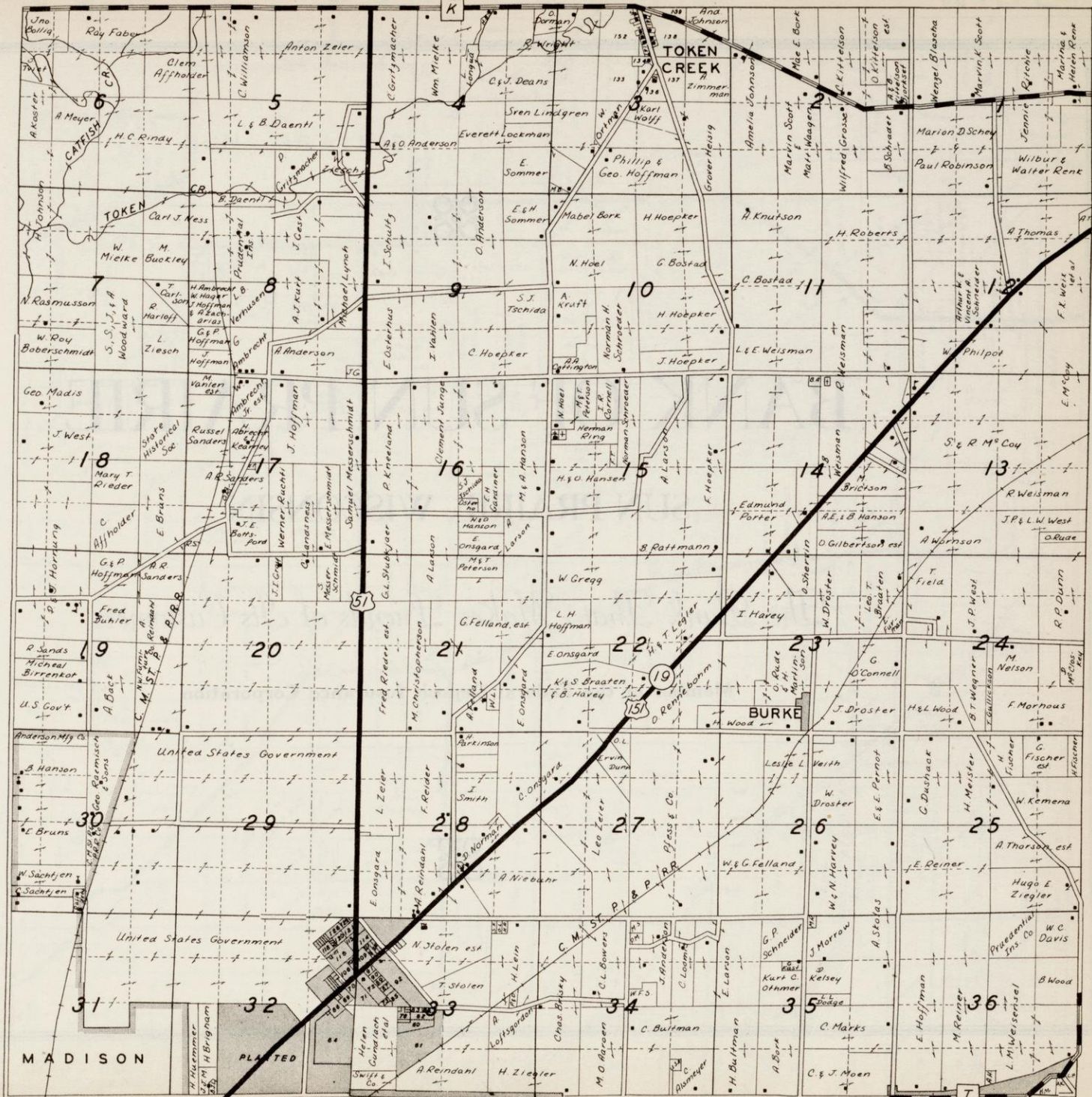



BANK OF SUN PRAIRIE

SUN PRAIRIE, WISCONSIN

The Bank That Makes Friends of Its Customers

Member of the Federal Deposit Insurance Corporation



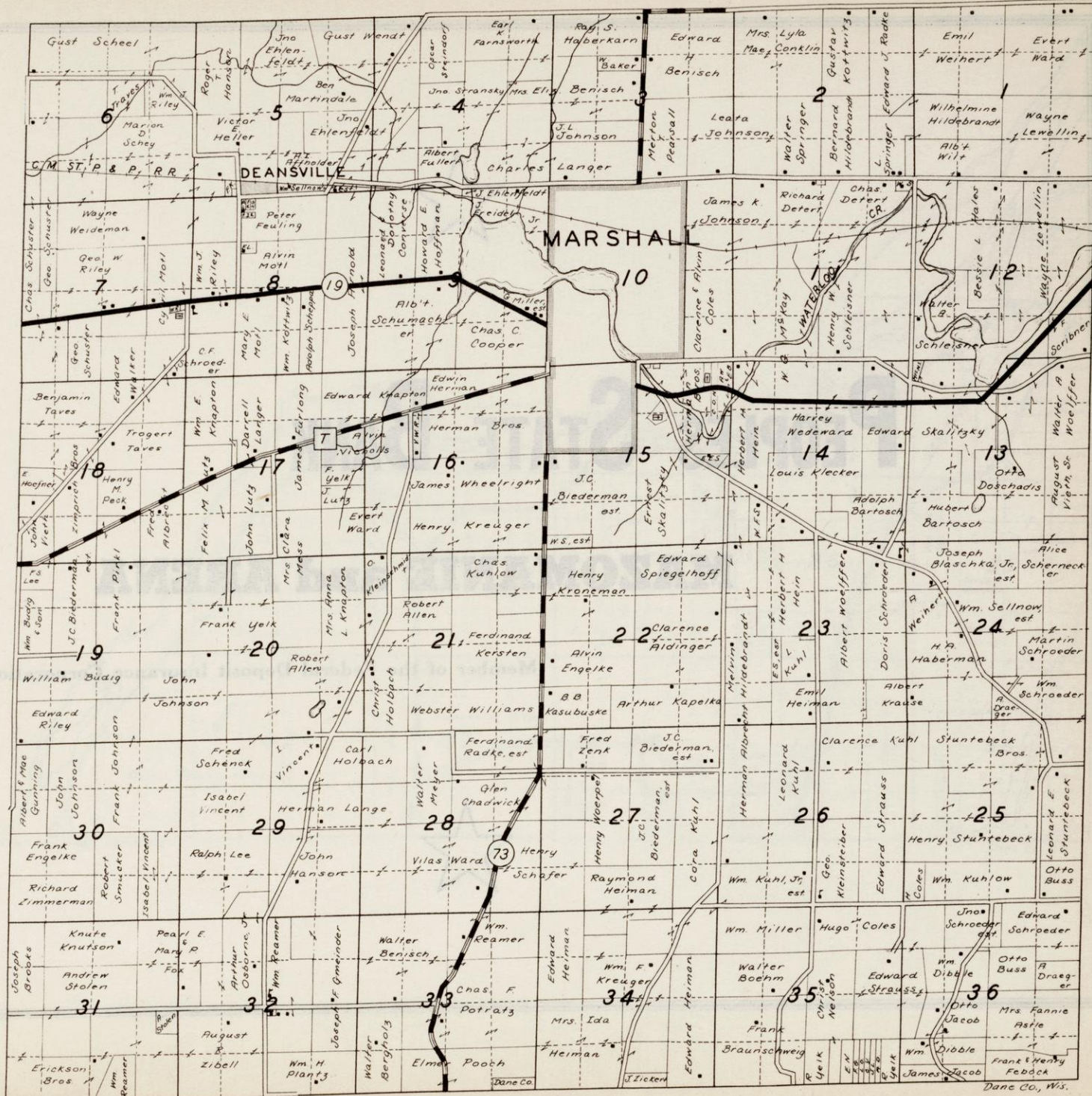



PEOPLES STATE BANK

MAZOMANIE and ARENA

Member of the Federal Deposit Insurance Corporation



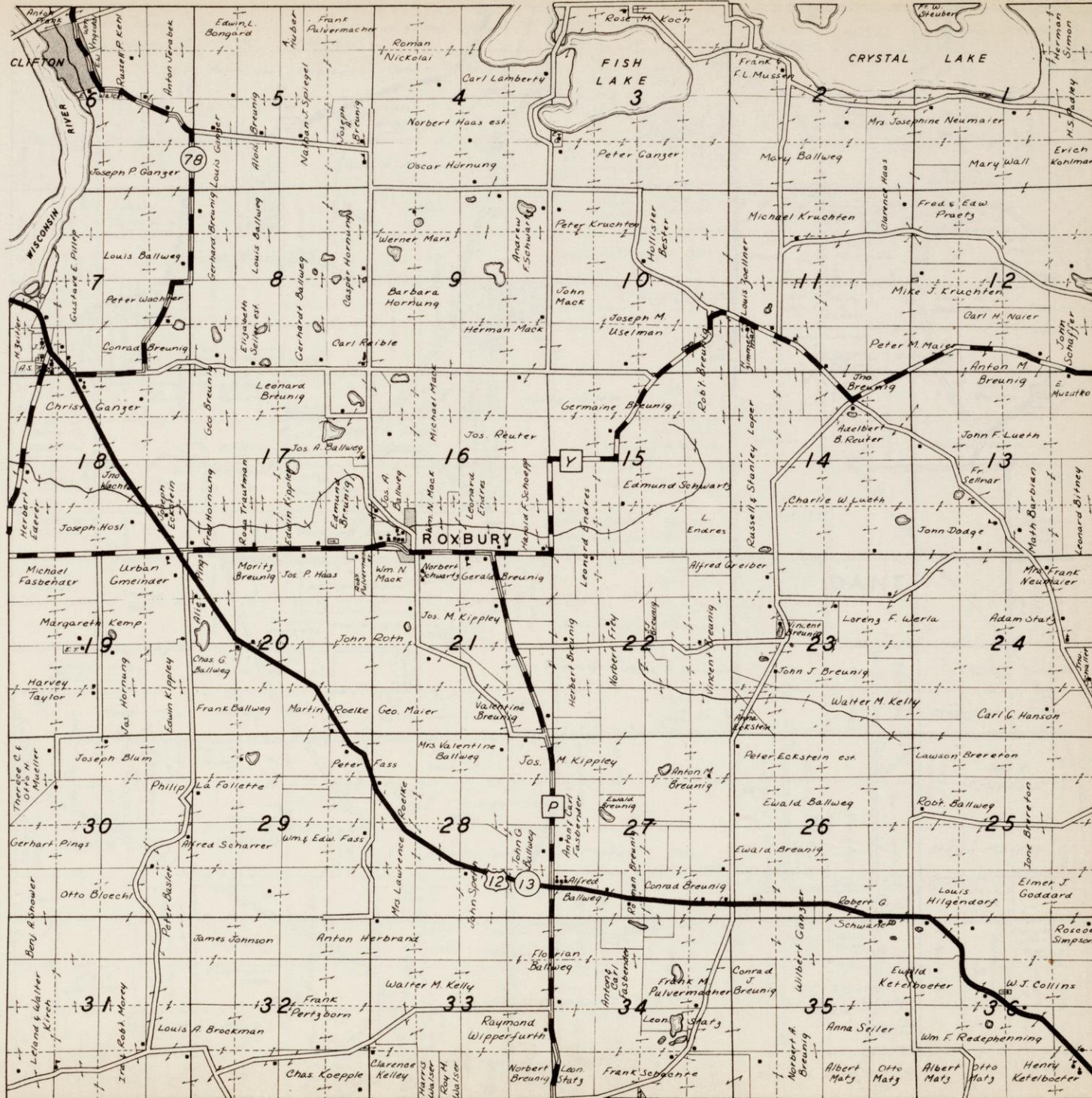

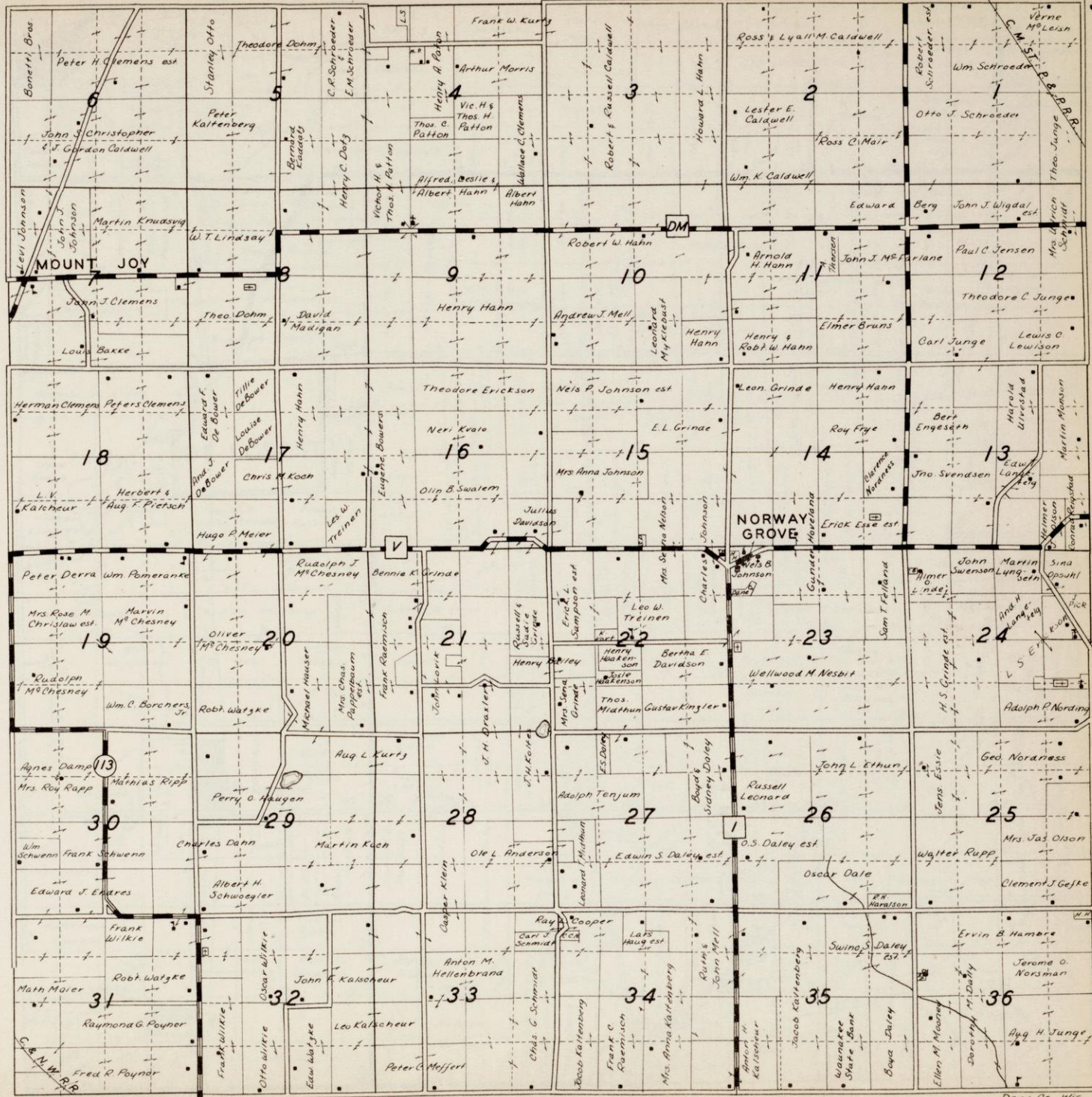

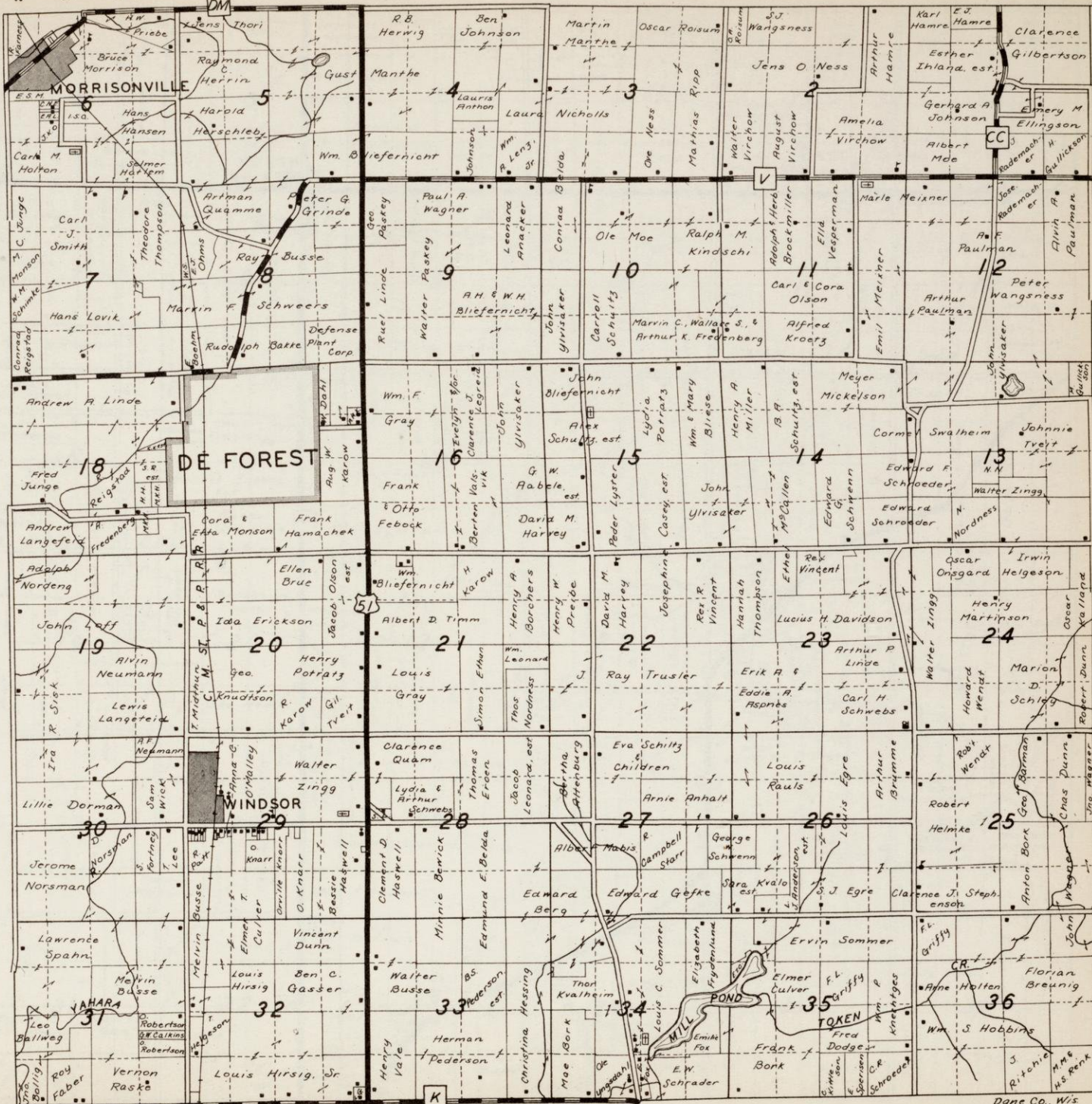

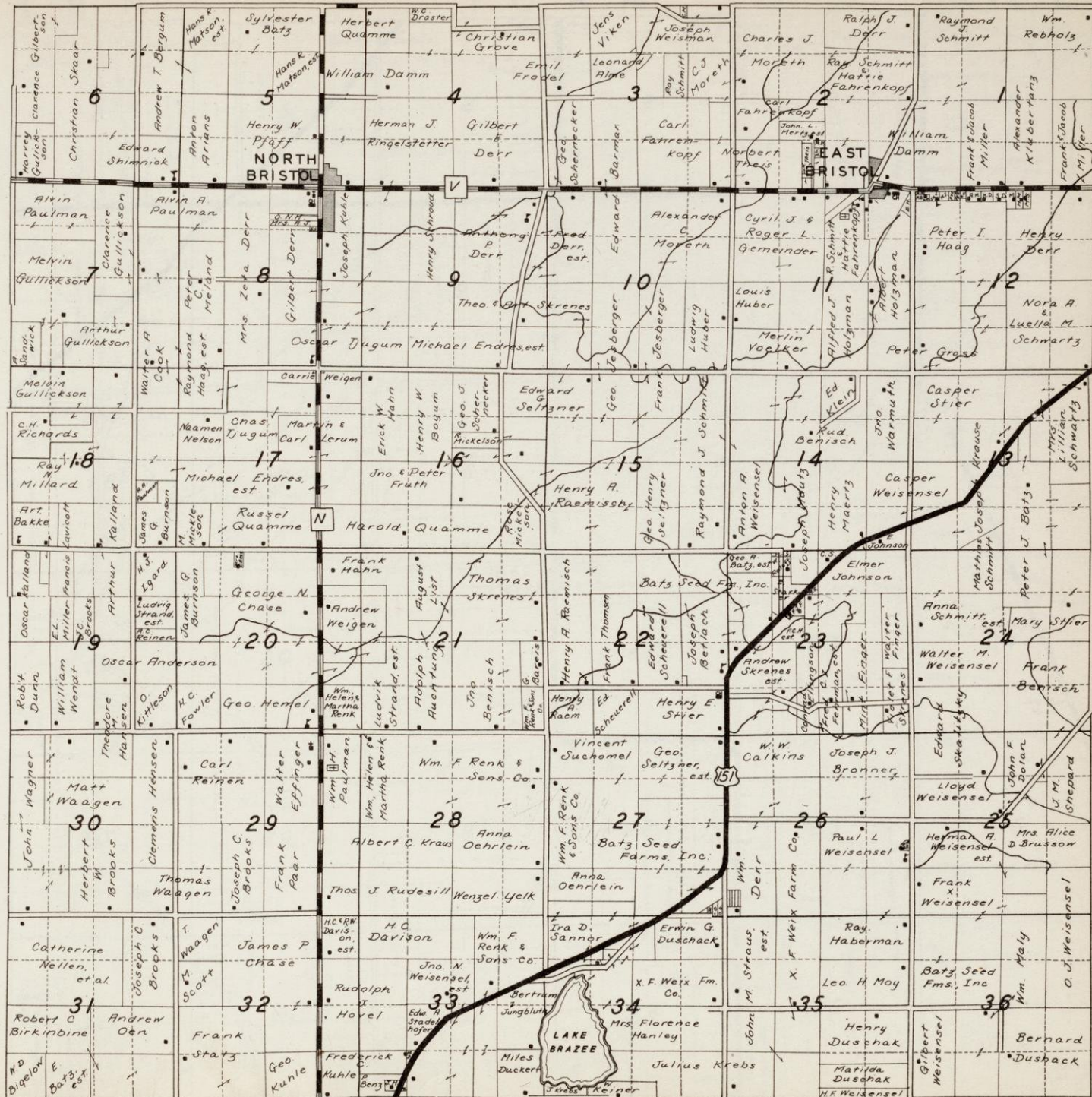

Everyone's Favorite!

Borden's
ICE CREAM



.. a real dairy food ..

