



LIBRARIES

UNIVERSITY OF WISCONSIN-MADISON

Dental depot fixtures.

[s.l.]: [s.n.], [s.d.]

<https://digital.library.wisc.edu/1711.dl/ITTQ6JEOQXJAF8N>

This material may be protected by copyright law (Title 17, US Code).

For information on re-use see:

<http://digital.library.wisc.edu/1711.dl/Copyright>

The libraries provide public access to a wide range of material, including online exhibits, digitized collections, archival finding aids, our catalog, online articles, and a growing range of materials in many media.

When possible, we provide rights information in catalog records, finding aids, and other metadata that accompanies collections or items. However, it is always the user's obligation to evaluate copyright and rights issues in light of their own use.

DENTAL DEPOT FIXTURES



The AMERICAN
CABINET CO.

MAIN OFFICE & FACTORY

TWO RIVERS, WIS. U.S.A.

EASTERN OFFICE & WAREHOUSE.....RAHWAY, N.J.



Introduction

THE object of this little booklet is to bring to the attention of the dealer, the material that we are in a position to furnish for his own use.

We have supplied many dealers with all or a part of their fixture outfits, including the J. W. Edwards Co., Billings-Marshall Dental Supply Co., Marshall-O'Brien-Worthen Co., John T. Nolde Dental Mfg. Co., Geo. W. Fels, Lee S. Smith & Son Co., Eckley Dental Supply Co., Johnson & Lund, Atlanta, M. F. Patterson Dental Supply Co., C. L. Frame Dental Supply Co., Ritter Dental Supply House, Consolidated Dental Mfg. Co., Detroit, Morrison Bros., Osmun & Cook, C. DeHaan, Northwestern Dental Supply Co., Henri Picard & Frere, Paris, and many others, and we refer to any of them as to the quality of the furniture.

Aside from the designs shown, we can furnish anything special to meet your particular requirements, and our drafting department is at your disposal. Send in a rough sketch or description of what you are in need of and we will make completed drawings and submit with our prices.

The American Cabinet Co.

Main Office and Factory
Two Rivers, Wis.

Eastern Office and Warehouse
Rahway, N. J.



IF NOT IN NEED OF GOODS IN THIS LINE NOW,
KEEP BOOK FOR FUTURE REFERENCE

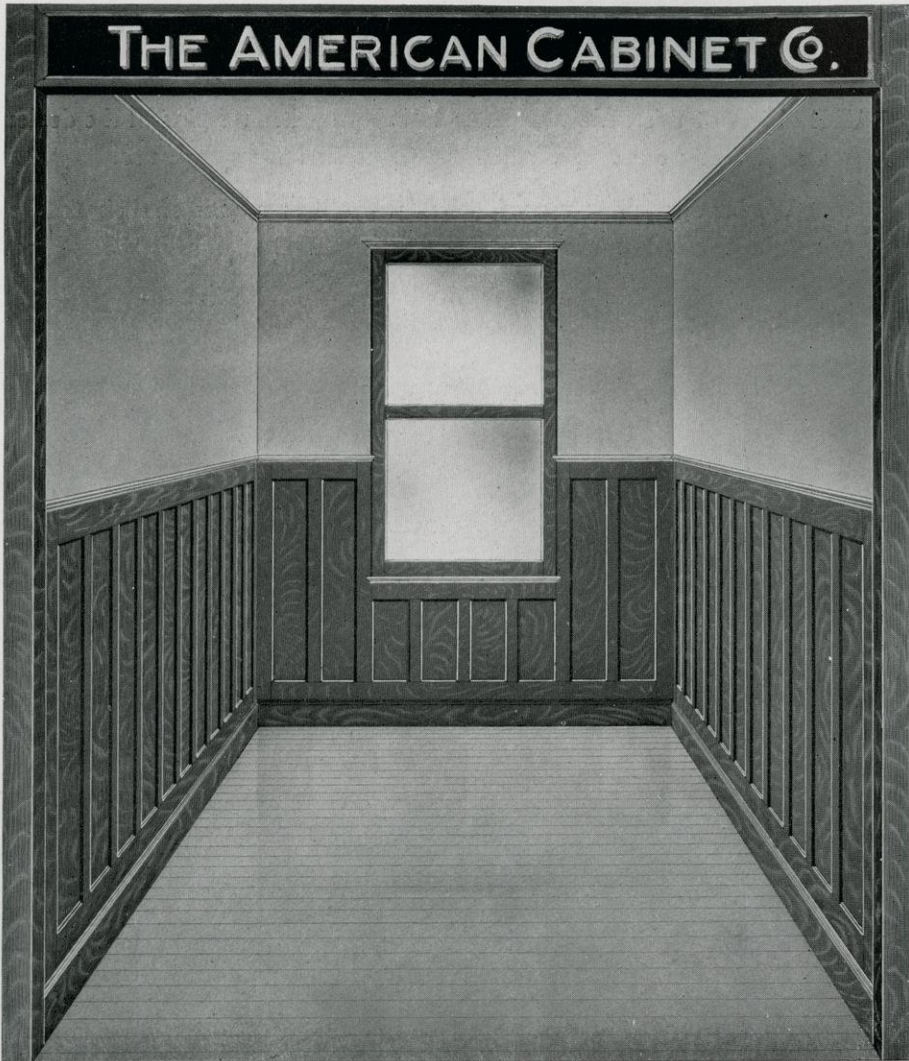

Model Offices

Probably there is no more effective way of showing Dental Outfits to advantage than in a model office.

The one shown is paneled in quartered oak with light brown wall above and with a cream ceiling, but of course we can suit your taste as to the interior finish.

A natural mahogany with green wall and cream ceiling makes a fine combination, and attracts much favorable comment, as we know from experience, having shown it on several occasions at dental meetings.

Made without the wainscoating if desired. Size as wanted.

These range in price from \$150.00 up, depending upon the material used, construction and finish.



Bracket Table Cabinet

The dealers who have used this Cabinet have been well pleased with it.

It will hold either Allan, Holmes, 20th Century, Toledo, two drawer, or flat Tables without drawers.

The entire front is a glass door which enables you to see the fronts of Tables and keeps them from dust and dirt.

This Cabinet can be used for other purposes if desired, and every dental depot needs one.

A long description is hardly necessary, as the cut shows the convenience of the Cabinet at a glance.

Made in quarter-sawed oak or mahogany with a dull rub finish, and in any shade.

DIMENSIONS:—22 inches wide, 19 inches deep, 50½ inches high.

Price to Dealer

Quarter-sawed oak.....\$20.00 Mahogany.....\$23.00

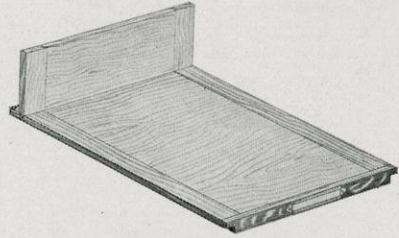
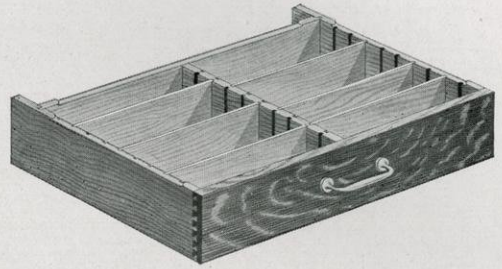

Catalog Cabinet

Many dealers have no regular place for manufacturers' catalogs, and as a result are often either entirely out or have many more than they need. They are also often scattered around on top of show cases or counters, and give the depot a most untidy appearance.

This Cabinet will provide a place for catalogs and circulars of all association manufacturers, and will enable you to see at a glance just the supply you have on hand of each catalog.

Each shelf is fitted with a label-holder and can be withdrawn so that even the smallest circular can be reached easily, and all shelves have a back attached that will prevent literature falling off. These shelves are all covered with a door with a glass front, which keep the catalogs free from dirt and dust.

In the base are three drawers with adjustable partitions for holding envelope slips or other small matter.

The Cabinets are thoroly well made in quarter-sawed oak or mahogany, and finished with a dull finish in any shade desired.

If you will put this Cabinet in use, you will find it a great convenience.

DIMENSIONS:—21 inches wide, 15 inches deep, 61½ inches high.

Price to Dealer

Quarter-sawed oak.....\$32.00 Mahogany.....\$35.00

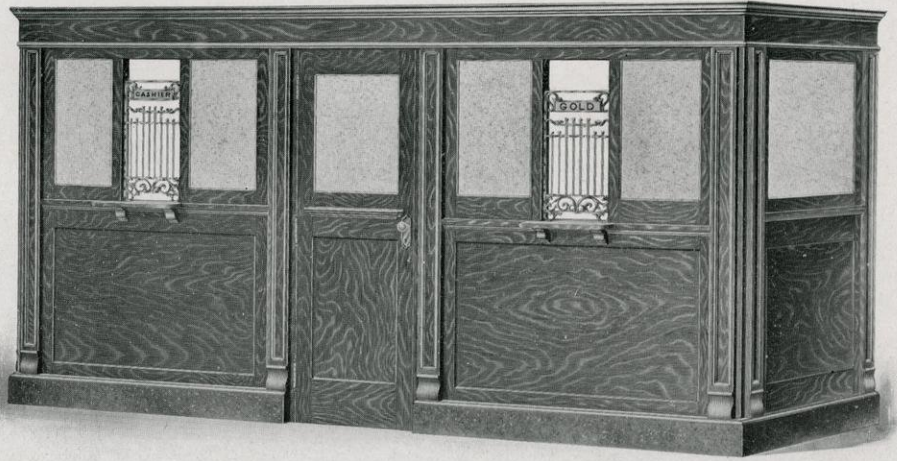

Partitions

Altho we show but this one style of partition here, we can make it in any way desired. This is a popular design but it can be furnished higher or lower with wire guards above bottom section, with plain or frosted glass, with or without marble base and in so many different ways that prices can only be given after learning the number of feet wanted with other particulars.

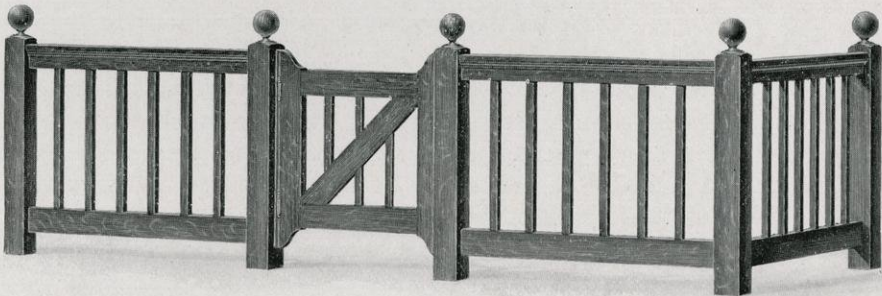

Railing

It depends to a considerable extent on the quantity ordered as to the cost of Railing. This is quite a heavy design and makes a very good appearance in oak. Prices on application.

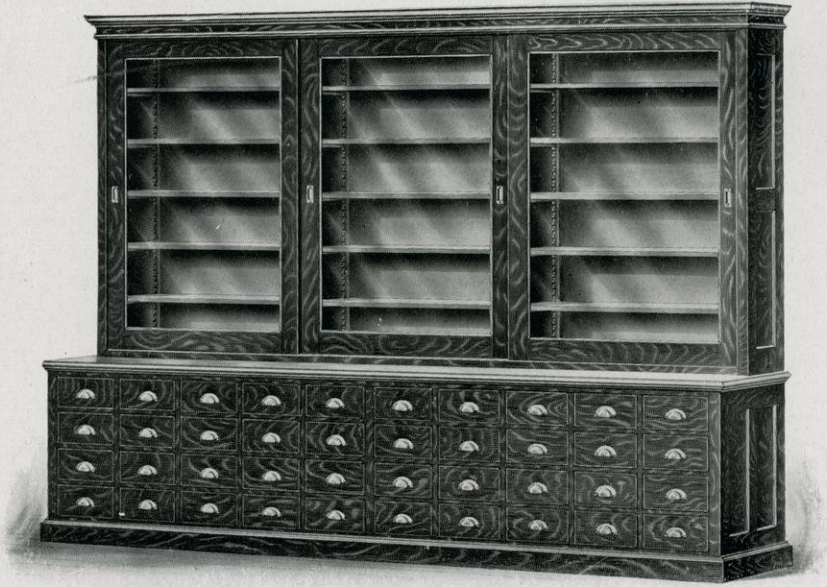

Wall Case No. 2

Wall Cases

The design shown is our No. 2 and has been often made, but it is not a stock article as it is seldom ordered the same length by any two purchasers.

The same top can be supplied on bases like those shown below, Nos. 1 and 3, or can be made of any design to best suit your requirements.

The drawers are all dovetailed, the sliding doors will never bind, and it is a serviceable piece of high grade furniture.

PLATE NO. 1

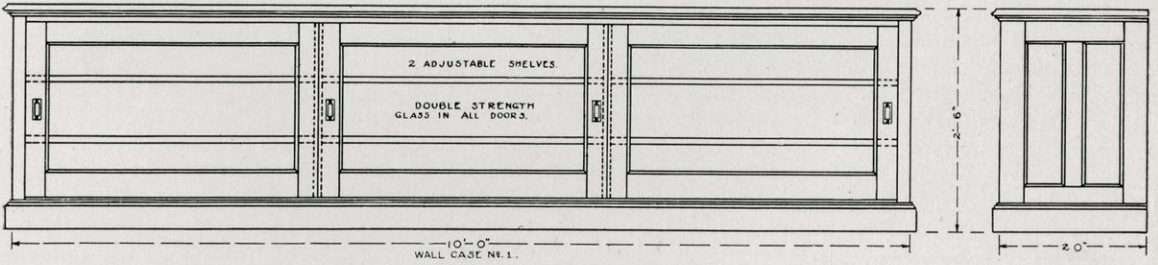
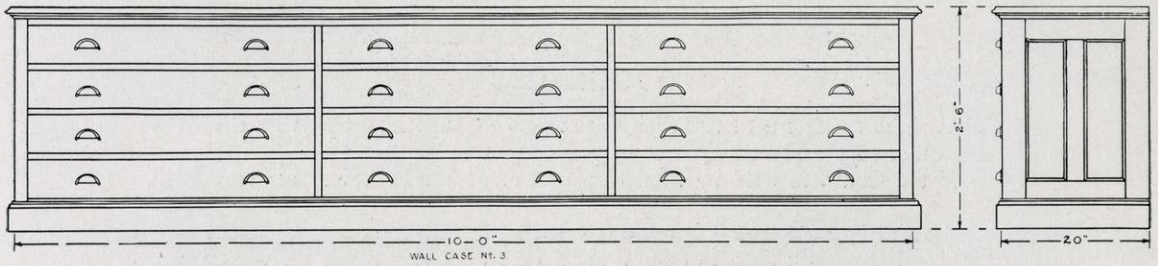



Regular Style Counter

Counters

We show here the fronts of two different styles of Counters. One with show case built on and the other of the right height to take a show case.

Most of the Counters used by the Edwards Co., at San Francisco, are made with show cases built on.

It can be readily seen that it is more convenient to pull the drawers from the rear and bring anything before you than to open a show case door and reach for what you may be in need of.

We also show you 15 different back views of Counters.

All of these plans have been suggested and are in use by dental dealers.

Those intended for show cases are usually built 3 feet high, while the others are about 3' 6" and they are as a rule ordered in 8 or 9-foot lengths.

Notice that all are made with a toe space, the drawers are dovetailed and are fitted with three-ply bottoms, the sliding doors run on ball bearings, and will not bind, label-holder pulls are used in most cases, and from start to finish they are well built pieces of cabinet work.

We have been especially favored by the dealer with orders for Tooth Counters and Cabinets. The cases in these Tooth Counters are made with three-ply bottoms and slide on steel runs. Label-holders are fitted to each case on a slanting block so they can be more readily seen. They can also be numbered both on Case and Counter if desired.



Counter with Show Case Built On

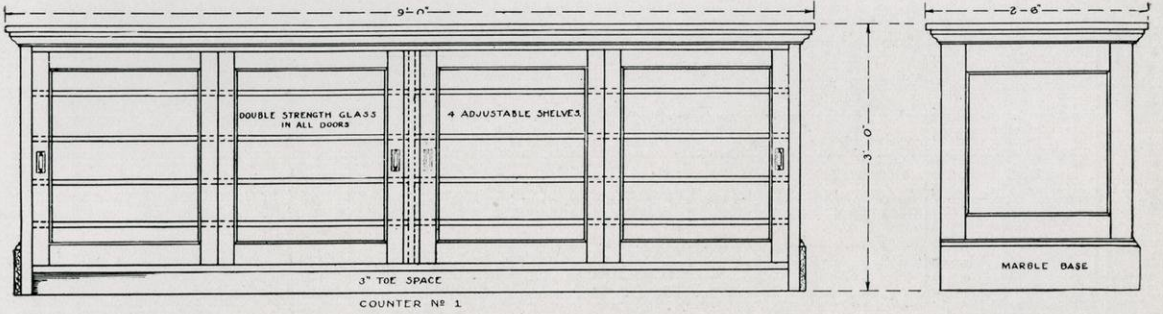

PLATE NO. 2.

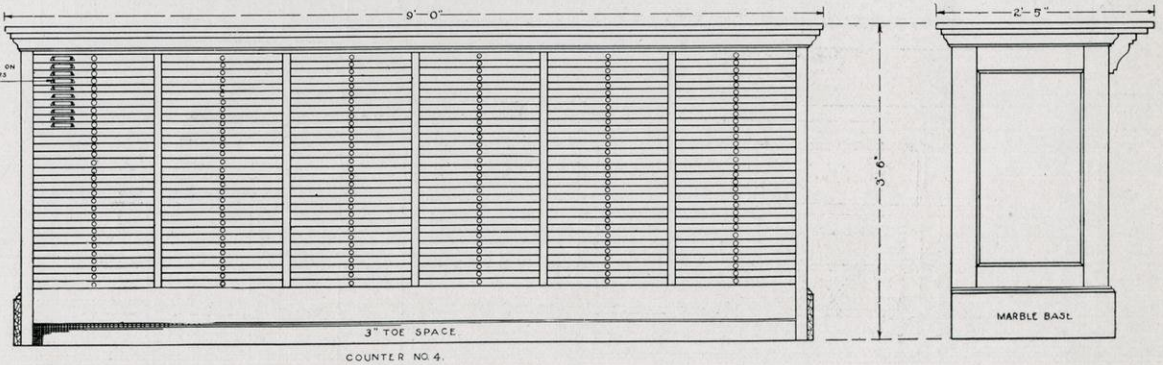
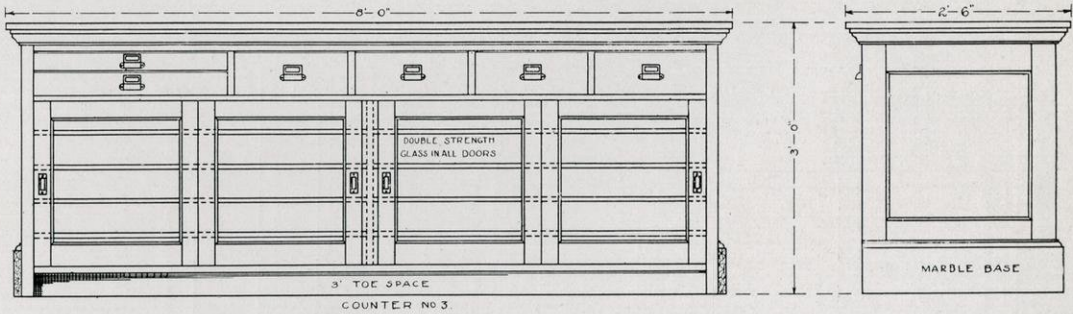
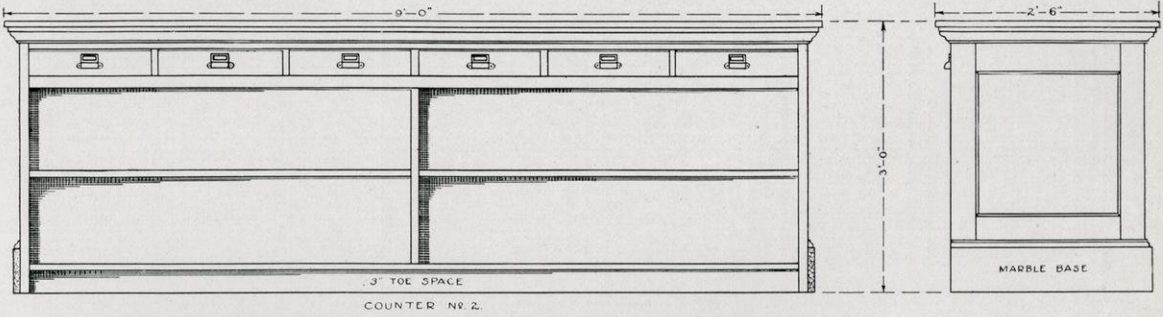

PLATE No 3.

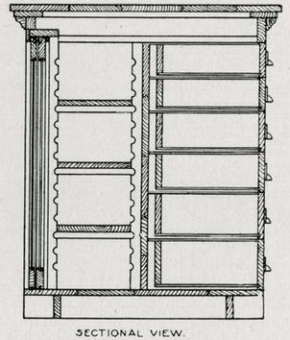
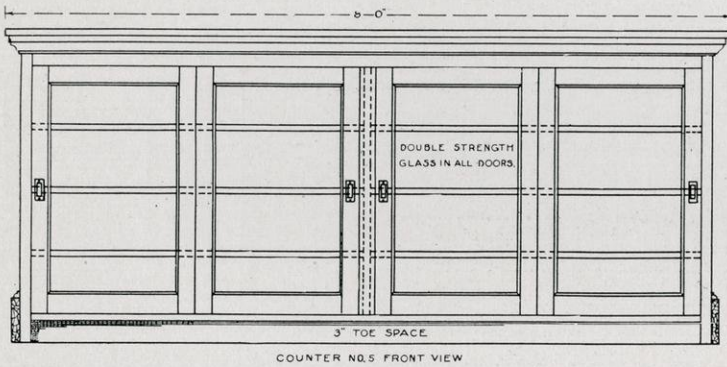
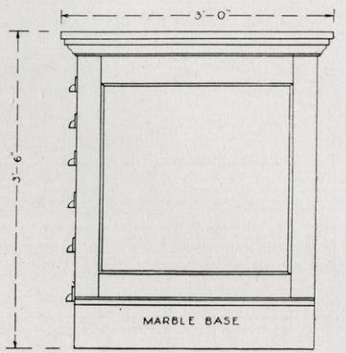
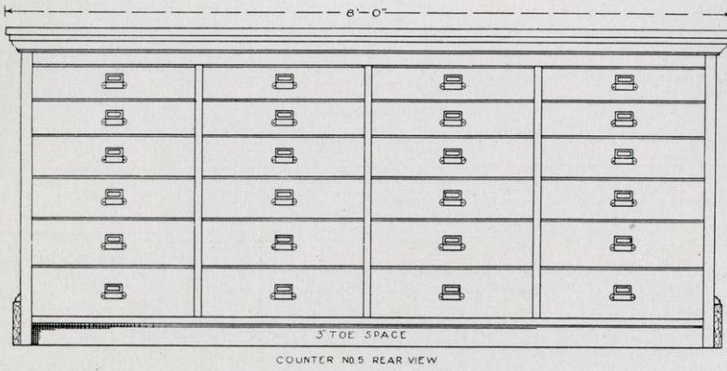

PLATE NO. 4.

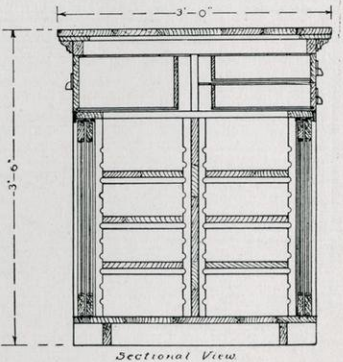
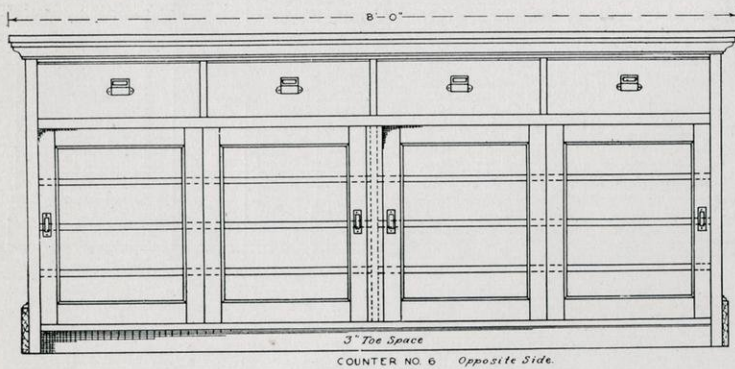
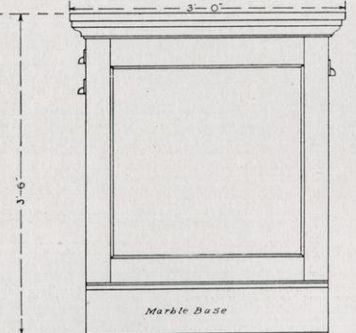
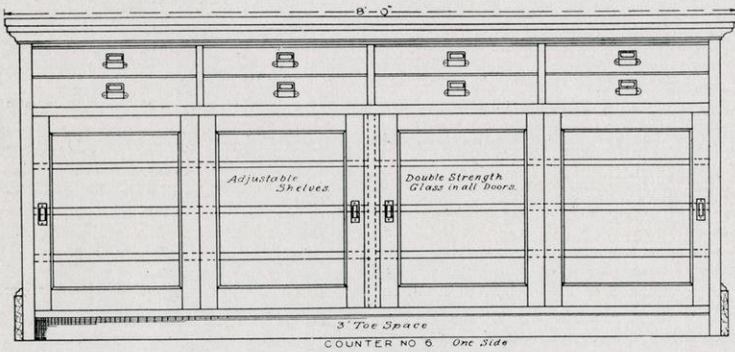
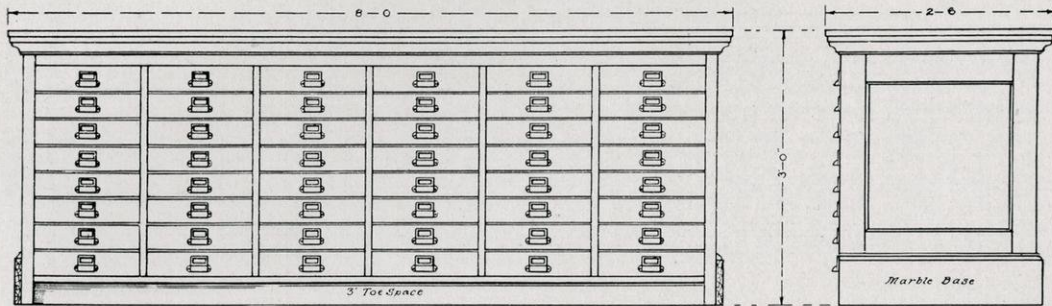
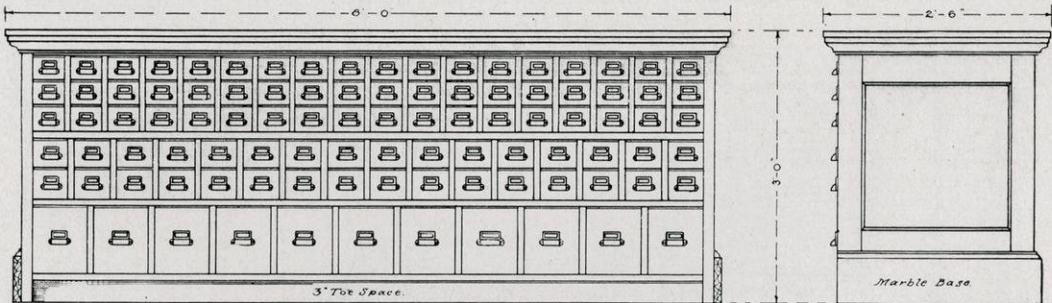

PLATE NO 5



COUNTER NO 7



COUNTER NO 8

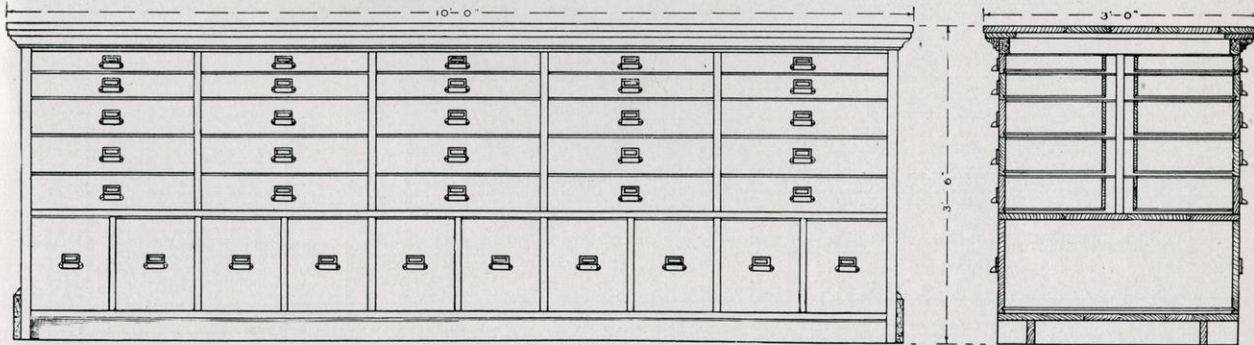

COUNTER NO 9 Both Sides Alike

Sectional View.

PLATE NO 6

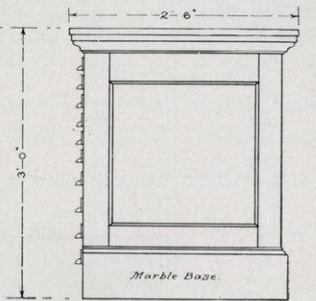
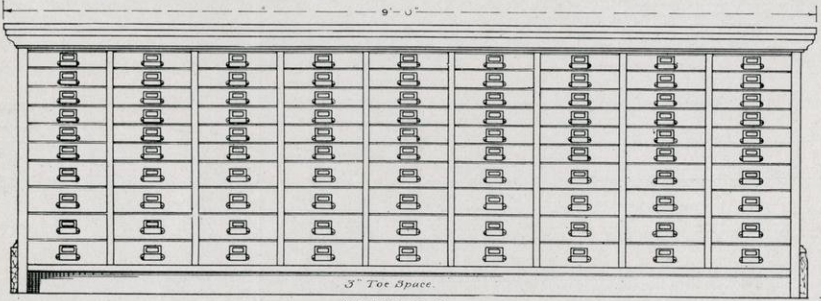
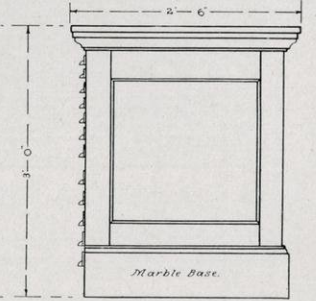
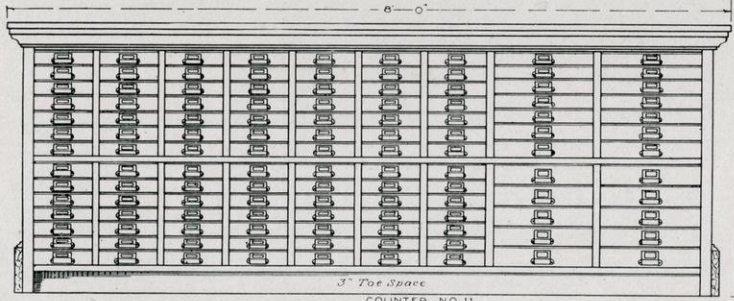
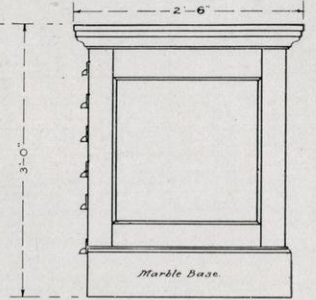
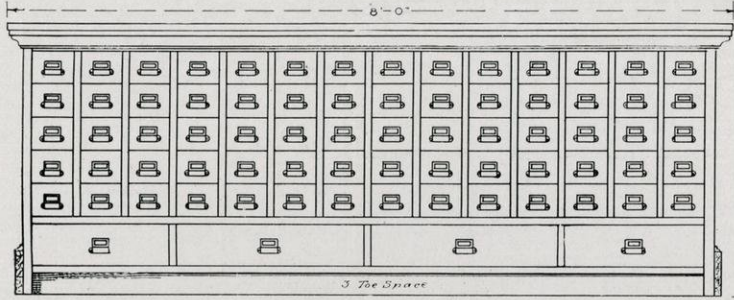

PLATE NO. 7.

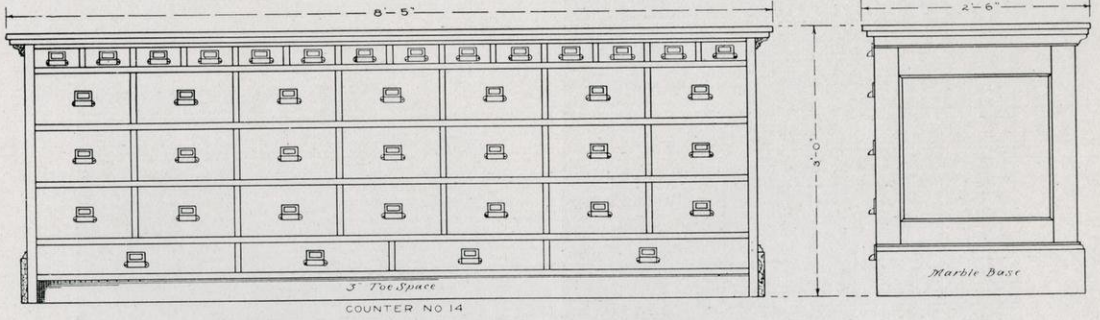
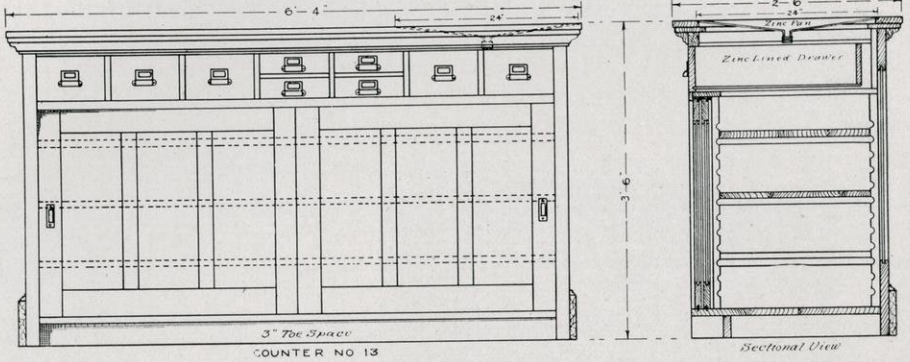
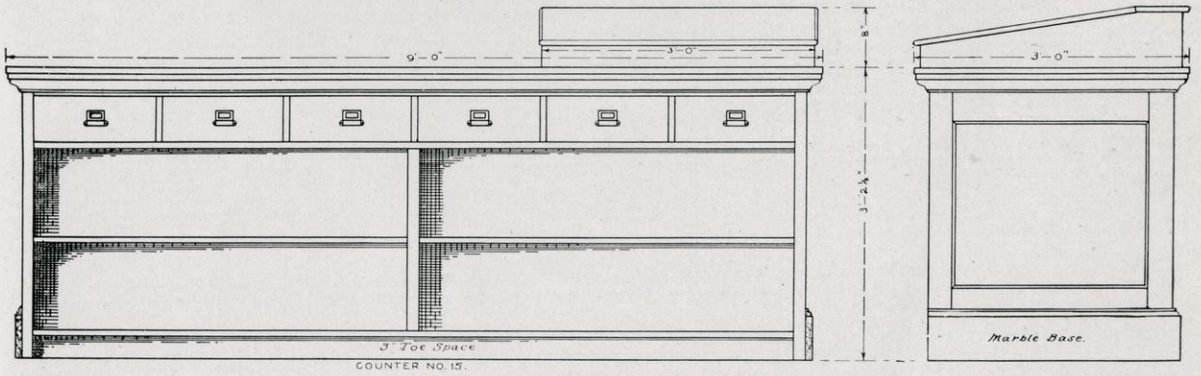

PLATE NO. 8.



Sectional Cabinets for Dealers

Sectional Cabinets have a distinct advantage over the old style in that they grow with your business.

In purchasing a cabinet it is only necessary to buy for your present needs, as the requirements of the future may be added as they are made necessary.

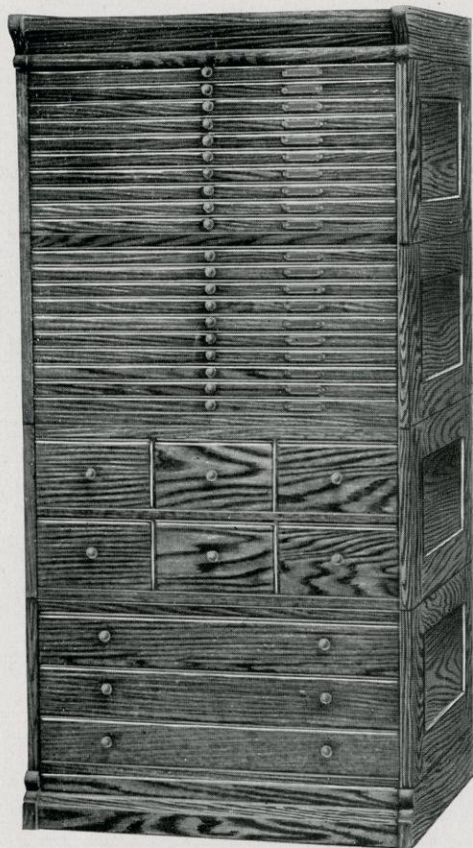

Showing Base Unit, 3 Drawer Unit, 6 Drawer Unit,
2/10 Drawer Tooth Units and Top



Tooth Unit with Base and Top

The units may expand horizontally as well as vertically.

With dental dealers perhaps these units will be especially appreciated as Tooth Cabinets, but can be used to equal advantage for other articles.

We list here six different units, two bases and one cap piece, but can furnish any special unit required, and will be pleased to quote prices on application.

In ordering care should be taken to specify cap and base pieces, if wanted, as they are not included with order for units unless especially mentioned.

Made of Oak with either Antique, Weathered or Golden Finish.

Description

- Style M Unit has 10 cases for teeth. The inside dimensions of cases are $21\frac{3}{4}$ in. wide, 16 in. long and 9-16 in. deep. Dimensions of Unit are 24 15-16 in. wide, 20 in. deep and $10\frac{7}{8}$ in. high. Each case is divided by a center partition and contains space for 8 boxes of teeth, laid side by side. We will partition these cases differently when requested to do so, without extra charge.....\$12.00
- Style N Unit has three drawers running full width of section. The inside dimensions are 22 in. wide, 16 in. long and $2\frac{3}{8}$ in. deep. Dimensions of Unit are 24 15-16 in. wide, 20 in. deep and $10\frac{7}{8}$ in. high. See illustration..... 10.00
- Style O Unit has six drawers. Inside dimensions are $6\frac{3}{4}$ in. wide, $16\frac{1}{2}$ in. long and $3\frac{7}{8}$ in. deep. Dimensions of Unit are 24 15-16 in. wide, 20 in. deep and $10\frac{7}{8}$ in. high. See illustration..... 11.00
- Style P. Unit has eight drawers. Inside dimensions are $4\frac{3}{4}$ in. wide, $16\frac{1}{2}$ in. long and $3\frac{7}{8}$ in. deep. Dimensions of Unit are 24 15-16 in. wide, 20 in. deep and $10\frac{7}{8}$ in. high..... 11.50
- Style Q Unit has seven blank cases for electrotypes. Dimensions of Unit are 24 15-16 in. wide, 20 in. deep and $10\frac{7}{8}$ in. high..... 10.00
- Style R Unit has seven Indexed Electrotpe cases. (If you are in need of an up-to-date electrotpe cabinet, send for circular). Dimensions of Unit are 24 15-16 in. wide, 20 in. deep and $10\frac{7}{8}$ in. high..... 11.00
- Cap Piece S. Dimensions 24 15-16 in. wide, $3\frac{1}{4}$ in. high, and 20 in. deep. See illustration..... 2.50
- Base T. Dimensions 24 15-16 in. wide, 3 in. high and 20 in. deep. See illustration..... 1.50
- Cupboard Base W. Dimensions 24 15-16 in. wide, 24 in. high and 20 in. deep.... 11.00

Discount from above prices, 25 and 10 per cent.



Tooth Stock Cabinets

The above engraving represents an article of furniture needed by every dealer in dental supplies. We make them any size desired, either as to height or number of tiers.

The size of the drawers is usually about 20 inches long, 16 inches wide and 9-16 of an inch deep, but as the cabinets are made to order the size can be made to suit the requirements in each case. We also divide the drawers into two equal parts, as shown, or make compartments of the right size to take in an ordinary tooth box.

The drawers slide on steel runs, which enables us to get in more drawers in the same space than would be possible were wood runs used, and they also slide much more easily. The bottoms are made of three-ply veneer. Each drawer is fitted with a brass label holder. The cabinet is well built throughout and has a good rub finish.

Our prices are based on being made of Ash with a Golden Oak Finish, but will quote on any wood on application.

Price List

20 Case Cabinet contains about	6,400 sq. in., 25 in. high	\$26.00
25 Case Cabinet contains about	8,000 sq. in., 30 in. high	30.00
30 Case Cabinet contains about	9,600 sq. in., 35 in. high	34.00
40 Case Cabinet contains about	13,000 sq. in., 45 in. high	40.00
50 Case Cabinet contains about	16,000 sq. in., 55 in. high	45.00
60 Case Cabinet contains about	19,000 sq. in., 65 in. high	50.00

The 40, 50 and 60 Case Cabinets furnished in 1 or 2 tiers as desired
Apply for prices on special sizes

Special Tooth Counters Made to Order

Discount from above prices, 25 and 10 per cent.

Dental Depot Interiors

The following are a few views of the Dental Depots that we have furnished :



M. F. Patterson Dental Mfg. Co., St. Paul, Minn.

Fixture Outfits

We have supplied many of the largest and best Dental Depots with their fixtures



M. F. Patterson Dental Supply Co., St. Paul, Minn.



Lee Smith & Sons Co., Pittsburg Pa.



Lee Smith & Sons Co., Pittsburg Pa.

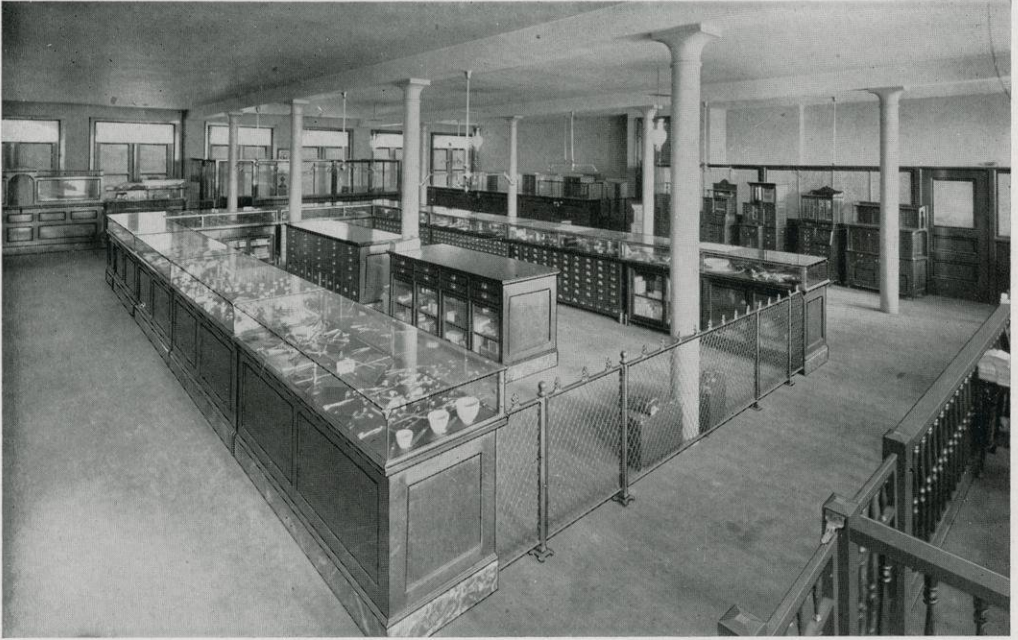

M. F. Patterson Dental Supply Co., St. Paul, Minn.

We manufacture special furniture of all kinds, and will be pleased to submit drawings and prices on anything in the line of cabinet work.

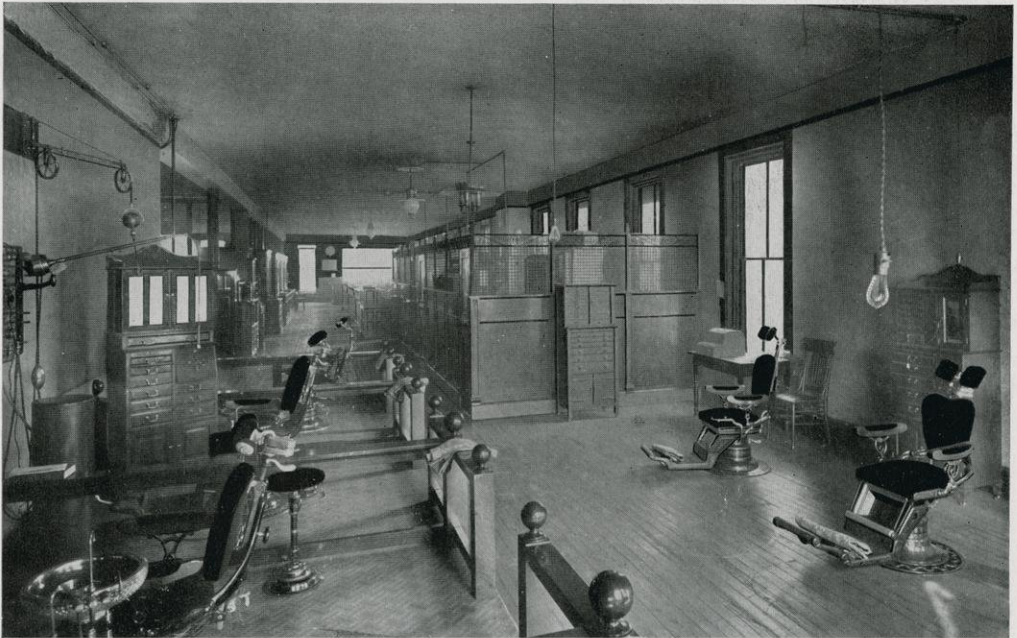

Marshall-O'Brien-Worthen Co., Des Moines, Iowa



John T. Nolde Mfg. Co., St. Louis



Tooth Counter—John T. Nolde Mfg. Co., St. Louis

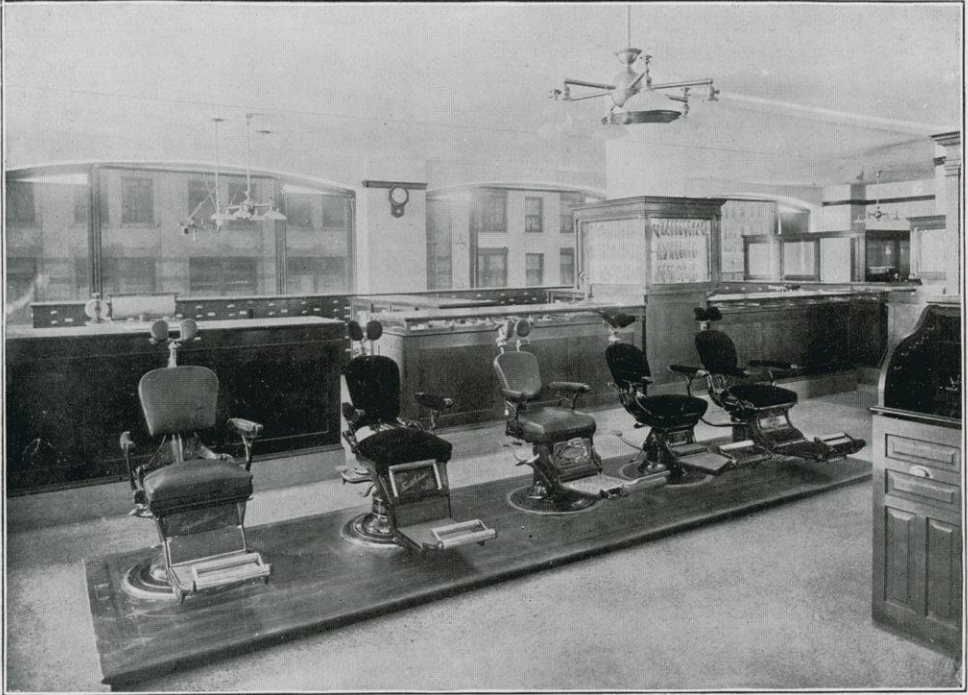

Jas. W. Edwards & Co., San Francisco



Jas. W. Edwards & Co., San Francisco

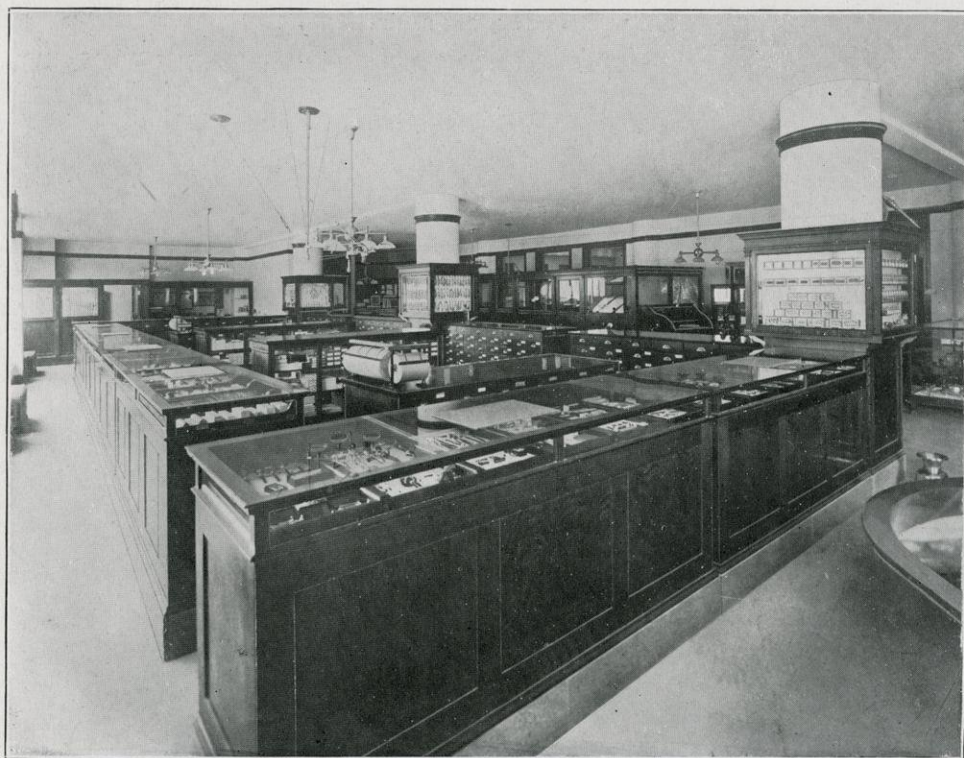

Jas. W. Edwards & Co., San Francisco



Jas. W. Edwards & Co., San Francisco

Remember that one of the first essentials of Cabinet making is the proper seasoning of the lumber. We carry from one to two years' supply in our yards at all times. It requires this out-of-doors seasoning to obtain good results, and in addition we have the most modern facilities for kiln drying it.

This is a point purchasers cannot see but it is very important and something every purchaser of Cabinet work should inquire about before placing order.

Ask us for prices when in need of anything in fixtures. Also remember we are in position to figure with you on anything in the line of woodwork. If you are using anything in the line of cases or boxes for marketing your product, such as crown trays, burr boxes, clamp boxes, etc., we solicit your inquiries.

The American Cabinet Co.

Main Office and Factory
Two Rivers, Wis.

Eastern Office and Warehouse
Rahway, N. J.

