



# LIBRARIES

UNIVERSITY OF WISCONSIN-MADISON

## **Bay Leaves & Lake Geneva Observer. Volume 8, No. 14 April 4, 1940**

Williams Bay, Wisconsin: Frank M. Van Epps, April 4, 1940

<https://digital.library.wisc.edu/1711.dl/7UOYYNUJPAMTM8M>

This material may be protected by copyright law (Title 17, US Code).

For information on re-use see:

<http://digital.library.wisc.edu/1711.dl/Copyright>

The libraries provide public access to a wide range of material, including online exhibits, digitized collections, archival finding aids, our catalog, online articles, and a growing range of materials in many media.

When possible, we provide rights information in catalog records, finding aids, and other metadata that accompanies collections or items. However, it is always the user's obligation to evaluate copyright and rights issues in light of their own use.



P.L.&R. 562  
Permit No.1  
Williams Bay, Wis.

# BAY LEAVES

VOL. VIII

NO. 14

& LAKE GENEVA OBSERVER

April 4, 1940

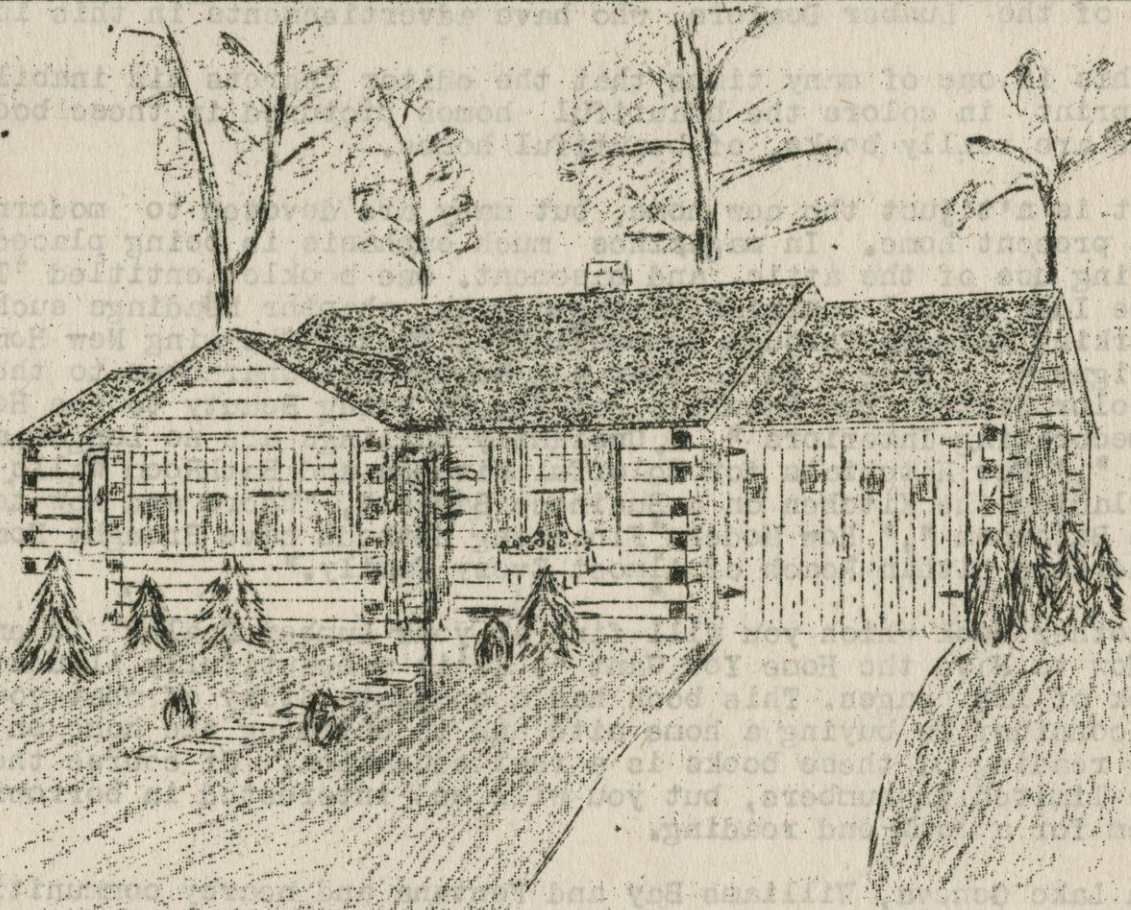

## HOME, SWEET HOME

'Mid pleasures and palaces though we may roam,  
Be it ever so humble, there's no place like home;  
A charm from the skies seems to hallow us there,  
Which, seek thro' the world, is never met with elsewhere.

Refrain. Home, home, sweet, sweet home.

I gaze on the moon as I tread the drear wild,  
And feel that my mother now thinks of her child,  
As she looks on that moon from our own cottage door,  
Thro' the woodbine, whose fragrance shall cheer me no more.

An exile from home splendor dazzles in vain;  
Oh, give me my lowly thatched cottage again;  
The birds singing gaily, that came at my call,  
Give me them, and that peace of mind dearer than all.



NO, THE LOG CABIN ON THE COVER IS NOT  
TAKEN FROM ANY PARTICULAR ONE  
ON LAKE GENEVA

This week and next week and possibly longer we are going to devote the pages of "Bay Leaves" to Homes and their furnishings and the gardens and lawns around them.

The sketch which you find on the cover is taken from one of the many beautiful books which I have before me which you can find at any of the Lumber Dealers who have advertisements in this issue.

This is one of many times that the editor regrets his inability to print in colors the beautiful homes pictured in these books, some are really books, of beautiful homes.

It is n't just the new home, but many are devoted to modernizing the present home. In magazines much emphasis is being placed on making use of the attic and basement. One booklet entitled "The Home Idea Book" contains 58 pages with chapter headings such as "Working Wonders Through Remodeling", "Twenty Charming New Home Designs", "Side Walls That Add Beauty and Character to the Home", "Color Sifted from Nature's Palette To Bring Beauty to the Home", "Decorating Interiors", "Unightly Ceilings are no Longer a Problem", "New Materials for Colorful Kitchen and Bathroom Walls", "Placing the Kitchen on a Business Basis", "Where and How to Plan The Bathroom", "How Modern Financing Methods have Brought Home Ownership within Reach of Almost Every Family."

Another book which you will find at your Lumber Dealer is entitled "How to Have the Home You Want". It is a beautifully illustrated book of 115 pages. This book has a complete story of what you need to consider in buying a home site and in building the home on it. The reading of these books is a real education. Of course these books are limited in numbers, but you will be interested in borrowing them for a week-end reading.

In Lake Geneva, Williams Bay and Fontana and nearby communities there are a great many of the finest artisans which you can find any where. A journey around the lake will convince you that today as in former days real carpenters and other workmen have built homes on the Lake.

If you are planning on building or remodeling, you will do well to consult with those who are telling of the wish to serve you in the pages of "Bay Leaves" in this issue and in those of the next few weeks.

From information received lately it augurs well for many new homes on the lake this Spring and Summer. It is rumored that some 10 houses are planned for Cedar Point Park alone, sounds like the days before the depression.

Two new homes are in the process of construction right now, both are on the lake shore in Cedar Point Park.

Frank M. Van Epps, Editor.



# EDWARD DUNN

LAKE GENEVA, WISCONSIN

Everything in the Building Line

JOHNS-MANSVILLE - CELOTEX - U. S. G.

TEL.

22

*Time To Clean Up  
and  
Paint Up!*

Dicadoo or Paint Cleaner

Devoc Velour Finish

For Wall or Wood

Devoc Mirrolac Enamel for  
Furniture

Devoc Floor and Deck  
Enamel or Devoc Varnish  
for Floor

Rent our sander to clean floors.

COBB HARDWARE CO.

PHONE NO. 6

LAKE GENEVA

Only the Best  
of

Workmanship

and

Materials in

PLUMBING & HEATING

A. G. LAWRIE

LAKE GENEVA

PHONE 21 Try us once!



## NEWS ITEMS

Selden Palmer Spencer and Miss Elizabeth Spencer, students at Lawrence College, Appleton, are spending their vacation from school this week with their mother, Mrs. Julia Spencer, Constance Blv'd.

Selden, a senior at Lawrence College, has been awarded the Phi Beta Kappa key, honorary scholastic fraternity, which is awarded to college students for high scholarship standing. His father was a Phi Beta Kappa as well as his grandfather, the late Judge Selden P. Spencer, brilliant St. Louis, Mo. jurist and United States Senator.

The Williams Bay Garden Club postponed their trip to the Garfield Park Conservatory on Wednesday this week on account of the funeral services for Carl Cable Bjorge.

Piehl & Piehl, builders, have the contract for a new home to be built in Cedar Point Park, Third Addition, costing \$8,000, for Mr. George Skrudland, Chicago.

Malsch, Lake Geneva, has the contract for building the new home on the lake shore near the Point in Cedar Point Park, for Mr. Joseph Klicka, River Forest, Ills., costing \$12,000.

A reception will be held at George Williams College, Chicago, next Sunday afternoon, April 7, 4:00 to 6:00 o'clock, in honor of Mr. and Mrs. Robert R. Vernon, in recognition of their many years of services to the college. Mr. Vernon has been appointed to the General Secretaryship of the St. Louis Y.M.C.A.

Nels Johnson, Chicago, spent the day, Sunday, at his lake shore home in the Bay. Mrs. Johnson will come to the Bay the last of April to open their home for the season.

Mr. and Mrs. Volmer Sorensen, Charles and Virginia, Madison, visited friends in Williams Bay last Sunday.

## ECLIPSE OF THE SUN TO BE VISIBLE NEXT SUNDAY

Don't complain if you suffer from a pain in the neck next Sunday, April 7, for on that day beginning at 2:31 p.m. and continuing until 5:06 p.m. will occur an annular eclipse of the sun, and if the weather is clear, you will not want to miss seeing it. This is an unusual type of solar eclipse, occurring when the moon is at its greatest distance from the earth, in which the sun appears as a circle of light surrounding the dark body of the moon. It means ring shaped. Its greatest magnitude at 3:53, about 62 per cent. Such an eclipse will not be witnessed again until 1994. Smoked glass or exposed picture film should be used to view the eclipse, or darkened outer edge of field glasses.

Mr. and Mrs. Henry Granzow left Wednesday for Waukesha where Mr. Granzow will take treatment at the spa.

Mrs. Z. Odalski, Chicago, was the guest of Mrs. Carl Ridell last week. Mrs. Odalski for a number of years was a summer resident of the Bay, her home being what is now the Nels Johnson lake shore property. in the Bay. She is still very fond of Williams Bay.

Mrs. H.A. Stark, Williams St., is in Chicago this week, shopping and visiting in the home of her son, Mr. and Mrs. H.R. Stark, Niles, Ill. and see her new granddaughter.

Mrs. Myron Piehl, Mrs. Carl Ridell and Mrs. Vosatka spent the day Monday in Milwaukee shopping.

Mrs. T.R. Thorsen, Oak Park, was the guest of Mr. and Mrs. Frank Fridlund and family, Fontana Road, last week.

Mrs. C.W. Kelly, mother of Mrs. F. Fridlund, is visiting friends in Clinton, Iowa.

Mrs. Helen Eoklund, son, Robert, and friends, Mr. and Mrs. Horace Thomas, Whitewater, were guests of Mr. and Mrs. Geo. Blakslee on Sunday





Major Feature

BROILERS

SPECIALS

SPINACH	14oz. boxes	19¢
RED RASPBERRIES	10-oz. "	19¢

### COFFEE-SUGAR

PURE CANE SUGAR	10-lb.sacks	57¢
POWDERED SUGAR	3-lbs.	22¢
SOFT BROWN SUGAR	" "	19¢
HILLS BROS COFFEE	2-lb.tins	51¢
ROUNDY'S SUPERIOR COFFEE	2-lb	49¢
G.and P.COFFEE	2-lbs.	45¢

### PICKLES-JAMS

BLK.RASP B.JAM(seedless)	2-lbs.	45¢
STRAWBERRY JAM	2-lb.jars	42¢
RICHELIEU MARMALADE	1-lb.jars	21¢
MIXED PICKLES	Qt.jars	27¢
BREAD & BUTTER PICKLES	15oz.	15¢

### COFFEE-SUGAR

LaGRANGE BUTTER	2-lbs.	65¢
LONG HORN CHEESE	perlb.	22¢
PHIL.CREAM CHEESE	2-3oz.foil	19¢
PABST-ETT	" 2-6½oz.pkgs.	35¢

HERSHEY'S COCOA	1-lb.tins	15¢
AMBROSIA CHOCOLATE	½-lb.bars	10¢
MARSHMALLOWS	1-lb.cello bags	14¢

CAMPBELL'S T.SOUP	3-10½oz.	25¢
-------------------	----------	-----

### FRESH MEAT

LEG of LAMB	per lb	29¢
VEAL SHOULDER	" "	24¢
POT ROASTS	" "	25¢
PORK LOINS	" "	17¢
" BUTTS	" "	16¢
" SAUSAGE(home made)"	" "	15¢
GENEROUS BACON	" "	19¢
HAMBURGER	" "	22¢
LARD (Wilson's)	2-lbs.	17¢

Fresh Fish on Friday.

# GRANZOW AND PETERSON

PHONE 196-W-1

April 5th. and 6th.

## QUALITY-FOOD-SHOP

\*\*\*\*\*

### CANNED FRUIT-VEG.

STANARD TOMATOES	3-20-oz.tins	25¢
CUT BEETS	" " " "	22¢
KIDNEY BEANS	2 " " "	19¢
LIMA BEANS	2 " " "	27¢
BLUE PLUMS	2-16 " "	23¢
RED RASPBERRIES	20-oz. "	26¢
SLICED PINEAPPLE	30-oz. "	23¢
ROUNDY'S PEARS	" " "	27¢

### FRUIT JUICES

ORG.& GRP.FRT.JUICE	2-18oz.	19¢
RDY'S TOMATO JUICE	2-24oz.tins	23¢
CARROT JUICE	2-10½-oz.tins	19¢
PINEAPPLE JUICE	46oz.tin	32¢
GRAPE FRUIT JUICE	2-46oz.tins	33¢

### CEREALS-FLOUR

PURASNOW FLOUR	24½-lb.sack	87¢
ROUNDY'S CAKE FLOUR	5-lb. "	28¢
WHEATIES	2-8oz.pkgs.	23¢
SHREDDED WHOLE WHEAT	2-12oz.	19¢

SODA CRACKERS	2-lb.pkg.	17¢
GRAHAM CRACKERS	" " "	19¢
CHOCOLATE COOKIES	2-lbs.	33¢

ROUNDY'S SALMON	1-lb.flat	31¢
CAL.SARDINES T.S.	2-15oz.tins	23¢
SWIFT'S CORN BEEF	12oz.tins	21¢
HORMEL'S SPAM	12oz.tins	29¢

AMERICAN FAMILY SOAP	5-bars	27¢
KITCHEN KLENSER	3-14oz.tins	19¢
CAMEO CLEANSER	" " "	25¢

KRAFT'S CHOC.M.MILK	1-lb.tins	31¢
RIPE OLIVES(large)	8½oz. "	22¢
ROUNDY'S DRESSING	25oz.jars	27¢

TEXAS GRAPE FRUIT(pink meat)	4-	25¢
" " " 64 size 5 for		27¢
" " " 96 " 7 for		25¢
CAL.ORANGES 288's	19¢ 200's	24¢Doz.
FLA " 216's	23¢Doz.	RADISHES-
3-bchs 10¢	DELICIOUS APPLES 4#	25¢
BANANAS(hard yellow)	3-lbs.	19¢



PHONE

198-3-1

GRANLOW

AND

April

5th

and

6th

PETERSON

QUALITY-FOOD-SHOP

## CANNED FRUIT-VEG.

STANDARD TOMATOES	3-20-oz. cans	25¢
CUT BEETS	" " "	25¢
KIDNEY BEANS	2 " "	15¢
LIMA BEANS	2 " "	25¢
BLUE PLUMS	2-16 " "	25¢
RED RASPBERRIES	20-oz. "	25¢
SLICED PINEAPPLE	30-oz. "	25¢
ROUNDY'S PEARS	" " "	25¢

## FRUIT JUICES

ORG. & GRP. FRUIT JUICE	2-16oz.	15¢
RDY'S TOMATO JUICE	2-24oz. cans	25¢
CARROT JUICE	2-10oz. cans	15¢
PINEAPPLE JUICE	4oz. can	25¢
GRAPE FRUIT JUICE	2-46oz. cans	25¢

## CEREALS-FLOUR

PURASNOW FLOUR	244-1lb. sack	25¢
ROUNDY'S CAKE FLOUR	2-16 " "	25¢
WHEATIES	2-8oz. pkgs.	25¢
SHREDDED WHOLE WHEAT	2-12oz. "	15¢

SODA CRACKERS	2-16 pkgs.	15¢
GRAHAM CRACKERS	" " "	15¢
CHOCOLATE COOKIES	2-16 " "	25¢

ROUNDY'S SALMON	1-16 fl. oz.	25¢
CAL. SARDINES	2-2-15oz. cans	25¢
SWIFT'S CORN BEET	12oz. cans	25¢
HORNEL'S SPAM	12oz. cans	25¢

AMERICAN FAMILY SOAP	2-16oz. bars	25¢
KITCHEN KLEENER	2-14oz. cans	15¢
CAMEO CLEANSER	" " "	25¢

HEART'S CHOIC. MILK	1-16 fl. oz.	25¢
RIPE OLIVES	(large) 25oz. jars	25¢
ROUNDY'S DRESSING	25oz. jars	25¢

TEXAS GRAPE FRUIT (pink meat)	4-25¢
" " " " " " " "	25¢
" " " " " " " "	25¢
CAL. ORANGES 288's 125 200's 24oz. cans	25¢
FLA. " " " " " " " "	25¢
2-pkgs. 100 DELICIOUS APPLES 4-15¢	15¢
BANANAS (hard yellow) 2-16 " "	15¢

SAVE TIME!  
SAVE MONEY!

SERVE

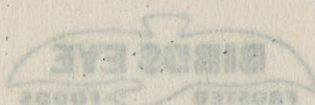

Major Feature

BROILERS

## SPECIALS

SPINACH	14oz. boxes	15¢
RED RASPBERRIES	10-oz. "	15¢

## COFFEE-SUGAR

PURE CANE SUGAR	10-16 sacks	25¢
POWDERED SUGAR	3-16 " "	25¢
SOFT BROWN SUGAR	" " "	15¢
HILL'S BROS. COFFEE	2-16 fl. oz.	25¢
ROUNDY'S SUPERIOR COFFEE	2-16 " "	45¢
G. and P. COFFEE	2-16 " "	45¢

## PICKLES-JAMS

BLK. RASP. B. JAM (seedless)	2-16 " "	45¢
STRAWBERRY JAM	2-16 jars	45¢
RICHIELEU MARMALADE	1-16 jars	25¢
MIXED PICKLES	2-16 jars	25¢
BREAD & BUTTER PICKLES	15oz. "	15¢

## COFFEE-SUGAR

LAGRANGE BUTTER	2-16 " "	25¢
LONG HORN CHEESE	per lb.	25¢
PHIL. CREAM CHEESE	2-3oz. foil	15¢
PASST-ETT	2-8oz. pkgs.	25¢

HERSHEY'S COCOA	1-16 fl. oz.	15¢
AMBROSIA CHOCOLATE	2-16 bars	10¢
MARSHMALLOW	1-16, cello bags	15¢

CAMPBELL'S T. SOUP	3-10oz. "	25¢
--------------------	-----------	-----

## FRESH MEAT

LEG OF LAMB	per lb.	25¢
VEAL SHOULDER	" "	25¢
POT ROASTS	" "	25¢
PORK LOINS	" "	15¢
BUTTS	" "	15¢
SAUSAGE (home made)	" "	15¢
GENEROUS BACON	" "	15¢
HAMBURGER	" "	25¢
LARD (Wilson's)	2-16 " "	15¢
Fresh Fish on Friday		



We appreciate the confidence that you have placed in us in electing us to the offices of trust in the Village of Williams Bay.

We will endeavor to carry on the duties of our respective offices to the best of our abilities.

We thank you.

During the first ten years of the Village of Williams Bay, Inc. the emphasis was placed on growth and home building. During that time the population of the Village grew from 420 to 630. During the last ten years the village passed through an improvement era, with installation of the water and sewage systems to care for that increased growth.

In the decade ahead of us the tendency is again for growth. The emphasis will be placed on beautification of our village, its lake shore, its streets, etc.

We will do whatever we can to help make Williams Bay not only a bigger, but a better place for home builders.

John E. Atkins,  
Village President

Harry Breen

O.B. Fensholt

Harold Pierce

Trustees

Frank M. Van Epps

Village Clerk

Edward H. Hollister  
Village Treasurer

Albert T. Anderson  
Assessor

Arthur C. Ohl  
Constable

Victor Hansen  
Supervisor



ERIC J. WERNER  
GENERAL  
CONTRACTOR  
&  
HOME BUILDER

WILLIAMS BAY, WIS.  
TEL. 1267 R3

WILLIAMS BAY  
LAUNDRY

EDWIN HOLM

PROPRIETOR

A Complete

Laundry Service

TEL. 1253 R1

FOR RELIABLE  
SERVICE  
IT'S

JOHNSON'S

GENERAL TRUCKING

SAND • GRAVEL •

BLACK SOIL

ROAD BUILDING

PHONE 1202 J1

WILLIAMS BAY

B. W. CHRISTIAN  
& CO.

DELAVAN • WILLIAMS BAY

SHOW ROOM IN  
DELAVAN

HEATING • PLUMBING

BENDIX HOME LAUNDRY

NORGE REFRIGERATORS

AUTOMATIC PUMPING

AND WATER SYSTEMS

WILLIAMS BAY OFFICE

130 N. WALWORTH AV.

TEL. 360 W3



# ANNOUNCING REDUCTIONS IN COMMERCIAL ELECTRIC RATES

We are pleased to announce important reductions in rates to commercial lighting and small power customers.

Detailed information on the extent of the reduction for various amounts of service used, will be furnished to customers affected, and to others if desired. The new rates have been approved by the Public Service Commission, and become effective for all service used after the April meter readings.

Downward rate adjustments for any class of customer indirectly benefits all classes. While merchants and business houses directly benefit from this particular reduction, all citizens benefit from it indirectly. "What helps business helps everybody."

This marks another step in our general rate reduction program which has included and will continue to include reductions as fast as possible to all classes of customers- residential, commercial, industrial, and municipal.

We appreciate that our first obligation to the public is to render the best in service. The most important thing is service. We derive great satisfaction from every forward step taken in the raising of service standards.

But to us the really bright spots on our highway of progress are those times when we can announce rate reductions- rate reductions regardless of the obstacles of increased taxes, increasing operating costs, and necessary increased investment for improvement in service or safety to employees and public.

We like to make rate reduction announcements like this one. The oftener we can do it, the better we like it.

## WISCONSIN POWER AND LIGHT COMPANY

JAS. G. ALLEN  
MANAGER

LAKE GENEVA



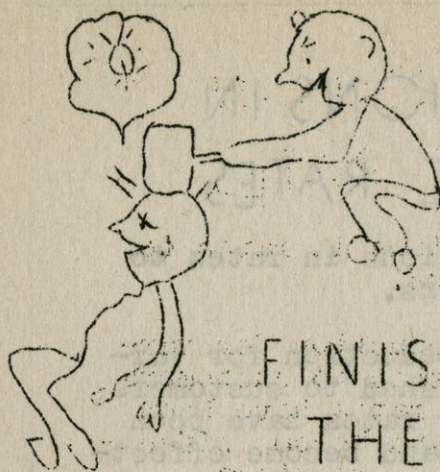

## FINISH THE JOB

While you're cleaning house, don't stop with the floors and walls -- look over your plumbing and renew those things that are worn and unsightly.

Maybe the closet seat is chipped and splintered, if so it is high time for a new one.

Or the Kitchen needs a new modern acid resisting porcelain enameled sink with a swing sput faucet, and enameled steel cabinet, which will save you many steps and add greatly to your leisure time.

Call us, we will be glad to help you plan new plumbing or to modernize the old ..... Our work will please you and our prices are low.

Modernize now !

CALL TEL NO 117  
**W. J. HOOKER**  
PLUMBING &  
HEATING  
SUBURBAN WATER SYSTEMS  
WATER SOFTENERS.  
STOKERS. OIL BURNERS  
923 HENRY ST. LAKE GENEVA

## MOVIES THIS WEEK

### GENEVA THEATRE

Thurs., April 3 -  
"BLACK FRIDAY" Boris Karloff  
and Bela Lugosi also  
"HOUSE OF SEVEN GABLES"

Fri., - Sat. April 5-6  
"VIGIL IN THE NIGHT"  
Carole Lombard, Brian Aherne  
Anne Shirley, also  
Kiddie Show and Dick Tracy's G-Men  
Saturday 1:30

Sun. Mon. Tues. April 7, 8, 9  
"THE GRAPES OF WRATH"

WED. Thurs. April 10-11  
"IT A:: CAME TRUE" Ann Sheridan  
Jeffrey Lynn also  
"FLORIANA" with Robert Young  
and Helen Gilbert.

### THE SPRAGUE

Thurs. Fri. April 4-5  
"THE FIGHTING 69TH"  
Jas. Cagney, Pat O'Brien

SATURDAY April 6  
"BLAZING SIX SHOOTERS"  
Chas. Starrett, Iris Meredith.  
Also "OLD HICKORY" Historical  
Technicolor Featurette and Our  
Gang.

Sun. Mon. Tues. Apr. 7, 8, 9  
"VIRGINIA CITY"  
Errol Flynn, Miriam Hopkins.  
Historical Melodrama, bigger and  
better than Dodge City.

Wed. Thurs. April 10-11  
"BARRICADE" Alice Faye, Warner  
Baxter, Charles Winniger.  
Adventure story in China.

### DELAVAL THEATRE

Thurs. April 4 - "Swiss Family  
ROBINSON"

Fri. Sat. Apr. 5, 6  
"BLACK FRIDAY" also "HOUSE  
OF SEVEN GABLES"

SUN. Mon. Apr. 7-8  
Mickey Rooney as "Young TOM  
Edison. T.W.T. "The LIGHT That  
FAILED"



TAGGART LUMBER CO.

LAKE GENEVA, WIS.

BUILDING HEADQUARTERS

CURTIS MILLWORK

RUBBER- OIL ASPHALT PRODUCTS

U. S. GYPSUM CO. PLASTER & WALLBOARD

BENJAMIN MOORE & CO. PAINTS

TEL. 319

M<sup>c</sup>CLELLAN &

SHERMAN

LAKE GENEVA

TEL. 484

ELECTRIC SHOP

ELECTRICAL

CONTRACTORS

"Everything

Electrical"

GEO. F. CURRAN

CONTRACTOR

AND

BUILDER

LAKE GENEVA, WIS.

TEL. 653

HOME BUILDER

REMODELING

ROOFING

SCREENS



## WILLIAMS BAY CASTS LARGEST VOTE

For the first time over 400 votes were cast in Williams Bay- the number was 407. As announced in "Bay Leaves " there are possible 480 plus voters.

The closest contest was for the office of Treasurer when at first the vote was tied at 200 each for Phil Fogle and Ed. Hollister. Upon recounting the ballots the tally was 201 for Hollister and 199 for Fogle.

In the race for members of the Board of Trustees Harold Pierce received the highest number of votes- 329; Breen second with 309 and Fensholt 210, for the 3rd member.

The votes were cast as follows:

### For Village President:

John E. Atkins	255.*
Eric J. Werner	142

### For Trustees

Harry Breen	309*
O.B. Fensholt	209*
Stanley Johnson	135
Harold Pierce	329*
Frank J. Vavra	196*

### For Village Clerk

Frank M. Van Epps	351*
-------------------	------

### For Village Treasurer

Philip J. Fogle	199
Edward H. Hollister	201*

### For Assessor

Albert T. Anderson	360*
--------------------	------

### For Constable

Arthur C. Ohl	259*
Alfred Johnson, Jr.	139

### For Supervisor

Victor Hansen	238*
Roy Johnson	160

### For Judge of Circuit Court

Alfred L. Drury	295
Edward J. Ruetz	65

For Repeal of Teacher's Tenure Law  
221 .Against 91

## HOW WILLIAMS BAY VOTED ON THE PRESIDENTIAL QUESTION.

One hundred six voters took the trouble to write in the name of Thomas E. Dewey - the highest no. of votes for an elector on the Republican ticket was 190, which was voted for Zimmerman who was pledged for Dewey. The highest for Vandenberg was 66.

In the First District William A. Sheldon George R. Cady, Dewey Pledged had 168 and 128 votes.

On the Democratic Delegate Ballot with the names printed in; 79 votes were cast for Roosevelt and 28 for Garner.

The highest number of votes for Roosevelt delegates was 50

Therefore on the basis of delegates ballots, Williams Bay voted Republican about 4 to 1.

## VERY INTERESTING MEETING FOR MEN'S COMMUNITY CLUB.

The men of the Village learned a lot about running a railroad from G.W. Carnell of Racine who was sent to represent the Chicago & Northwestern Ry.

Mr. Carnell who is Traveling Representative for the Galena and Kenosha Divisions has a very pleasing personality and a frank way of putting all the cards on the table.

Better train service was discussed and we hope that our round table conference will bring results in several respects.

Though more trains cannot be expected we can hope for cleaner coaches and screened windows, etc.

52 were present. In the opening prayer M.T. Peterson gave recognition of Carl Cable Bjorge who was a guest of the Club one month ago as a member of the Basket Ball Team.



AT A SACRIFICE

15 BRAND NEW AIR CONDITIONED

ICE REFRIGERATORS, "COOLERATORS"

5 1/2 CU. FT. CAPACITY

REGULAR PRICE \$79.50

*While they last only \$42<sup>50</sup>*

AMEROSE BROS.

ICE & COAL CO.

CALL AT THE PLANT

ELKHORN RD. WILLIAMS BAY

TEL. 196 J 3

ANDERSON BROS.

GENERAL CONTRACTORS

AND BUILDERS OF  
FINE HOMES

Albert T. Anderson

TEL. 1267 J 2

Carl E. Anderson

TEL. 1259 J 3

WILLIAMS BAY, WIS.

HARRY BREEN

PLUMBING &

HEATING

WILLIAMS BAY

1541 W. GENEVA ST

TEL. 1259 J 2



## CONG'L CHURCH CHOIR CONCERT ENJOYED BY MANY

One of the most delightful musical evenings in Williams Bay was spent last Thursday evening by those attending the concert given by the choir of the Congregational church.

The choir, directed by Naomi E. Roeker, who has been their leader since last fall, presented the following program—  
Chorus, "Invitation to Ammon"—Bizet  
Kashmiri Song, Finden-Salter;

Choir

'Cello— "Elegie"— Faure—Schroeder

"Chanson Villagerise" Popper

Elizabeth Webb— Cellist

Tenor Solo— "Lovely Spring"—Coenen

D.J. Oetjen

Women's Trio—

"The Shadow March"—Protheroe

"Rain"— Curran

Women of the Choir

Chorus— "The Green Cathedral"—Hahn

The Choir

'Cello—

"Cavotte"

Popper

"Orientale"

Cui

Elizabeth Webb

Piano—

"Rhapsodie" No. 14" Liszt

Chorus—

"Bridal Chorus from Rose Maiden

The Choir

The women's choruses were particularly enjoyed, and was the groups' first appearance.

Elizabeth Webb, cello soloist, proved herself to be a musician of much ability in her solo numbers. This is a beautifully sounding instrument when well played. Mrs. Webb is a member of the faculty of the Webb School of Music, Elkhorn.

Mrs. Roeker received her B.M. degree from the University of Pittsburgh, and did advanced study in music at Pittsburgh Music Institute.

She displayed much skill and splendid technique in her rendition of Liszt's difficult "Rhapsodie No. 14."

Mrs. Roeker and the choir greatly appreciate the patronage and generous support of the many who attended the concert, and otherwise contributed to make it a success.

## WISCONSIN DRAMA GUILD AWARDS

The Wisconsin Dramatic Guild, a federation of Little Theatre, community, school and church players organizations, at their in Madison last week, elected Mrs. Esther Higgins Hotton, Wms Bay, president of the Guild for another year.

The Belfry Players, Williams Bay, directed by Mrs. Hotton, won excellent rating for their presentation of "Twentieth Century Lullaby", on Saturday afternoon.

Vera Vosatka, a member of the cast in the play presented by the Belfry Players, was named as an outstanding player, was judged the best actress in the urban group. The Belfry Players won first place for excellent performance in the urban group.

## VOICE PUPILS OF PAUL McMANS IN RECITAL

On Sunday afternoon, April 7, at 4 o'clock, in the College Auditorium in Whitewater, four students from the voice studios of Paul McMans will give a recital. The public is most cordially invited to attend without charge. The students appearing are— Fern Frohmader, dramatic soprano, who will sing "Die Erlkoenig" by Schubert; "Star" by Rogers; "One Fine Day" from "Madam Butterfly"—Puccini; and "Still wie die Nacht"—Bohm.

Mary Nasot, colorature soprano, of Watertown, will sing— "Il Bacio" by Arditi; "Clavelitos" (Spanish folk song); "A Heart That's Free" by Robyn; "Annie Laurie", and "Hymn to the Sun", from Le Coq d'or by Korsakow.

Robert Kaemflein, Janesville, tenor, will sing, "Where Ere You Walk", by Handel; "Morning" by Speaks; and "Mah Lindy Lou" by Strickland. Paul Tyvand, baritone, of the college, will sing—"Hear Ye Winds and Waves", Handel; "Lost in London Town", Mitchell; and "Friend of Mine" by Sanderson.

The singers will be assisted by duo-pianists, Winifred Cobb and Dorothy Sayre.



FOR SAND

GRAVEL

FILLING AND

TOP SOIL

PHONE

1201 R 1

DONALD

KRAUSE

ICE DELIVERY

TRUCKING

WILLIAMS BAY

Building ?

Remodeling ?

Repairing ?

We'll take care

of the

WIRING

BAY ELECTRIC SHOP

PHONE 1201 R 4

A. J. MUNDSCHAU, WMS BAY  
CONTRACTOR • DEALER

## CHURCHES

### GOSPEL TABERNACLE

Morning Worship -	10:30
Sunday School	11:30
Young Peoples	7:00
Evening Service	8:00

Dr. A.L. Tedoll, Professor at  
Free Church Bible School, Chicago  
will preach both morning and  
evening.

Ladies Aid- April 11 Mrs. Edwin  
Holm, Hostess.

### CONGREGATIONAL CHURCH

Rev. Eric H. Arendt, Pastor

Church School	9:30
Morning Worship	10:45

St. Benedicts Catholic Church  
Fontana

Sunday 9:A.M.

LAKE

GENEVA

SAND &

GRAVEL

CO.

FONTANA

SAND AND GRAVEL

FOR ALL PURPOSES

SPECIFY OUR PRODUCTS.

ASK YOUR LOCAL HAULING  
CONTRACTOR.



REGIONAL HIGH SCHOOL BASEBALL  
SEASON OPENS APRIL 19

with all six teams playing, reports Coach Robert Cook of the Williams Bay school, league secretary of the Southern Regional conference. Walworth has been added to the schedule as a non-conference participant.

Most of the games are scheduled for Tuesdays and Fridays, all games starting at 3:30. Genoa City was the conference champion last year. Schools in the Southern Regional group are- Capron, Ill., Darien, Sharon, Williams Bay, and Walworth.

The first games in the schedule will be played on Friday, April 19, as follows- Darien at Capron; Sharon at Genoa City; Williams Bay at Walworth.

WALWORTH COUNTY BRANCH A.A.U.W.

held a luncheon meeting at the Delavan Congregational church, last Saturday, March 30. Guest speaker was Dr. Harold Whitehall, of the University of Wisconsin, who spoke on "America's Language-Why We Speak As We Do". Dr. Whitehall is a native of England, and is a distinguished authority on languages and the history of the English language.

Williams Bay A.A.U.W. members who attended the luncheon meeting were Mmes J.S. Hotton, L. Henry, Jess Greenstein, Wm Morgan, Gerard Kuiper and S. Chandrasekhar.

FROM A GOOD BOOSTER FOR BAY LEAVES  
-OBSERVER

Congress Park, Ill.,  
March 30-1940

"Enclosed find check for which please enter my subscription for another year, to BAY LEAVES-OBSERVER. I enjoyed everyone of the of the copies last year and feel that I know everyone of the residents personally thru reading your wonderful paper. The extra amount enclosed will help defray postage expense."

Yours truly  
W.H. Berg.

Mr. Berg owns property in Oakwood Estates.

WILLIAMS BAY YOUTH DIES OF INJURIES  
RECEIVED IN AUTO ACCIDENT

The remains of Carl Cable Bjorge, who died at six o'clock Sunday evening, in the Huey Long hospital, Pineville, La., from injuries received in an automobile accident on March 20, while on a vacation trip, were brought to Williams Bay on Tuesday morning. Mr. and Mrs. Bjorge and Mrs. G. Van Biesbroeck, who have been in Pineville since word of the accident was received, accompanied the body home to Williams Bay.

Carl Cable, son of Mr. and Mrs. Carl M. Bjorge, and their only child, was born in Williams Bay on April 7, 1923, and would have been seventeen years old on next Sunday.

He was a Senior in the Williams Bay High School. A member of the high school basketball team and baseball team, and was leader of the high school orchestra in his Sophomore year, he being an accomplished pianist.

Carl Cable united with the Congregational church Palm Sunday, the day before he and a group of high school companions went to New Orleans.

He was an excellent student, ranking a high average in a state educational test in his sophomore year conducted throughout the high schools in Wisconsin. The flag at the school was at half mast this week. He spent three months last year traveling in Europe.

Funeral services were held at 2 P.M. Wednesday from the Lackey, Little 'Brion Funeral Home in Delavan. ~~Jean Radabaugh sang a hymn, "Still, Still with Thee."~~ Rev. Eric H. Arendt, pastor of the Williams Bay Congregational church conducted the service. Burial was in East Delavan cemetery. Pall bearers were his high school companions, Dick Spencer, Marlan Krebs, Edwin Van Biesbroeck, William Elbert, Jr., Robert Hess, Allan Forsberg.

Supt. of Schools Kenneth Viste and Mrs. Viste were at Madison last Friday for the principals conference.



DR.STRUVE RELATED HIS EXPERIENCES AS AN OFFICER IN WHITE ARMY OF RUSSIA.

At the Men's Brotherhood of the Williams Bay Congregational Church last night, Dr. Otto Struve told 42 men in attendance the very interesting story of his early days in Russia during the World War, then the Civil War, when he was an officer in the White Army and then of Dr. Frost's letter asking him to come here to Yerkes Observatory as his assistant.

Interest in the Brotherhood is increasing every meeting. At the next meeting there will be an old fashioned "Box Social", with the men furnishing the baskets and the ladies doing the buying.

#### MEL SPENCE GETTING ALONG NICELY AFTER SEVERE OPERATION.

Last Friday night Mel was taken severely ill and was rushed to Walworth Co. Hospital where he was operated on early Saturday morning. A blood transfusion was given Sunday morning.

As planned by Mel the work of remodeling is going on. The dining room is being redecorated and the lounge is undergoing quite extensive improvements.

Mr. Spence's father is visiting here from Canada.

#### ELECTION IN NEARBY COMMUNITIES

In spite of a strenuous campaign against them Fontana president Harold Foote and Clerk Quinn retain their offices. Others were all re-elected except Clude Long who is succeeded by Ernest Nobis as Constable.

Walter Ledger was opposed by Evalyn Mahoney who got 337 votes to his 893. Other officers were re-elected also.

There were no changes in the Towns of Linn and Walworth bordering the Lake Geneva.

#### LADIES AID SOCIETY

of the Gospel Tabernacle will meet with Mrs. Edwin Holm, Walworth and Congress Sts., next Thursday, April 11, at 2:30. Mrs. Emanuel Peterson will be co-hostess.

#### ENTERTAINS FOR BIRTHDAYS FOR OCTOGENARIANS

Mrs. Amy Jorgenson entertained a group of ladies at Rose Lane this afternoon (Thursday) in honor of Mrs. Louise Rockenfeller and Mrs. Charles Slocumb for their birthdays. The ladies are both over four score years. Mrs. Rockenfeller is still very active. Mrs. Slocumb has not been in very good health the past year.

#### GIVES TEA FOR MRS. STANLEY JOHNSON

Mrs. Henry Reynolds of Hotel Normandie, was hostess this afternoon at a tea in honor of Mrs. Stanley Johnson.

Mr. and Mrs. Jack Hansen, Chicago, are the parents of a son, Jack Marquette Hansen, born March 26. Mrs. Hansen was Ruby Nelson before her marriage.

Mr. Chris Sockel, from Brainard, Minn., who is visiting his daughter, Mrs. Carlquist in Lake Geneva, was the guest of Eric Anderson on Thursday and visited the Yerkes Observatory.

Miss Florence Boyd, Lake Geneva, celebrated her 76th birthday Monday, April 1. Miss Boyd has lived her entire life in the home where she born, located at Boyd's Corner, Lynn Township. Her father and mother came to this vicinity nearly 100 years ago from the East. She is a member of the Lake Geneva Historical Society, Woman's Club and Lynn Neighborly Club, in which she takes active part.

#### NEXT WEEK MANY ADVERTISEMENTS ALREADY IN WILL BE PRINTED.

Send in your ad. for the next few issues. We give full coverage to our summer friends as well as local readers.

--- " HOME NUMBER " continued next week ---



SPECIALS

# FISH LINE STORE

FRIDAY  
APR. 5

TEL. 819 W1

SATURDAY  
APR. 6

PURE CANE SUGAR 10 lb Cloth Bag- 57¢	FRESH FROZEN STRAWBERRIES 16 oz Pkg-no sugar- 23¢	HILLS BROS. COFFEE 2 lb Can- 51¢ 1 lb Can- 26¢
GRANULATED SUGAR 10 lb Cloth Bag- 54¢	FRESH FROZEN RASPBERRIES 16 oz Pkg-no sugar- 23¢	BLISS COFFEE 2- 1# Cans- 45¢
SWIFT'S BROOKFIELD BUTTER- 2-1# Pkgs-63¢	Selected FRESH FROZEN PEAS- 12 oz Pkg- 19¢	STRICTLY FRESH EGGS pr Dozen- 17¢
SWIFTS SILVERLEAF LARD-3- 1# Pkgs- 25¢	Selected Fresh Frozen CORN- 12 oz Pkg- 19¢	SWANSDOWN CAKE FLOUR per lb 23¢
QUAKER PUFFED WHEAT 3 Pkg's- 20¢	GREEN or WAX BEANS 2- 10 oz Pkg's- 35¢	BLUE LABEL KARO per lb Can 29¢
CORN FLAKES or SHREDDED WHEAT 2 Pkg's- 19¢	SPINACH 14 oz Pkg- 20¢	ROSEMARY MAPLE SYRUP 2- 22 oz Jars- 35¢
LIBBY WHOLE KERNEL GOLDEN BANTAM 3- 20 oz Cans- 32¢	FRESH SMELT 3 lbs- 23¢	LIBBY'S TOMATO JUICE 2- 50 oz Cans- 43¢ 4- 14 oz Cans- 35¢
LIBBYS GRAPE FRUIT 2- 20 oz Cans- 25¢	WE HAVE FROZEN FISH ALL KINDS	LIBBYS GREEN & WAX BEANS 2- 20 oz Cans- 29¢
PEERLESS PAPER NAPKINS 3- 100 Ct Pkg's- 25¢	GENEROUS SLICED BACON per lb 21¢	SEEDLESS RAISINS 2 lb Pkg- 15¢
EDUCATOR CRAX 2 Pkg's- 25¢	HAM SHANKS- per lb- 15¢	CALUMET BAKING POWDER 1 lb Can- 20¢
RINSO (large) 2 Pkg's- 39¢	SPARE RIBS- pr lb- 11¢	JOHNSTON CRACKERS 2 lbs GRAHAM- 19¢ 2 lbs SODA - 17¢
AMERICAN FAMILY SOAP 5 Bars- 27¢	PORK LOIN ENDS-3# average- per lb 16¢	JOHNSTON COOKIE SPECIAL ALMOND PATTIES-1#-15¢ CHOCOLATE CREME-1#-15¢
P & G SOAP 5 Bars- 19¢	ROSEMARY MILK 4- 14 oz Cans- 25¢	
STANDARD TOMATOES 3- 20 oz Cans- 25¢	POT ROAST per lb 24¢	LONGHORN or BRICK CHEESE pr lb- 21¢
FIFTH AVE CORN 3- 20 oz Cans- 25¢		KRAFT AMERICAN 2 lb Loaf- 49¢
BANANAS- 3 lbs- 20¢	TEXAS ORANGES- Doz- 23¢	IDAHO POTATOES pr Peck- 43¢
GRAPEFRUIT- 6 or 9 for 25¢	CALIFORNIA ORANGES 30¢ or 35¢ DOZEN	WISCONSIN POTATOES per Peck- 27¢
PINK GRAPEFRUIT 4 for 25¢		