



LIBRARIES

UNIVERSITY OF WISCONSIN-MADISON

Site 4108: Fond du Lac County Park Low Woods, Fond du Lac County, Township 14N, Range 15E, Section 31. 1953-10-11

[s.l.]: [s.n.], 1953-10-11

<https://digital.library.wisc.edu/1711.dl/LNSLJSN5X3F5O8I>

This material may be protected by copyright law (Title 17, US Code).

For information on re-use see:

<http://digital.library.wisc.edu/1711.dl/Copyright>

The libraries provide public access to a wide range of material, including online exhibits, digitized collections, archival finding aids, our catalog, online articles, and a growing range of materials in many media.

When possible, we provide rights information in catalog records, finding aids, and other metadata that accompanies collections or items. However, it is always the user's obligation to evaluate copyright and rights issues in light of their own use.

STAND RECORD

FORESTS

Stand No. 4108

Name: Fond du Lac County Park Low Woods Locality: NE: NW
 County: Fond du Lac T: 14N R: 15E Sec: 31
 Date: Oct. 11, 1953 Observers: Ware
 Size of Stand: 97. A Size of Area Sampled: 10 A
 Forest Type: Bottomland Hardwood Soil Type:
 Topography: Low, generally level Slope: Directions

Condition of Stand:

Reported to be almost completely undisturbed, man.
 Sedge occupied depressions rather common. Holes
 in canopy throughout woods. Many fallen trees
 from wind storm in Aug. 1953.

Open Grown Trees:

85 % Canopy:

Stumps:

1.	4.	7.	10.
2.	5.	8.	11.
3.	6.	9.	12.

Soil Data:

	pH	N	P	K	Ca	Mg	Org. Mat.	Colloids	W.H.C.
A ₀									
A ₁									
A ₂									
B									

DEPTH

CHARACTERISTICS (Color, Texture, Structure, etc.)

A ₀	1/2 - 1"	Freshly fallen leaves
A ₁	2-6"	Deep rich black loam
A ₂	2-4"	Black loam
B	2-4"	Dark brown clay loam

Parent Material: Glacial till. Boulders visible occasionally

Map:

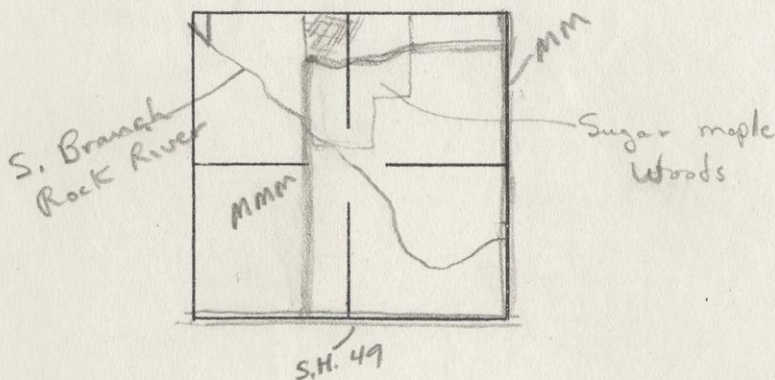

1-10

STATION NO.	1	2	3	4	5	6	7	8	9	10		
Acer negundo												
A. saccharinum												
A. saccharum												
Betula nigra												
Carya cordiformis												
Celtis occident.												
Crataegus sp.												
Fraxinus americ.						170						
F. nigra			29	65	2			22				
F. pensylvanica												
Gleditsia triacan.												
Gymnocladus dioica												
Juglans cinerea				1	15							
Ostrya Platanus occident.					15	4	3	35	7	21	50	3
Populus deltoides												
P. tremuloides												
Prunus serotina				1								
Quercus bicolor												
Q. rubra			640						520		140	390
Robinia pseudo.												
Salix nigra												
Tilia americana	26		170	2	50	50	320	100				
Ulmus americana	25	4	29	1		3				3		
U. rubra												4
<i>Quercus alba</i>							290					
Distance	28	13	28	25	17	50	24	22	18	23		

STATION NO.	1	2	3	4	5	6	7	8	9	10
Acer negundo										
A. saccharinum										
A. saccharum										
Betula nigra										
Carya cordiformis		4	4					1	1	
Celtis occident.										
Crataegus sp.	3									
Fraxinus americ.		75			4	1		330		
F. nigra										
F. pennsylvanica	290									
Gleditsia triacan.										
Gymnocladus dioica										
Juglans cinerea										
Q. strob. Platanus occident.								12 13	3	18 3
Populus deltoides										
P. tremuloides										
Prunus serotina				1						
Quercus bicolor										
Q. rubra	460			640 270	500					
Robinia pseudo.										
Salix nigra										
Tilia americana		230	500			140 120 80 40 20	1	130		160 1
Ulmus americana				3	220		1	180	1	
U. rubra			150					222		
Distance	40	26	22	23	38	27	27	14	13	27

11-20

21-30

STATION NO.	1	2	3	4	5	6	7	8	9	10
Acer negundo										
A. saccharinum										
A. saccharum										
Betula nigra										
Carya cordiformis									110	
Celtis occident.										
Crataegus sp.						1	118			
Fraxinus americ.										
F. nigra		3		1						
F. pennsylvanica										
Gleditsia triacan.										
Gymnocladus dioica										
Juglans cinerea										
Platanus occident.										
Populus deltoides										
P. tremuloides										
Prunus serotina		1							2	
Quercus bicolor	760									
Q. rubra				210	180			120		
Robinia pseudo.										
Salix nigra										
Tilia americana		290 12	330 35			110 50 120	260 190		50	
Ulmus americana	140 25		500							25 20
U. rubra			4	3	4	3		4	11	
Quercus alba				220	600					
Populus grand							3			
Distance	14	24	17	29	33	29	24	15	19	23

STATION NO.	1	2	3	4	5	6	7	8	9	10
Acer negundo										
A. saccharinum										
A. saccharum										
Betula nigra										
Carya cordiformis									1	
Celtis occidental.										
Crataegus sp.										
Fraxinus americ.									60	
F. nigra						45				
F. pennsylvanica										
Gleditsia triacan.										
Gymnocladus dioica										
Juglans cinerea										
Platanus Platanus occident.		40								16
Populus deltoides										
P. tremuloides										
Prunus serotina			4							2
Quercus bicolor	50			800						
Q. rubra									170	
Robinia pseudo.										
Salix nigra										
Tilia americana	180 150		116 100 50				230			
Ulmus americana		95		20	35					
U. rubra	3					2	190	4		110
<i>Quercus alba</i>					640					
Distance	38	17	46	29	42	35	25	25	45	12

31-40

Presence List
(Uncommon species)

FLOOD-PLAIN HARDWOODS

Stand No. 4108
Quadrat No.

PRESENCE

Acorus calamus
Actaea pachypoda
Actaea rubra
Agastache scrophulariaefolia
Agropyron trachycaulum
Alisma subcordatum
Alnus incana
Alnus rugosa
Ambrosia trifida
Amorpha fruticosa
Anemone quinquefolia
Anemonella thalictroides
Angelica atropurpurea
Apios americana
Aralia hispida
Aralia racemosa
Asclepias incarnata
Aster cordifolius
Aster sagittifolius
Aster shortii
Bidens connata
Bidens coronata
Bidens frondosa
Bidens vulgata
Botrychium virginianum
Bromus purgans
Calamagrostis canadensis
Carex albursina
Carex alopecoidea
Carex convoluta
Carex cristata
Carex grisea
Carex laxiflora
Carex molesta
Carex muskingumensis
Carex pennsylvanica
Carex projecta
Carex stipata
Carex tribuloides
Carex typhina
Carex vesicaria
Cassia marilandica
Caulophyllum thalictroides
Galastrus scandens
Chaerophyllum procumbens
Chelone glabra
Cicuta bulbifera
Circaea alpina
Clematis virginiana
Clintonia borealis

Comandra umbellata
Cornus alternifolia
Cuscuta sp.
Dentaria laciniata
Desmodium nudiflorum
Dicentra cucullaria
Diervilla lonicera
Dryopteris cristata
Dryopteris spinulosa
Dryopteris thelypteris
Eliisia nyctelea
Elymus virginicus
Epilobium palustris
Equisetum arvense
Equisetum hyemale
Erigeron philadelphicus
Erigeron pulchellus
Erythronium albidum
Eupatorium perfoliatum
Eupatorium purpureum
Eupatorium rugosum
Euonymus atropurpureus
Festuca obtusa
Fragaria vesca
Galium tinctorium
Gerardia gradiflora
Geum strictum
Hackelia virginica
Helenium autumnale
Helianthus strumosus
Hepatica acutiloba
Heracleum maximum
Hydrophyllum appendiculatum
Hypericum ascyron
Hypericum pyramidatum
Hystrix patula
Impatiens pallida
Iris versicolor
Isopyrum biternatum
Juncus tenuis
Lactuca canadensis
Lilium michiganense
Lilium philadelphicum
Lilium superbum
Lippia lanceolata
Lonicera prolifera
Maianthemum canadense
Mentha arvensis
Mertensia virginica
Mimulus ringens

Mitella diphylla
Monarda fistulosa
Muhlenbergia sp.
Napaea dioica
Nepeta hederacea
Oryzopsis racemosa
Osmunda cinnamomea
Osmunda regalis
Oxalis europaea
Oxalis stricta
Parietaria pennsylvanica
Phalaris arundinacea
Phlox pilosa
Physocarpus opulifolius
Pilea pumila
Poa palustris
Polygonatum biflorum
Polygonatum pubescens
Polygonum hydropiper
Polygonum sagittatum
Pteridium aquilinum
Ranunculus recurvatus
Ratibida pinnata
Rubus allegheniensis
Rubus occidentalis
Rumex altissimus
Salix amygdaloides
Salix interior
Sanicula marilandica
Saxifraga pennsylvanica
Scutellaria lateriflora
Senecio aureus
Silphium perfoliatum
Sium suave
Solidago gigantea
Solidago ulmifolia
Spiraea alba
Staphylea trifolia
Stellaria longifolia
Symplocarpus foetida
Trientalis borealis
Trillium grandiflorum
Trillium recurvatum
Triosteum perfoliatum
Urtica dioica
Uvularia grandiflora
Vernonia fasciculata
Viola renifolia
Zizia aurea

Additional Species:

Presence or Frequency
(Common species only)

FLOOD-PLAIN HARDWOODS

Stand No. 4109
Quadrat No.

PRESENCE

Adiantum pedatum
Agrimonia gryposepala
Allium canadense
Allium tricoccum
Amphicarpa bracteata
Anemone canadensis
Anemone virginiana
Aralia nudicaulis
Arenaria lateriflora
Arisaema atrorubens
Arisaema dracontium
Asarum canadense
Aster lateriflorus
Aster simplex
Athyrum filix-femina
Athyrum thelypteroides
Boehmeria cylindrica
Brachyelytrum erectum
Caltha palustris
Campanula americana
Carex crinita
Carex grayii
Carex intumescens
Carex lupulina
Carex normalis
Carex vupinoidea
Cephalanthus occidentalis
Cicuta maculata
Circaea quadrisulcata
Cirsium altissimum
Convolvulus sepium
Cornus femina
Cornus obliqua
Cornus rugosa
Cornus stolonifera

Corylus americana
Cryptotaenia canadensis
Desmodium glutinosum
Dioscorea villosa
Echinocystis lobata
Fragaria virginiana
Galium aparine
Galium concinnum
Galium obtusum
Galium triflorum
Geranium maculatum
Geum canadense
Glyceria striata
Hydrophyllum virginianum
Ilex verticillata
Impatiens capensis
Iris virginica
Lactuca biennis
Laportea canadensis
Leersia oryzoides
Lobelia cardinalis
Lycopus americanus
Lycopus uniflorus
Lysimachia ciliata
Lysimachia nummularia
Menispermum canadense
Onoclea sensibilis
Osmorhiza claytoni
Osmorhiza longistylis
Parthenocissus inserta
Phlox divaricata
Phryma leptostachya
Physostegia virginiana
Podophyllum peltatum
Polemonium reptans

Polygonatum canaliculatum
Prenanthes alba
Ranunculus abortivus
Ranunculus septentrionalis
Rhus radicans
Ribes americanum
Ribes cynosbati
Ribes missouriense
Rorippa islandica
Rudbeckia laciniata
Rumex verticillatus
Sambucus canadensis
Sanguinaria canadensis
Sanicula gregaria
Smilacina racemosa
Smilacina stellata
Smilax ecirrhata
Smilax herbacea
Smilax tannoides
Solanum dulcamara
Stachys palustris
Teucrium canadense
Thalictrum dasycarpum
Thalictrum dioicum
Tovara virginiana
Trillium flexipes
Uvularia sessilifolia
Veronicastrum virginianum
Viburnum lentago
Viola canadensis
Viola conspersa
Viola cucullata
Viola pubescens
Vitis riparia
Zanthoxylum americanum

Additional species:

Presence or Frequency
(Common species only)

FLOOD-PLAIN HARDWOODS

Stand No. 4108
Quadrat No.

<i>Adiantum pedatum</i>	<i>Corylus americana</i>	<i>Polygonatum canaliculatum</i>
<i>Agrimonia gryposepala</i>	<i>Cryptotaenia canadensis</i>	<i>Prenanthes alba</i>
<i>Allium canadense</i>	<i>Desmodium glutinosum</i>	<i>Ranunculus abortivus</i>
<i>Allium tricoccum</i>	<i>Dioscorea villosa</i>	<i>Ranunculus septentrionalis</i>
<i>Amphicarpa bracteata</i>	<i>Echinocystis lobata</i>	<i>Rhus radicans</i>
<i>Anemone canadensis</i>	<i>Fragaria virginiana</i>	<i>Ribes americanum</i>
<i>Anemone virginiana</i>	<i>Galium aparine</i>	<i>Ribes cynosbati</i>
<i>Aralia nudicaulis</i>	<i>Galium concinnum</i>	<i>Ribes missouriense</i>
<i>Arenaria lateriflora</i>	<i>Galium obtusum</i>	<i>Rorippa islandica</i>
<i>Arisaema atrorubens</i>	<i>Galium triflorum</i>	<i>Rudbeckia laciniata</i>
<i>Arisaema dracontium</i>	<i>Geranium maculatum</i>	<i>Rumex verticillatus</i>
<i>Asarum canadense</i>	<i>Geum canadense</i>	<i>Sambucus canadensis</i>
<i>Aster lateriflorus</i>	<i>Glyceria striata</i>	<i>Sanguinaria canadensis</i>
<i>Aster simplex</i>	<i>Hydrophyllum virginianum</i>	<i>Sanicula gregaria</i>
<i>Athyrium filix-femina</i>	<i>Ilex verticillata</i>	<i>Smilacina racemosa</i>
<i>Athyrium thelypteroides</i>	<i>Impatiens capensis</i>	<i>Smilacina stellata</i>
<i>Boehmeria cylindrica</i>	<i>Iris virginica</i>	<i>Smilax ecirrhata</i>
<i>Brachyelytrum erectum</i>	<i>Lactuca biennis</i>	<i>Smilax herbacea</i>
<i>Caltha palustris</i>	<i>Laportea canadensis</i>	<i>Smilax tamnoides</i>
<i>Campanula americana</i>	<i>Leersia oryzoides</i>	<i>Solanum dulcamara</i>
<i>Carex crinita</i>	<i>Lobelia cardinalis</i>	<i>Stachys palustris</i>
<i>Carex grayii</i>	<i>Lycopus americanus</i>	<i>Teucrium canadense</i>
<i>Carex intumescens</i>	<i>Lycopus uniflorus</i>	<i>Thalictrum dasycarpum</i>
<i>Carex lupulina</i>	<i>Lysimachia ciliata</i>	<i>Thalictrum dioicum</i>
<i>Carex normalis</i>	<i>Lysimachia nummularia</i>	<i>Tovara virginiana</i>
<i>Carex vupinoidea</i>	<i>Menispermum canadense</i>	<i>Trillium flexipes</i>
<i>Cephalanthus occidentalis</i>	<i>Onoclea sensibilis</i>	<i>Uvularia sessilifolia</i>
<i>Cicuta maculata</i>	<i>Osmorhiza claytoni</i>	<i>Veronicastrum virginianum</i>
<i>Circaea quadrisulcata</i>	<i>Osmorhiza longistylis</i>	<i>Viburnum lentago</i>
<i>Cirsium altissimum</i>	<i>Parthenocissus inserta</i>	<i>Viola canadensis</i>
<i>Convolvulus sepium</i>	<i>Phlox divaricata</i>	<i>Viola conspersa</i>
<i>Cornus femina</i>	<i>Phryma leptostachya</i>	<i>Viola cucullata</i>
<i>Cornus obliqua</i>	<i>Physostegia virginiana</i>	<i>Viola pubescens</i>
<i>Cornus rugosa</i>	<i>Podophyllum peltatum</i>	<i>Vitis riparia</i>
<i>Cornus stolonifera</i>	<i>Polemonium reptans</i>	<i>Zanthoxylum americanum</i>

Additional species:

Presence or Frequency
(Common species only)

FLOOD-PLAIN HARDWOODS

Stand No. 4108
Quadrat No.

Adiantum pedatum
Agrimonia grypsosepala
Allium canadense
Allium tricoccum
Amphicarpa bracteata
Anemone canadensis
Anemone virginiana
Aralia nudicaulis
Arenaria lateriflora
Arisaema atrorubens
Arisaema dracontium
Asarum canadense
Aster lateriflorus
Aster simplex
Athyrium filix-femina
Athyrium thelypteroides
Boehmeria cylindrica
Brachyelytrum erectum
Caltha palustris
Campanula americana
Carex crinita
Carex grayii
Carex intumescens
Carex lupulina
Carex normalis
Carex vupinoidea
Cephalanthus occidentalis
Cicuta maculata
Circaea quadrisulcata
Cirsium altissimum
Convolvulus sepium
Cornus femina
Cornus obliqua
Cornus rugosa
Cornus stolonifera

Corylus americana
Cryptotaenia canadensis
Desmodium glutinosum
Dioscorea villosa
Echinocystis lobata
Fragaria virginiana
Galium aparine
Galium concinnum
Galium obtusum
Galium triflorum
Geranium maculatum
Geum canadense
Glyceria striata
Hydrophyllum virginianum
Ilex verticillata
Impatiens capensis
Iris virginica
Lactuca biennis
Laportea canadensis
Leersia oryzoides
Lobelia cardinalis
Lycopus americanus
Lycopus uniflorus
Lysimachia ciliata
Lysimachia nummularia
Menispermum canadense
Onoclea sensibilis
Osmorhiza claytoni
Osmorhiza longistylis
Parthenocissus inserta
Phlox divaricata
Phryma leptostachya
Physostegia virginiana
Podophyllum peltatum
Polemonium reptans

Polygonatum canaliculatum
Prenanthes alba
Ranunculus abortivus
Ranunculus septentrionalis
Rhus radicans
Ribes americanum
Ribes cynosbati
Ribes missouriense
Rorippa islandica
Rudbeckia laciniata
Rumex verticillatus
Sambucus canadensis
Sanguinaria canadensis
Sanicula gregaria
Smilacina racemosa
Smilacina stellata
Smilax ecirrhata
Smilax herbacea
Smilax tamnoides
Solanum dulcamara
Stachys palustris
Teucrium canadense
Thalictrum dasycarpum
Thalictrum dioicum
Tovara virginiana
Trillium flexipes
Uvularia sessilifolia
Veronicastrum virginianum
Viburnum lentago
Viola canadensis
Viola conspersa
Viola cucullata
Viola pubescens
Vitis riparia
Zanthoxylum americanum

Additional species:

Presence or Frequency
(Common species only)

FLOOD-PLAIN HARDWOODS

Stand No. 4108
Quadrat No.

Adiantum pedatum
Agrimonia grypsosepala
Allium canadense
Allium tricoccum
Amphicarpa bracteata
Anemone canadensis
Anemone virginiana
Aralia nudicaulis
Arenaria lateriflora
Arisaema atrorubens
Arisaema dracontium
Asarum canadense
Aster lateriflorus
Aster simplex
Athyrum filix-femina
Athyrum thelypteroides
Boehmeria cylindrica
Brachyelytrum erectum
Caltha palustris
Campanula americana
Carex crinita
Carex grayii
Carex intumescens
Carex lupulina
Carex normalis
Carex vupinoidea
Cephalanthus occidentalis
Cicuta maculata
Circaea quadrisulcata
Cirsium altissimum
Convolvulus sepium
Cornus femina
Cornus obliqua
Cornus rugosa
Cornus stolonifera

Corylus americana
Cryptotaenia canadensis
Desmodium glutinosum
Dioscorea villosa
Echinocystis lobata
Fragaria virginiana
Galium aparine
Galium concinnum
Galium obtusum
Galium triflorum
Geranium maculatum
Geum canadense
Glyceria striata
Hydrophyllum virginianum
Ilex verticillata
Impatiens capensis
Iris virginica
Lactuca biennis
Laportea canadensis
Leersia oryzoides
Lobelia cardinalis
Lycopus americanus
Lycopus uniflorus
Lysimachia ciliata
Lysimachia nummularia
Menispermum canadense
Onoclea sensibilis
Osmorhiza claytoni
Osmorhiza longistylis
Parthenocissus inserta
Phlox divaricata
Phryma leptostachya
Physostegia virginiana
Podophyllum peltatum
Polemonium reptans

Polygonatum canaliculatum
Prenanthes alba
Ranunculus abortivus
Ranunculus septentrionalis
Rhus radicans
Ribes americanum
Ribes cynosbati
Ribes missouriense
Rorippa islandica
Rudbeckia laciniata
Rumex verticillatus
Sambucus canadensis
Sanguinaria canadensis
Sanicula gregaria
Smilacina racemosa
Smilacina stellata
Smilax ecirrhata
Smilax herbacea
Smilax tamnoides
Solanum dulcamara
Stachys palustris
Teucrium canadense
Thalictrum dasycarpum
Thalictrum dioicum
Tovara virginiana
Trillium flexipes
Uvularia sessilifolia
Veronicastrum virginianum
Viburnum lentago
Viola canadensis
Viola conspersa
Viola cucullata
Viola pubescens
Vitis riparia
Zanthoxylum americanum

Additional species:

Presence or Frequency
(Common species only)

FLOOD-PLAIN HARDWOODS

Stand No. 4108
Quadrat No.

<i>Adiantum pedatum</i>	<i>Corylus americana</i>	<i>Polygonatum canaliculatum</i>
<i>Agrimonia gryposepala</i>	<i>Cryptotaenia canadensis</i>	<i>Prenanthes alba</i>
<i>Allium canadense</i>	<i>Desmodium glutinosum</i>	<i>Ranunculus abortivus</i>
<i>Allium tricoccum</i>	<i>Dioscorea villosa</i>	<i>Ranunculus septentrionalis</i>
<i>Amphicarpa bracteata</i>	<i>Echinocystis lobata</i>	<i>Rhus radicans</i>
<i>Anemone canadensis</i>	<i>Fragaria virginiana</i>	<i>Ribes americanum</i>
<i>Anemone virginiana</i>	<i>Galium aparine</i>	<i>Ribes cynosbati</i>
<i>Aralia nudicaulis</i>	<i>Galium concinnum</i>	<i>Ribes missouriense</i>
<i>Arenaria lateriflora</i>	<i>Galium obtusum</i>	<i>Rorippa islandica</i>
<i>Arisaema atrorubens</i>	<i>Galium triflorum</i>	<i>Rudbeckia laciniata</i>
<i>Arisaema dracontium</i>	<i>Geranium maculatum</i>	<i>Rumex verticillatus</i>
<i>Asarum canadense</i>	<i>Geum canadense</i>	<i>Sambucus canadensis</i>
<i>Aster lateriflorus</i>	<i>Glyceria striata</i>	<i>Sanguinaria canadensis</i>
<i>Aster simplex</i>	<i>Hydrophyllum virginianum</i>	<i>Sanicula gregaria</i>
<i>Athyrium filix-femina</i>	<i>Ilex verticillata</i>	<i>Smilacina racemosa</i>
<i>Athyrium thelypteroides</i>	<i>Impatiens capensis</i>	<i>Smilacina stellata</i>
<i>Boehmeria cylindrica</i>	<i>Iris virginica</i>	<i>Smilax ecirrhata</i>
<i>Brachyelytrum erectum</i>	<i>Lactuca biennis</i>	<i>Smilax herbacea</i>
<i>Caltha palustris</i>	<i>Laportea canadensis</i>	<i>Smilax tannoides</i>
<i>Campanula americana</i>	<i>Leersia oryzoides</i>	<i>Solanum dulcamara</i>
<i>Carex crinita</i>	<i>Lobelia cardinalis</i>	<i>Stachys palustris</i>
<i>Carex grayii</i>	<i>Lycopus americanus</i>	<i>Teucrium canadense</i>
<i>Carex intumescens</i>	<i>Lycopus uniflorus</i>	<i>Thalictrum dasycarpum</i>
<i>Carex lupulina</i>	<i>Lysimachia ciliata</i>	<i>Thalictrum dioicum</i>
<i>Carex normalis</i>	<i>Lysimachia nummularia</i>	<i>Tovara virginiana</i>
<i>Carex vupinoidea</i>	<i>Menispermum canadense</i>	<i>Trillium flexipes</i>
<i>Cephalanthus occidentalis</i>	<i>Onoclea sensibilis</i>	<i>Uvularia sessilifolia</i>
<i>Cicuta maculata</i>	<i>Osmorhiza claytoni</i>	<i>Veronicastrum virginianum</i>
<i>Circaea quadrisulcata</i>	<i>Osmorhiza longistylis</i>	<i>Viburnum lentago</i>
<i>Cirsium altissimum</i>	<i>Parthenocissus inserta</i>	<i>Viola canadensis</i>
<i>Convolvulus sepium</i>	<i>Phlox divaricata</i>	<i>Viola conspersa</i>
<i>Cornus femina</i>	<i>Phryma leptostachya</i>	<i>Viola cucullata</i>
<i>Cornus obliqua</i>	<i>Physostegia virginiana</i>	<i>Viola pubescens</i>
<i>Cornus rugosa</i>	<i>Podophyllum peltatum</i>	<i>Vitis riparia</i>
<i>Cornus stolonifera</i>	<i>Polemonium reptans</i>	<i>Zanthoxylum americanum</i>

Additional species: