



LIBRARIES

UNIVERSITY OF WISCONSIN-MADISON

Sectional map of Winnebago County. 1855

[s.l.]: [s.n.], 1855

<https://digital.library.wisc.edu/1711.dl/EEC4ZNMPMZL348C>

Based on date of publication, this material is presumed to be in the public domain.

Original material owned by Oshkosh Public Library.

For information on re-use, see

<http://digital.library.wisc.edu/1711.dl/Copyright>

The libraries provide public access to a wide range of material, including online exhibits, digitized collections, archival finding aids, our catalog, online articles, and a growing range of materials in many media.

When possible, we provide rights information in catalog records, finding aids, and other metadata that accompanies collections or items. However, it is always the user's obligation to evaluate copyright and rights issues in light of their own use.

CODRINTY
TOWNSHIP 20 N.

WASHARA
TOWNSHIP 19 N.

MARQUETTE COUNTY
TOWNSHIP 17 N.

CALUMET COUNTY

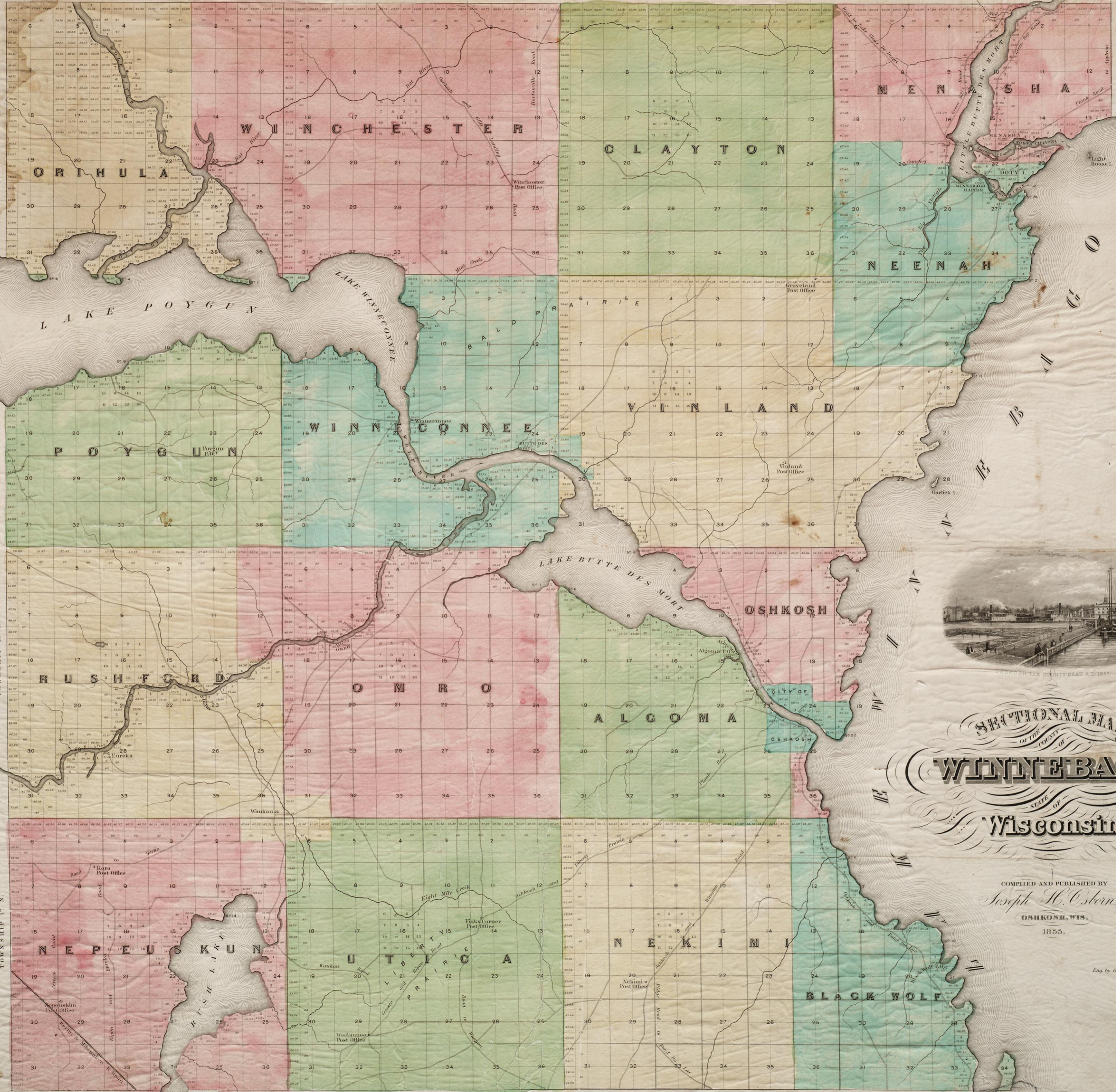

SECTIONAL MAP
OF THE COUNTY OF
WINNEBAGO
STATE OF
Wisconsin

COMPILED AND PUBLISHED BY
Joseph H. Osborn
OSHKOSH, WIS.
1855.

Eng by Geo. E. Sherman, N.Y.

SECTIONAL MAP

OF THE COUNTY OF

WINNEBAGO

STATE OF

Wisconsin.

COMPILED AND PUBLISHED BY

Joseph H. Osborn.

OSHKOSH, WIS.

1855.

Eng. by Geo. E. Sherman. N.Y.

RANGE 16 E.



RANGE 17 E.



MENASHA

BUTTERFIELD'S MORT

Road to Lake View Dr Desert

Green Bay Road

Green Bay Road

Plank Road

to Appleton

Cemetery

Light House I.

NORTH CHANNEL

Rapids

Bridge

lands







Groveland
Post Office

Vinland
Post Office

Garlick I.

V I N L A N D

A I R I E

R



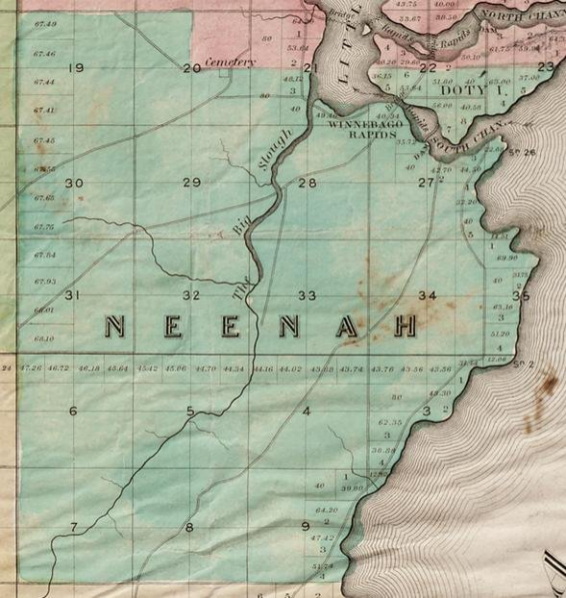

TOWNSHIP 18 N.

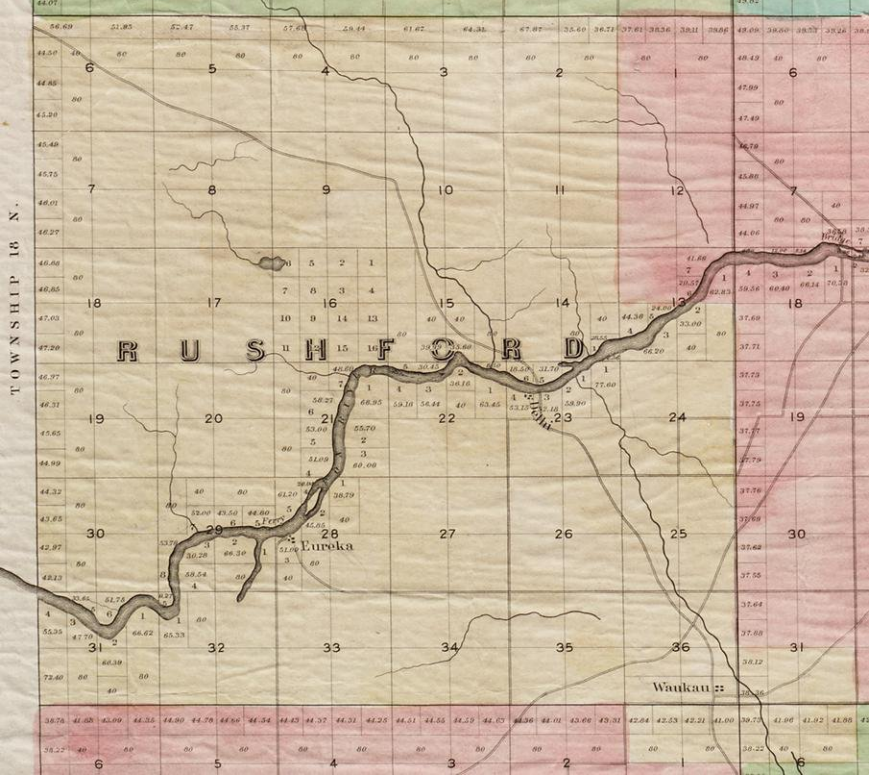

R U S H C R O F T

Eureka

Waukau

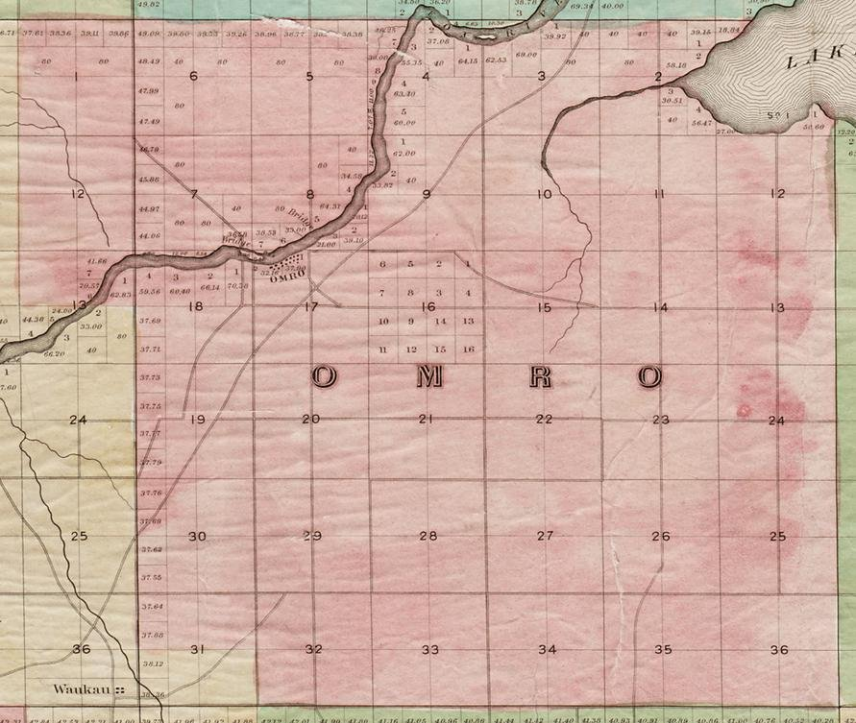

LAK

OMRO

Waukau ::

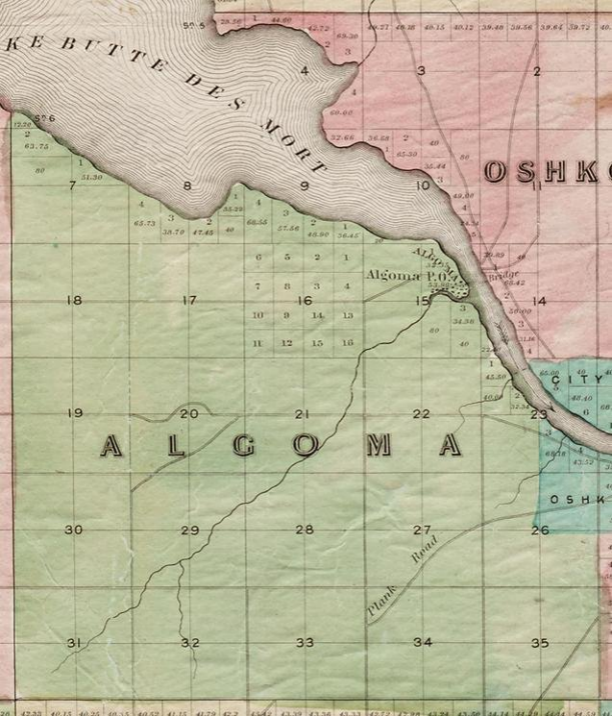



OSHKOSH

Algoma P.O.

CITY OF

OSHKOSH

COMA

E.S. MORT

Plank Road



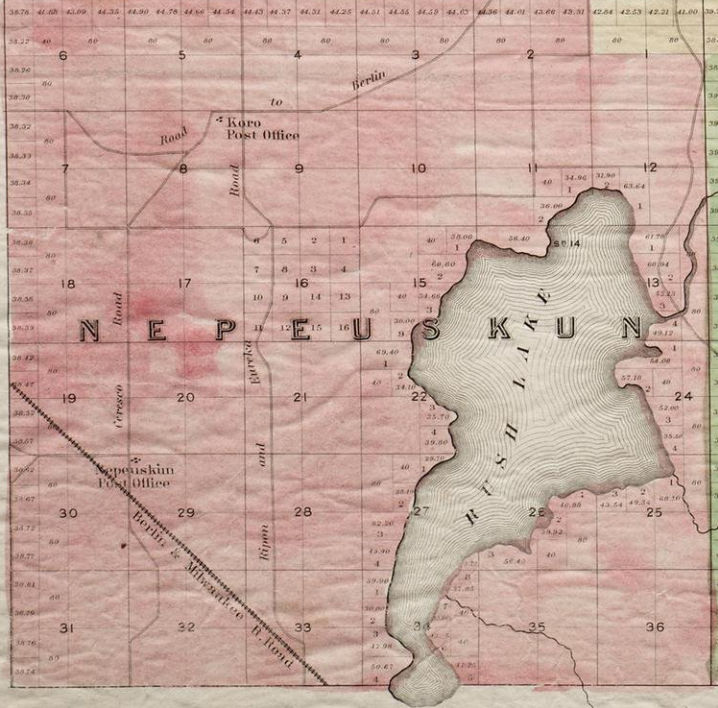

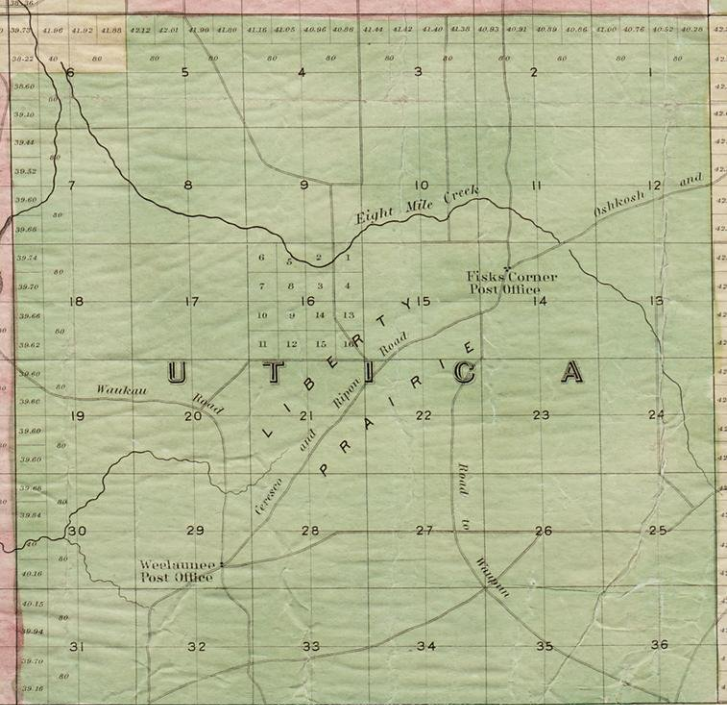

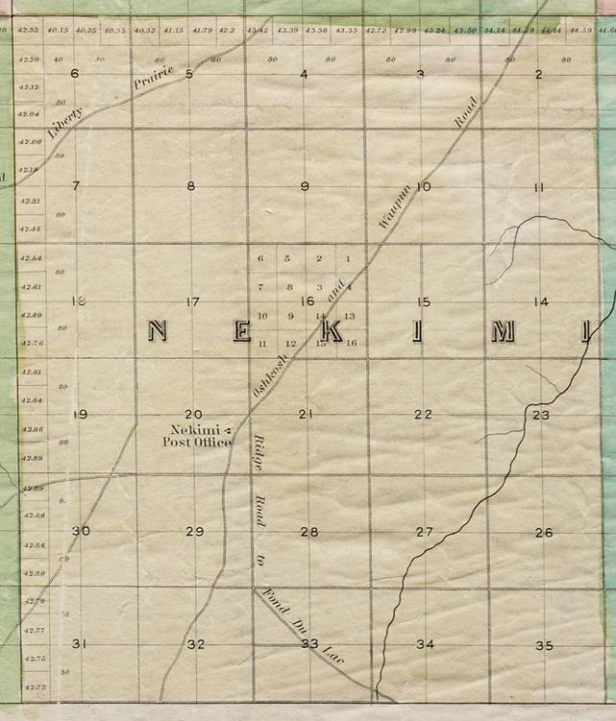

Wis

COMP

Joseph



BLACK WOLF

Pond du Lac

Black Wolf P.O.

Black Wolf

12

13

24

25

36

7

18

19

30

31

17

20

29

32

7

21

28

33

34

1
2
3
4

5
6
7
8

9
10
11

12
13
14

15
16
17

18
19
20

21
22
23

24
25
26

27
28
29

30
31
32

26.20
32.40
32.60
33.44
37.16
37.47
37.76

45.22
45.44

52.16

49.40
49.60
49.80

40.08
42.40
38.00

63.44
34.16
32.00
36.56

73.60

85.4
69.20

54.00
29.20



OSHKOSH THE COUNTY SEAT A.D. 1855.