



# LIBRARIES

UNIVERSITY OF WISCONSIN-MADISON

## Atlas of Manitowoc County, Wisconsin. 1922

Pentzien, Louis I.

Sheboygan, Wisconsin: Donohue, 1922

<https://digital.library.wisc.edu/1711.dl/SIJKBWJZBA6C78J>

Images cannot be copied or reproduced without the written permission of the Manitowoc Public Library. For information on re-use, see

<http://digital.library.wisc.edu/1711.dl/Copyright>

The libraries provide public access to a wide range of material, including online exhibits, digitized collections, archival finding aids, our catalog, online articles, and a growing range of materials in many media.

When possible, we provide rights information in catalog records, finding aids, and other metadata that accompanies collections or items. However, it is always the user's obligation to evaluate copyright and rights issues in light of their own use.

WR  
917.75  
A

1806

OC PUBLIC LIBRARY  
OC, WISCONSIN 54220

# ATLAS OF MANITOWOC COUNTY Wisconsin

Compiled and Published by  
**The JERRY DONOHUE ENGINEERING COMPANY**  
SHEBOYGAN, WISCONSIN  
and LOUIS T. PENTZIEN, Civil Engineer  
Manitowoc, Wisconsin

1922

# Manitowoc Savings Bank

MANITOWOC, WISCONSIN

---

**CAPITAL & SURPLUS \$360,000.00**

**RESOURCES OVER \$4,000,000.00**

---

## OFFICERS

Louis Schuette, President

Edwin Schuette, Cashier

Henry Detjen, Asst. Cashier

## DIRECTORS

L. Nash,

Edwin Schuette,

L. E. Geer

Louis Schuette,

A. J. Vits

# BANK OF TWO RIVERS

*CAPITAL and SURPLUS \$175,000.00*

*RESOURCES OVER 1½ MILLION*



**STRENGTH**

**SERVICE**

**COURTESY**

**It is Our Aim to Make it Both Agreeable and Profitable to do  
Business With Us**

J. E. Hamilton, President

C. E. Mueller, Vice-President

H. C. Wilke, Cashier

H. R. Schwake, Ass't Cashier

Roland C. Bleser, Clerk

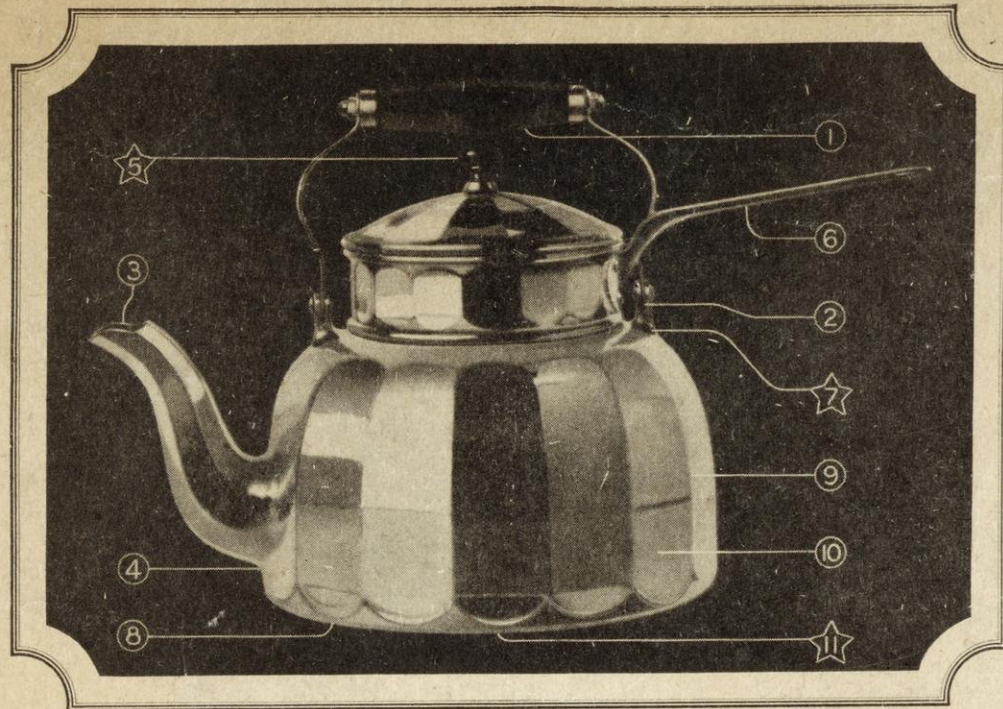

## Mirro Wears for Many Years

Long life is common to all Mirro utensils. For nothing is left undone that will prolong their wear. Bodies are of one-piece construction. Welds take the place of soldered joints. And welds take the place of rivets wherever possible. Even the aluminum itself is subjected to a process which works it into extraordinary density, and a singular endurance.

But time alone does not measure the service of Mirro Aluminum. It is designed to be as useful as it is long-lived, and as beautiful as it is useful.

Mark, for instance, the many features of convenience that distinguish this handsome Mirro Tea Kettle with boiler inset. You do not find them in ordinary aluminum ware.

(1) Highly ebonized, sure-grip, detachable handle. (2) Slotted ears permit handle to be shifted to any desired position without coming in contact with Kettle. (3) Easy-filling, easy-

pouring spout. (4) Spout welded on.

☆ (5) Rivetless, no-burn, ebonized knob. (6) Hollow steel handle, comfortable to the hand. ☆ (7) Handle ears welded on. (8) Unusually wide heating base.

(9) Rich Colonial design. (10) Famous Mirro finish. ☆ (11) Famous Mirro trade-mark stamped into the bottom of every Mirro utensil, and your guarantee of excellence throughout.

Note that the same cover fits both Kettle and inset.

To appreciate this guarantee at its full worth, remember that back of it is the world's foremost manufacturer of aluminum utensils—a manufacturer with nearly thirty years' experience in the making of better aluminum ware.

You will find Mirro Aluminum at the leading stores everywhere.

Send for miniature Mirro catalog.

Aluminum Goods Manufacturing Company, General Offices: Manitowoc, Wis., U. S. A.  
Makers of Everything in Aluminum

**MIRRO** ALUMINUM  
Reflects  
Good Housekeeping



## Why is BADGER CEMENT TILE Superior to Other Drain Tile?

**BECAUSE**—It is made from the best washed sand and gravel, mixed with a large proportion of cement. (1 to 2½)

**BECAUSE**—It is uniform in quality. Every tile is exactly like every other tile in size, form and strength.

**BECAUSE**—It is smooth on the inside, thereby reducing friction and permitting the greatest possible flow of water.

**BECAUSE**—It is so dense in character that frost will not affect it. There are no soft ones.

**BECAUSE**—It is permanent. Concrete increases in strength as it grows older. Your drainage system will become better each year if Badger Tile is used.

**BECAUSE**—It is the most economical in the long run, for the first cost is no more than for inferior tile and its durability is greater.



This Field after Tiling Produced 60 Bushels of Corn per Acre



This Field across the Road without Tile, produced only 8 Bushels per Acre

# er Cement Tile Co.

Telephone 595

PLYMOUTH, WISCONSIN

T.21N. COOPERSTOWN R.22E.



COOPERSTOWN

MARIBEL

ROSECRANS

GREENSTREET



# The Glander Art Studio

PHOTOS, FRAMES and PICTURES

MOTION PICTURES

KODAKS and SUPPLIES — AMATEUR FINISHING

Washington St.

MANITOWOC, WIS.

## SERVICE CYCLE SHOP

L. J. SCHETTL

Indian and Henderson Motorcycles

Bicycle Accessories and Supplies

*Largest Stock in the County*

1018 S. Main St.

Phone 1431 W

MANITOWOC, WIS.



## H. W. DEPONS

PAINTING AND DECORATING

Wall Paper, Paints, Oils, Varnishes, Brushes  
and Window Shades

*We Do Picture Framing*

PHONE 615 W.

903 Washington St.

Manitowoc, Wis.

## TAUSCHEK'S MILLINERY

EVERYTHING IN HATS

Combined with Courtesy, Service and Satisfaction that  
You Will Tell Your Friends About

JAY ST.,

MANITOWOC, WISCONSIN

SEEDS MADSON QUALITY SEEDS BULBS

The M. G. Madson Seed Co.

Seedsman

Florists

Nurserymen

Manitowoc,

Wisconsin

FLOWERS

FERTILIZERS

## THE UPHOLSTERING WORKS

J. F. DETTMAN, Mgr.

Overstuffed Furniture — Cushions Built to Order

UPHOLSTERING REPAIR DEPARTMENT

General Upholstering — Furniture Repaired and Refinished — Crating and Packing

AUTO TRIMMING DEPARTMENT

Auto Tops — Curtains — Seat Covers — Special Work

SPRING CUSHIONS made to order and repaired for Passenger Cars and Trucks

MANITOWOC,

WISCONSIN

## MANITOWOC LUMBER CO.

DEALERS IN

*LUMBER, MILLWORK, WALL BOARD  
ROOFING and BUILDING PAPERS*

Corner 11th & Franklin

Phone 130

MANITOWOC,

WISCONSIN

## The Washington Confectionery

CANDIES & ICE CREAM

*We Make Our Own Candies*

Cor. 11th & Washington St.

MANITOWOC, WIS.

## Walter O. Bahr

CONTRACTOR

Sewer and Waterwork Construction

910-911 S. 12th Street

:::

Manitowoc, Wis.

## Koch - Melendy Electric Company

ELECTRICAL CONTRACTORS

A Full Line of Electrical Fixtures, Appliances and  
Wiring Supplies

Buffalo and N. 8th St.

Phone 197

MANITOWOC,

WISCONSIN

T.21N. GIBSON R.23E.

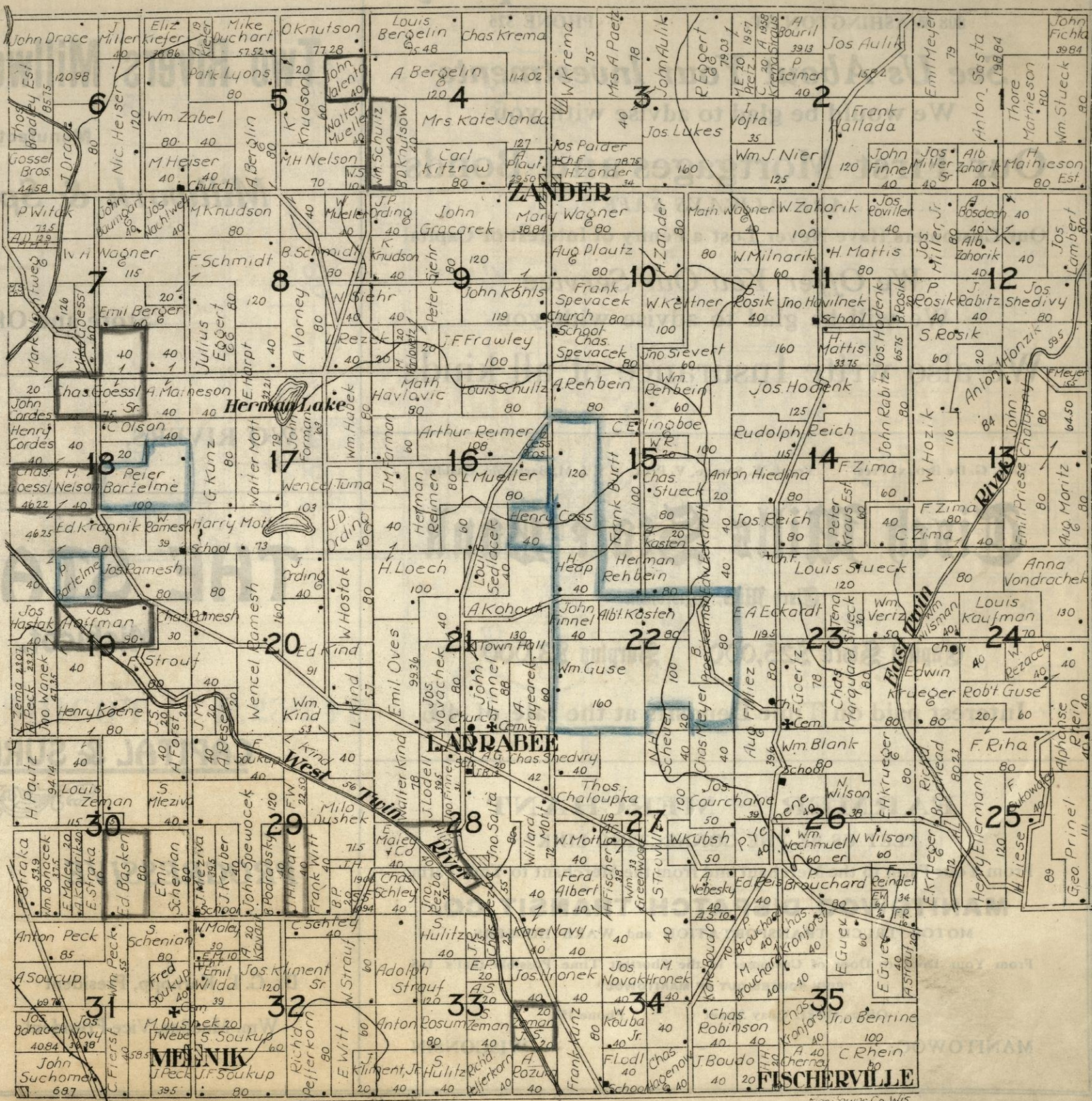

# Lindstedt-Hoffman Company

808 WASHINGTON ST.

PHONE 325

## See Us About Your Investments

We would be glad to advise with you

## Our First Mortgages and Bonds

ARE ALWAYS SAFE

Our Customers Have Never Lost a Penny of Interest or Capital

*We Offer You Our Service*

We will be glad to advise with you

We also write Insurance of all kinds

Geo. G. De Broux, Pres.

Frank W. Stange, V. Pres.

J. M. Bartelme, Cashier

# Tisch Mills State Bank

Tisch Mills, Wisconsin

Capital Stock \$25,000      Surplus \$3,000

Interest paid on Time Deposits at the rate of 4%

## FARMER — MERCHANT

"LET US BE THE CONNECTING LINK"

From Your Farm to the Merchant and from the Merchant to Your Farm

### MANITOWOC DISPATCH TRANSIT CO.

MOTOR TRUCK TRANSPORTATION and WARE HOUSERS

From Your Door to Door of Customer in the Shortest Time Possible that's US

"FIVE ROUTES OUT OF MANITOWOC"

Office 810-812 Quay Street

Phone 359

MANITOWOC,

WISCONSIN

HANS MEYER, Pres. & Mgr.

W. A. NIMMER, Sec. & Treas.

# Two Rivers Millwork & Cabinet Co.

Manufacturers of

## Millwork & Special Furniture

Store and Office Fixtures

TWO RIVERS,

WISCONSIN

# THE STATE BANK

Mishicot, Wisconsin

CAPITAL & SURPLUS \$35,000.00



**PROGRESSIVE**

**CONSERVATIVE**

Dr. G. L. Karnopp, President

Herman Stehn, Cashier

Wm. Mueller, Vice-President

Randolph Stehn, Asst. Cashier

T.20-21N. MISHICOT R.23-24E.

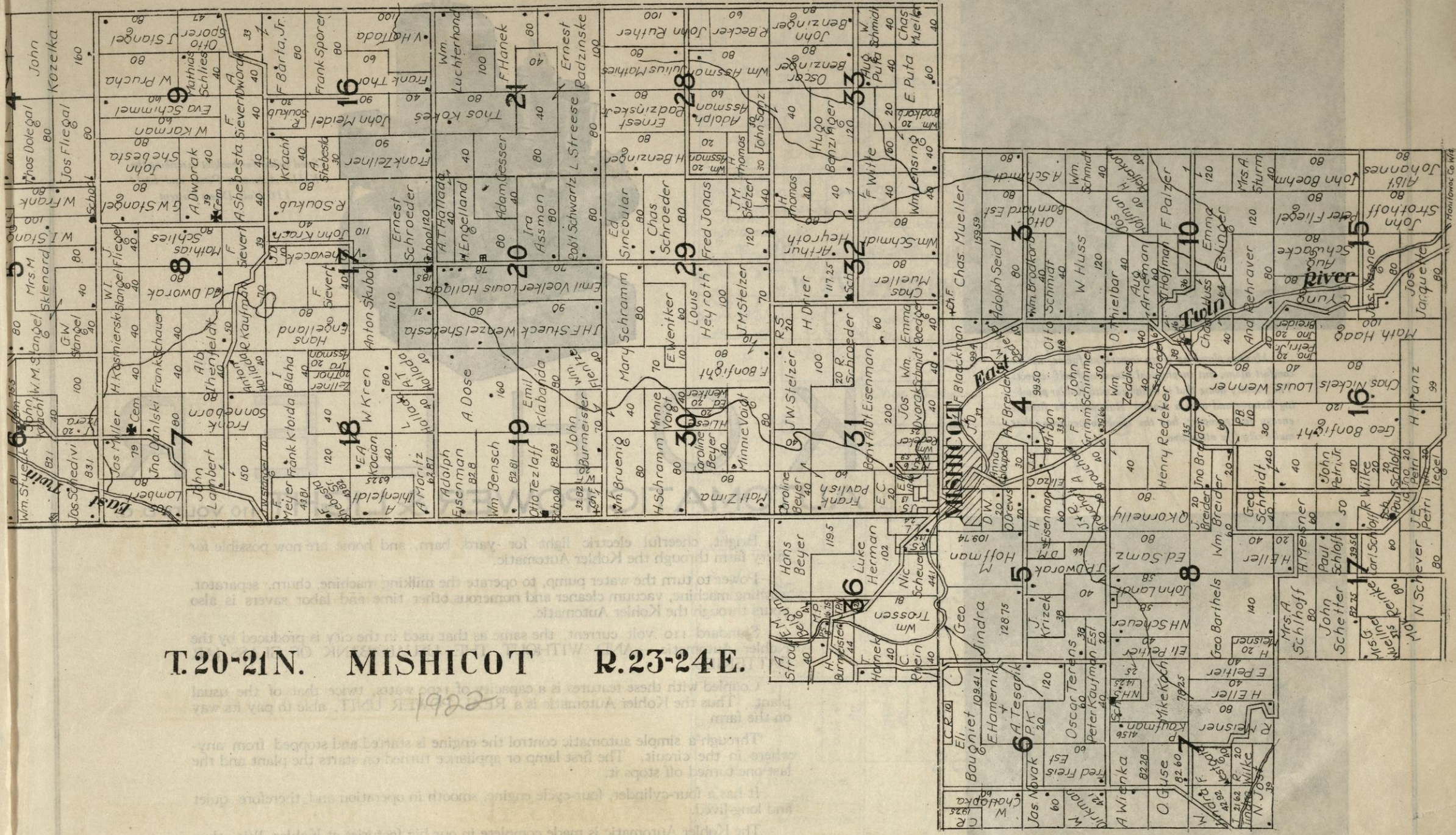

The Kohler Automatic is made complete in our big factories at Kohler, Wis., thus insuring that every unit is built to the well-known Kohler standards of quality and dependability.

The Kohler Automatic is made complete in our big factories at Kohler, Wis., thus insuring that every unit is built to the well-known Kohler standards of quality and dependability.

It has a four-cylinder four-cycle engine, smooth in operation and producing quiet and low-level.

Through a simple automatic control the engine is started and stopped from any remote point in the circuit. The fan lamp or appliance turned on starts the pump and the pump one closed off stops it.

When you connect with these features is a complete unit, ready to pay for way ahead. Thus the Kohler Automatic is a REAL UNIT, able to pay for way ahead on the farm.

Send for your current the same as that used in the city is produced by the Kohler Automatic. The Kohler Automatic is a REAL UNIT, able to pay for way ahead on the farm.

Lower to turn the water pump to operate the milking machine, churn, separator, etc. The Kohler Automatic is a REAL UNIT, able to pay for way ahead on the farm.

Light through the Kohler Automatic.

Light through the Kohler Automatic.

BRANCHES IN PRINCIPAL CITIES  
Shipping Point, Sheboygan, Wis.  
Kohler Co., Founded 1873, Kohler, Wis.

KOHLER OF KOHLER



*Modern plumbing is an important factor, not in comfort alone, but in physical fitness and self-respect. The country home that is equipped with Kohler plumbing fixtures and with a Kohler Automatic to furnish energy for pumping, has the same conveniences that make city life attractive.*



*When darkness gives way to cheerful, bright electric light, and the monotonous drudgery is relieved by the magic of electric power, then does farming become a joyous and wonderful occupation. For marvelous is the transformation which man-made machines has wrought in history's oldest and most important profession.*

## ELECTRIFY YOUR FARM!

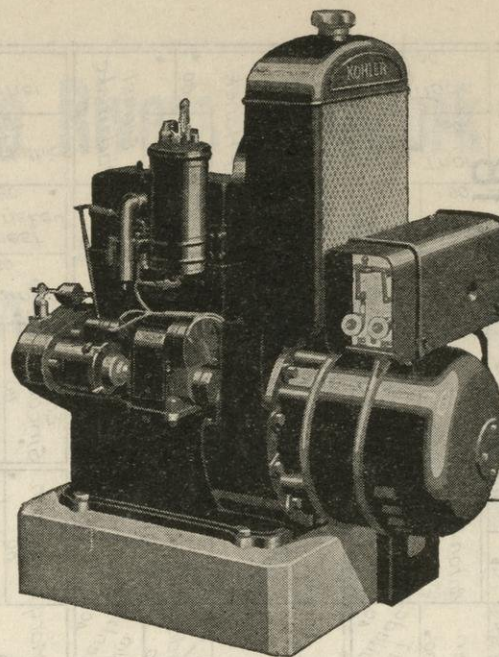

*Send today for booklet describing the Kohler Automatic Power and Light 110 Volt Direct Current*

# K O H L E R

## AUTOMATIC POWER & LIGHT 110 VOLTS D. C.

Bright, cheerful electric light for yard, barn, and home are now possible for every farm through the Kohler Automatic.

Power to turn the water pump, to operate the milking machine, churn, separator, washing machine, vacuum cleaner and numerous other time and labor savers is also yours through the Kohler Automatic.

Standard 110 volt current, the same as that used in the city is produced by the Kohler Automatic — AND WITHOUT THE USUAL BANK OF GLASS JAR BATTERIES.

Coupled with these features is a capacity of 1500 watts, twice that of the usual plant. Thus the Kohler Automatic is a REAL POWER UNIT, able to pay its way on the farm.

Through a simple automatic control the engine is started and stopped from anywhere in the circuit. The first lamp or appliance turned on starts the plant and the last one turned off stops it.

It has a four-cylinder, four-cycle engine, smooth in operation and therefore quiet and long-lived.

The Kohler Automatic is made complete in our big factories at Kohler, Wis., thus insuring that every unit is built to the well-known Kohler Standards of quality and dependability.

### KOHLER OF KOHLER

Kohler Co., Founded 1873, Kohler, Wis.

Shipping Point: Sheboygan, Wis.

BRANCHES IN PRINCIPAL CITIES

T.21N. TWO CREEKS R.24-25E.

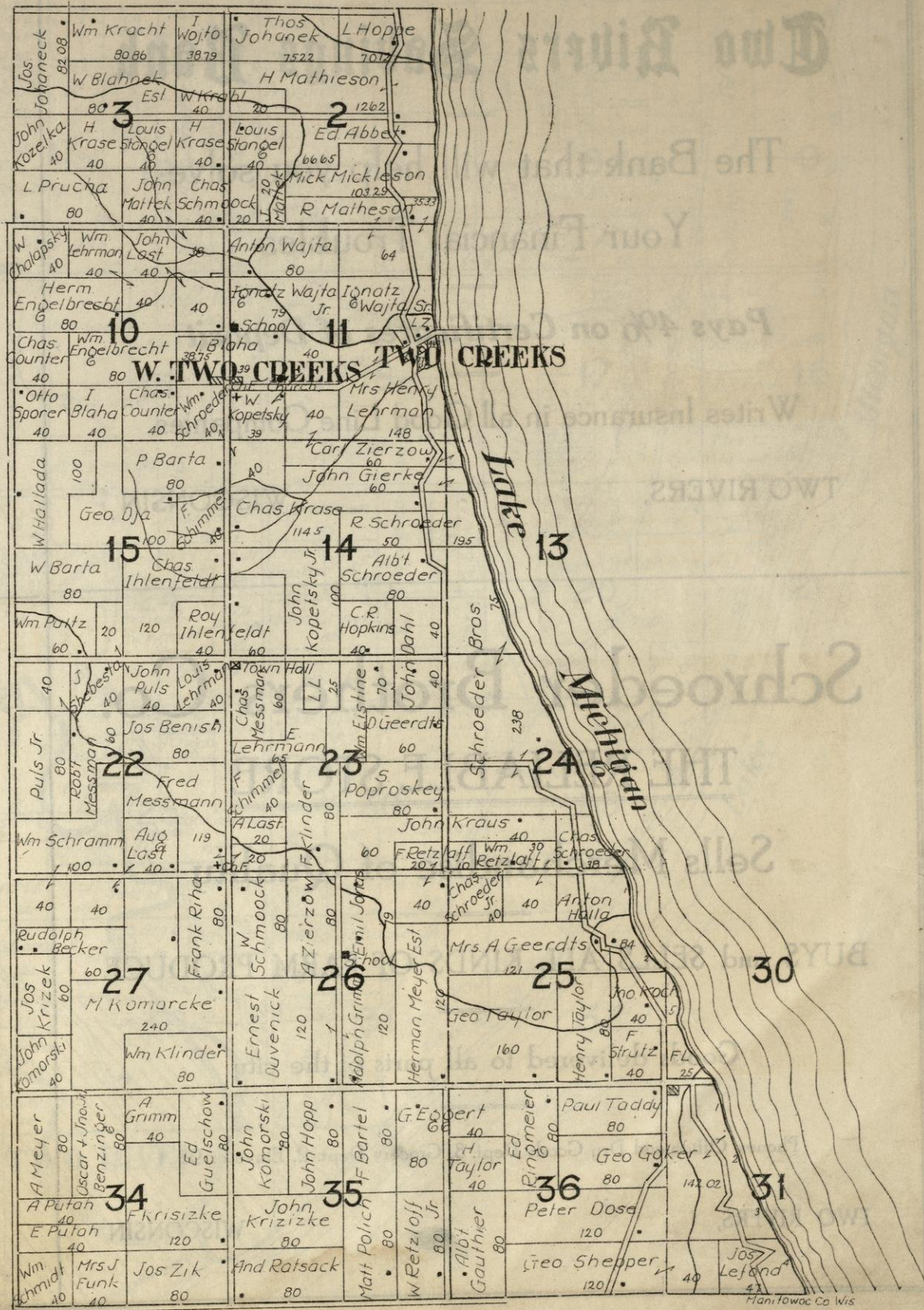

PETER SCHROEDER, Pres.

FRANK SCHROEDER, Cashier

## Two Rivers Savings Bank

The Bank that will help you solve  
Your Financial Troubles

*Pays 4% on Certificates of Deposit*

Writes Insurance in all Good Line Companies

TWO RIVERS,

WISCONSIN

## Two Rivers Mercantile Co.

### The Big Store

We Aim:

*To carry Quality Merchandise,*

*To give courteous Service*

*To guarantee one price to all—and that the lowest.*

We Sell:

*Groceries, Crockery, Dry Goods, Shoes, Furniture,  
House Furnishing, Rugs, Grafanolas, Records,  
Ladies' Ready-to-Wear and Gents' Furnishings.*

## Two Rivers Mercantile Co.

Phone: Office 9

- Grocery 6

TWO RIVERS

- WISCONSIN

## Schroeder Brothers Co.

### THE RELIABLE STORE

Sells Merchandise of Quality

BUYS and SELLS ALL KINDS OF FARM PRODUCE

Goods delivered to all parts of the city

Phones: Office and Dry Goods Dept. 8, Grocery Dept. 2, Elevator 98

TWO RIVERS,

WISCONSIN

## SCHMIDT LUMBER CO.

We Make a Specialty of

Sash, Doors, Mouldings, Sawed, Turned and Stair  
Work, Storm Sash and Doors, Window, Door  
and Porch Screens

White Pine, Yellow Pine, Hemlock, Cedar Posts, Cypress, Oak, Fir, Lath  
Red Cedar Shingles and Siding, White Cedar Shingles, Roofing  
Everything in Flooring

YARDS AT MANITOWOC AND TWO RIVERS

TWO RIVERS

- WISCONSIN

M. J. Kellner

KELLNER & SONS

FRANCIS CREEK

FRANCIS CREEK

FRANCIS CREEK

# TWO RIVERS

T.19-20N.

R.24-25E.

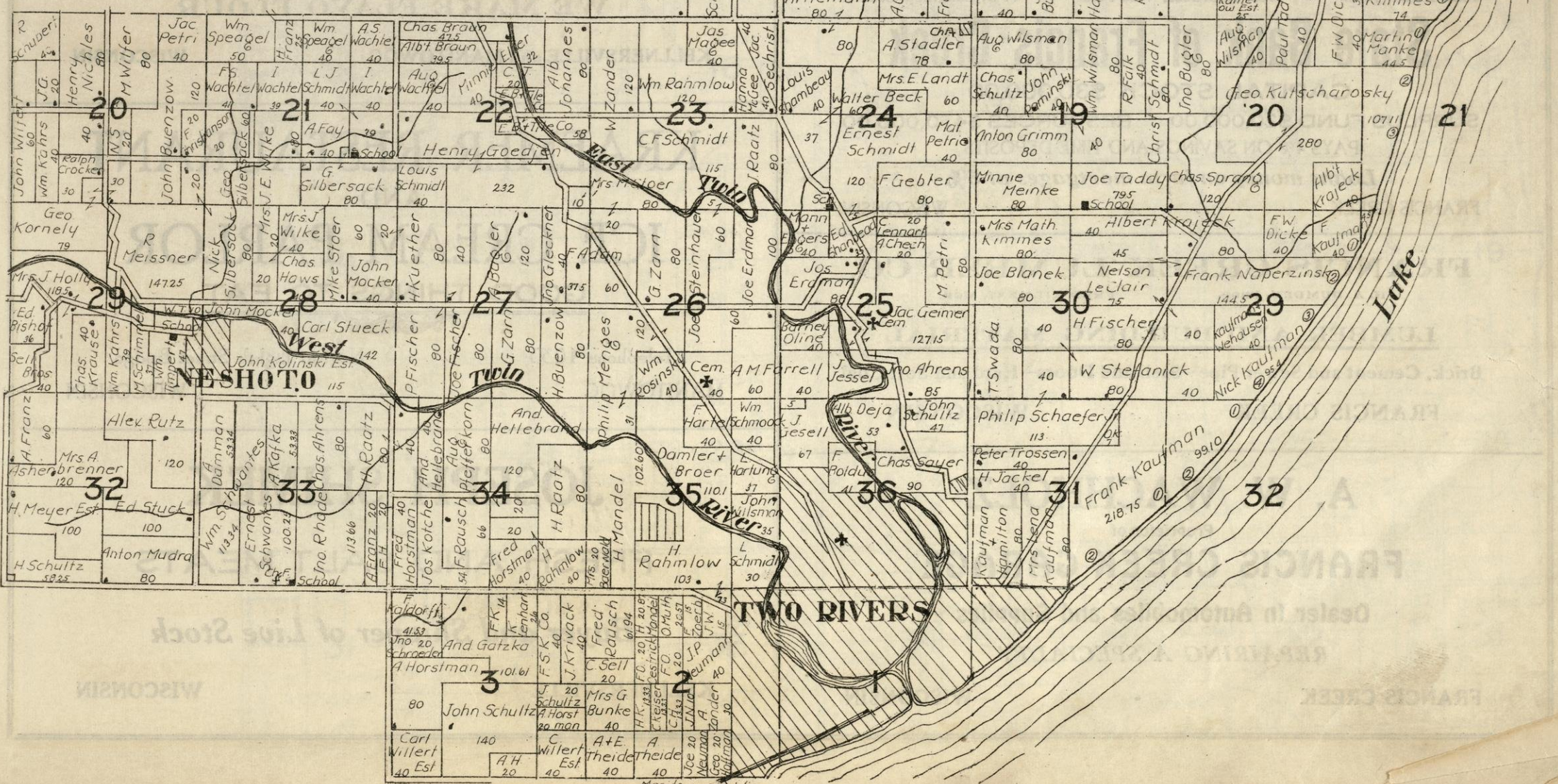

West

East

TWO RIVERS

Metchum

Lutke

Manitowoc Co. Wis



C. J. HESSEL

JOHN EWEN

**HESSEL & EWEN**DEALERS IN  
GENERAL MERCHANDISE

FRANCIS CREEK

WISCONSIN

**HOTEL HESSEL**

C. J. HESSEL, Proprietor

*Bowling Alley and Pool Room*

FRANCIS CREEK

WISCONSIN

John Ewen, Pres.

Jos. J. Gruber, Vice-Pres.

F. C. Baugniet, Cashier

**State Bank of Francis Creek**

CAPITAL STOCK \$30,000.00

SURPLUS FUND \$20,000.00 RESOURCES \$450,000.00

PAYS 4% ON SAVINGS AND TIME DEPOSITS

*Loans money on farm mortgages at 5%*

FRANCIS CREEK

WISCONSIN

**FRANCIS CREEK LUMBER CO.**

H. A. DUMDEY, PROP.

FRED KILMENT, MGR.

**LUMBER AND BUILDING MATERIAL**

Brick, Cement and Sewer Pipe—Sash and Doors—Hard and Soft Coal

FRANCIS CREEK

WISCONSIN

**A. W. WACHHOLZ**

Proprietor of

**FRANCIS CREEK GARAGE**

Dealer In Automobiles and Supplies

*REPAIRING A SPECIALTY*

FRANCIS CREEK

WISCONSIN

John C. Kellner

M. J. Kellner

**M. KELLNER & SONS**

Dealers in

**GENERAL MERCHANDISE***Flour, Feed and Country Produce**FARM MACHINERY*

Jobbers of Big Jo, Madelia, Aristos, and Cream of Wheat

Holstein-Friesian Cattle and Horses always for Sale

**WE MAKE FLAVO FLOUR**

KELLNERSVILLE and MANITOWOC

WISCONSIN

**KRAEMER RESTAURANT**

AND

**ICE CREAM PARLOR****GOOD THINGS TO EAT**

Telephone 1033

Next to Eighth Street Bridge

MANITOWOC

WISCONSIN

**JOSEPH SHIMEK**

FRESH AND SALT MEATS

*Buyer and Shipper of Live Stock*

KELLNERSVILLE

WISCONSIN

T.20N. KOSSUTH R.23-24E.

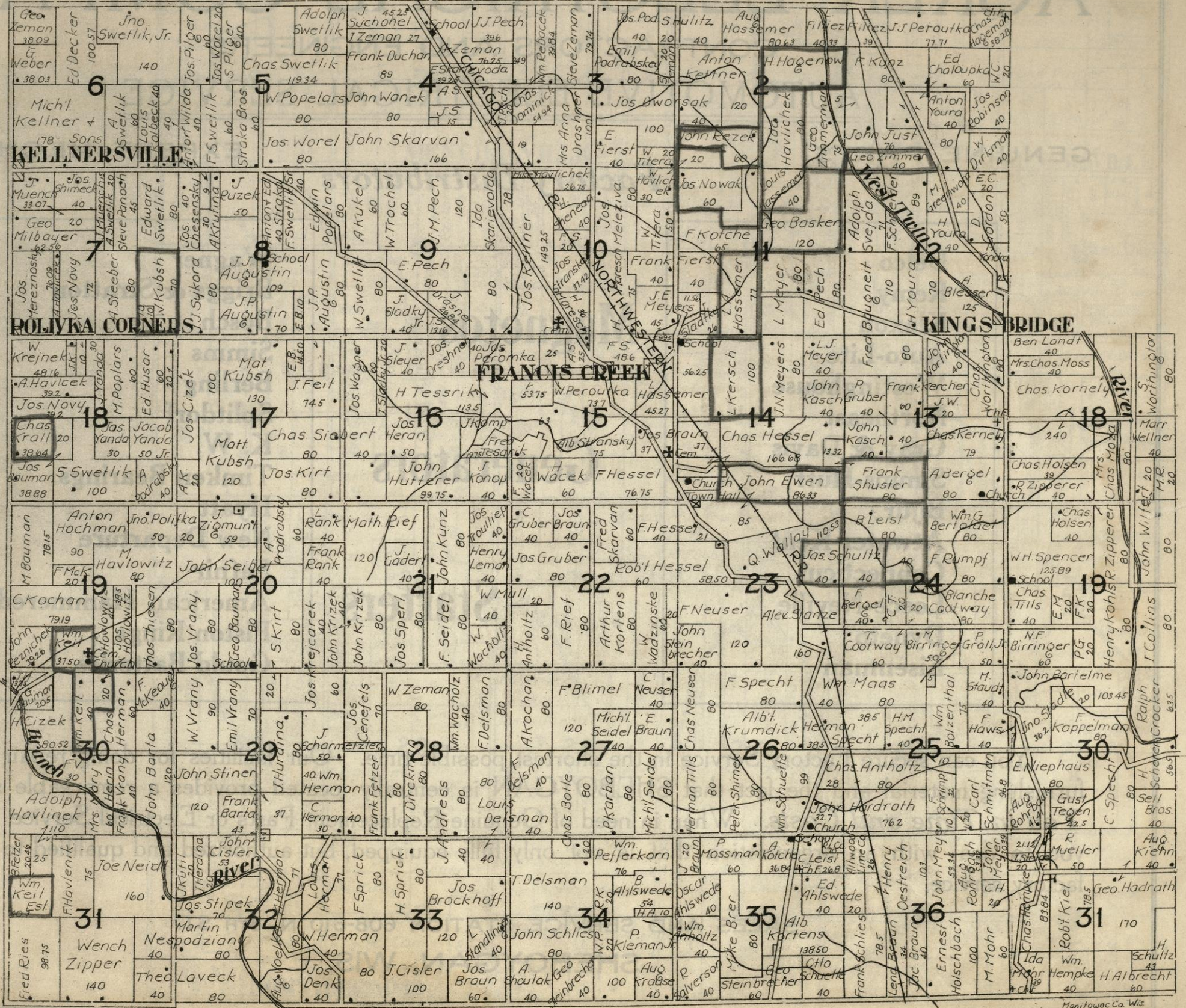

# ACKER ELECTRICAL COMPANY

CONTRACTORS AND ENGINEERS  
AUTOMOTIVE ELECTRICAL SERVICE

GENUINE PARTS

EXPERT MECHANICS

*Factory Distributors*

Delco  
 Remy  
 Klaxon  
 Auto-Lite  
 Westinghouse  
 Northeast  
 Gray & Davis  
 Simms-Huff  
 Bijur  
 Atwater-Kent  
 Connecticut  
 Leece-Neville  
 Dyneto  
 Eisenman

**Magnetos**

**Generators**

**Starters**

Wagner  
 Briggs & Stratton  
 Bosch  
 Simms  
 Berling  
 Splitdorf  
 K. W.  
 Timken Bearings  
 Hyatt  
 New Departure  
 Fafnir  
 American Hammered  
 Piston Rings  
 Gould Batteries

You can secure Factory Service in the shortest possible time. Our facilities for doing repair work and furnishing material and the fact that SHEBOYGAN is centrally located provides a remarkable saving *To You in Time and Costs.* When in need of Genuine Replacement Parts or Electrical Service it will pay you to deal with an organization that is not only fully equipped, but authorized and qualified to administer factory service.

SALES AND SERVICE STATION 608-610 N. 8TH ST.

SHEBOYGAN, WIS.

T.20N. FRANKLIN R.22E.

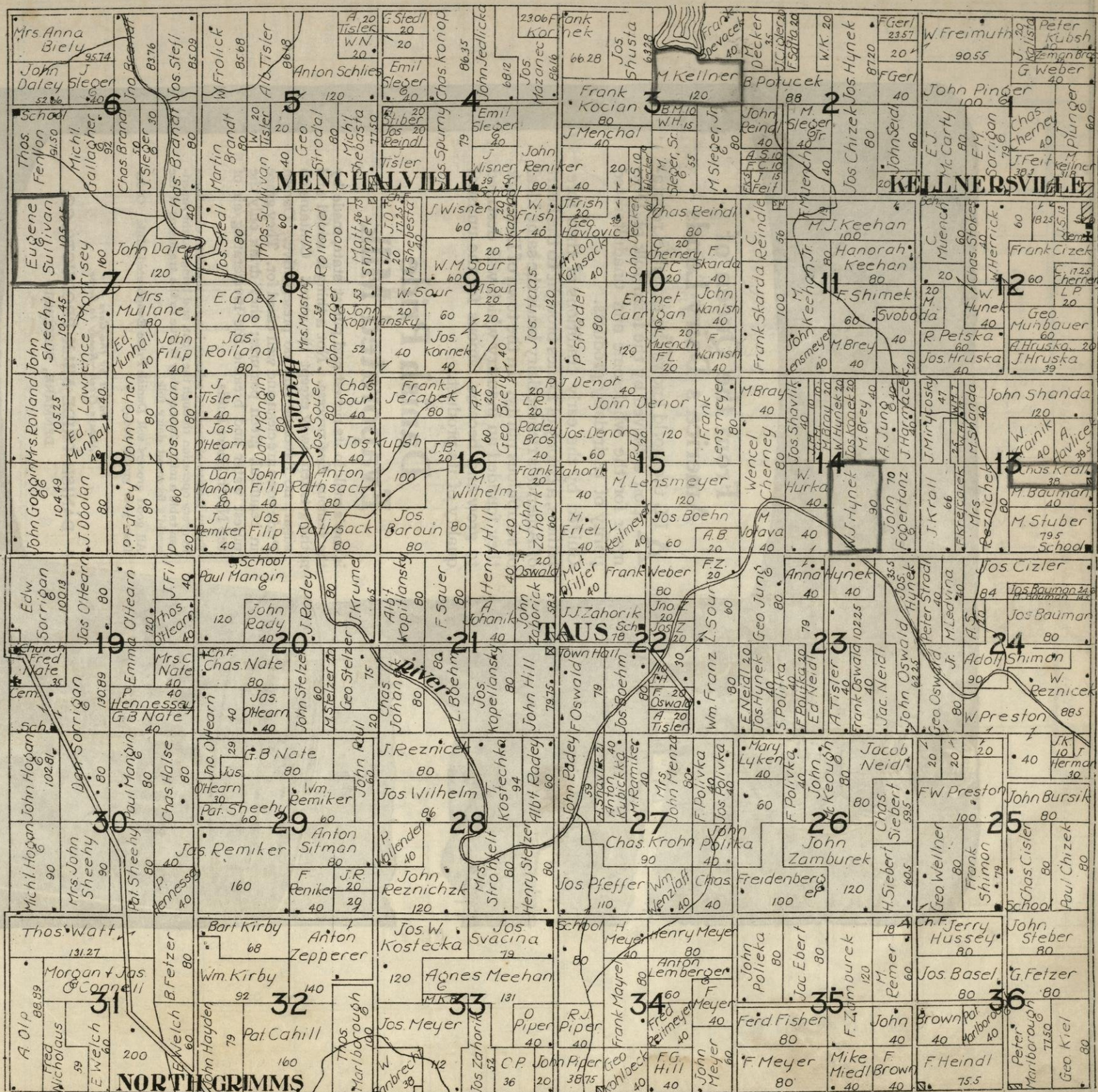

MENSCHVILLE

KELLNERSVILLE

BRADYVILLE

TAUS

NORTH GRIMMS

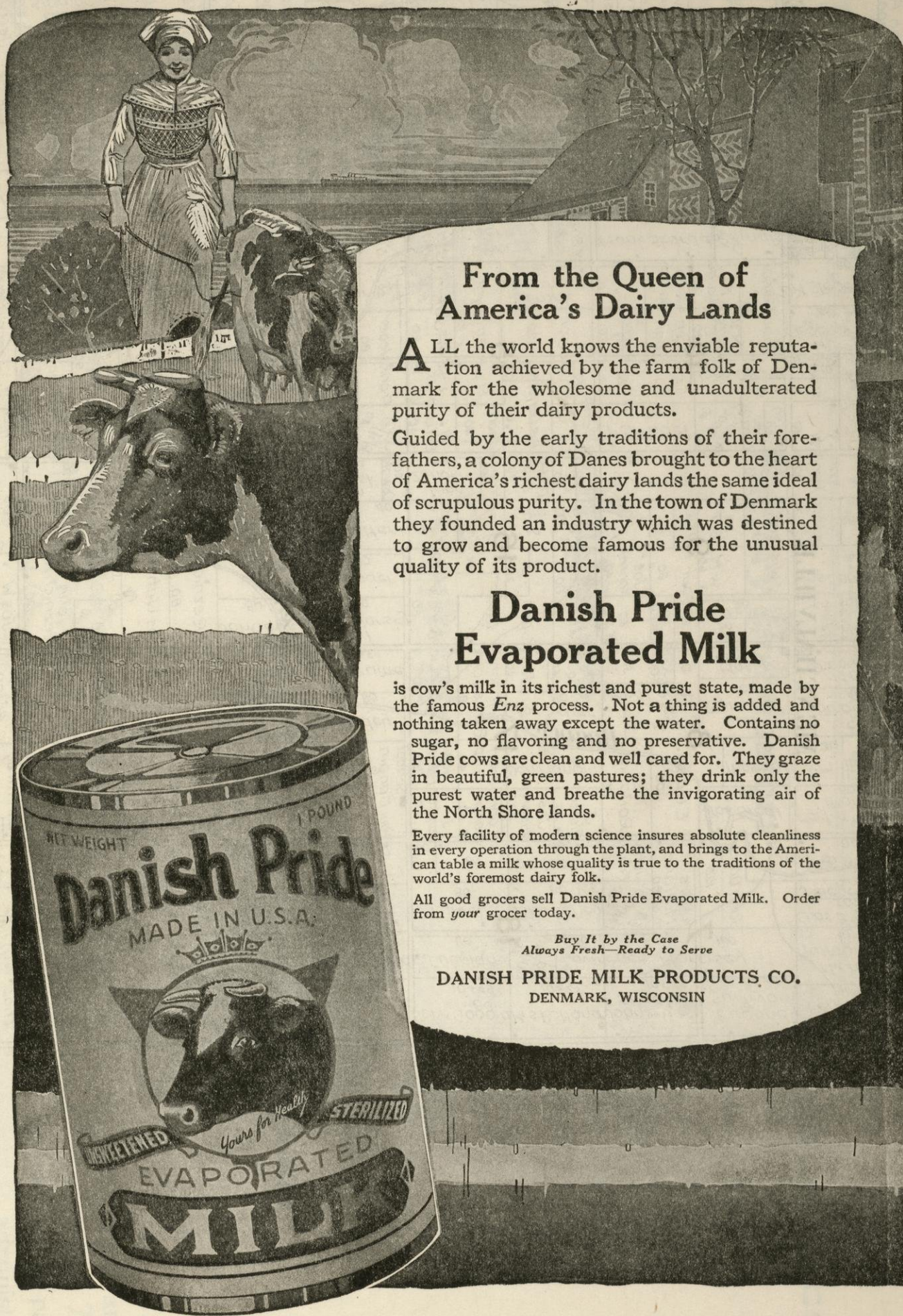

## From the Queen of America's Dairy Lands

ALL the world knows the enviable reputation achieved by the farm folk of Denmark for the wholesome and unadulterated purity of their dairy products.

Guided by the early traditions of their forefathers, a colony of Danes brought to the heart of America's richest dairy lands the same ideal of scrupulous purity. In the town of Denmark they founded an industry which was destined to grow and become famous for the unusual quality of its product.

## Danish Pride Evaporated Milk

is cow's milk in its richest and purest state, made by the famous *Enz* process. Not a thing is added and nothing taken away except the water. Contains no sugar, no flavoring and no preservative. Danish Pride cows are clean and well cared for. They graze in beautiful, green pastures; they drink only the purest water and breathe the invigorating air of the North Shore lands.

Every facility of modern science insures absolute cleanliness in every operation through the plant, and brings to the American table a milk whose quality is true to the traditions of the world's foremost dairy folk.

All good grocers sell Danish Pride Evaporated Milk. Order from your grocer today.

*Buy It by the Case  
Always Fresh—Ready to Serve*

DANISH PRIDE MILK PRODUCTS CO.  
DENMARK, WISCONSIN

T.20 N. MAPLE GROVE R.21E.

*Trin  
nell  
oneal*

*Sec 10 - Reedsville*

John Schuk 85.71	John Koerth Mrs J Degner	Chas Heinrich 4897	Wm Degner 80	Wm A Ziegler 160	Jas Cohen 120	Dan Schilling 78	Henry Boeder 87.8	J Gill 41	Martin O'Neill 172.11	R Klug 85.81	M Tisler 92.4	Julius Guedke 124.44	Olto Zinders 40	John Ehrries Schwahn 80
Fred Maertz 58.48	Wm A Ziegler 160	Dan Schilling 78	Wm Brown 80	Jas Cohen 40	Mrs K Fritch 40	Art Cafilisch 120	Chas Fritch 40	M J Mullins 120	Mrs M Kings 80	Ed Sinnane 40	Ed Kiekhaefer 125.61	Ed Kiekhaefer 40	Henry Maas 160	John O'Hearn 40
F Maertz 44	Mrs H Fisher 40	Wm Brown 80	Jas Cohen 40	Mrs K Fritch 40	Art Cafilisch 120	David Cafilisch 80	Chas Fritch 40	M J Mullins 120	Jas Gill 40	Mrs J Kings 40	Ed Sinnane 40	Ed Kiekhaefer 40	Wm Morrissey 40	Jos Dailey 80
John Geiger 29.37	John Geiger 120	Art Heinrich 40	Art Cafilisch 120	David Cafilisch 80	AC Fritch 40	Peter Hoyer 160	Chas Fritch 40	M J Mullins 120	Mrs J Kings 40	Ed Sinnane 40	Ed Kiekhaefer 40	Ed Kiekhaefer 40	Wm Morrissey 40	Jos Dailey 80
S Schuk 58.76	Geo Richardt 80	Art Heinrich 40	Art Cafilisch 120	David Cafilisch 80	AC Fritch 40	Peter Hoyer 160	Chas Fritch 40	M J Mullins 120	Mrs J Kings 40	Ed Sinnane 40	Ed Kiekhaefer 40	Ed Kiekhaefer 40	Wm Morrissey 40	Jos Dailey 80
Nick Binsfeldt 160	Jos Mandlick 40	A Ecker 40	Paul Kleiber 40	A Ecker 40	Horn 40	John Kleiber 40	L Radant 80	H Abitz 40	Chas Hinz 40	Chas Juedes 40	Barney Krueger 80	PE Gukin 80	Albt Zimmerman 120	John Sheehan 100
L Radloff 49	Jos Nagel 80	Paul Mosser 40	John Kleiber 40	L Radant 80	H Abitz 40	Chas Hinz 40	Chas Juedes 40	Barney Krueger 80	PE Gukin 80	Albt Zimmerman 120	John Sheehan 100	John Zimmerman 80	John Sheehan 100	Jas Sheehan 100
Dan Natzke 29.33	L Radloff 40	Jos Weins 80	Alb Thurow 80	John Schmidt 80	Otto Krueger 120	Otto Kurth 60	Wm Luedtke 80	Herman Zimmerman 160	Wm Luedtke 80	Herman Zimmerman 160	Wm Luedtke 80	Herman Zimmerman 160	Wm Luedtke 80	Herman Zimmerman 160
Anton Kleiber 120	John Kleiber 26	Ecker 40	John Mosser 80	John Mosser 80	John Mosser 80	John Mosser 80	John Mosser 80	John Mosser 80	John Mosser 80	John Mosser 80	John Mosser 80	John Mosser 80	John Mosser 80	John Mosser 80
Herman Behnke 89.6	A J Herwig 100	K Miller 40	Fred Wolf 40	Fred Wolf 40	Louis Boettcher 40	Aug Thurow 40	Fred Thurow 40	Fred Thurow 40	Fred Thurow 40	Fred Thurow 40	Fred Thurow 40	Fred Thurow 40	Fred Thurow 40	Fred Thurow 40
Wm Engels 58.18	Anton Tkalisky 77	John Spatshack 40	Jos Spatshack 40	Jos Spatshack 40	Jos Spatshack 40	Jos Spatshack 40	Jos Spatshack 40	Jos Spatshack 40	Jos Spatshack 40	Jos Spatshack 40	Jos Spatshack 40	Jos Spatshack 40	Jos Spatshack 40	Jos Spatshack 40
John Steinfest 61.92	Wm Miller 80	John Spatshack 40	John Spatshack 40	John Spatshack 40	John Spatshack 40	John Spatshack 40	John Spatshack 40	John Spatshack 40	John Spatshack 40	John Spatshack 40	John Spatshack 40	John Spatshack 40	John Spatshack 40	John Spatshack 40
Steve Koecuek 62.24	Wm Koch 80	John Spatshack 40	John Spatshack 40	John Spatshack 40	John Spatshack 40	John Spatshack 40	John Spatshack 40	John Spatshack 40	John Spatshack 40	John Spatshack 40	John Spatshack 40	John Spatshack 40	John Spatshack 40	John Spatshack 40

MAPLE GROVE

REEDSVILLE



T.19N.

ROCKLAND

R.21E.

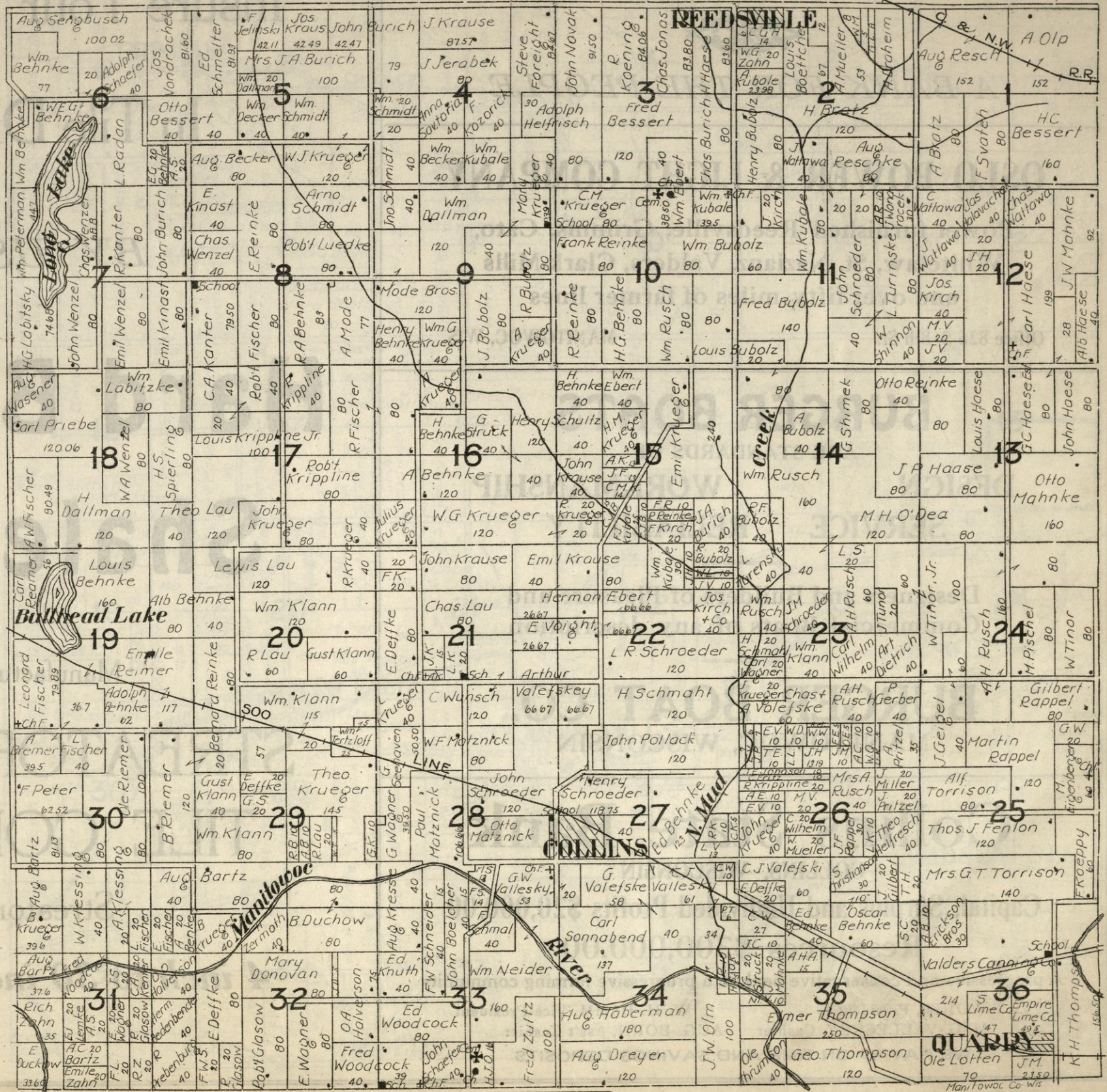



# FARMERS STATE BANK

GATO, WISCONSIN



*A BANK FOR THE PEOPLE*

## OSLO POWER & LIGHT COMPANY

Power furnished Reedsville, Grimms, Cato,  
Whitelaw, St. Nazianz, Valders, Clark Mills  
and over fifty miles of farmer lines

Office 826 S. 8th St.

MANITOWOC, WIS.

## BURGER BOATS

ARE STANDARDS OF

DESIGN

WORKMANSHIP

SERVICE

RELIABILITY

Designers and Builders of Pleasure and  
Commercial Boats of any description

## BURGER BOAT CO.

MANITOWOC, WISCONSIN

## Collins State Bank

COLLINS, WISCONSIN

Capital, Surplus and Undivided Profits \$20,000.00

Resources \$300,000.00

A progressive and conservative bank in a progressive farming community

L. T. VOIGT, President

W. H. DAMM, Vice-President

M. G. VALLESKEY, Cashier

AUG. BORN, Ass't Cashier

WE PAY 4% ON TIME AND SAVINGS DEPOSITS

Insure Your Investment

In Tile Drainage

*BY USING*

# Hard Burned Shale Tile

Manufactured by

## STREATOR DRAIN TILE COMPANY

Streator, Ill.

*4 inch to 30 inch Diameters*

T.19 N. CATO R.22 E.

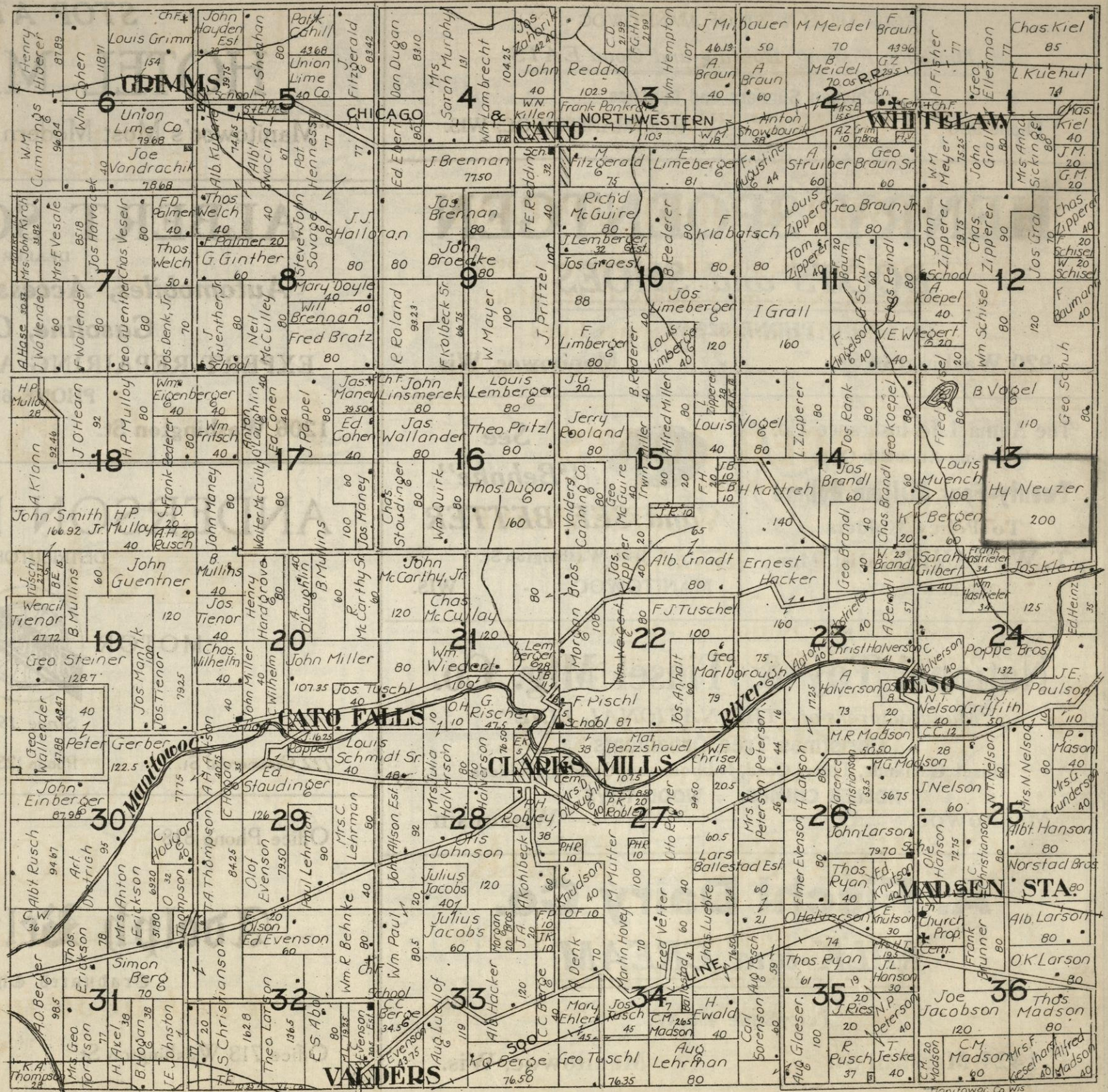

## SILVER LAKE HOTEL

WM. HASENFUS, Proprietor

FOUR MILES WEST OF MANITOWOC

*Dancing, Fishing, Boating and Good EATS*

Chicken Suppers and Lunches

Phone 980

R. 2, MANITOWOC, WIS.

## HENRY SPOENTGEN

BOOTS and SHOES

PHONE 529 W.

920 Washington St.

Manitowoc, Wis.

The Aetna Life Insurance Co.  
Is Paying Annually Over

**Twenty-Four Million Dollars**

To Policy Holders

T. W. DAVIES, Dist. Mgr.

Manitowoc, Wis.



See  
"Behnke"  
and SEE BETTER

911 Washington St.

MANITOWOC, - WIS.

## National Toy & Tinsel Mfg. Co.

Manufacturers of "THE NATIONAL LINE"

Christmas Tree Ornaments

Tinsel Garlands, Tinsel Cord, Ribbonzene, Candle Holders

ROLLER CHIMES — WOOD TOYS

Manitowoc,

Wisconsin

## A. Fischl Dairy Co.

MILK and CREAM

Telephone 458 W.

1421 Marshall St.

Manitowoc, Wis.

*When in Manitowoc*

*STOP AT THE*

## HOTEL MANITOU

"Manitowoc's Most Modern and Up-to-Date Hotel"

## ALBERT SCHUETZE

DEALER IN

*Automobiles, Accessories & Supplies*

*Gasoline, Oils, etc.*

EXPERT REPAIRING AND OVERHAULING

PHONE 628 W.

1206 Washington St.

Manitowoc, Wis.

## ANDERSON-PETRIE CO.

DISTRIBUTORS OF

MOTOR



CARS

Since 1909

722 Commercial St.

Phone 123

MANITOWOC, WIS.

Office Phone 818

Residence 1059 J.

## Adolph Belinske, D. C.

Graduated Chiropractor

Office 713 Washington St.

Manitowoc, Wis.

# T.19N. MANITOWOC RAPIDS R.23E.



*copy*



# SCHUETTE BROS. CO.

**DEPARTMENT STORE**

*Farm Produce*

MANITOWOC

WISCONSIN

# O. TORRISON COMPANY

MANITOWOC, WISCONSIN

**The Place to Trade**

**For the Whole Family**

Men's Clothing    Ladies' Ready to Wear    Shoes

Dry Goods    Crockery    Rugs and Carpets

*We Aim to Please*

# O. TORRISON COMPANY

# Henry Esch Sons Co.

MANITOWOC, WIS.

The Leaders of Low Prices for  
New and Reliable Merchandise



Showing extensive assortments of the Season's most desirable Styles for Men, Women and Children



# Henry Esch Sons Co.

THE STORE FOR BETTER VALUES

Corner 9th and Jay Streets

Otto A. Kielsmeier, Pres.    Arthur F. Zelm, Vice Pres.    Rudolph C. Kielsmeier, Sec. & Treas.

# KIELSMEIER COMPANY

MAIN OFFICE MANITOWOC

Manufacturers and Distributors of

**DAIRY PRODUCTS**



Telephone 424 W

REFERENCES:

Manitowoc Savings Bank  
American Exchange Bank, Manitowoc  
National Exchange, Milwaukee  
State Bank of Hilbert  
Plymouth Exchange Bank  
State Bank of Plymouth  
State Bank of Owen  
American National Bank, Wausau

BRANCHES

PLYMOUTH  
MANITOWOC  
MILWAUKEE  
OWEN  
ALVERNO  
WAUSAU  
SPRING GREEN

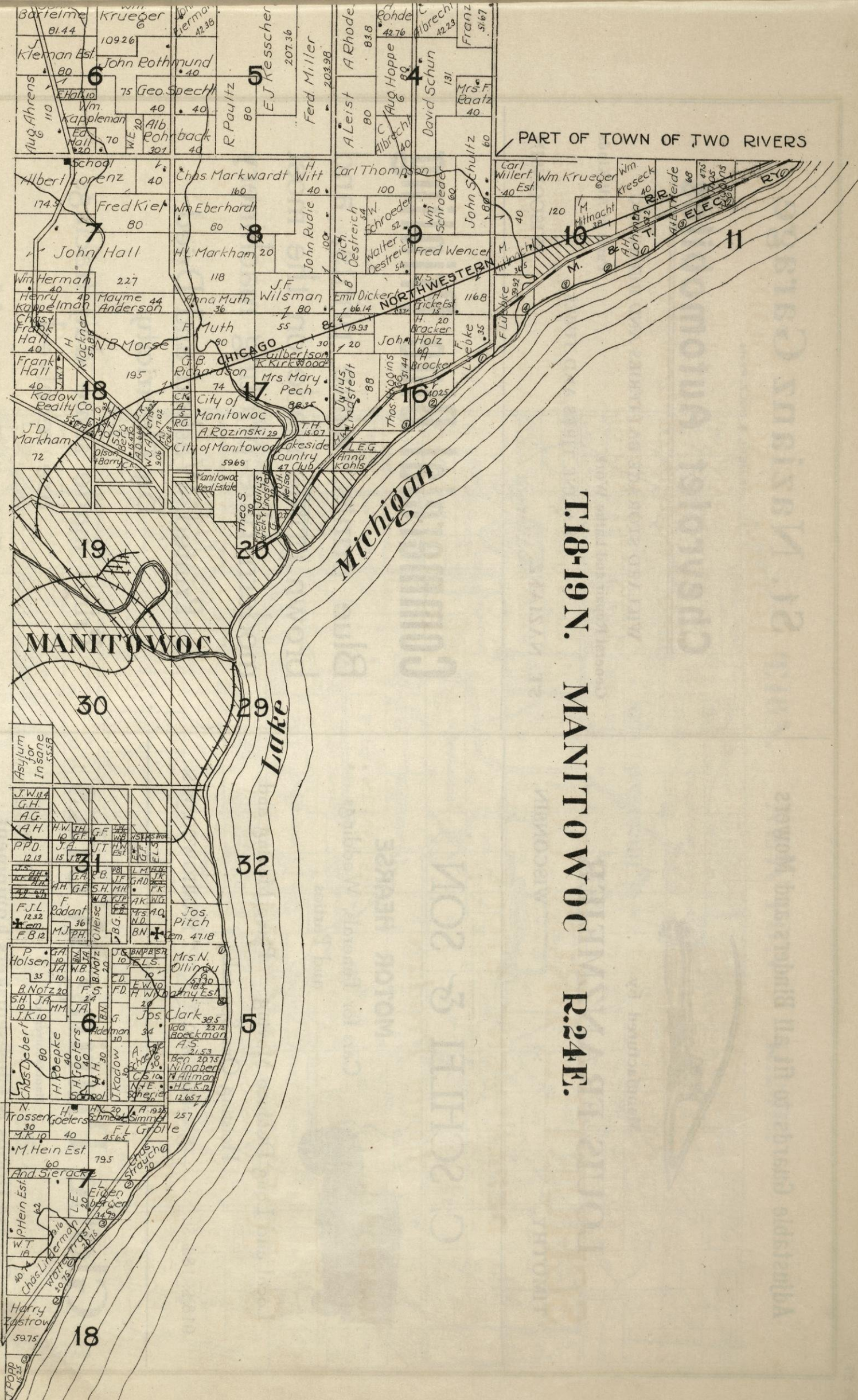

PART OF TOWN OF TWO RIVERS

Michigan

MANITOWOC

30 29 Lake

32

5

T.18-19N. MANITOWOC R.24E.

Adjustable Guards to fit all Binders and Mowers

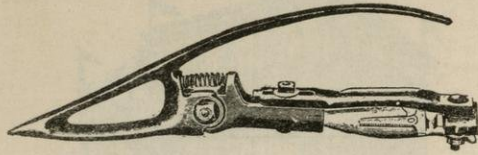

Manufactured by

**LOUIS FRANZMEIER**

TIMOTHY,

:::

WISCONSIN

**St. Nazianz Garage**

HEIMERL & BOLZ, Props.

**Chevrolet Automobiles**

WILLARD STORAGE BATTERIES AND REPAIRING

General Repair and Lathe Work

Parts of All Kinds

RACINE TIRES AND TUBES

ST. NAZIANZ,

WISCONSIN

**C. SCHLEI & SON**

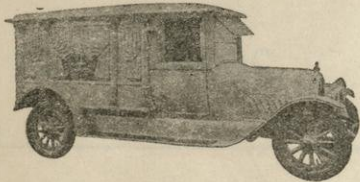

**MOTOR HEARSE**

Cars for Funerals, Weddings  
and Parties

Local and Long Distance Moving    Piano Moving and  
Hoisting Our Specialty

918 S. 18th St.

Phone 490

MANITOWOC, WIS.

**Globe Plating Works**

Manufacturers of

Cheese Hoops & Cheesemakers Equipment



*Retinning and Rebuilding Dairy Supplies*

Cor. 9th & Commercial Sts.

MANITOWOC, WIS.

**Commercial Blue Printing**

Blue prints, white prints, and  
brown prints made on the most  
modern blue-printing machinery

Printed, Washed and Dried  
By Electricity

Prints made same day tracings  
are received

*Prices Reasonable*

**Jerry Donohue Engineering Co.**

Acker Building

SHEBOYGAN, WISCONSIN

T.18N. NEWTON R.23E.

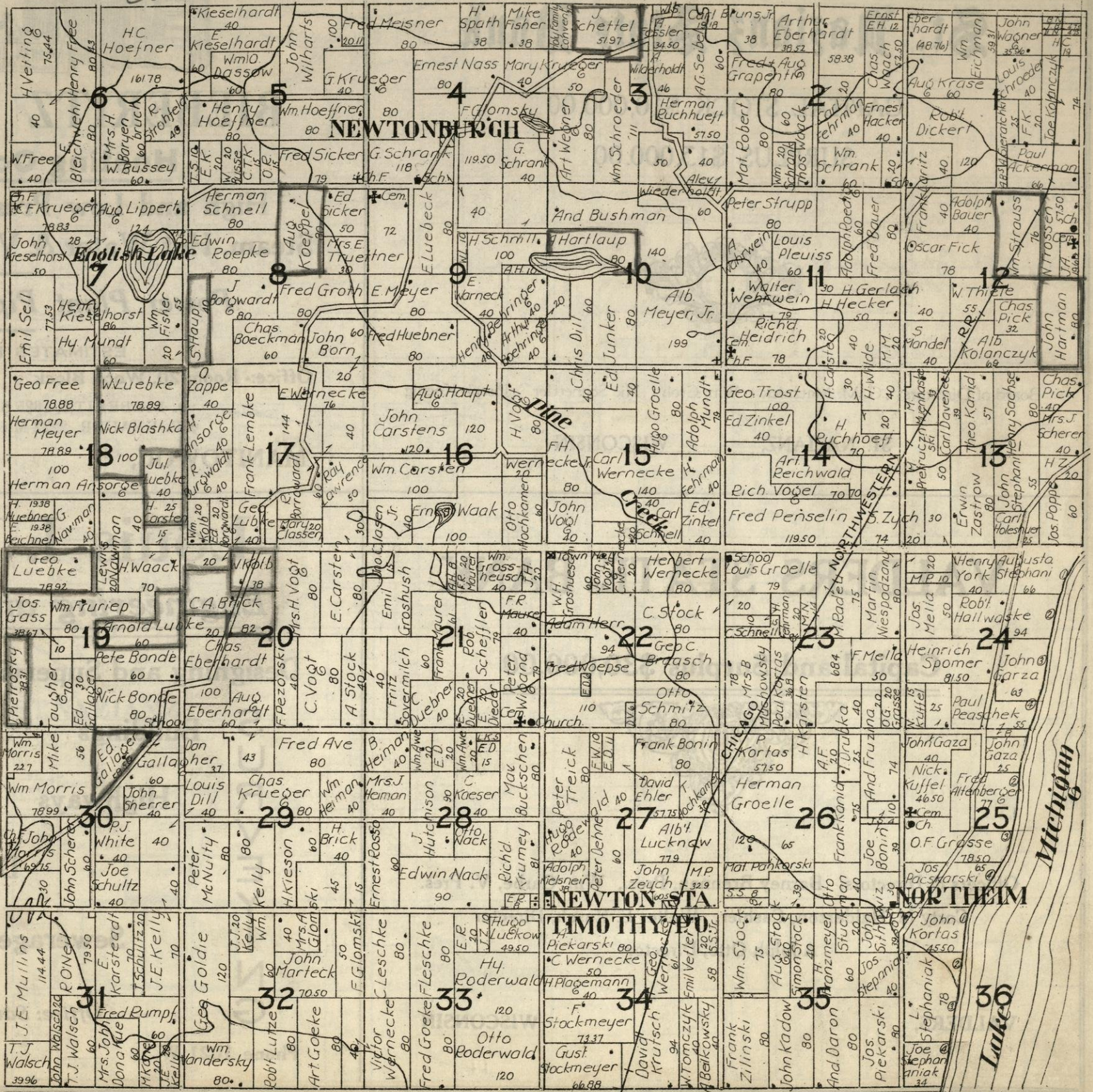



N. FILZ, Pres.

W. C. GROH, V. Pres.

A. A. SCHMITZ, Cashier

# St. Nazianz State Bank

CAPITAL STOCK \$10,000.00

SURPLUS \$13,000.00



Board of Directors: G. M. Matznick Wm. Groh Nic Schnettler Joseph Koenig

ST. NAZIANZ,

WISCONSIN

# VALDERS STATE BANK

Capital and Surplus \$30,000.00



Officers &amp; Directors: Barney Brennan, Pres., Wm. Garbe, V. Pres.

Corty M. Halderson, Cashier, Walter E. Rusch, Director

Adolph Otto, Director

VALDERS,

WISCONSIN



## BIEBERITZ & KNAUER

### Heating Contractors

High and Low Pressure Steam Fitters  
Steam, Hot Water & Vapor Heating Systems

Power Plant Piping a Specialty

ESTIMATES FURNISHED

Office:- Room 20, Wood Block

Telephone 488 J.

O. BIEBERITZ, 1325 S. 15th St., Phone 312 W.

E. KNAUER, 2222 Michigan Ave., Phone 1241

MANITOWOC,

WISCONSIN

## Louis I. Pentzien

### Engineering and Contracting

Designing and Supervising:-

S  
U  
R  
V  
E  
Y  
I  
N  
G

Buildings

Pavements

Highways

Water Supply

Drainage

Sewerage &amp; Sewage Disposal

Office: Savings Bank Building

Phone 1021 W.

MANITOWOC, WIS.

T.18N. LIBERTY R.22E.

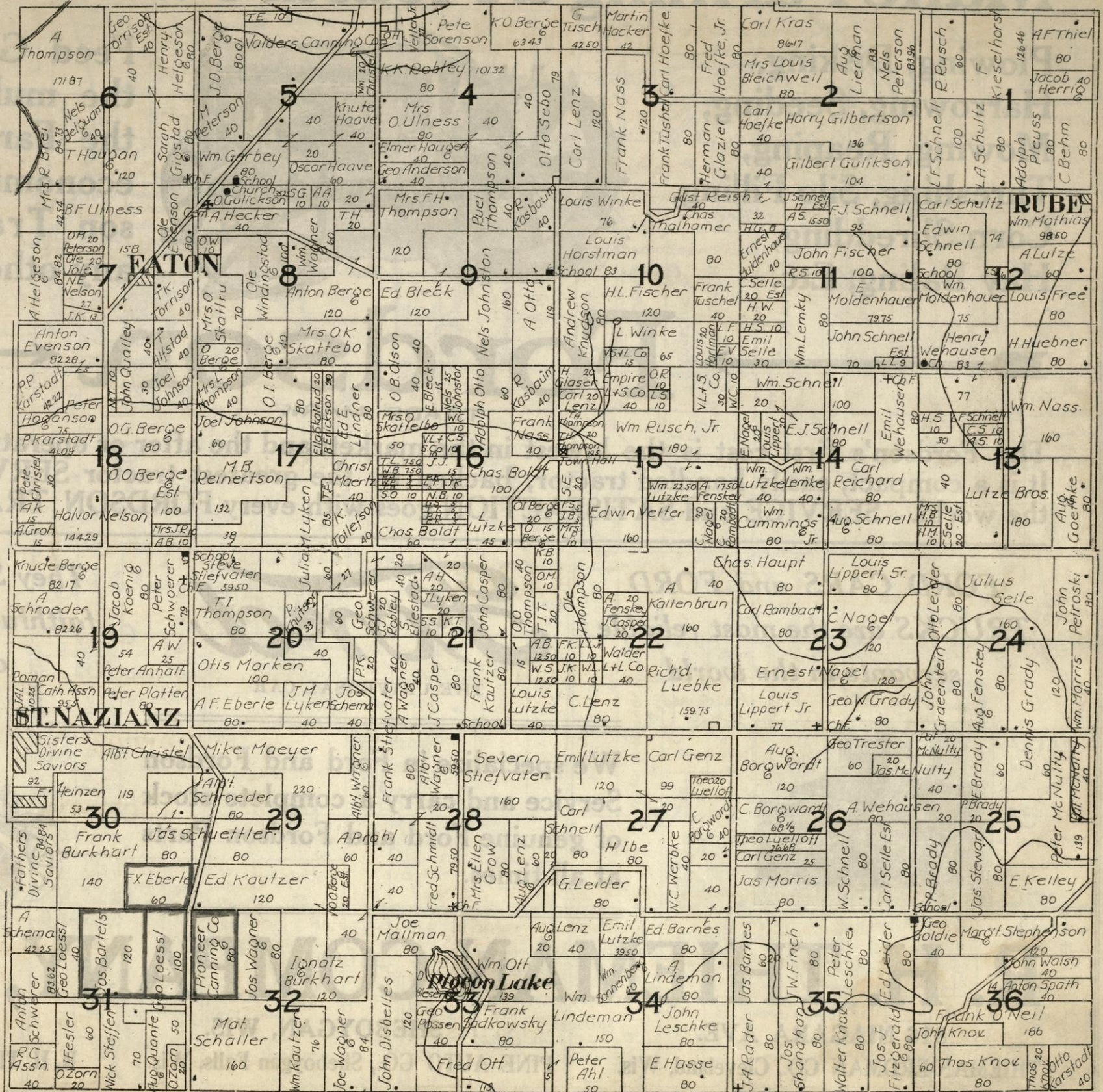

# Make Farming a Pleasure with a Fordson

Plowing, Disking,  
Harrowing, Seeding,  
Mowing, Reaping,  
Threshing, Silo Filling,  
Corn Shredding,  
Hay Baling, Etc.

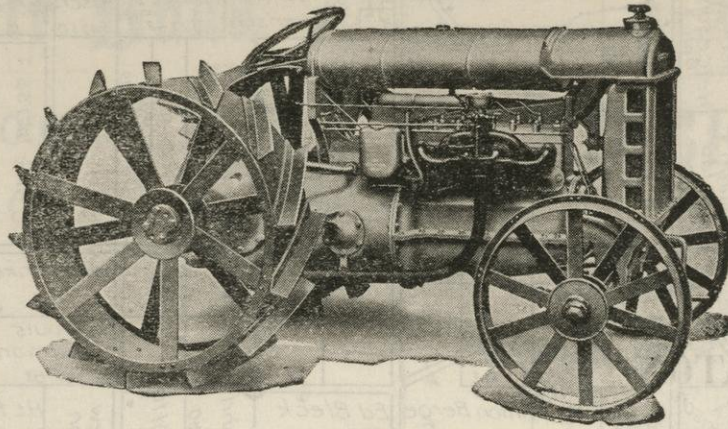

Feed Grinding and all  
the multiplied work on  
the Farm is done more  
economically by Ford-  
son Tractors than by  
any other method.

→ **Fordson** ←  
TRADE MARK

The Fordson's first cost is the lowest in the market; and the after or operating cost is the lowest. It is a compact, easily handled tractor, backed by the greatest tractor SERVICE organization in the world. SERVICE and SATISFACTION goes with every FORDSON TRACTOR.

*FORD CARS and FORD  
TRUCKS are the most reliable  
servants in the world*

**Ford**

THE UNIVERSAL CAR

*They SAVE and SERVE  
faithfully many millions of  
owners to-day*



We specialize in Ford and Fordson  
Service and carry a complete stock  
of genuine Ford and Fordson Parts  
at all times.

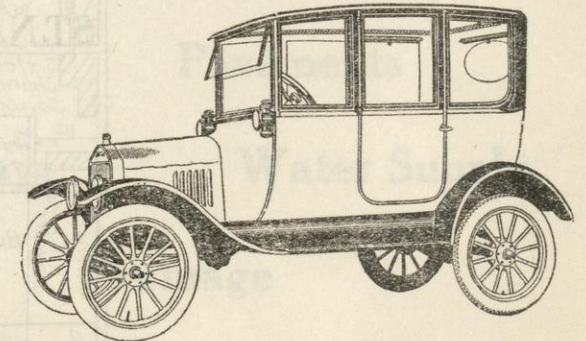

**R. H. THIEMAN COMPANY,** Exclusive Ford and  
Fordson Distributors

816 NIAGARA AVE.

SHEBOYGAN, WIS.

PHONE 600

THIEMAN-ERDMAN CO., Cleveland, Wis.

PINE AUTO CO., Sheboygan Falls, Wis.

R. H. THIEMAN CO., Oostburg, Wis.

T.18N. EATON R.21E.

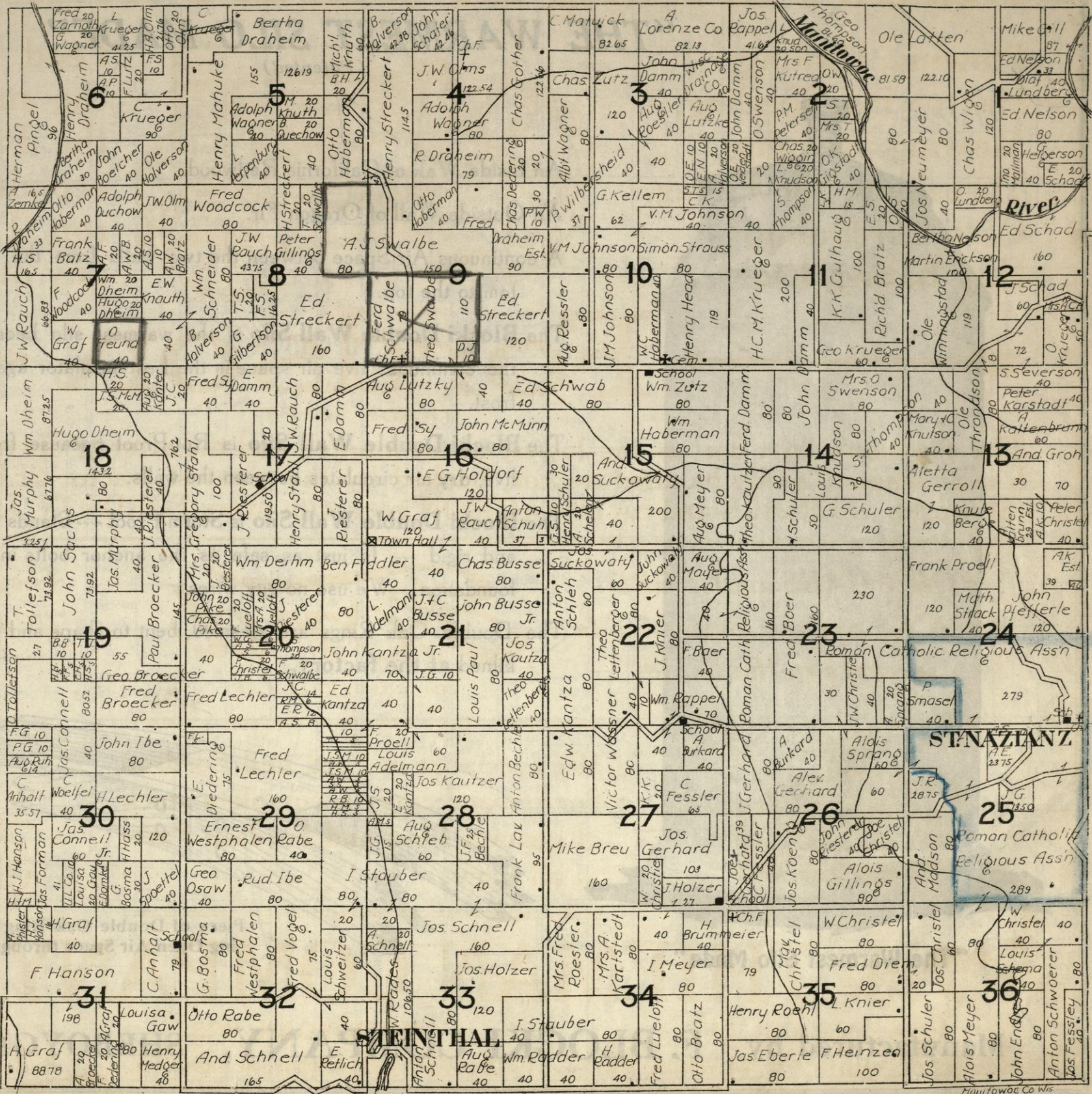

STANIZANZ

STEINTHAL

# BLOCKI DOUBLE WALL SILO

*"THE WARMEST SILO MADE"*

*(Patented)*

An Inside Wall of California Redwood.

An Outside Wall of Oregon Fir.

A continuous Air Space between the two walls from the bottom to the top.

The **Blocki Double Wall Silo** is the warmest silo because the continuous live air space is the best insulator against frost.

The **Blocki Double Wall Silo** is Rot-Proof because fresh, live, dry air circulates between the walls.

The **Blocki Double Wall Silo** is Storm-Proof ---- Stands firm and rigid ---- Is just as safe as the anchor bolts in the foundation. We use no guy wires.

The Double Oak Rings are steamed, bent to shape and dry-kilned **at the factory.**

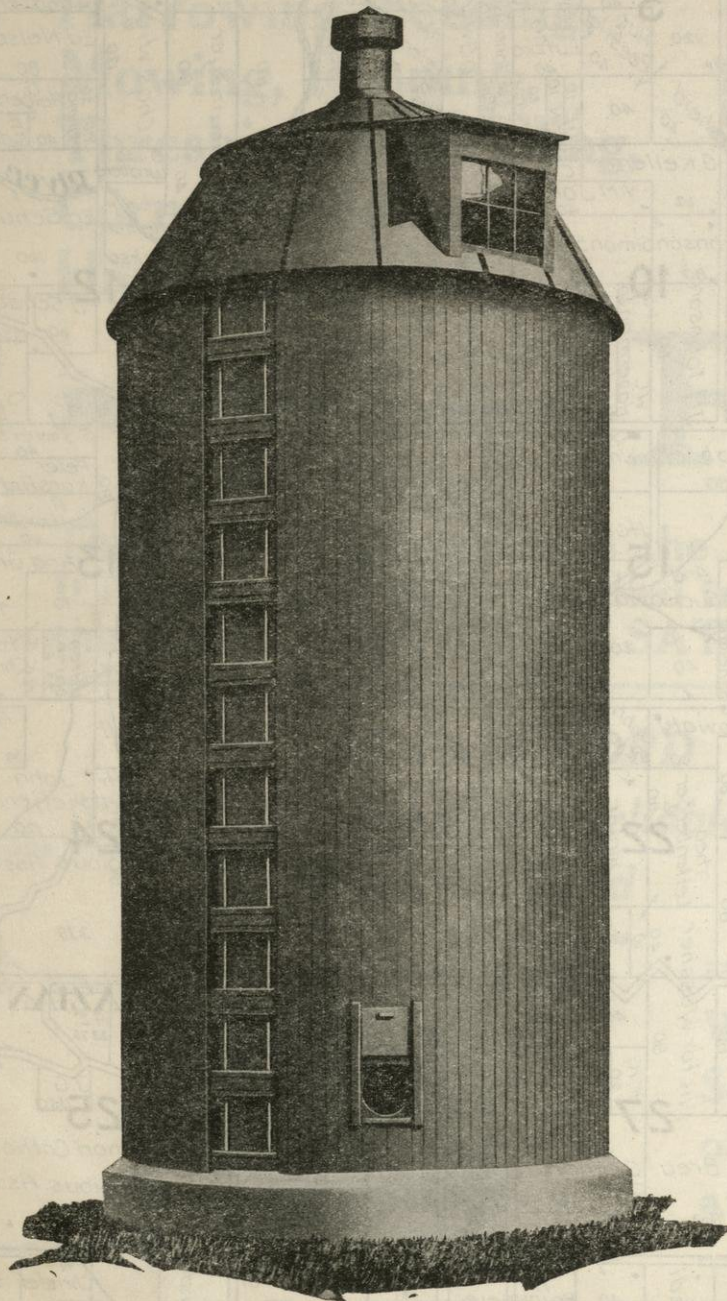

*"The Warmest Silo Made"*

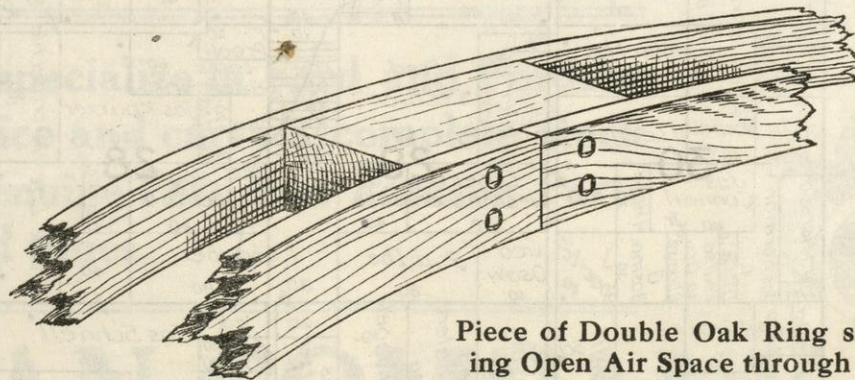

Piece of Double Oak Ring showing Open Air Space through ring

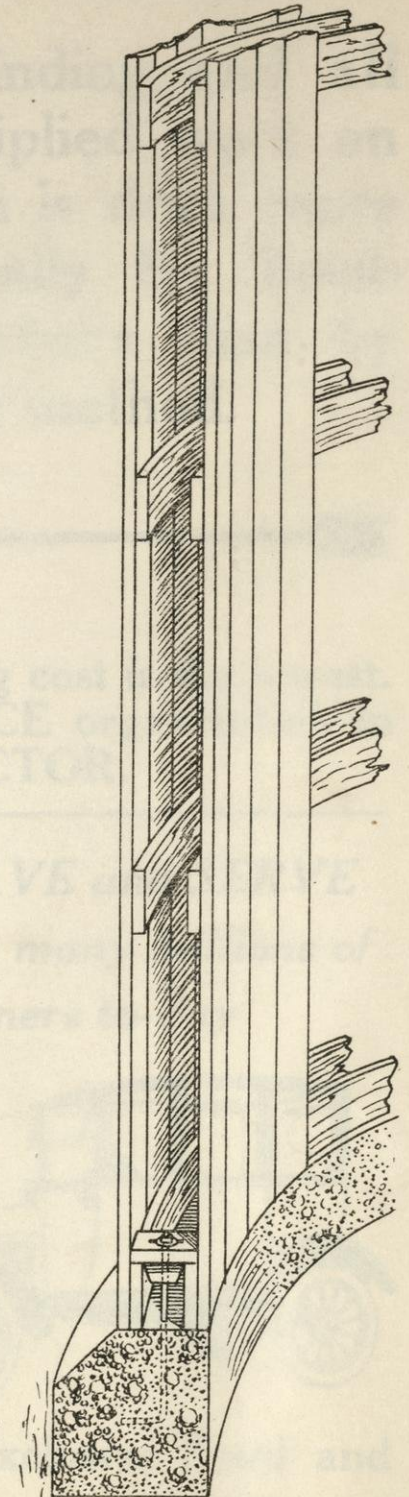

Showing the continuous Air Space Between the Walls

Manufactured by **F. BLOCKI COMPANY, SHEBOYGAN, WISCONSIN**

ALLO

1811

CONSIST

2

52

Guardian

or

and

at Fustage

WEEKLY

NO. 1

1811

EL

NDISE

SCONSIN

---

RS

RS

---

Guardian

tor

and

es

ent Privilege

OSCAR A. ALTER  
SECRETARY

sin

T.17 N. MEEME R.22 E.

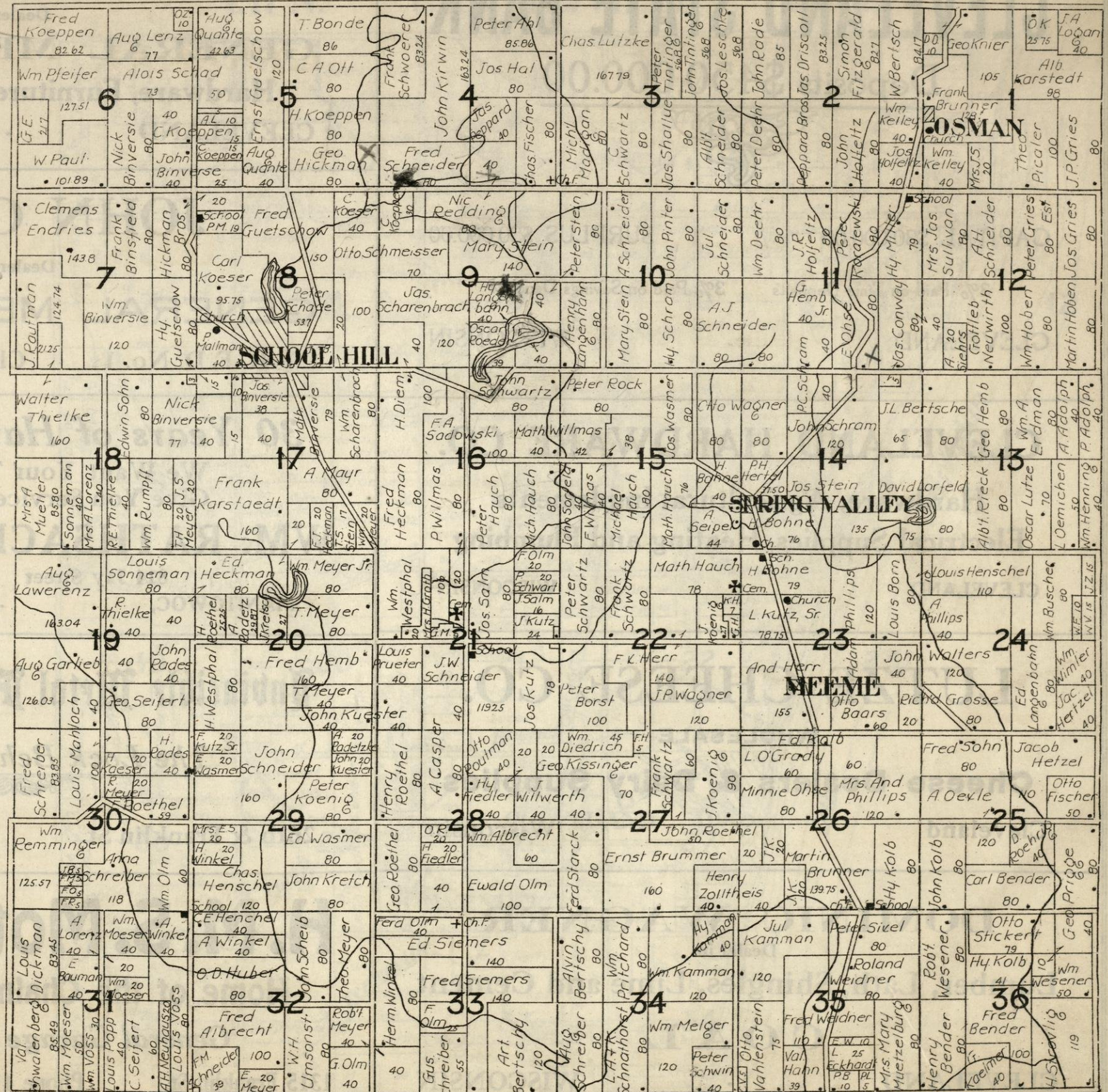

*Handwritten note:* 2nd road past town

**JOSMAN**

**SCHOOL HILL**

**SPRING VALLEY**

**MEEME**



# CLEVELAND STATE BANK

Deposits \$450,000.00



CAPITAL \$30,000.00

SURPLUS \$30,000.00

3% Paid on Time Deposits

3% Paid on Savings Deposits

CLEVELAND

WISCONSIN

## CLEVELAND HARDWARE CO.

Hardware, Agricultural Implements  
Electrical Supplies, Heating and Plumbing

CLEVELAND

WISCONSIN

## LUTZE CHEESE CO.

WHOLESALE

**Cheese Dealers & Dairy Supplies**

Cleveland

Wisconsin

## DOMINIC WAGNER

Dealer in

Lumber, Lath, Shingles, Lime and Cement

**COAL**

CLEVELAND

WISCONSIN

## A. STOLTENBERG

Dealer in

**GENERAL MERCHANDISE**

Hardware, Furniture and Undertaking

CLEVELAND

WISCONSIN

## JOHN GRETZ

Dealer in

**GENERAL MERCHANDISE**

R. F. D. No. 1

Cleveland, Wisconsin

## *30 Years of Hardware Service*

We Want Your Trade and Will  
Give You Service to Merit Same

**WM. RATHSACK & SONS CO.**

814 Jay Street

Phone 181

MANITOWOC,

WISCONSIN

## *Invincible Metal Furniture Company*

*The Lock Behind the Lock*

26th & Franklin St.

MANITOWOC, WIS.

## **H. M. S. Motor Car Co.**

Home of the Chalmers and Maxwell

*General Garage and Repairing*

1315 Franklin St.

Phone 413 W.

Manitowoc, Wis.

T.17 N. CENTERVILLE R.23E.

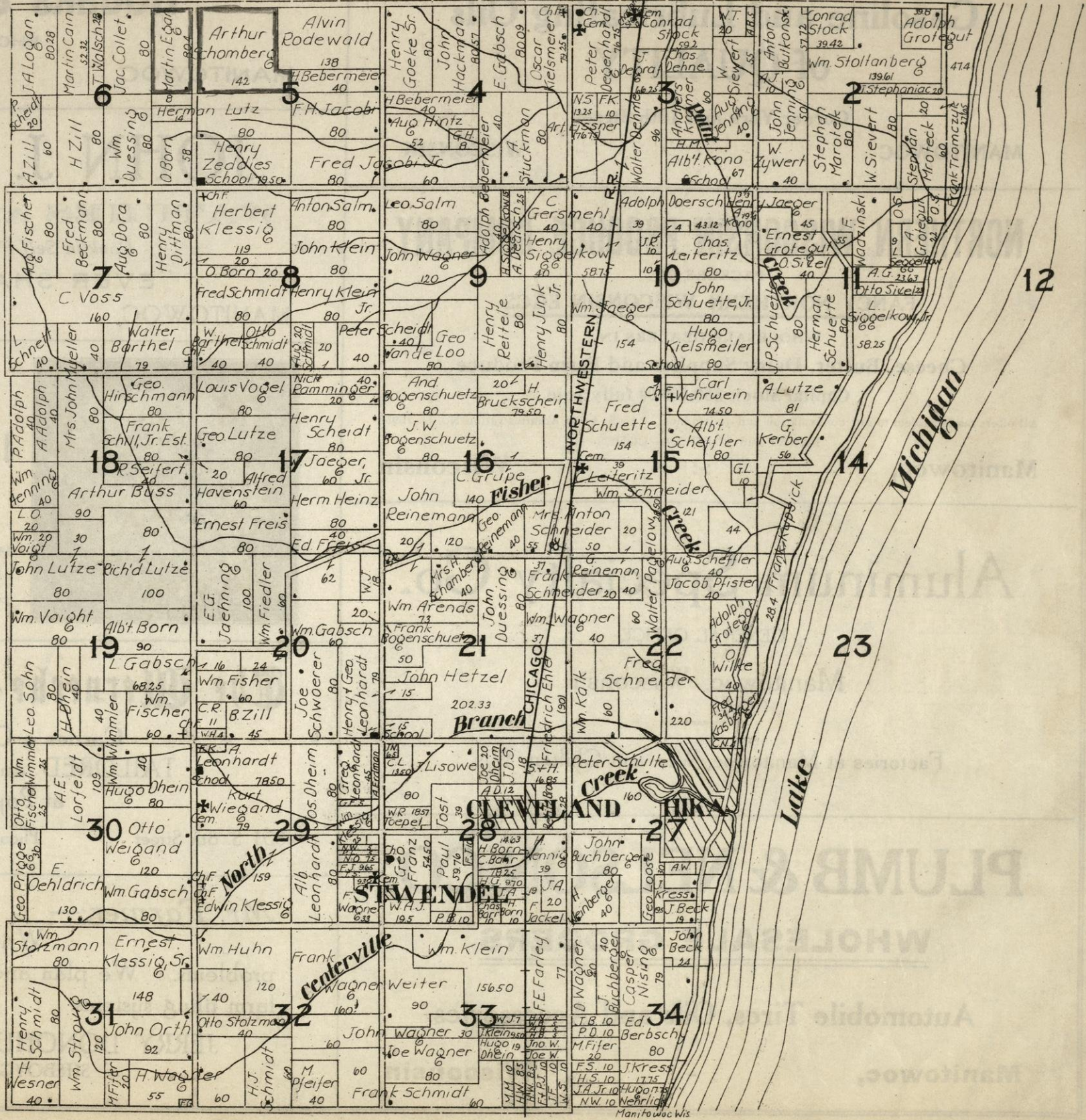

# CLARK OIL COMPANY

## Gasoline and Lubricating Oils of QUALITY

Corner York and 10th Street

MANITOWOC

WISCONSIN

# NORTHERN WISCONSIN PRODUCE COMPANY

PACKERS OF

FANCY NORTHERN WISCONSIN EGGS

WHOLESALE DEALERS IN

Cheese, Butter, Dairy Supplies and Farm Produce

Capital Stock \$50,000.00 fully paid

All offers made subject to our confirmation and acceptance. U. S. Food Administration No. G. 13950  
BARRY and ROBINSON CODES

Manitowoc,

:::

Wisconsin

# Aluminum Specialty Co.

GENERAL OFFICE

Manitowoc, Wisconsin

Factories at Manitowoc, Wis. and Chilton, Wis.

# PLUMB & NELSON CO.

WHOLESALE GROCERS

Automobile Tires, Oils and Accessories

Manitowoc,

-

Wisconsin

# PARK DRUG STORE

## Kodaks & Supplies

PHONE 340

MANITOWOC,

-

WISCONSIN

# JOHN J. KOEHLER

## WATCHES AND DIAMONDS

*Conklin Self-Filling Fountain Pens*

"EVER SHARP" PENCILS

MANITOWOC,

-

WISCONSIN

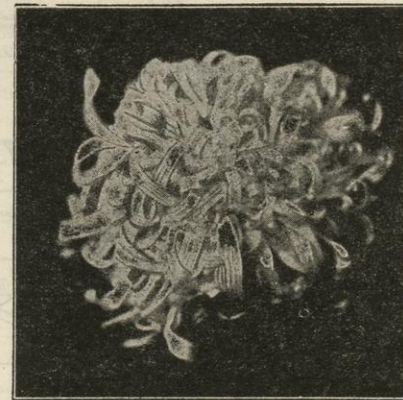

*For Better Seeds and Advice*

*Consult*

**J. K. Rugowski Seed Company**

905-909 Washington St.

Manitowoc, Wisconsin

Originators of

World's Finest Astors, Blight Resisting  
Potato, Earliest Producer Tomato, etc.

*Pay us a visit at our Seed Farm, S. 10th St.*

# The Wernecke-Meeker Millinery

Carries a Complete Line of  
TAILORED and TRIMMED HATS  
at Popular Prices

831 S. 8th Street

Phone 352-J

Manitowoc, Wisconsin

*Mr. Farmer:—*

Write us about your tile drainage problems. We plan and supervise the construction of farm tiling systems.

JERRY DONOHUE ENGINEERING CO.

SHEBOYGAN, WISCONSIN



MAP  
OF  
CITY OF  
**MANITOWOC**  
WISCONSIN

SCALE—1"=800 ft.

M I C H I G A N

L A K E



MAP  
OF THE  
**CITY OF TWO RIVERS**  
WISCONSIN

ENGINEER'S DEPARTMENT  
TWO RIVERS, WISCONSIN  
JANUARY 1921

SCALE 1"=400' 1921.

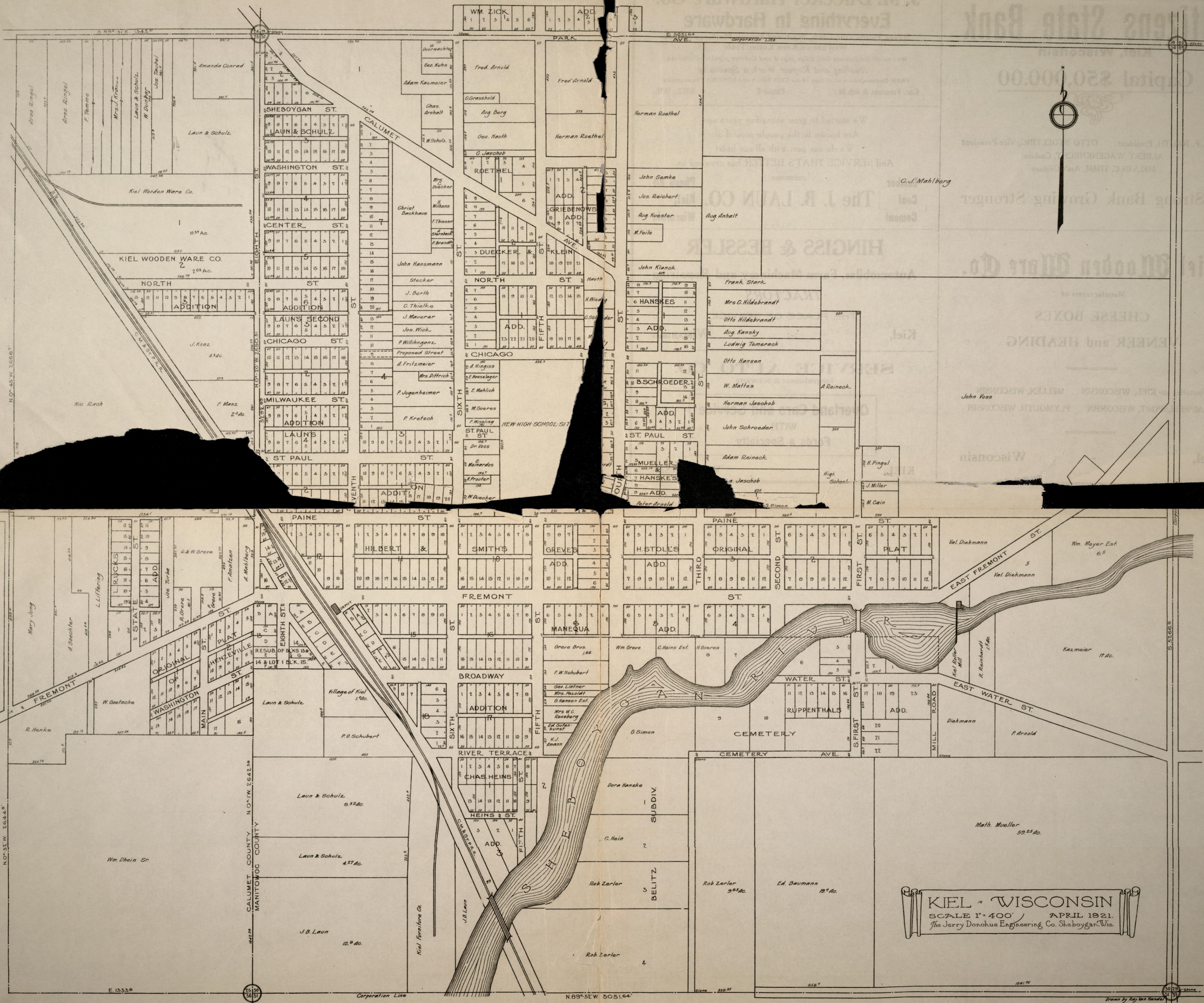

**KIEL, WISCONSIN**  
 SCALE 1" = 400' APRIL 1921.  
 The Jerry Donohue Engineering Co. Sheboygan, Wis.

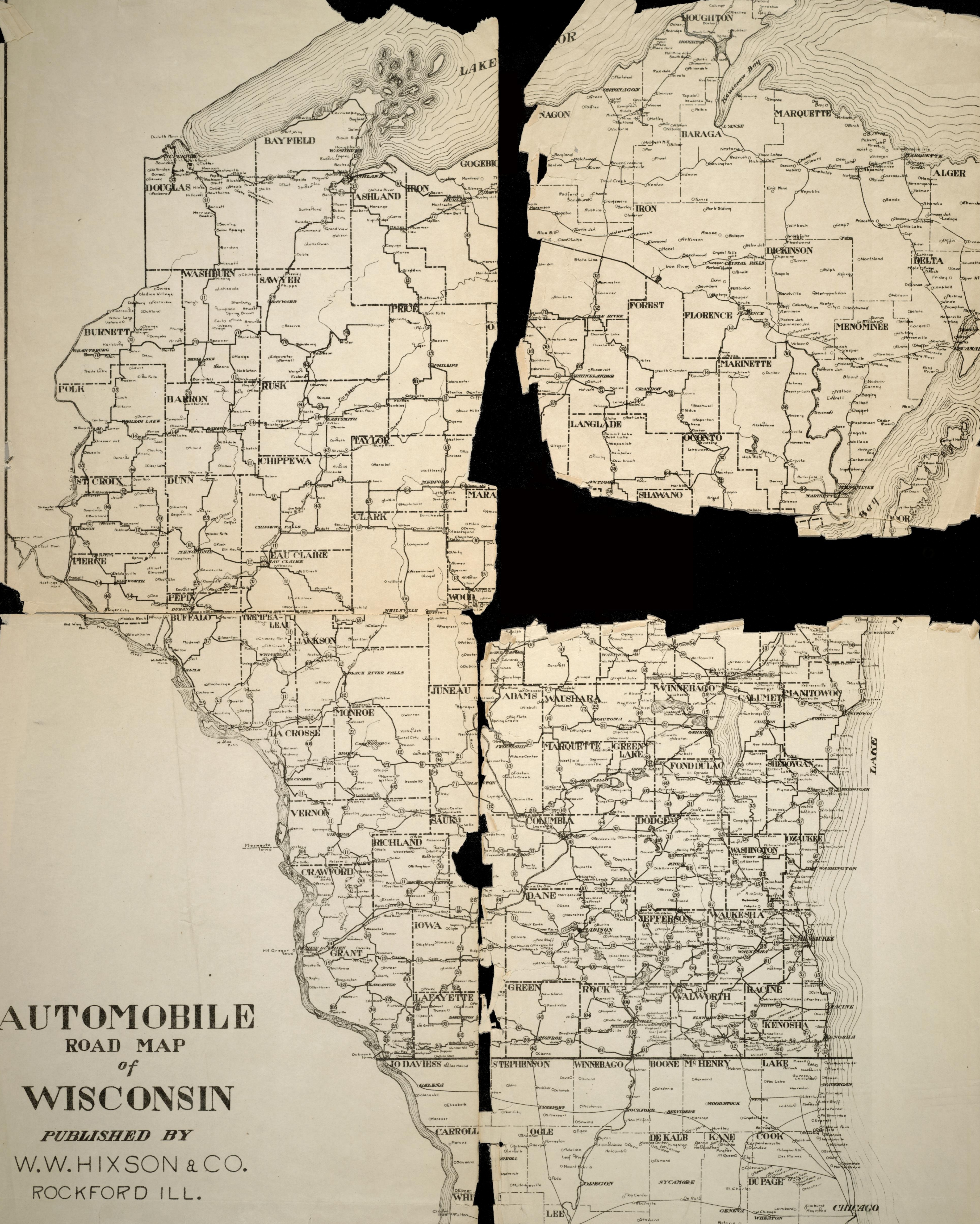

**AUTOMOBILE**  
**ROAD MAP**  
*of*  
**WISCONSIN**  
 PUBLISHED BY  
**W.W.HIXSON & CO.**  
 ROCKFORD ILL.

CHICAGO  
 WISCONSIN  
 ILLINOIS  
 INDIANA  
 MICHIGAN  
 MINNESOTA  
 IOWA  
 NEBRASKA  
 KANSAS  
 MISSOURI  
 ARIZONA  
 CALIFORNIA  
 OREGON  
 WASHINGTON  
 MONTANA  
 WYOMING  
 NEVADA  
 IDAHO  
 UTAH  
 COLORADO  
 WYOMING  
 NEVADA  
 IDAHO  
 UTAH  
 COLORADO